

**SEWER JUNCTION INFORMATION  
FOR SEWER ID MA60019037**

REFERENCE—METERS NORTH OF MANHOLE MH60016461

DIST. FROM REF. MANHOLE	JUNCTION DIA.	CLOCK REF.	SERVICE TYPE	DESCRIPTION
13.4	150	03	CN	LIVE
26.4	150	02	CNI	LIVE

ALL JUNCTION INFORMATION  
BASED ON CCTV INSPECTION

**KILKENNY DRIVE**

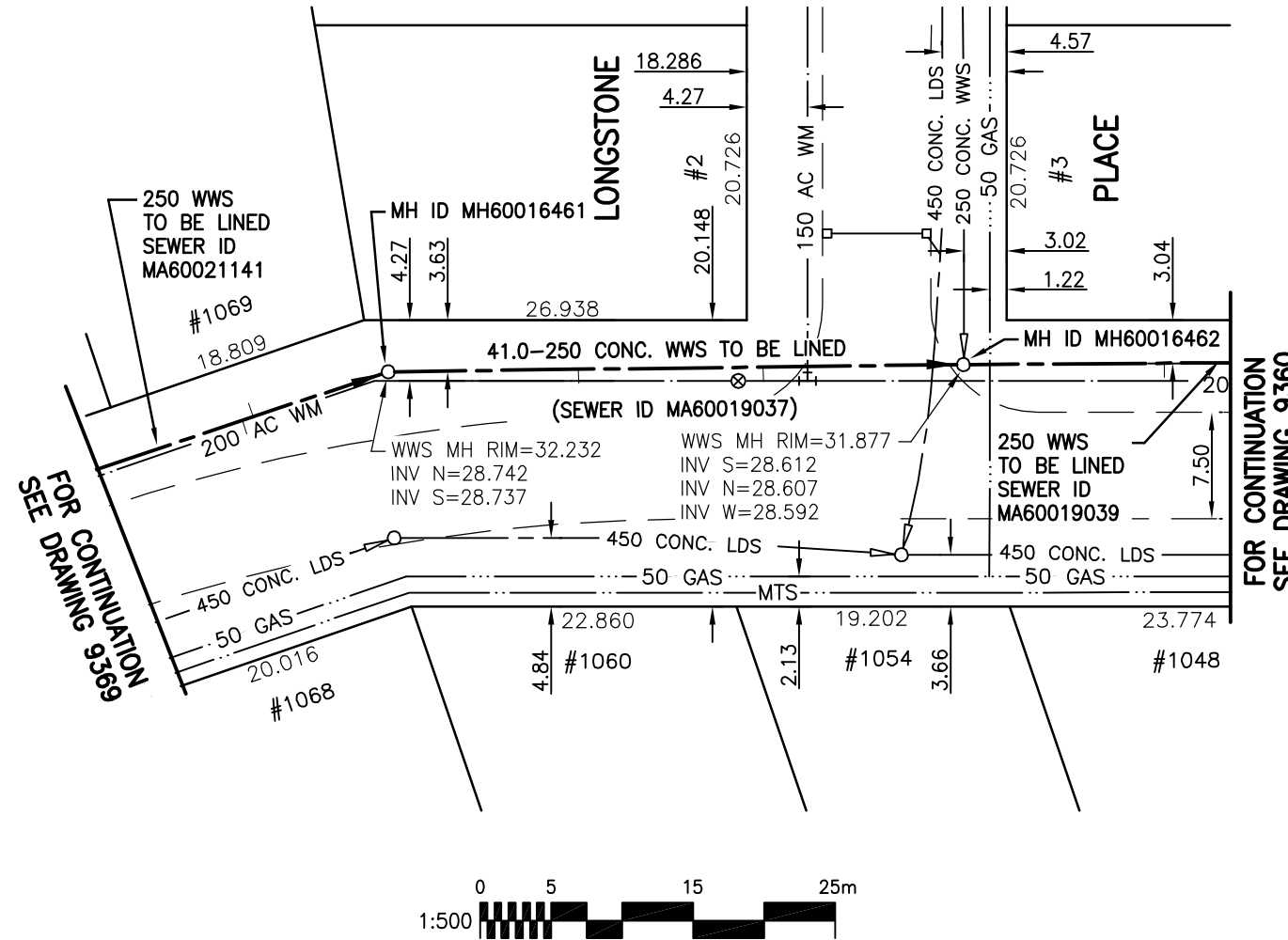
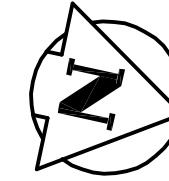

**WARNING**

IF POWER EQUIPMENT OR EXPLOSIVES ARE TO BE USED FOR EXCAVATION ON THIS PROJECT THE CONTRACTOR MUST:

- 1) NOTIFY THE GAS COMPANY OF THE PROPOSED LOCATION OF EXCAVATION.
- 2) TAKE PRECAUTION TO AVOID DAMAGE TO GAS COMPANY INSTALLATIONS.

SEE PROVINCIAL REGULATION 140/92 FOR DETAILS

**METRIC**

WHOLE NUMBERS INDICATE MILLIMETRES  
DECIMALIZED NUMBERS INDICATE METRES

BENCH MARK: S.W. Cor. Kilkenny Dr. & Rice Rd., Tblt. on top of 0.05 m dia. x 2.4 m iron pipe, 10.4 m W. of C.L. Conc. Pav't. of Kilkenny Dr. & 4.5 m S. of C.L. Conc. Pav't. of Rice Rd. produced from the W.

**BID OPPORTUNITY 245-2010**



Certificate of Authorization

Stantec Consulting Ltd.

No. 1301 Date: \_\_\_\_\_

**LOCATION APPROVED UNDERGROUND STRUCTURES**

B.M. 82-32  
ELEV. 231.420m



**Stantec Consulting Ltd.**

905 Waverley Street, Winnipeg, Manitoba  
Tel 204-489-5900 Fax 204-453-9012

ENGINEER'S SEAL



**THE CITY OF WINNIPEG  
WATER AND WASTE DEPARTMENT**

**2010 SEWER RENEWALS  
BY CIPP LINING - CONTRACT 14  
KILKENNY DRIVE  
1ST MH S. OF LONGSTONE PL. TO  
MH AT LONGSTONE PL.**

SHEET OF  
**6 26**  
CAD FILE DRAWING NUMBER  
12350c-106-735.dwg  
CITY DRAWING NUMBER  
**9359**

DESIGNED BY	J.K.H.	CHECKED BY	W.A.B.
DRAWN BY	J.K.H.	APPROVED BY	C.L.D.
HOR. SCALE:	1:500	RELEASED FOR CONSTRUCTION:	
VERTICAL:	N/A		
NO.	REVISIONS	DATE	BY
		10.06.21	

CONSULTANT DRAWING NO.  
**C-106**