

**SEWER JUNCTION INFORMATION
FOR SEWER ID MA60023205**

REFERENCE—METERS EAST OF MANHOLE MH60019461

DIST. FROM REF. MANHOLE	JUNCTION DIA.	CLOCK REF.	SERVICE TYPE	DESCRIPTION
3.2	150	11	JN	-
10.9	150	01	JN	-
17.3	150	10	CNI	LIVE
27.8	150	02	JN	LIVE
40.8	150	01	CN	LIVE
45.2	150	10	CNI	LIVE
52.8	150	01	JN	LIVE
59.0	150	10	CNI	LIVE
66.8	150	12	CN	LIVE
72.6	150	10	CX	LIVE
77.8	150	12	JN	LIVE
77.8	150	01	CN	LIVE

ALL JUNCTION INFORMATION
BASED ON CCTV INSPECTION

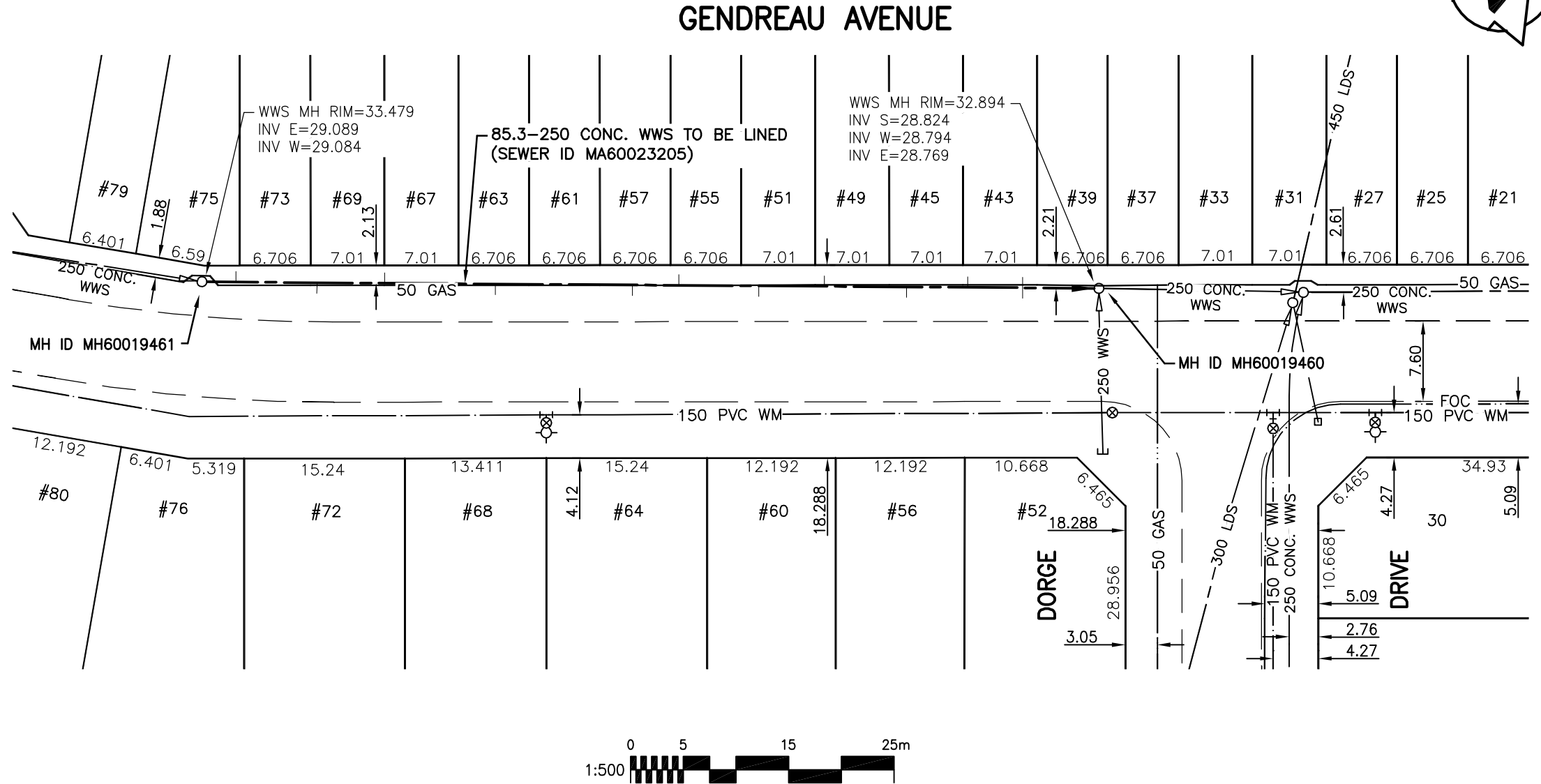

WARNING

IF POWER EQUIPMENT OR EXPLOSIVES ARE TO BE USED FOR EXCAVATION ON THIS PROJECT THE CONTRACTOR MUST:

- 1) NOTIFY THE GAS COMPANY OF THE PROPOSED LOCATION OF EXCAVATION.
 - 2) TAKE PRECAUTION TO AVOID DAMAGE TO GAS COMPANY INSTALLATIONS.
- SEE PROVINCIAL REGULATION 140/92 FOR DETAILS

METRIC

WHOLE NUMBERS INDICATE MILLIMETRES
DECIMALIZED NUMBERS INDICATE METRES

BENCH MARK: S.E. Cor. Ave. Gendreau & Dorge Dr., Tblt. in W. Conc. foundation of No. 30 Ave. Gendreau, 3.5 m S. & 0.2 m below stucco from N.W. Cor. of dwelling.

BID OPPORTUNITY 245-2010



Certificate of Authorization

Stantec Consulting Ltd.

No. 1301 Date: _____

LOCATION APPROVED UNDERGROUND STRUCTURES

B.M. 88-16
ELEV. 233.569m



Stantec Consulting Ltd.

905 Waverley Street, Winnipeg, Manitoba
Tel 204-489-5900 Fax 204-453-9012

ENGINEER'S SEAL



**THE CITY OF WINNIPEG
WATER AND WASTE DEPARTMENT**

**2010 SEWER RENEWALS
BY CIPP LINING - CONTRACT I4
GENDREAU AVENUE**

1ST MH E. OF LESTANG ST. TO
MH AT DORGE DR. (W. PL)

SHEET OF
20 26

CAD FILE DRAWING NUMBER
12350c-120-735.dwg

CITY DRAWING NUMBER
9373

DESIGNED BY	J.K.H.	CHECKED BY	W.A.B.
DRAWN BY	J.K.H.	APPROVED BY	C.L.D.
HOR. SCALE:	1:500	RELEASED FOR CONSTRUCTION:	
VERTICAL:	N/A		
NO.	REVISIONS	DATE	BY
		DATE	10.06.21

CONSULTANT DRAWING NO.
C-120