

**SEWER JUNCTION INFORMATION
FOR SEWER ID MA70020973**

REFERENCE—METERS EAST OF MANHOLE MH60019484

DIST. FROM REF. MANHOLE	JUNCTION DIA.	CLOCK REF.	SERVICE TYPE	DESCRIPTION
12.6	150	01	JN	-

ALL JUNCTION INFORMATION
BASED ON CCTV INSPECTION

DES TRAPPISTES STREET

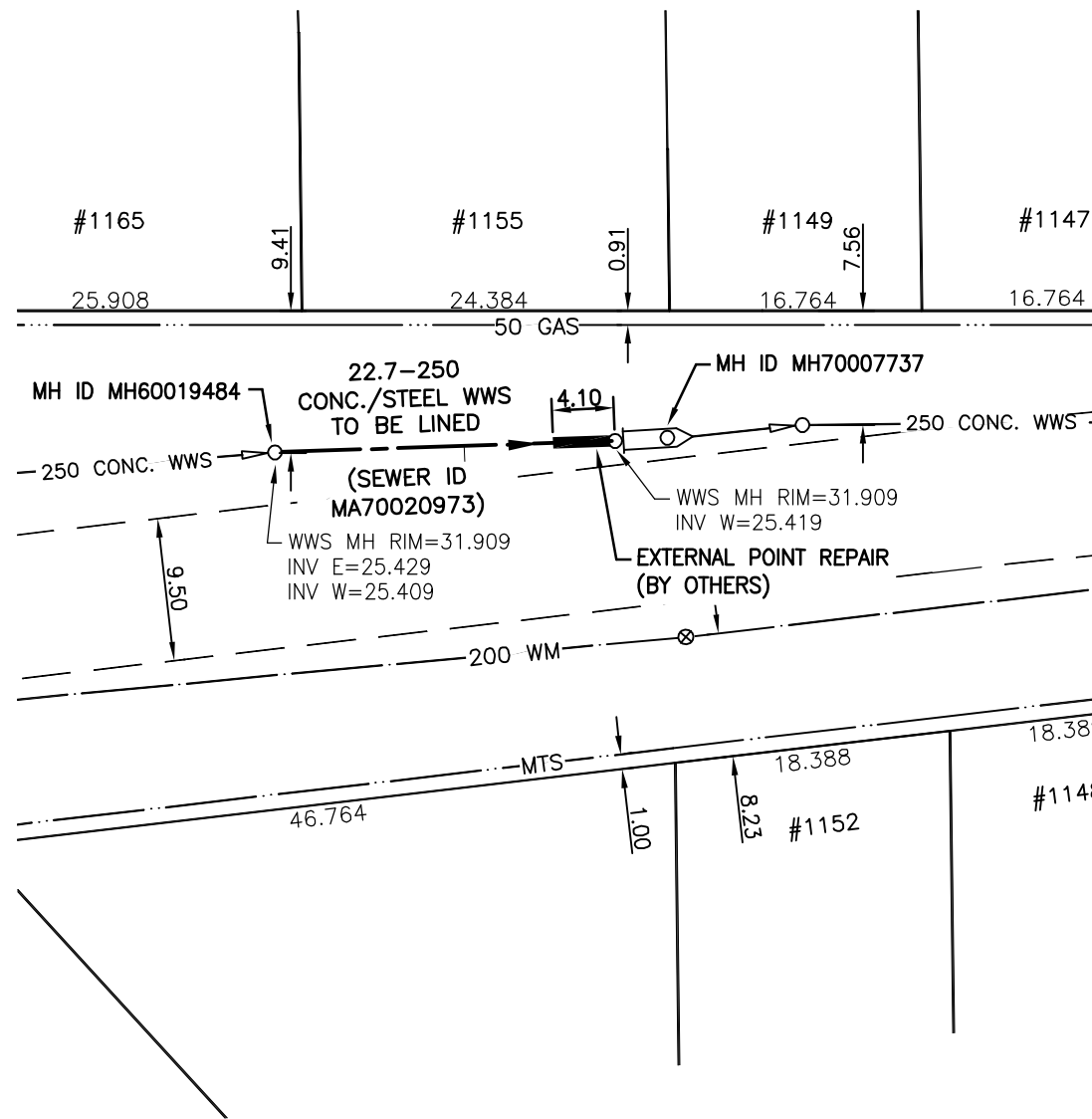
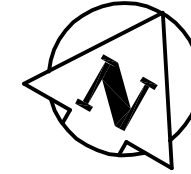

WARNING

IF POWER EQUIPMENT OR EXPLOSIVES ARE TO BE USED FOR EXCAVATION ON THIS PROJECT THE CONTRACTOR MUST:

- 1) NOTIFY THE GAS COMPANY OF THE PROPOSED LOCATION OF EXCAVATION.
- 2) TAKE PRECAUTION TO AVOID DAMAGE TO GAS COMPANY INSTALLATIONS.

SEE PROVINCIAL REGULATION 140/92 FOR DETAILS

METRIC

WHOLE NUMBERS INDICATE MILLIMETRES
DECIMALIZED NUMBERS INDICATE METRES

BENCH MARK: N. side Rue des Trappistes, @ Rue Du Monastere; Tblt. on top of 0.05 m dia. x 2.4 m iron pipe, 23.5 m W. of W. wall & 22.0 m N. of N. wall of attached garage on N. side of No. 2 Rue Du Monastere.

BID OPPORTUNITY 245-2010



Certificate of Authorization

Stantec Consulting Ltd.

No. 1301 Date: _____

LOCATION APPROVED UNDERGROUND STRUCTURES

B.M. 88-29
ELEV. 231.453m



Stantec Consulting Ltd.

905 Waverley Street, Winnipeg, Manitoba
Tel 204-489-5900 Fax 204-453-9012

ENGINEER'S SEAL



THE CITY OF WINNIPEG

WATER AND WASTE DEPARTMENT

**2010 SEWER RENEWALS
BY CIPP LINING - CONTRACT I4
DES TRAPPISTES STREET
1ST MH E. OF DU MONASTERE ST. TO
LIFT SUMP**

SHEET OF
22 26

CAD FILE DRAWING NUMBER
12350c-122-735.dwg

CITY DRAWING NUMBER
9375

DESIGNED BY	J.K.H.	CHECKED BY	W.A.B.
DRAWN BY	J.K.H.	APPROVED BY	C.L.D.
HOR. SCALE:	1:500	RELEASED FOR CONSTRUCTION:	
VERTICAL:	N/A		
NO.	REVISIONS	DATE	BY
		10.06.21	

CONSULTANT DRAWING NO.
C-122

W:\1173\dwg\11733333.dwg (p) 10/22/2010 11:27:11 AM By: dclan