

**SEWER JUNCTION INFORMATION
FOR SEWER ID MA20017821**

REFERENCE—METERS SOUTH OF MANHOLE MH20015961

| DIST. FROM REF. MANHOLE | JUNCTION DIA. | CLOCK REF. | SERVICE TYPE | DESCRIPTION |
|-------------------------|---------------|------------|--------------|-------------|
| 2.3 | 150 | 11 | CN | PLUGGED |

ALL JUNCTION INFORMATION
BASED ON CCTV INSPECTION

NOTRE DAME AVENUE

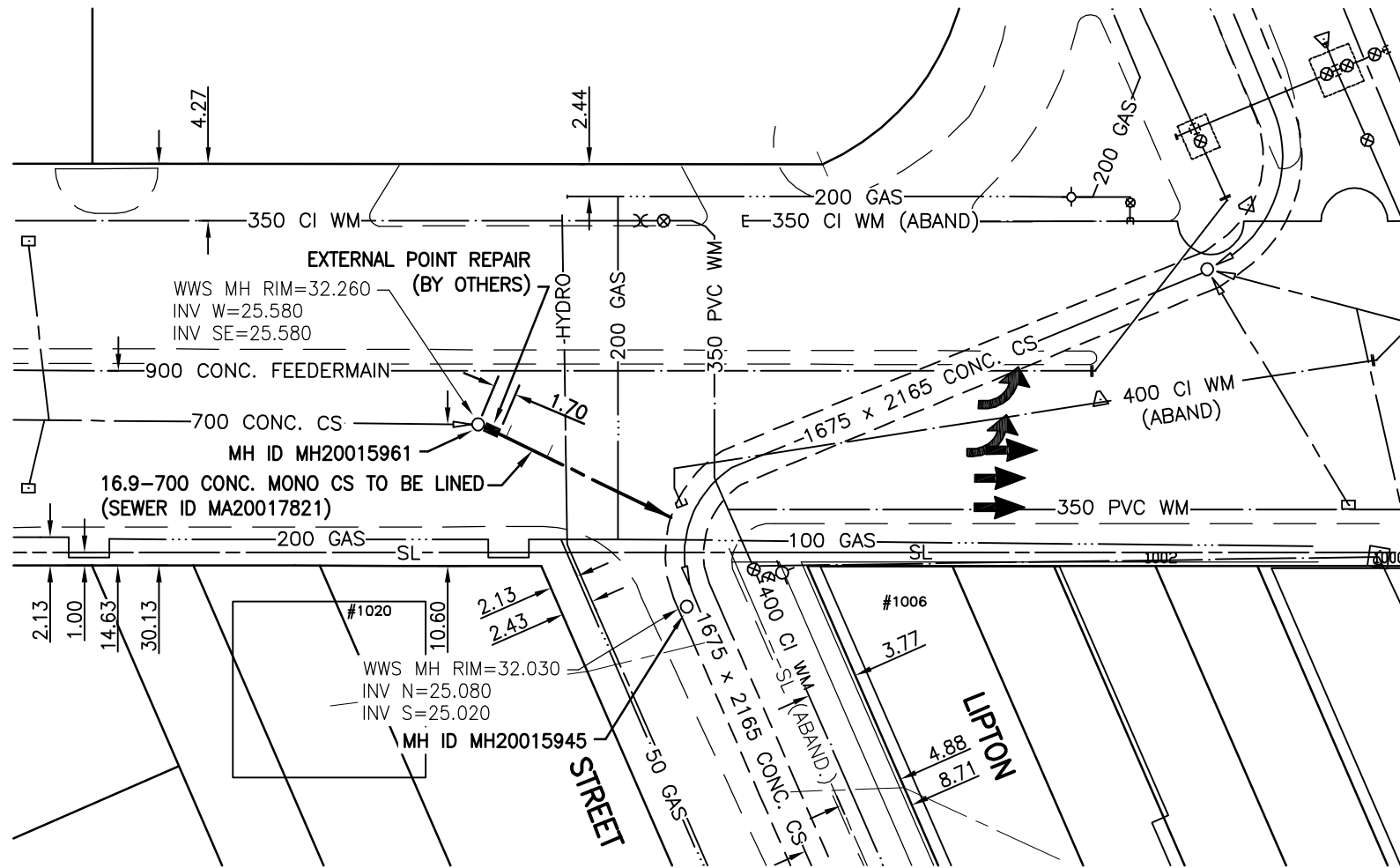
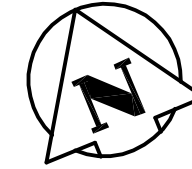

WARNING

IF POWER EQUIPMENT OR EXPLOSIVES ARE TO BE USED FOR EXCAVATION ON THIS PROJECT THE CONTRACTOR MUST:

- 1) NOTIFY THE GAS COMPANY OF THE PROPOSED LOCATION OF EXCAVATION.
 - 2) TAKE PRECAUTION TO AVOID DAMAGE TO GAS COMPANY INSTALLATIONS.
- SEE PROVINCIAL REGULATION 140/92 FOR DETAILS

METRIC

WHOLE NUMBERS INDICATE MILLIMETRES
DECIMALIZED NUMBERS INDICATE METRES

BENCH MARK: 89R609 – N.W. cor. Notre Dame Ave. & McPhillips St. in traffic island, brass plug in 14m conc. pile beneath valve box, 2.7m S. of N.L. of Notre Dame Ave., produced from the W. & 0.3m W. of W.L. McPhillips St. produced from the N.

BID OPPORTUNITY 245-2010



Certificate of Authorization

Stantec Consulting Ltd.

No. 1301 Date: _____

**LOCATION APPROVED
UNDERGROUND STRUCTURES**

B.M. 36-007
ELEV. 232.065m



Stantec Consulting Ltd.

905 Waverley Street, Winnipeg, Manitoba
Tel 204-489-5900 Fax 204-453-9012

ENGINEER'S SEAL

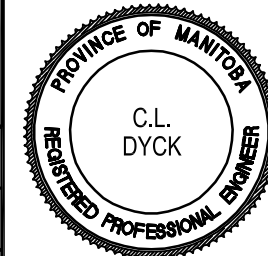

THE CITY OF WINNIPEG

WATER AND WASTE DEPARTMENT

**2010 SEWER RENEWALS
BY CIPP LINING - CONTRACT I4
NOTRE DAME AVENUE**

1ST MH W. OF LIPTON ST. TO
LIPTON ST.

SHEET OF
26 26

CAD FILE DRAWING NUMBER
12350c-126-735.dwg

CITY DRAWING NUMBER
9379

| | | | |
|-------------|-----------|----------------------------|--------|
| DESIGNED BY | J.K.H. | CHECKED BY | W.A.B. |
| DRAWN BY | J.K.H. | APPROVED BY | C.L.D. |
| HOR. SCALE: | 1:500 | RELEASED FOR CONSTRUCTION: | |
| VERTICAL: | N/A | DATE | |
| NO. | REVISIONS | DATE | BY |
| | | 10.06.21 | |

CONSULTANT DRAWING NO.
C-126