

- NOTE:**
- STATION CHAINAGE IS BASED ON CENTRELINE OF CORYDON AVENUE.
 - ADJUST NEW MH AND CB RIMS TO NEW GRADES.
 - PLUG SUBDRAINS AT TERMINAL ENDS.
 - REGRADE EXISTING PRIVATE SIDEWALKS AS REQUIRED.
 - ISOLATE ALL POLES, BASES AND PILES WITHIN BUS STOP SIDEWALK (SD-228C).
 - AVOID DAMAGE TO EXISTING TREES WITHIN THE LIMITS OF CONSTRUCTION.
 - ALL PAVEMENT MEASUREMENTS ARE TO BACK OF CURB WHERE REQUIRED.
 - CONTACT TERASPAN TO LOWER FIBRE OPTIC CABLE WHERE REQUIRED.
 - CONSTRUCT MANHOLE AND CATCH BASIN ISOLATIONS IN ACCORDANCE WITH SD-228C.
 - INSTALL DETECTABLE WARNING SURFACE TILES IN ACCORDANCE WITH SPECIFICATION E17.
 - CAUTION: THE TERASPAN CABLE IS LOCATED ALONG THE ENTIRE LENGTH OF THE PROJECT AND WITHIN 300mm OF THE GROUND/PAVEMENT SURFACE.
 - INSTALL 100mm THICK APPROVED INSULATION BETWEEN NEW CATCH BASINS AND EXISTING 400 AC WATERMAIN. INSTALL INSULATION ACCORDING TO SPECIFICATION E18.
 - INSTALL 100mm THICK INSULATION ACCORDING TO THE ROAD CROSS SECTION FOR THE FULL LENGTH OF RECONSTRUCTION (STA. 1+48.8 TO STA. 3+48.0). INSTALL 3.0m WIDE INSULATION AS CLOSE TO THE SOUTH WALL OF THE ROADWAY EXCAVATION AS POSSIBLE.

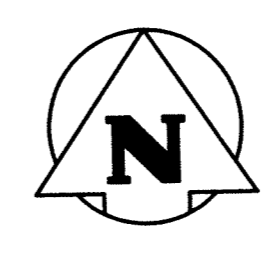

PROPERTY LIMITS DELINEATION
DELINEATION OF PROPERTY LIMITS AS SHOWN ON THIS DWG DOES NOT REPRESENT A "LEGAL SURVEY". KGS GROUP MAKES NO REPRESENTATION OR WARRANTY AS TO THE ACCURACY OF PROPERTY LIMITS DELINEATED ON THIS DWG, NOR ON THE DIMENSIONAL ACCURACY OF DWG FEATURES RELATIVE TO THOSE PROPERTY LIMITS.

WARNING
1. NOTIFY THE GAS COMPANY OF THE PROPOSED LOCATION OF EXCAVATION.
2. TAKE PRECAUTION TO AVOID DAMAGE TO GAS COMPANY INSTALLATIONS.
3. SEE PROVINCIAL REGULATION 210/72 FOR DETAILS.

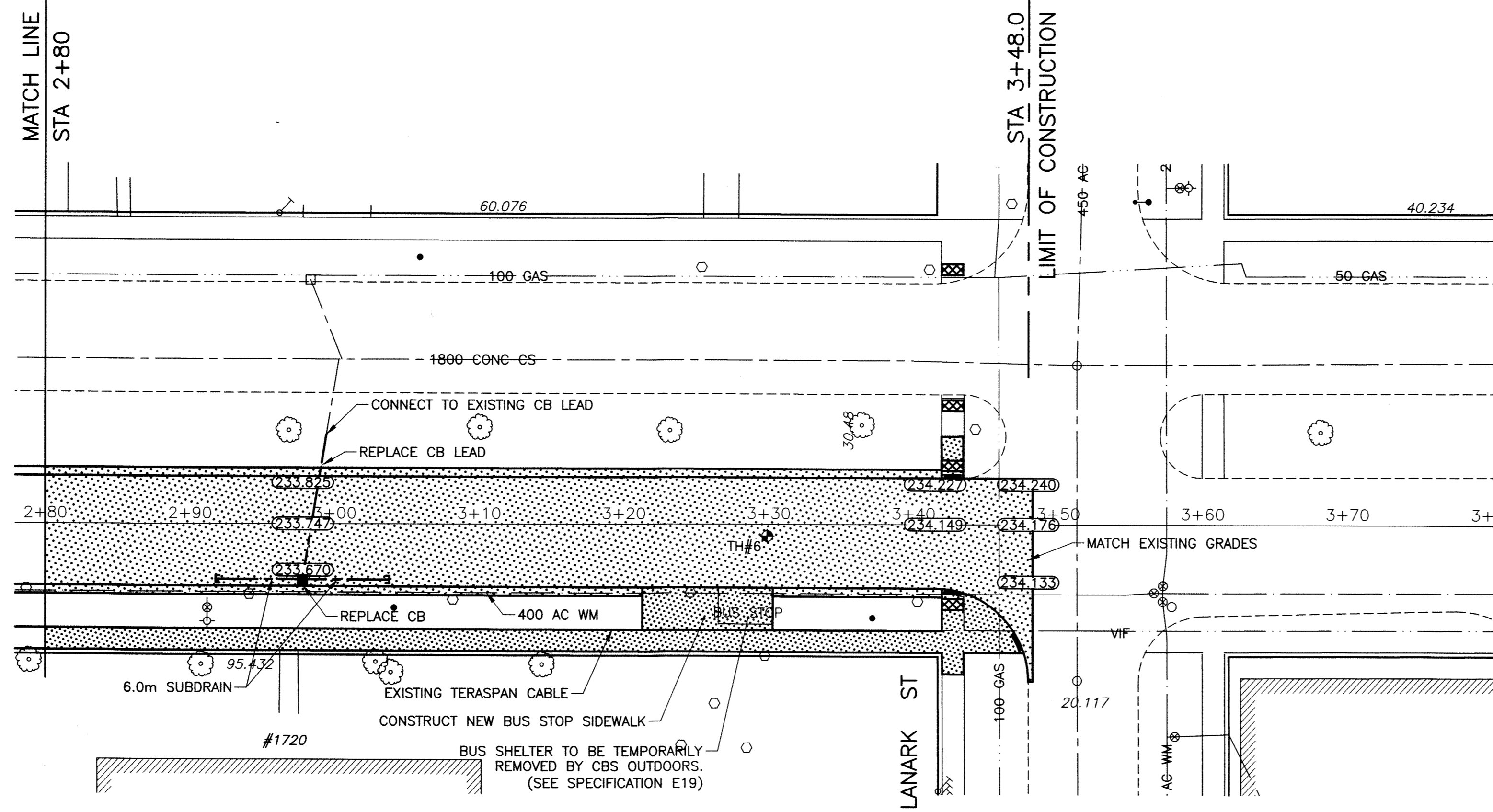
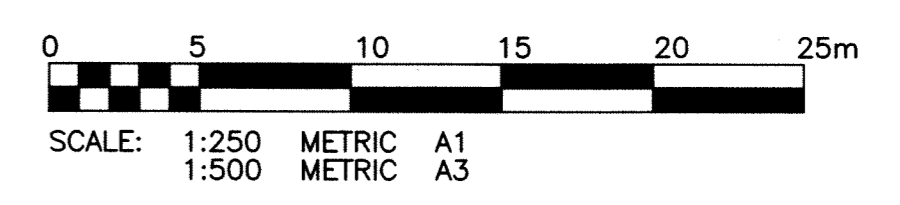
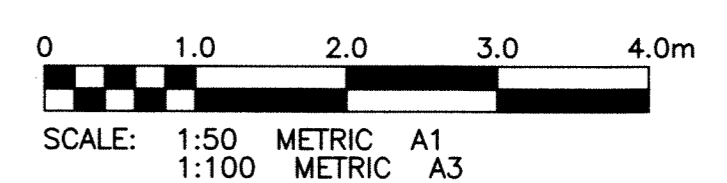

METRIC
WHOLE NUMBERS INDICATE MILLIMETRES
DECIMALIZED NUMBERS INDICATE METRES

APEGN
Certificate of Authorization
KGS Group
No. 245 Date: 10/04/27

300 LBS	LAND DRAINAGE SEWER	300 LBS	BACK OF CURB	CONCRETE	CONCRETE
250 WWS	WASTE WATER SEWER	250 WWS	ASPHALT	ASPHALT	ASPHALT
	GAS		SIDEWALK	SIDEWALK	SIDEWALK
	HYDRO		CURB RAMP	CURB RAMP	CURB RAMP
	M.T.S.		PROPERTY LINE	PROPERTY LINE	PROPERTY LINE
150 WM	WATERMAIN	150 WM	DETECTABLE WARNING TILES	DETECTABLE WARNING TILES	DETECTABLE WARNING TILES
	HYDRANT		TEST HOLE	TEST HOLE	TEST HOLE
	VALVE		GUY WIRE	GUY WIRE	GUY WIRE
	MANHOLE		TREE	TREE	TREE
	CATCH BASIN		SURVEY BAR	SURVEY BAR	SURVEY BAR
	CURB INLET		GEODETIC BENCHMARK	GEODETIC BENCHMARK	GEODETIC BENCHMARK
	LIGHT STANDARD		ELEVATION	ELEVATION	ELEVATION
	POLES				
EXISTING	LEGEND-PLAN	PROPOSED	EXISTING	LEGEND-PLAN	PROPOSED

LOCATION APPROVED UNDERGROUND STRUCTURES
SUPV. U/G STRUCTURES COMMITTEE DATE
NOTE: LOCATION OF UNDERGROUND STRUCTURES AS SHOWN ARE BASED ON THE BEST INFORMATION AVAILABLE BUT NO GUARANTEE IS GIVEN THAT ALL EXISTING UTILITIES ARE SHOWN OR THAT THE GIVEN LOCATIONS ARE EXACT. CONFIRMATION OF EXISTENCE AND EXACT LOCATION OF ALL SERVICES MUST BE OBTAINED FROM THE INDIVIDUAL UTILITIES BEFORE PROCEEDING WITH CONSTRUCTION.

B.M. 51-025	ELEV. 234.791	N.E. CORNER CORYDON AVE & RENFREW ST	TELT. IN W. CONC. FOUNDATION OF RENFREW SHOPPING CENTRE, 1.5m N. 0.2m BELOW BRICK S.W. CORNER BLDG
1	REISSUED FOR TENDER	10/04/27	JDF
0	ISSUED FOR TENDER	10/04/01	JDF
NO.	REVISIONS	DATE	BY

DESIGNED BY	JDF	CHECKED BY	MCR
DRAWN BY	GEL	APPROVED BY	RJH
HOR. SCALE:	1:250	RELEASED FOR CONSTRUCTION:	
VERTICAL:	1:50	DATE	10/03/08

ENGINEER'S SEAL
THE ORIGINAL ISSUE REV. 0 WAS STAMPED, DATED AND SIGNED BY
J.D. FRIESEN, P.ENG.
ON 10/04/05
CONSULTANT DRAWING NO.
09-0107-23_C03

THE CITY OF WINNIPEG
PUBLIC WORKS DEPARTMENT
TRANSPORTATION ENGINEERING DIVISION
CORYDON AVENUE EASTBOUND
PAVEMENT RECONSTRUCTION & REHABILITATION
BEAVERBROOK ST. TO LANARK ST.
STA. 2+80 TO STA. 3+48.0

SHEET OF
03 OF 03
COMPUTER FILE NAME
09-0107-23_CALL
CITY DRAWING NUMBER
P-3320-03

P:\Projects\2008\09-0107-23\Doc Control\Tobias\DWG\09-0107-23_C03-REV 1.dwg - Tab: C03 Plotted By: Dderoché 04/28/2010 [Mon 2:46pm]