

**ALLEY PAVEMENT PROFILE**  
SCALE: 1:250 HOR  
1:10 VER

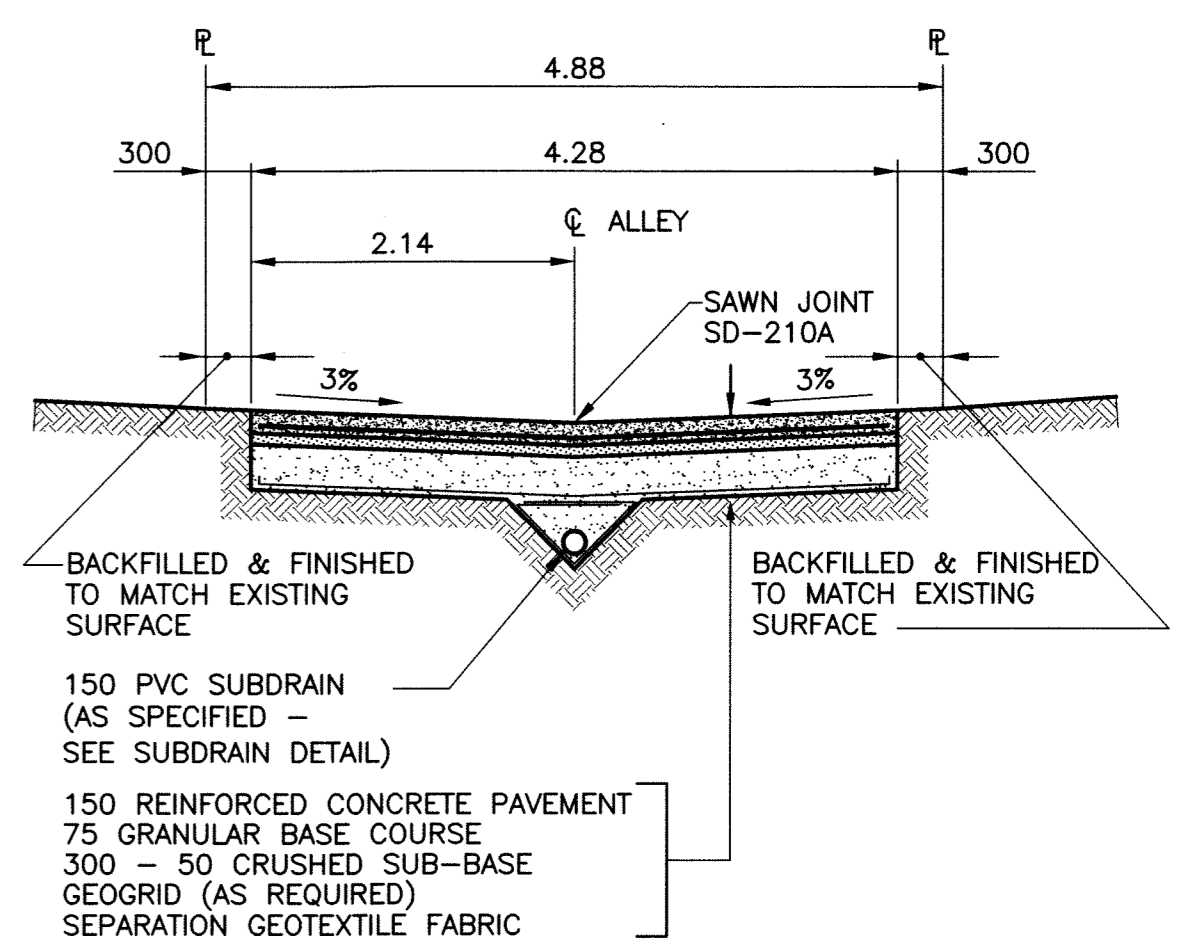

**TYPICAL CROSS SECTION**  
SCALE: 1:50

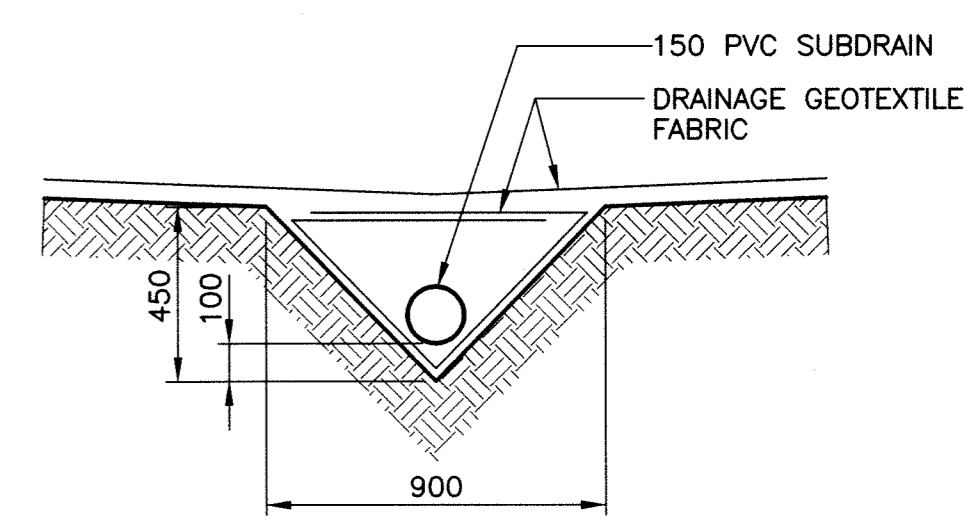

**SUBDRAIN DETAIL**  
SCALE: 1:20

- NOTE:**
1. STATION CHAINAGE IS BASED ON CENTERLINE OF ALLEY RIGHT OF WAY.
  2. ADJUST MH AND CB RIMS TO NEW GRADES.
  3. PLUG SUBDRAINS AT TERMINAL ENDS.
  4. REGRADE EXISTING PRIVATE SIDEWALKS AS REQUIRED.
  5. INSTALLATION OF LIP CURBS AND THEIR EXTENTS TO BE DETERMINED BY THE CONTRACT ADMINISTRATOR.
  6. LIGHT STANDARDS, HYDRO POLES AND ANCHORS MAY REQUIRE TEMPORARY SUPPORT/REMOVAL OR REPLACEMENT AT THE CONTRACTOR'S EXPENSE.
  7. ISOLATE ALL POLES, BASES AND PILES WITHIN ALLEY RIGHT OF WAY (SD-228C)
  8. AVOID DAMAGE TO EXISTING TREES WITHIN THE LIMITS OF CONSTRUCTION.

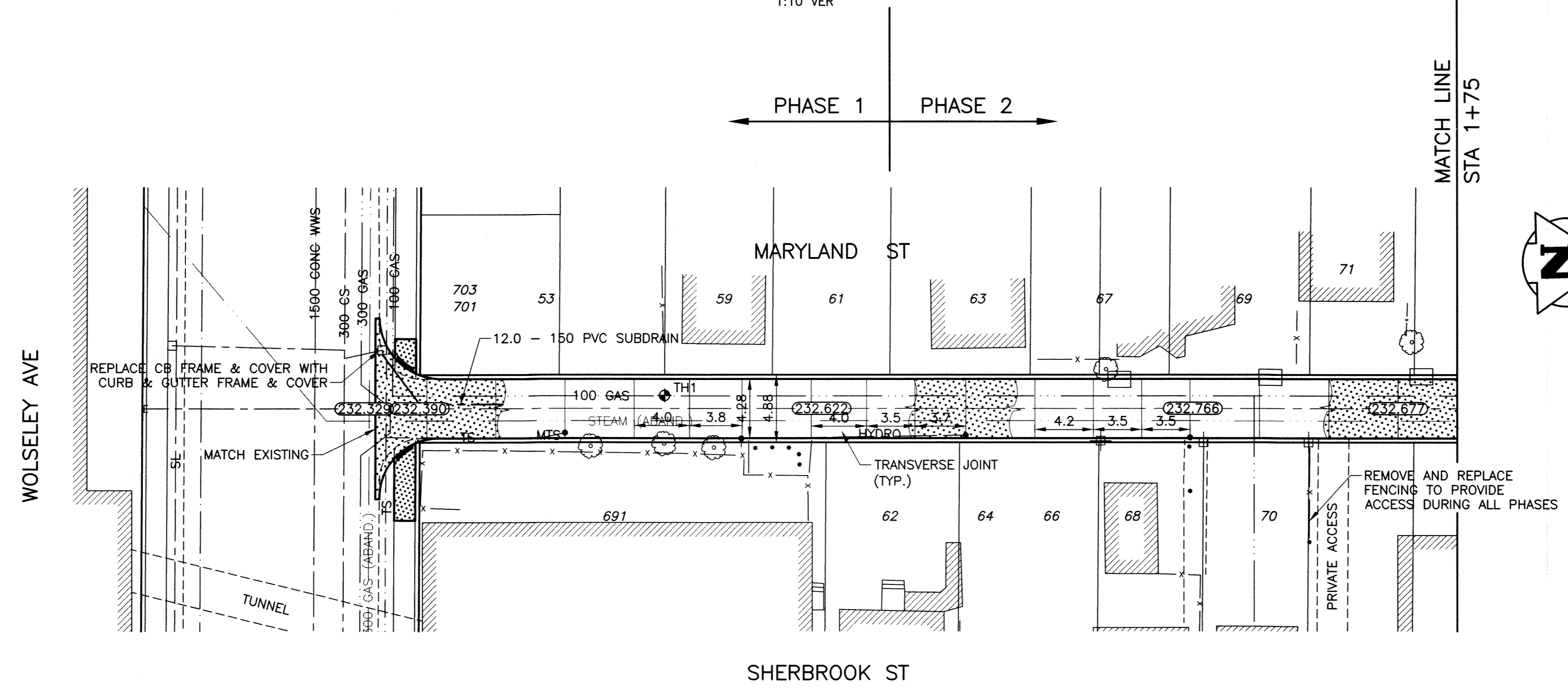

**ALLEY PAVEMENT PLAN**  
SCALE: 1:250 HOR

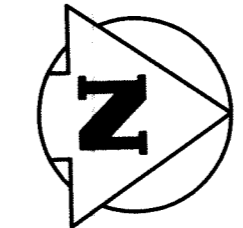

**PROPERTY LIMITS DELINEATION**

DELINEATION OF PROPERTY LIMITS AS SHOWN ON THIS DWG DOES NOT REPRESENT A "LEGAL SURVEY". KGS GROUP MAKES NO REPRESENTATION OR WARRANTY AS TO THE ACCURACY OF PROPERTY LIMITS DELINEATED ON THIS DWG, NOR ON THE DIMENSIONAL ACCURACY OF DWG FEATURES RELATIVE TO THOSE PROPERTY LIMITS.

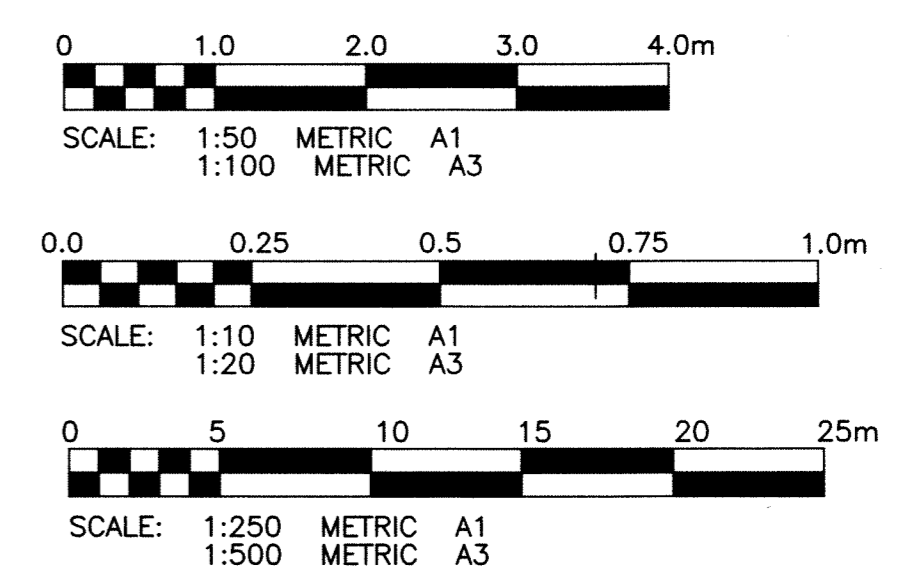

**WARNING**

1. NOTIFY THE GAS COMPANY OF THE PROPOSED LOCATION OF EXCAVATION.
2. TAKE PRECAUTION TO AVOID DAMAGE TO GAS COMPANY INSTALLATIONS.
3. SEE PROVINCIAL REGULATION 210/72 FOR DETAILS.

**METRIC**

WHOLE NUMBERS INDICATE MILLIMETRES  
DECIMALIZED NUMBERS INDICATE METRES

**APCGM**  
Certificate of Authorization  
KGS Group  
No. 245 Date: 10/01/06

P:\Projects\2009\09-0107-20\Drawings\DWG\09-0107-20\_0013-REV 0.dwg - Tab: 13 Plotted By: DBenoche 04/20/2010 [Tue 3:41pm]

300 L.D.S.	LAND DRAINAGE SEWER	300 L.D.S.	+	TEST HOLE			
250 WWS	WASTE WATER SEWER	250 WWS	+	GUY WIRE			
	GAS		+	LIGHT STANDARD			
	HYDRO		+	BACK OF CURB			
	M.T.S.		+	CONCRETE			
150 WM	WATERMAIN	150 WM	+	ASPHALT			
	HYDRANT		+	SIDEWALK			
	VALVE		+	RAMP CURB			
	MANHOLE		+	PROPERTY LINE			
	CATCH BASIN		+	SURVEY BAR			
	CURB INLET		+	GEODETIC BENCHMARK			
	POLES		+	ELEVATION			
EXISTING	LEGEND-PLAN	PROPOSED		EXISTING	LEGEND-PROFILE	PROPOSED	

**LOCATION APPROVED UNDERGROUND STRUCTURES**

SUPV. U/G STRUCTURES COMMITTEE DATE

**NOTE:**  
LOCATION OF UNDERGROUND STRUCTURES AS SHOWN ARE BASED ON THE BEST INFORMATION AVAILABLE BUT NO GUARANTEE IS GIVEN THAT ALL EXISTING UTILITIES ARE SHOWN OR THAT THE GIVEN LOCATIONS ARE EXACT. CONFIRMATION OF EXISTENCE AND EXACT LOCATION OF ALL SERVICES MUST BE OBTAINED FROM THE INDIVIDUAL UTILITIES BEFORE PROCEEDING WITH CONSTRUCTION.

B.M. 37-054 ELEV. 232.706	S.W. CORNER MARYLAND ST. & PURCELL AVE. T.B.L. IN N. CONC. FOUNDATION NO. 120 MARYLAND ST., 5m E. & 0.1m BELOW TYPICAL STONE OF N.W. CORNER OF BUILDING
ISSUED FOR TENDER	10/04/21
REVISIONS	DATE BY

<b>KGS GROUP</b> CONSULTING ENGINEERS	
DESIGNED BY: RBO	CHECKED BY: CR
DRAWN BY: GEL	APPROVED BY: [Signature]
HOR. SCALE: 1:250	RELEASED FOR CONSTRUCTION:
VERTICAL: 1:50	DATE
10/02/03	

ENGINEER'S SEAL

PROVINCE OF MANITOBA  
REGISTERED  
R.B. OFFMAN  
Member  
24701  
Professional Engineer

CONSULTANT DRAWING NO.  
09-0107-20\_C13

**THE CITY OF WINNIPEG**  
PUBLIC WORKS DEPARTMENT  
TRANSPORTATION ENGINEERING DIVISION

PROJECT TITLE  
**2010 ALLEY & LOCAL STREET RENEWALS**

MARYLAND ST./SHERBROOK ST. ALLEY  
WOLSELEY AVE. TO WESTMINSTER AVE.  
WOLSELEY AVE. TO STA. 1+75

SHEET 13 OF 18  
COMPUTER FILE NAME  
MARYLAND-SHERBROOK SOUTH-PLT  
CITY DRAWING NUMBER  
0013