

F:\Projects\2009\09-0107-21\Drawn\Win\AT.dwg\WUP-PL01.dwg - Tab: 15 Plotted By: Gloenen 04/30/2010 [Fri 8:55am]

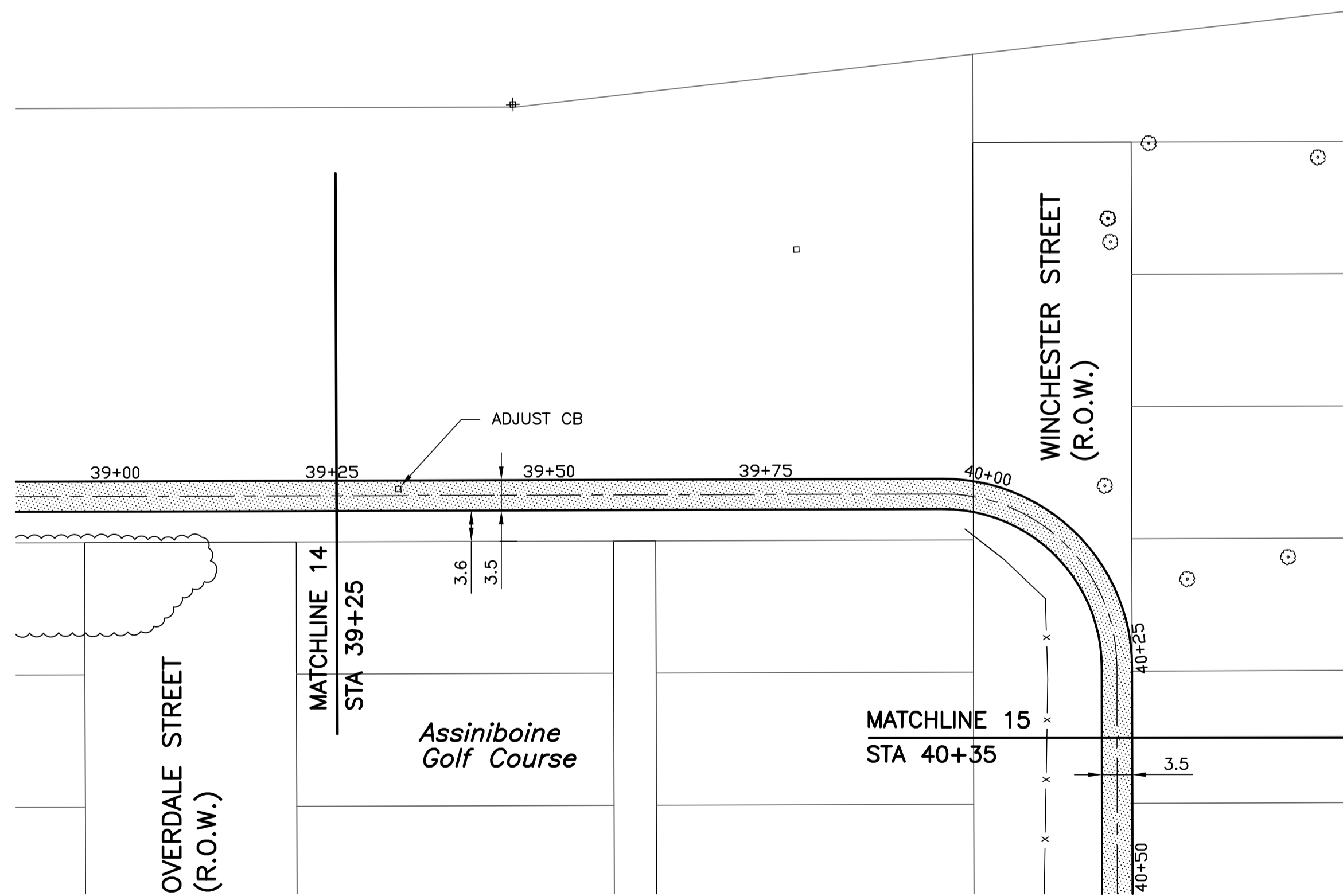
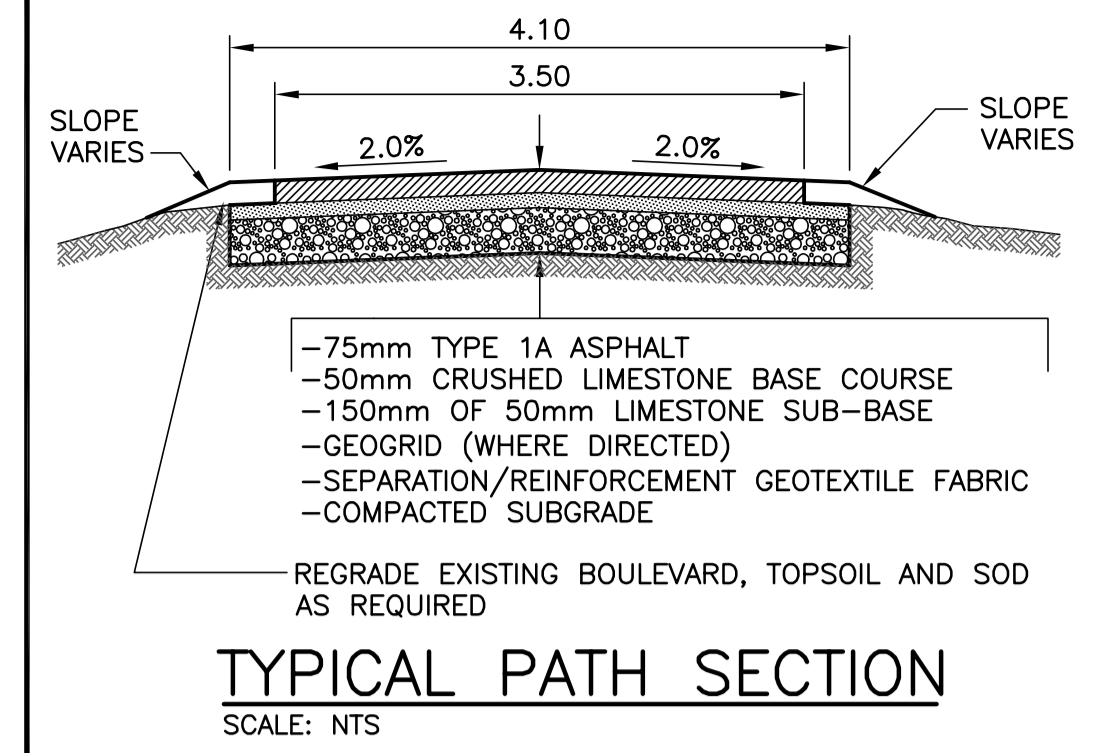
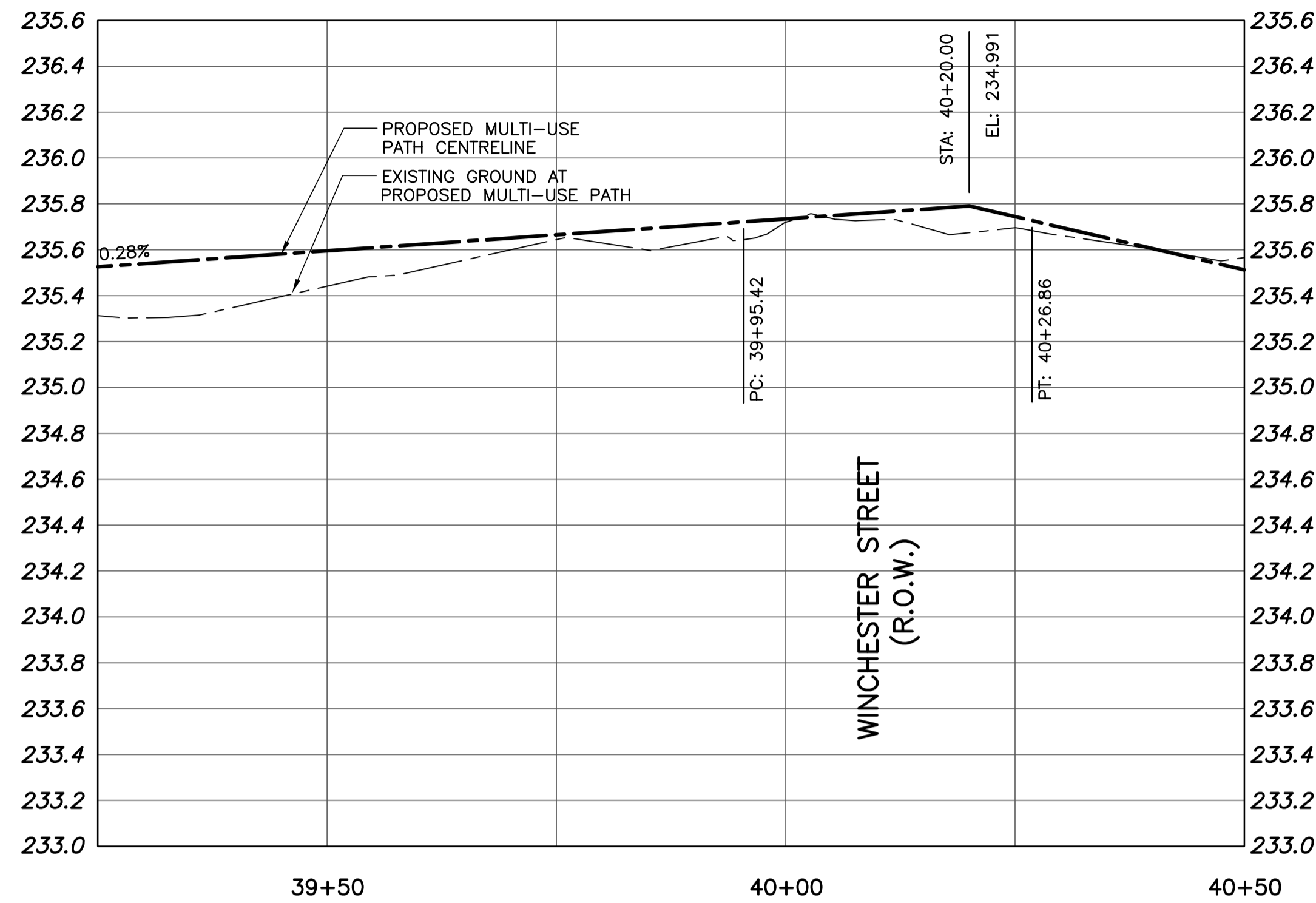
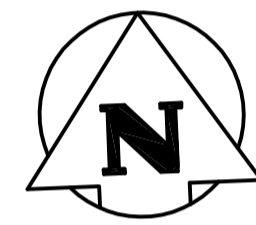

PROPERTY LIMITS DELINEATION

DELINEATION OF PROPERTY LIMITS AS SHOWN ON THIS DWG DOES NOT REPRESENT A "LEGAL SURVEY". KGS GROUP MAKES NO REPRESENTATION OR WARRANTY AS TO THE ACCURACY OF PROPERTY LIMITS DELINEATED ON THIS DWG, NOR ON THE DIMENSIONAL ACCURACY OF DWG FEATURES RELATIVE TO THOSE PROPERTY LIMITS.

METRIC

WHOLE NUMBERS INDICATE MILLIMETRES
DECIMALIZED NUMBERS INDICATE METRES

APEGM
Certificate of Authorization
KGS Group
No. 245 Date: 10/05/03

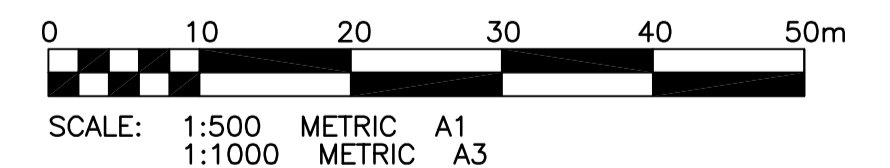

150 WM	WATERMAIN	150 WM	HYDRO	150 WM	WATERMAIN	150 WM
Hydrant	HYDRANT	Hydrant	M.T.S.	Hydrant	HYDRANT, VALVE	Hydrant
Valve	VALVE	Valve	CONCRETE	300 LDS	LAND DRAINAGE SEWER	300 LDS
300 LDS	LAND DRAINAGE SEWER	300 LDS	ASPHALT	250 WWS	WASTE WATER SEWER	250 WWS
250 WWS	WASTE WATER SEWER	250 WWS	SIDEWALK	Q. PROFILE		
Manhole	MANHOLE	Manhole	KGS TEST HOLE		NORTH/WEST GUTTER	
Catch Basin	CATCH BASIN	Catch Basin	PROPERTY LINE		SOUTH/EAST GUTTER	
Curb Inlet	CURB INLET	Curb Inlet	SURVEY BAR		N/W, S/E R'S	
Junctions	JUNCTIONS	Junctions	DITCH		N/W, S/E TOP/CURB	
Culvert	CULVERT	Culvert	ELEVATION	(32.231)	NORTH/WEST DITCH	
Gas	GAS	Gas			SOUTH/EAST DITCH	
EXISTING	LEGEND-PLAN	PROPOSED	EXISTING	LEGEND-PLAN	PROPOSED	EXISTING

LOCATION APPROVED UNDERGROUND STRUCTURES

SUPV. U/G STRUCTURES COMMITTEE DATE

NOTE:
LOCATION OF UNDERGROUND STRUCTURES AS SHOWN ARE BASED ON THE BEST INFORMATION AVAILABLE BUT NO GUARANTEE IS GIVEN THAT ALL EXISTING UTILITIES ARE SHOWN OR THAT THE GIVEN LOCATIONS ARE EXACT. CONFIRMATION OF EXISTENCE AND EXACT LOCATION OF ALL SERVICES MUST BE OBTAINED FROM THE INDIVIDUAL UTILITIES BEFORE PROCEEDING WITH CONSTRUCTION.

B.M. 38-026 W. side Winchester St., S. of Silver Ave., 19mm dia. I.B. in Valve Box, 1.5m N. of N. wall & 1.3m E. of E. wall No. 468 Winchester St., or 2.0m E. of W.L. of Winchester St. & 32.6m S. of the S.L. of Silver Ave.
ELEV. 233.879m

NO.	REVISIONS	DATE	BY
0	ISSUED FOR TENDER	10/05/03	

KGS GROUP CONSULTING ENGINEERS
SCATLIFF+MILLER+MURRAY Inc.
TEL: 204.781.0444 FAX: 204.781.0443 1-888-WINNIPEG WINNIPEG, MB CANADA

DESIGNED BY	CR	CHECKED BY	
DRAWN BY	DMW	APPROVED BY	
HOR. SCALE:	1:500	RELEASED FOR CONSTRUCTION:	
VERTICAL:	1:50	DATE	09/12/16

ENGINEER'S SEAL
PROVINCE OF MANITOBA
M.C. ROWBOTHAM
Member 22679
REGISTERED PROFESSIONAL ENGINEER

THE CITY OF WINNIPEG PUBLIC WORKS DEPARTMENT

PROJECT TITLE
2010 ACTIVE TRANSPORTATION / INFRASTRUCTURE STIMULUS PROGRAM

SILVER AVE. - AIR FORCE WAY TO FERRY RD.
STA. 39+25 TO STA. 40+35

CONSULTANT DRAWING NO.
09-0107-21_C15

SHEET OF
15 OF **35**

COMPUTER FILE NAME
09-0107-21

CITY DRAWING NUMBER
15