

PROFILE
SCALE: 1:100 HOR

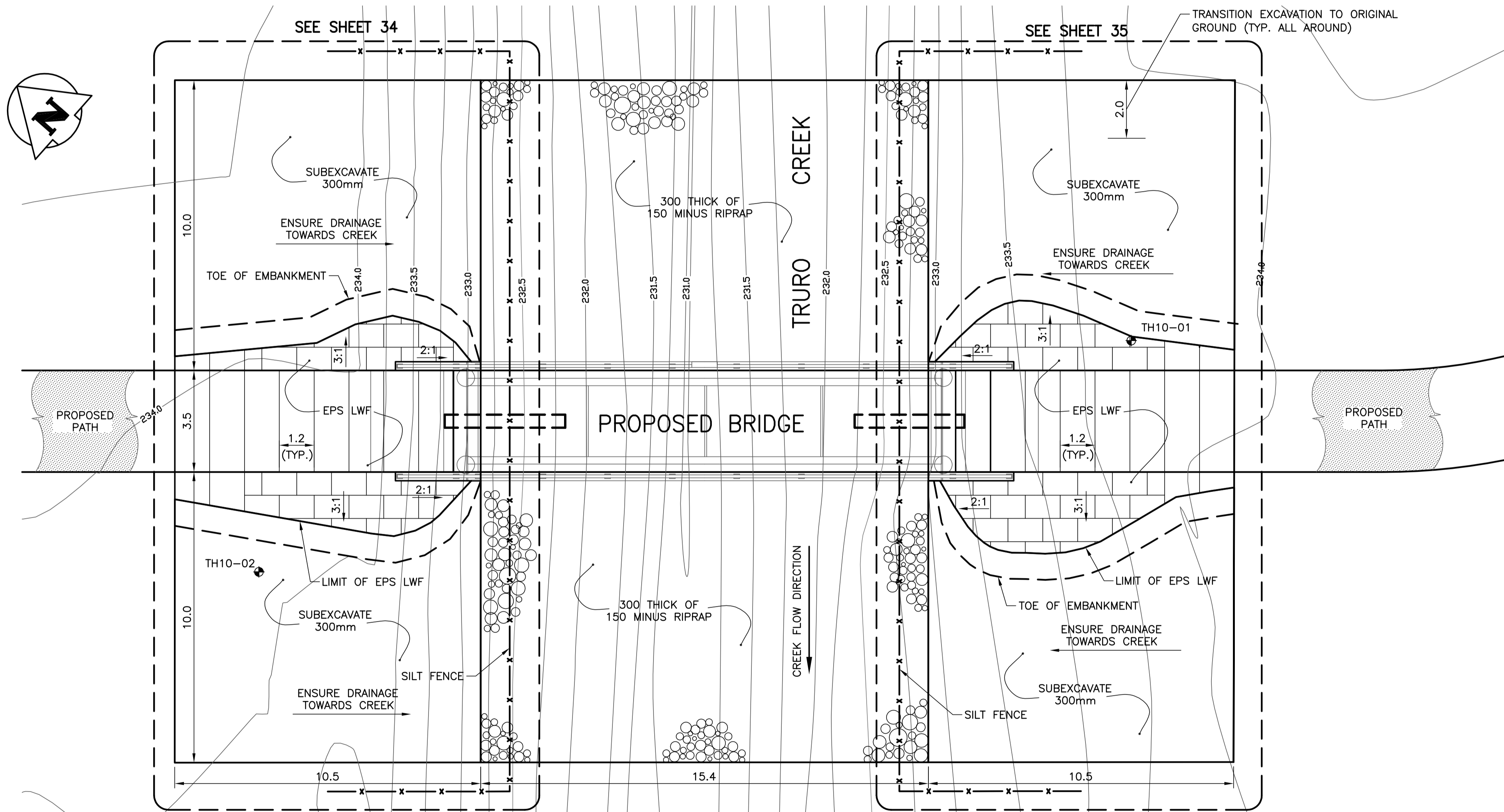

PLAN
SCALE: 1:100 HOR

NOTES

1. EPS LWF - EXPANDED POLYSTYRENE LIGHTWEIGHT FILL.
2. PLACE TOPSOIL & SEED ON ALL EXCAVATED AREAS AND EMBANKMENT SLOPES.
3. ALL EPS LWF SHALL BE AASHTO DESIGNATION EPS100. EPS LWF MATERIALS SHALL CONFORM TO ASTM C578 TESTING SPECIFICATIONS.
4. EXCAVATION CONSTRUCTION SEQUENCE SHALL COMMENCE AT THE TOP OF THE BANK AND PROCEED DOWNSLOPE FOR BOTH BANKS.
5. WHERE POSSIBLE, THE LONGEST DIMENSION OF THE EPS LWF WILL BE PLACED PERPENDICULAR TO THE DIRECTION OF THE PATHWAY.
6. EPS LWF BLOCKS SHALL HAVE A MINIMUM COVER OF 600mm INCLUDING PAVEMENT.
7. NO MATERIAL SHALL BE STOCKPILED WITHIN 50m OF THE TOP OF THE BANK.
8. THE SMALLEST DIMENSIONS OF THE EPS LWF BLOCKS SHALL BE 0.2m THICK BY 1.2m WIDE. EPS LWF BLOCK SHALL HAVE A MINIMUM LENGTH OF 2.44m.
9. PUMP OUT EXCAVATION AS NECESSARY TO ENSURE THAT EXCAVATED FOUNDATION FOR EPS LWF IS DRY AND ABSENT OF STANDING WATER.
10. PLACE NON-WOVEN GEOTEXTILE UNDER EPS SAND BEDDING AND RIPRAP.
11. CONSTRUCT FRENCH DRAIN IN ACCORDANCE WITH CW 3120. OMIT DRAINAGE PIPE.

PROPERTY LIMITS DELINEATION

DELINEATION OF PROPERTY LIMITS AS SHOWN ON THIS DWG DOES NOT REPRESENT A "LEGAL SURVEY". KGS GROUP MAKES NO REPRESENTATION OR WARRANTY AS TO THE ACCURACY OF PROPERTY LIMITS DELINEATED ON THIS DWG, NOR ON THE DIMENSIONAL ACCURACY OF DWG FEATURES RELATIVE TO THOSE PROPERTY LIMITS.

WARNING

1. NOTIFY THE GAS COMPANY OF THE PROPOSED LOCATION OF EXCAVATION.
2. TAKE PRECAUTION TO AVOID DAMAGE TO GAS COMPANY INSTALLATIONS.
3. SEE PROVINCIAL REGULATION 210/72 FOR DETAILS.

METRIC

WHOLE NUMBERS INDICATE MILLIMETRES
DECIMALIZED NUMBERS INDICATE METRES

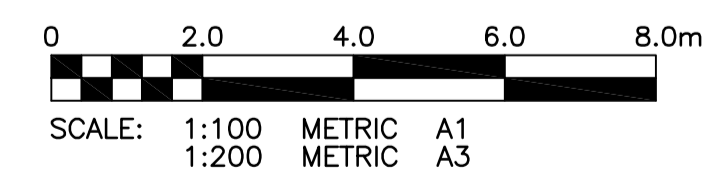

Certificate of Authorization
KGS Group

No. 245 Date: _____

P:\Projects\2009_09-0107-21\DWG\Mun_09-0107-21_CALL.dwg - Tab: C33 Plotted By: Gloewen 05/04/2010 [Tue 8:42am]

150 WM	WATERMAIN	150 WM	HYDRO	150 WM	WATERMAIN	150 WM	WATERMAIN
HYDRANT	HYDRANT	HYDRANT	M.T.S.	CONCRETE	ASPHALT	LAND DRAINAGE SEWER	LAND DRAINAGE SEWER
VALVE	VALVE	VALVE	CONCRETE	ASPHALT	LAND DRAINAGE SEWER	LAND DRAINAGE SEWER	LAND DRAINAGE SEWER
300 LDS	LAND DRAINAGE SEWER	300 LDS	ASPHALT	LAND DRAINAGE SEWER	LAND DRAINAGE SEWER	LAND DRAINAGE SEWER	LAND DRAINAGE SEWER
250 WWS	WASTE WATER SEWER	250 WWS	WASTE WATER SEWER	WASTE WATER SEWER	WASTE WATER SEWER	WASTE WATER SEWER	WASTE WATER SEWER
MANHOLE	MANHOLE	MANHOLE	KGS TEST HOLE	PROPERTY LINE	SURVEY BAR	DITCH	ELEVATION
CATCH BASIN	CATCH BASIN	CATCH BASIN	PROPERTY LINE	SURVEY BAR	DITCH	ELEVATION	ELEVATION
CURB INLET	CURB INLET	CURB INLET	SURVEY BAR	DITCH	ELEVATION	ELEVATION	ELEVATION
JUNCTIONS	JUNCTIONS	JUNCTIONS	DITCH	ELEVATION	ELEVATION	ELEVATION	ELEVATION
CULVERT	CULVERT	CULVERT	ELEVATION	ELEVATION	ELEVATION	ELEVATION	ELEVATION
GAS	GAS	GAS	ELEVATION	ELEVATION	ELEVATION	ELEVATION	ELEVATION
EXISTING	LEGEND-PLAN	PROPOSED	EXISTING	LEGEND-PLAN	PROPOSED	EXISTING	LEGEND-PROFILE

LOCATION APPROVED UNDERGROUND STRUCTURES

SUPV. U/G STRUCTURES COMMITTEE DATE

NOTE:
LOCATION OF UNDERGROUND STRUCTURES AS SHOWN ARE BASED ON THE BEST INFORMATION AVAILABLE BUT NO GUARANTEE IS GIVEN THAT ALL EXISTING UTILITIES ARE SHOWN OR THAT THE GIVEN LOCATIONS ARE EXACT. CONFIRMATION OF EXISTENCE AND EXACT LOCATION OF ALL SERVICES MUST BE OBTAINED FROM THE INDIVIDUAL UTILITIES BEFORE PROCEEDING WITH CONSTRUCTION.

B.M. 39-032	S.W. Cor. Moray St. & Silver Ave., Tblt. in N. Conc. foundation No. 65 Moray Village, 3m W. & 0.1m below brick of N.E. Cor. of apartment unit.
ELEV. 238.871m	
0	ISSUED FOR TENDER 10/05/03
NO. REVISIONS	DATE BY

KGS GROUP CONSULTING ENGINEERS	SCATLIFF+MILLER+MURRAY Inc. TEL: 204-942-0444 FAX: 204-942-0443 210 W. WILSON ST. WINNIPEG, MB. CANADA
DESIGNED BY: JDF	CHECKED BY:
DRAWN BY: GEL	APPROVED BY:
HOR. SCALE: 1:100	RELEASED FOR CONSTRUCTION:
VERTICAL: 1:100	DATE: 10/04/06

ENGINEER'S SEAL

PROVINCE OF MANITOBA
J.D. FRIESEN
Member
23875
REGISTERED PROFESSIONAL ENGINEER

CONSULTANT DRAWING NO.
09-0107-21_C33

THE CITY OF WINNIPEG PUBLIC WORKS DEPARTMENT	PROJECT TITLE 2010 ACTIVE TRANSPORTATION / INFRASTRUCTURE STIMULUS PROGRAM	SHEET OF 33 OF 35
	TRURO CREEK BRIDGE BANK STABILIZATION	COMPUTER FILE NAME 09-0107-21_CALL
		CITY DRAWING NUMBER 33