

**PLANT LIST**

KEY	QTY.	COMMON NAME/BOTANICAL NAME	SIZE	REMARKS
<b>DECIDUOUS TREES</b>				
A	16	AMERICAN ELM / ULMUS AMERICANA	75mm cal.	SPECIMEN, W.B. MACHINE DUG WITH MIN. 10 BRANCHES IN WELL BRANCHED HEAD, STRAIGHT TRUNK, MIN. HT. 4.5m, BRANCHING HT. 1.8m.
B	5	TOBA HAWTHORN / CRATAEGUS X MORDENENSIS 'TOBA'	75mm cal.	SPECIMEN, W.B. MACHINE DUG WITH MIN. 10 BRANCHES IN WELL BRANCHED HEAD, STRAIGHT TRUNK, MIN. HT. 4.5m, BRANCHING HT. 1.8m.
<b>CONIFEROUS TREES</b>				
C	0	WHITE SPRUCE / PICEA GLAUCA	1.8m ht.	SPECIMEN, W.B. MACHINE DUG WITH SINGLE UPRIGHT LEADER, STRAIGHT TRUNK, WELL BRANCHED, FULL FORM.
D	3	COLORADO SPRUCE / PICEA PUNGENS	1.8m ht.	SPECIMEN, W.B. MACHINE DUG WITH SINGLE UPRIGHT LEADER, STRAIGHT TRUNK, WELL BRANCHED, FULL FORM.
<b>DECIDUOUS SHRUBS</b>				
E	51	SNOWMOUND SPIREA / SPIRAEA NIPPONICA 'SNOWMOUND'	2 gal pot.	SPECIMEN, CONTAINER GROWN, WITH MINIMUM 3 STALKS IN WELL BRANCHED PLANT, MINIMUM 500mm HEIGHT.
F	18	IVORY HALO DOGWOOD / CORNUS ALBA 'IVORY HALO'	5 gal pot.	SPECIMEN, CONTAINER GROWN, WITH MINIMUM 3 STALKS IN WELL BRANCHED PLANT, MINIMUM 1.2m HEIGHT.
G	34	ADELAIDE HOODLESS ROSE / ROSA 'ADELAIDE HOODLESS'	2 gal pot.	SPECIMEN, CONTAINER GROWN, WITH MINIMUM 3 STALKS IN WELL BRANCHED PLANT, MINIMUM 500mm HEIGHT.
<b>CONIFEROUS SHRUBS</b>				
H	49	BLUE DANUBE JUNIPER / JUNIPERUS SABINA 'BLUE DANUBE'	5 gal pot.	SPECIMEN, CONTAINER GROWN, WITH MINIMUM 3 STALKS IN WELL BRANCHED PLANT, MINIMUM 750mm SPREAD.
<b>VINES</b>				
J	164	VIRGINIA CREEPER / PARTHENOICISSUS QUINQUEFOLIA	2 gal pot.	SPECIMEN, CONTAINER GROWN, WITH MINIMUM 3 STALKS IN WELL BRANCHED PLANT.

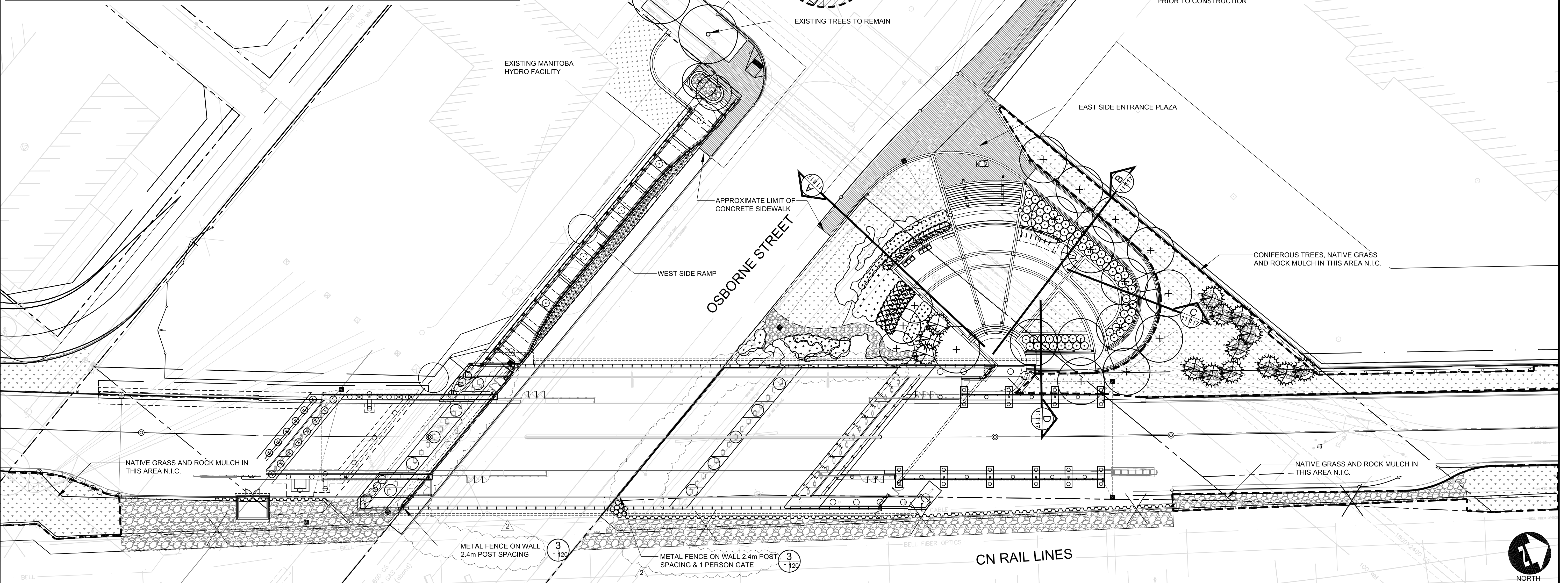

<p><b>LEGEND</b></p> <ul style="list-style-type: none"> <li> NATIVE GRASSES</li> <li> MULCH BED</li> <li> CONCRETE SIDEWALK</li> <li> EXISTING TREES TO REMAIN</li> <li> PROPOSED DECIDUOUS TREE</li> <li> PROPOSED CONIFEROUS TREE</li> <li> EXISTING DECIDUOUS TREE TO BE REMOVED</li> <li> EXISTING CONIFEROUS TREE TO BE REMOVED</li> <li> PROPOSED SHRUBS</li> </ul>	<p><b>PLANT KEY</b></p> <p>QUANTITY PLANT KEY</p>
---	---

NO.	REVISIONS	DATE	BY
1	ISSUED FOR TENDER	10/05/14	JW
2	ISSUED FOR ADDENDUM #2	10/06/11	JW

DESIGNED BY	SR/JW
DRAWN BY	JW/TM
CHECKED BY	JW/SR
APPROVED BY	
HOR. SCALE	1:250
VERTICAL	
DATE	2010-05-07

LANDSCAPE ARCHITECT'S SEAL

ORIGINAL SIGNED BY JACKIE WILKIE

JACQUELINE L. WILKIE member no. 75

CONSULTANT PROJECT NO. 08-028

<p><b>THE CITY OF WINNIPEG</b> TRANSIT DEPARTMENT</p> <p>SOUTHWEST RAPID TRANSIT CORRIDOR - STAGE 1 OSBORNE STATION AND ASSOCIATED WORKS</p> <p>LANDSCAPE WORKS OVERALL PLAN</p>	<p>CITY DRAWING NUMBER B237-10-111</p> <p>SHEET OF 111 121</p> <p>CONSULTANT DRAWING NUMBER C5-L-5000-T-R1</p>
--	--

X:\08-028 Southwestern BRT Corridor\dwg\2010\osborne station\wkg\osborne LANDSCAPE PLAN 2010-05-06-02.dwg