

NOTE: FOR SIDE WALK REINFORCING DETAILS SEE SHEET 39
 FOR BARRIER WALL DETAILS SEE SHEETS 43&44
 FOR PRECAST CONCRETE MEDIAN DETAILS SEE SHEET 37

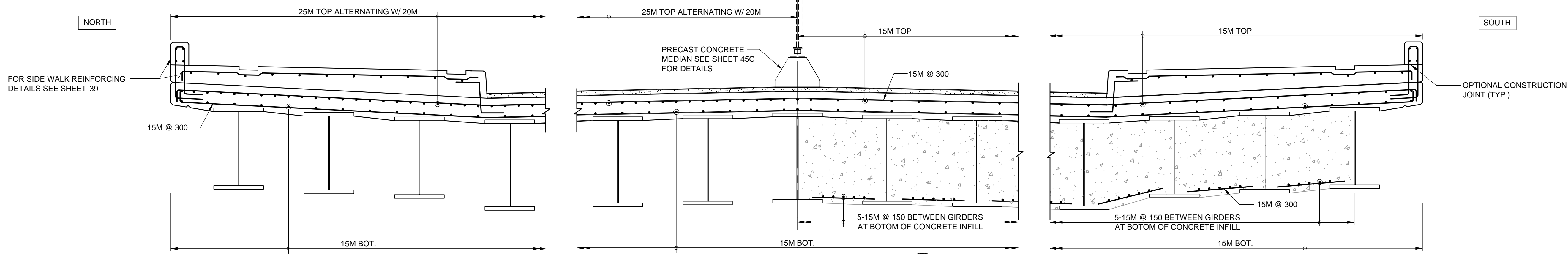

NOTE: SHEAR STUDS NOT SHOWN FOR CLARITY

BAR SIZE	SHAPE
15M	
15M	
15M	
15M	

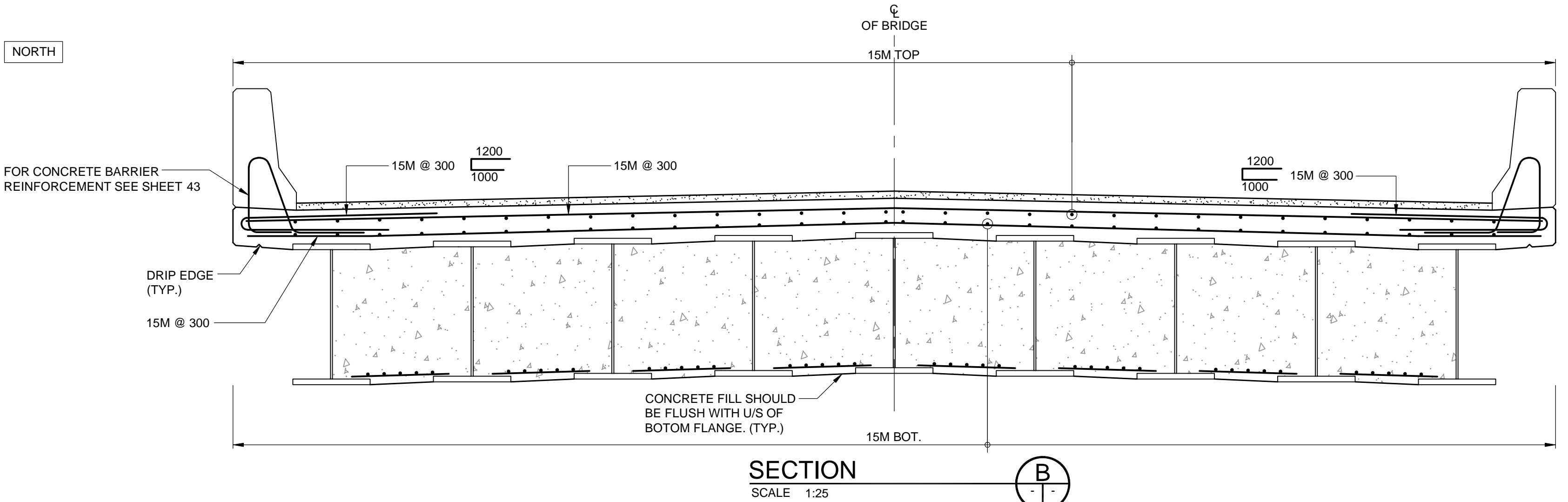

LOCATION	APPROVED	B.M. ELEV.	DESIGNED BY
UNDERGROUND	STRUCTURES		BJR
			DRAWN BY: GDT
			CHECKED BY: SSR
			APPROVED BY: DPK
			HOR. SCALE: AS SHOWN
			VERTICAL: AS SHOWN
1	ISSUED FOR TENDER	10/05/14	DPK
NO.	REVISIONS	DATE	BY

DATE	BY	DATE	BY
2010/05/14	DPK	2010/05/14	DPK

DATE	BY
2010/05/14	DPK

RELEASED FOR CONSTRUCTION
 ORIGINAL SIGNED BY RANDY FINGAS
 DATE 2010/05/14

ENGINEER'S SEAL
 PROVINCE OF MANITOBA
 ORIGINAL STAMPED BY
 S.S. RIHAL
 2010/05/14
 REGISTERED PROFESSIONAL ENGINEER
 CONSULTANT PROJECT NO.
 088813

THE CITY OF WINNIPEG
 TRANSIT DEPARTMENT

Winnipeg

SOUTHWEST RAPID TRANSIT CORRIDOR - STAGE 1
 OSBORNE STATION & ASSOCIATED WORKS

CITY DRAWING NUMBER
B237-10-37

SHEET **37** OF **121**

CONSULTANT DRAWING NUMBER
C5-S1122-T

DECK DETAILS 1 OF 3

APEGM
 Certificate of Authorization
Dillon Consulting Limited (MB)
 No. 1789 Date: 2010/05/14

G:\CAD\088813\Contract\Current\Station\Bridge\Deck\C5-OSBXX-DECK_LAYOUT.dwg