

WINAKWA COMMUNITY CENTRE

DOOR SCHEDULE

NO	SIZE	DOORS							DOOR FRAMES					HARDWARE CODE	ULC LABEL	REMARKS A: 90 min Rating
		THICK 45mm 1 3/4"	MATERIAL HOLLOW METAL	ALLUMINUM INSULATED	GLAZING WIRED	FINISH DOUBLE PAN.	PAINT	TYPE	WELDED P.S.	ALLUMINUM	THERM.BROKEN	INSULATED	FINISH PAINT			
MAIN FLOOR																
D-100	900 X 2150 PR	D	●	●	●	●	●	2	●	●			1		C/W Removeable Mullion	
EX-100	900 X 2150 PR	EX	●	●				2	●				23			
D-102A	900 X 2150 PR	C	●	●		●		2	●				3			
D-102B	900 X 2150	C	●	●		●		1	●				4			
D-102C	900 X 2150 PR	A	●	●	●			2	●				4			
D-102D	900 X 2150 PR	A	●	●	●			2	●				4			
D-103	900 X 2150	C	●	●		●		3	●				5			
D-104	900 X 2150	C	●	●	●	●		1	●				6			
D-105	900 X 2150	A	●	●				1	●				21			
D-106	900 X 2150	A	●	●				1	●				7			
D-107	900 X 2150	A	●	●				1	●				7			
D-108	900 X 2150	A	●	●				1	●				7			
D-109	900 X 2150	A	●	●				1	●				15	A		
D-110	900 X 2150	A	●	●				1	●				8		C/W Peep Hole	
D-113A	900 X 2150	C	●	●		●		1	●				10			
D-113B	900 X 2150	C	●	●		●		1	●				10			
D-114	900 X 2150	C	●	●		●		1	●				27			
D-115	900 X 2150 PR	A	●	●				2	●				11			
D-116A	900 X 2150	C	●	●		●		3	●				9			
D-116B	900 X 2150	A	●	●	●			1	●		●		12			
D-118	900 X 2150	C	●	●		●		1	●				19			
D-119	900 X 2150	A	●	●				1	●				13			
D-120	900 X 2150 PR	A	●	●				2	●				14			
D-134	900 X 2150	A	●	●				1	●				19			
D-136	900 X 2150	A	●	●				1	●				18			
D-140	900 X 2150	A	●	●				1	●				26			
D-ST4A	900 X 2150	A	●	●	●			1	●		●		12	A		
D-ST4B	900 X 2150	C	●	●		●		1	●				20	A		
MEZZANINE																
D-201	900 X 2150	C	●	●		●		1	●				22	A		
D-202A	900 X 2150	A	●	●				1	●				18			
D-202B	900 X 2150 PR	A	●	●				1	●				24			
D-202C	900 X 2150	A	●	●	●			1	●		●		25			
D-203	900 X 2150	A	●	●				1	●				19			

WALL TYPES

- **GENERAL NOTES:**
- ALL INTERIOR WALLS TO EXTEND TO U/S OF DECK. PROVIDE ULC LISTED SYSTEM OF FIRE RATED SEALANT AND ROCK WOOL FLUTE CLOSURES TO ACHIEVE SPECIFIED FIRE RATINGS. AT UNRATED WALLS PROVIDE PREFORMED FLUTE CLOSURES AND/OR CONT. SILL SEAL GASKETS FOR AIR & SOUND SEAL.
 - SEE ELEVATIONS FOR COURSE PATTERNS & LOCATION OF SCORED BLOCKS.
 - PROVIDE ACOUSTIC SEALANT BETWEEN STUD WALLS & ADJACENT CONSTRUCTION TO MAINTAIN SOUND SEAL.

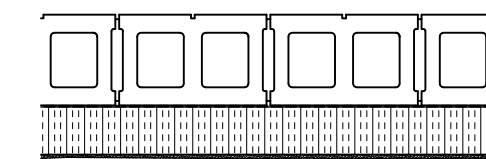

EW1
240 CONCRETE BLOCK PER STRUCT (USE SINGLE SCORE CB UP TO 4,400 HIGH @ 6YM INTERIOR WALL)
AIR / VAPOUR BARRIER MEMBRANE
75 RIGID INSUL. POLYISO (R51-3.52)
AIR SPACE
90 SPLIT FACE (SPLIT LEDGE) CONCRETE BLOCK

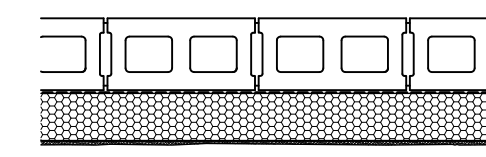

EW2a
190 CONCRETE BLOCK (USE SINGLE SCORE CB UP TO 4,400 HIGH @ 6YM INTERIOR WALL)
AIR / VAPOUR BARRIER MEMBRANE
75 RIGID INSUL. POLYISO (R51-3.52)
25 AIR SPACE
90 SPLIT FACE (SPLIT LEDGE) CONCRETE BLOCK

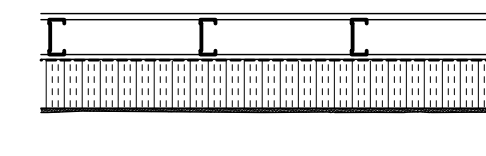

EW2b
16 ABUSE RESISTANT GMB, PTD.
92 STEEL STUD @ 400 O.C.
16 EXTR. GRADE PLYND
AIR / VAPOUR BARRIER SYSTEM (BY EIFS)
125 EXT. INSUL FINISH SYSTEM (R51-3.52)

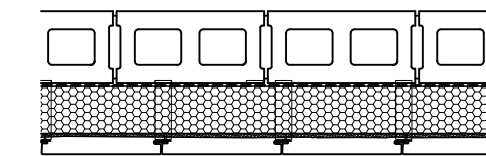

EW3a
190 CONCRETE BLOCK
AIR / VAPOUR BARRIER SYSTEM (BY EIFS)
125 EXT. INSUL FINISH SYSTEM (R51-3.52)
Z-GIRTS, FURRING HAT CHANNEL/OUTRIGGERS
AD300R VIC-WEST METAL CLADDING

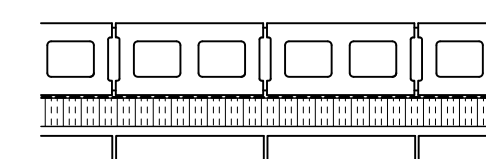

EW3b
190 CONCRETE BLOCK
AIR / VAPOUR BARRIER MEMBRANE
75 RIGID INSUL. POLYISO (R51-3.52)
25 AIR SPACE
90 SPLIT FACE (SPLIT LEDGE) CONCRETE BLOCK

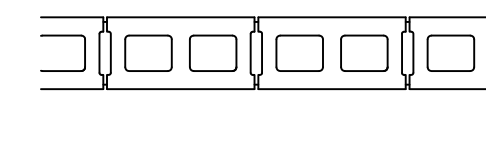

W1
190 CONCRETE BLOCK (USE SINGLE SCORE CB UP TO 4,400 HIGH @ 6YM INTERIOR WALL)

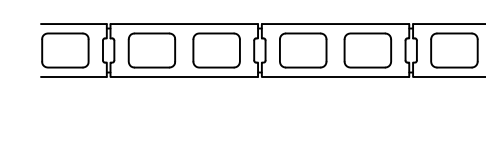

W2
140 CONCRETE BLOCK

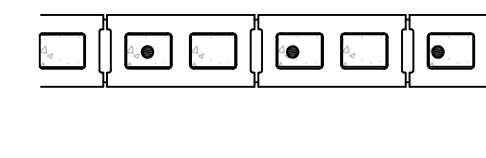

W3 (1-HOUR FIRE RATED)
190 CONCRETE BLOCK (USE LT. WT. BLK FOR REQD FRR)

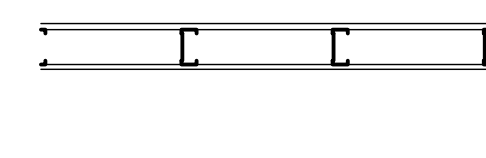

W4
16 ABUSE RESISTANT GMB
92 STEEL STUD 400 O/C MAX

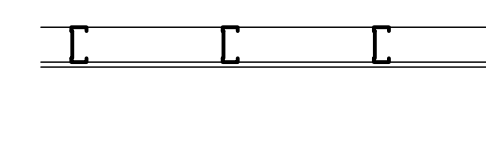

W5
16 GLASS-MAT GMB
92 STEEL STUD 400 O/C MAX

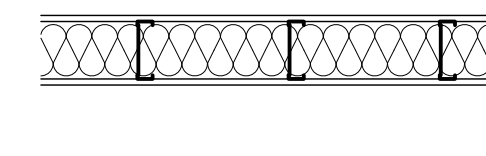

W6
16 ABUSE RESISTANT GMB
152 STEEL STUD @400 O/C MAX
ACOUSTIC BATT
16 ABUSE RESISTANT GMB

FIRE RATINGS

- 0 HR. FIRE RESISTANCE RATED FIRE SEPARATION
- 45 MINUTES FIRE RESISTANCE RATED FIRE SEPARATION
- 1 HR. FIRE RESISTANCE RATED FIRE SEPARATION OR ASSEMBLY
- 2 HR. FIRE RESISTANCE RATED FIRE SEPARATION OR ASSEMBLY

- ***NOTE:**
- RUN F.R. ASSEMBLIES CONT THROUGH PRIOR TO INSTALLING ABUTTING WALLS.
 - F.R. WALLS TO RUN CONT TO U/S OF FLOOR/ROOF ASSEMBLY ABOVE.
 - F.R. WALLS TO BE CONSTRUCTED TO APPROPRIATE U.L.C. LISTED ASSEMBLY FOR MATERIALS INDICATED.
 - SEE ALSO WALL TYPES GENERAL NOTES.

ROOF TYPES

R1
MOD. BIT. MEMBRANE ROOFING SYSTEM
SLOPED POLYISO, INSUL MIN R51-7.04 C/M
VAPOUR RETARDANT
13 GLASS-MAT EXT GYPSUM ROOF BOARD
30 STEEL DECK PER STRUCT
STEEL JOISTS PER STRUCT

R2
MOD. BIT. MEMBRANE ROOFING SYSTEM
SLOPED POLYISO, INSUL MIN R51-7.04 C/M
VAPOUR RETARDANT
13 GLASS-MAT EXT GYPSUM ROOF BOARD
30 STEEL DECK PER STRUCT
STEEL JOISTS PER STRUCT

FLOOR TYPES

F1
CONC. SLAB PER STRUCT
10 MIL POLY VAPOUR BARRIER
100 RIGID INSUL MECHANICALLY FASTENED TO SLAB AT EXT PERIMETER
FOR MIN 2400 FROM GRADE BEAM
3 UN-TEMPERED MASONITE AT ALL AREAS
W/O INSUL MECHANICALLY FASTENED TO SLAB
VOIDFORM PER STRUCT
LEVELING SAND PER STRUCT

F2
30 CONC TOPPING PER STRUCT
200 HOLLOW CORE PER STRUCT

0	ISSUED FOR TENDER	2010.04.07	CAA
NO. REVISION	DATE	BY	

THIS DRAWING IS THE EXCLUSIVE PROPERTY OF THE ARCHITECT AND CAN BE REPRODUCED ONLY WITH THE PERMISSION OF THE ARCHITECT. IN WHICH CASE THE REPRODUCTION MUST BEAR THE NAME OF THE ARCHITECT.

THIS DRAWING SHALL NOT BE SCALED. FOLLOW GIVEN DIMENSIONS ONLY.

THE CONTRACTOR SHALL SATISFY HIMSELF THAT ALL DIMENSIONS AND INFORMATION SHOWN ARE CORRECT.

PRIOR TO COMMENCEMENT OF WORK REPORT ANY DISCREPANCIES TO THE ARCHITECT.

VARIATIONS AND MODIFICATIONS TO WORK SHOWN WILL NOT BE ALLOWED WITHOUT WRITTEN PERMISSION OF THE ARCHITECT.

CONSULTANT

SEAL

CALNITSKY ASSOCIATES ARCHITECTS

ARCHITECTURE | **INTERIOR DESIGN**
124 Nassau Street North | Winnipeg, Manitoba R3L 2H1
Tel: (204) 453-6441 | Fax: (204) 453-3392
E-mail: caa@escape.ca

PROJECT TITLE
ADDITION & RENOVATION OF WINAKWA COMMUNITY CENTRE

980 WINAKWA RD, WINNIPEG

SHEET TITLE
SCHEDULES

DRAWN BY	SCALE	SHEET NUMBER
CS, SM	AS SHOWN	A0.1
CHECKED BY	DATE	
BM	2010.05.14	
PROJECT NO.	REV. DATE	REV. NO.
09-012		0