

NOTES:

- ALL ITEMS ON EXISTING EXTERIOR WALLS THAT ARE AFFECTED BY METAL CLAD BANDING MUST BE ADJUSTED/RELOCATED/RE-MOUNTED OR REMOVED IN WHATEVER CASE MAY APPLY.

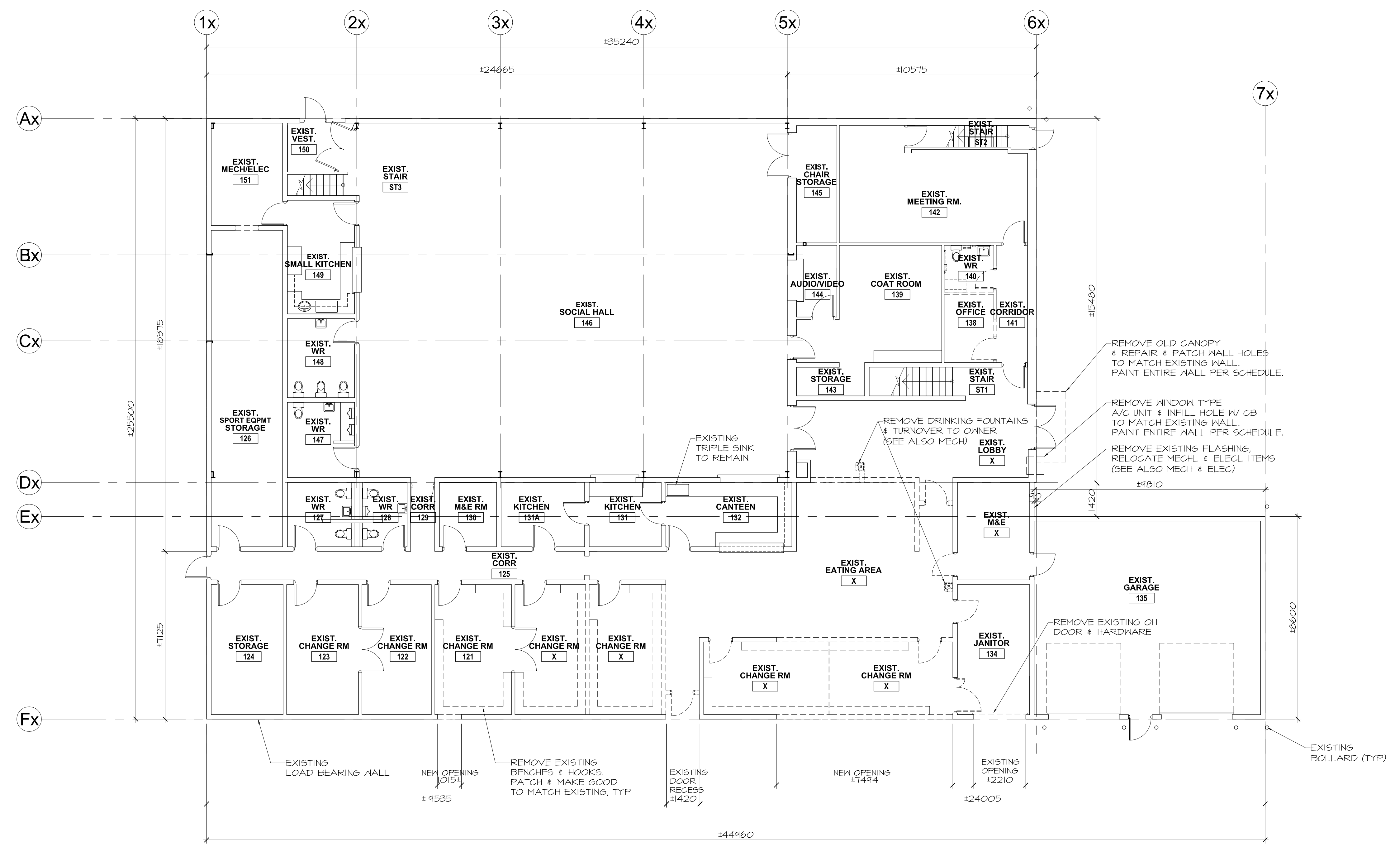

**1**  
**2.0**  
EXISTING MAIN FLOOR PLAN  
1:100

NOTES:

- DIMENSIONS SHOWN FOR EXISTING CONSTRUCTION ARE BASED ON INFORMATION AVAILABLE ON ORIGINAL REFERENCE DRAWINGS, AS BUILD DIMENSIONS MAY VARY, INFORM THE ARCHITECT OF ANY DISCREPANCY PRIOR TO CONSTRUCTION. (TYP ALL SHEETS)
- SEE ALSO CIVIL, STRUCT, MECH & ELEC FOR OTHER & RELATED DEMOLITIONS.

**DEMOLITION LEGEND**

=====  
EXISTING TO REMAIN

-----  
REMOVE PARTITIONS AND BUILDING ELEMENTS SHOWN DOUBLE DASHED LINES

NOTES:

- REMOVE & REPAIR EXISTING FLOORING, CEILING & RELATED SYSTEMS TO ACCOMMODATE NEW CONSTRUCTIONS.
- REMOVE, PATCH AND REPAIR CEILING AND OTHER CONSTRUCTION AS REQUIRED TO ACCOMMODATE INSTALLATION OF NEW SPRINKLER SYSTEM.
- REPAIR, PATCH EXISTING FLOOR, WALLS, CEILING AND OTHER PARTS OF THE BUILDING THAT ARE AFFECTED BY THE NEW CONSTRUCTION AND/OR RENOVATIONS.

NO.	REVISION	DATE	BY
0	ISSUED FOR TENDER	2010.05.13	CAA

THIS DRAWING IS THE EXCLUSIVE PROPERTY OF THE ARCHITECT AND CAN BE REPRODUCED ONLY WITH THE PERMISSION OF THE ARCHITECT IN WHICH CASE THE REPRODUCTION MUST BEAR THE NAME OF THE ARCHITECT.

THIS DRAWING SHALL NOT BE SCALED. FOLLOW GIVEN DIMENSIONS ONLY.

THE CONTRACTOR SHALL SATISFY HIMSELF THAT ALL DIMENSIONS AND INFORMATION SHOWN ARE CORRECT.

PRIOR TO COMMENCEMENT OF WORK REPORT ANY DISCREPANCIES TO THE ARCHITECT.

VARIATIONS AND MODIFICATIONS TO WORK SHOWN WILL NOT BE ALLOWED WITHOUT WRITTEN PERMISSION OF THE ARCHITECT.

CONSULTANT

SEAL

**CALNITSKY ASSOCIATES ARCHITECTS**

CALNITSKY ASSOCIATES ARCHITECTS INC.  
124 Nassau Street North Winnipeg, Manitoba R3L 2H1  
Tel: (204) 453-6441 Fax: (204) 453-3392  
E-mail: caa@escape.ca

**ARCHITECTURE** | **INTERIOR DESIGN**  
124 Nassau Street North Winnipeg, Manitoba R3L 2H1  
Tel: (204) 453-6441 Fax: (204) 453-3392  
E-mail: caa@escape.ca

PROJECT TITLE  
**ADDITION & RENOVATION OF WINAKWA COMMUNITY CENTRE**

980 WINAKWA RD, WINNIPEG

SHEET TITLE  
**EXISTING FLOOR PLANS & DEMOLITION**

DRAWN BY	SCALE	SHEET NUMBER
SM, CS	AS SHOWN	<b>A2.0</b>
CHECKED BY	DATE	
CS, BM	2010.05.13	
PROJECT NO.	REV. DATE	REV. NO.
09-012		0