

G:\CAD\088813\Contract\Contract_6-Burway\Current\Roadway\C6-310-Paving-Grading-Burway.dwg

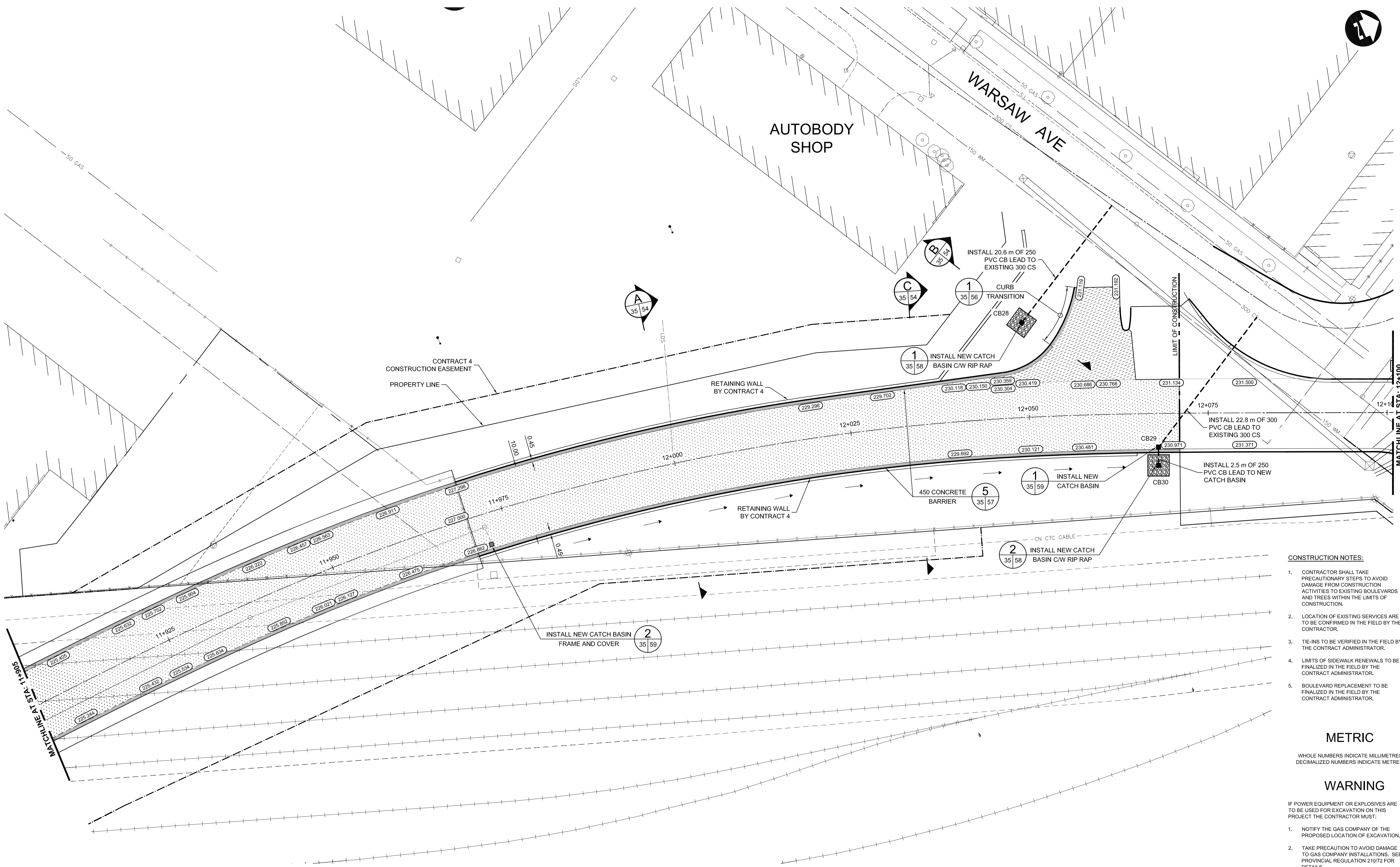

- CONSTRUCTION NOTES:**
- CONTRACTOR SHALL TAKE PRECAUTIONARY STEPS TO AVOID DAMAGE FROM CONSTRUCTION ACTIVITIES TO EXISTING BOULEVARDS AND TREES WITHIN THE LIMITS OF CONSTRUCTION.
 - LOCATION OF EXISTING SERVICES ARE TO BE CONFIRMED IN THE FIELD BY THE CONTRACTOR.
 - TIE-INS TO BE VERIFIED IN THE FIELD BY THE CONTRACT ADMINISTRATOR.
 - LIMITS OF SIDEWALK RENEWALS TO BE FINALIZED IN THE FIELD BY THE CONTRACT ADMINISTRATOR.
 - BOULEVARD REPLACEMENT TO BE FINALIZED IN THE FIELD BY THE CONTRACT ADMINISTRATOR.

METRIC
WHOLE NUMBERS INDICATE MILLIMETRES
DECIMALIZED NUMBERS INDICATE METRES.

WARNING
IF POWER EQUIPMENT OR EXPLOSIVES ARE TO BE USED FOR EXCAVATION ON THIS PROJECT THE CONTRACTOR MUST:

- NOTIFY THE GAS COMPANY OF THE PROPOSED LOCATION OF EXCAVATION.
- TAKE PRECAUTION TO AVOID DAMAGE TO GAS COMPANY INSTALLATIONS. SEE PROVINCIAL REGULATION 210/72 FOR DETAILS.

#	COORDINATES		RIM ELEV.	SUMP ELEV.	STATION	PIPE LEAD	LEAD INV.	INV. AT MAIN
	NORTHING	EASTING						
CB28	5526101.358	633517.114	TBD	-	-	-	-	-
CB29	5526111.790	633540.961	230.971	228.571	12+067.500	23.4m - 250mm	229.171	228.687
CB30	5526110.896	633543.026	230.971	228.671	12+067.500	2.5m - 250mm	229.271	229.201

NOTE: ALL COORDINATES SHOWN ON DRAWINGS ARE NAD 83 UTM.
COMBINED SCALE FACTOR TO OBTAIN GROUND DISTANCES IS 0.9997688



LOCATION UNDERGROUND	APPROVED STRUCTURES	B.M. ELEV.	DESIGNED BY
SUPPLY U/G STRUCTURES COMMITTEE	DATE		RTP
			DRAWN BY T.JH./P.M.W.
			CHECKED BY ORIGINAL SIGNED BY TARAN J. PETERS
			APPROVED BY ORIGINAL SIGNED BY DAVE P. KRAHN
2	ISSUED FOR TENDER	03/26/10	T.J.P.
1	ISSUED FOR 75% REVIEW	03/03/10	T.J.P.
NO.	REVISIONS	DATE	BY

NO.	REVISIONS	DATE	BY	DATE
2	ISSUED FOR TENDER	03/26/10	T.J.P.	
1	ISSUED FOR 75% REVIEW	03/03/10	T.J.P.	

HOR. SCALE	VERTICAL
1 : 250	1 : 10

RELEASED FOR CONSTRUCTION
ORIGINAL SIGNED BY RANDY FINGAS
DATE 03/24/10

ENGINEER'S SEAL
PROVINCE OF MANITOBA
REGISTERED PROFESSIONAL ENGINEER
T.J. PETERS
03/26/10
Member 22309

THE CITY OF WINNIPEG TRANSIT DEPARTMENT

Winnipeg

SOUTHWEST RAPID TRANSIT CORRIDOR - STAGE 1
TRANSITWAY CONSTRUCTION, LANDSCAPING & ASSOCIATED WORKS

PAVING & GRADING - TRANSITWAY - STA. 11+905 TO 12+100 (PLAN)

CITY DRAWING NUMBER: P-3317-35
SHEET 35 OF 72
CONSULTANT DRAWING NUMBER: C6-C3025-T

CONSULTANT PROJECT NO.: 088813