

NOTE: CHAINAGES SHOWN ALONG CL OF PIPE

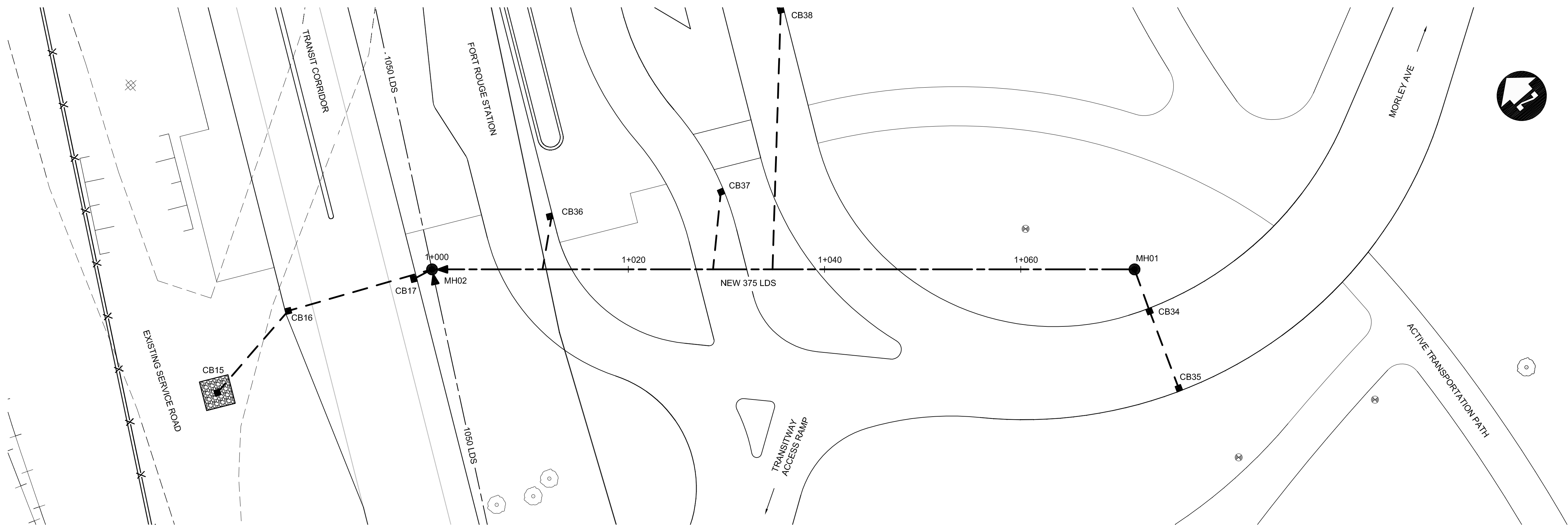

**CONSTRUCTION NOTES:**

- CONTRACTOR SHALL TAKE PRECAUTIONARY STEPS TO AVOID DAMAGE FROM CONSTRUCTION ACTIVITIES TO EXISTING BOULEVARDS AND TREES WITHIN THE LIMITS OF CONSTRUCTION.
- LOCATION OF EXISTING UTILITIES TO BE CONFIRMED IN THE FIELD BY THE CONTRACTOR.
- CONTRACTOR TO PLUG ANY ABANDONED PIPES THAT ARE BROKEN DURING CONSTRUCTION.
- TRENCHES & EXCAVATIONS WITHIN 1 METRE OF A PAVED AREA INCLUDING SIDEWALKS SHALL BE CLASS 3 BACKFILL OTHERWISE USE CLASS 5.
- SEE ROAD CONSTRUCTION DRAWINGS FOR CB INSTALLATION.
- MH02 TO BE INSTALLED AS PER CW2130 - SECTION 3.9.2.

**METRIC**

WHOLE NUMBERS INDICATE MILLIMETRES  
DECIMALIZED NUMBERS INDICATE METRES.

**WARNING**

- IF POWER EQUIPMENT OR EXPLOSIVES ARE TO BE USED FOR EXCAVATION ON THIS PROJECT THE CONTRACTOR MUST:
- NOTIFY THE GAS COMPANY OF THE PROPOSED LOCATION OF EXCAVATION.
  - TAKE PRECAUTION TO AVOID DAMAGE TO GAS COMPANY INSTALLATIONS. SEE PROVINCIAL REGULATION 210/72 FOR DETAILS.

COORDINATES		RIM ELEV.	#	STATION	INVERT			
NORTHING	EASTING				N	S	E	W
5524919.712	633324.866	232.501	MH01	1+071.59				229.500
5524966.449	633270.635	232.690	MH02	1+000.00				226.803 227.500

NOTE: ALL COORDINATES SHOWN ON DRAWINGS ARE NAD 83 UTM.  
COMBINED SCALE FACTOR TO OBTAIN GROUND DISTANCES IS 0.9997688

**APEGM**  
Certificate of Authorization  
**Dillon Consulting Limited (MB)**  
No. 1789 Date: \_\_\_\_\_

LOCATION UNDERGROUND	APPROVED STRUCTURES	B.M. ELEV.	DESIGNED BY	CLP
SUPV. U/G STRUCTURES COMMITTEE	DATE		DRAWN BY	CLP
			CHECKED BY	ORIGINAL SIGNED BY TARAN J. PETERS
			APPROVED BY	ORIGINAL SIGNED BY DAVE P. KRAHN
			HOR. SCALE	1 : 250
			VERTICAL	1 : 50
			RELEASED FOR CONSTRUCTION	ORIGINAL SIGNED BY RANDY FINGAS
			DATE	03/24/10
			CONSULTANT PROJECT NO.	088813
			NO. REVISIONS	DATE BY
			2	ISSUED FOR TENDER 03/26/10 CLP
			1	ISSUED FOR 75% REVIEW 03/09/10 CLP

DESIGNED BY	CLP
DRAWN BY	CLP
CHECKED BY	ORIGINAL SIGNED BY TARAN J. PETERS
APPROVED BY	ORIGINAL SIGNED BY DAVE P. KRAHN
HOR. SCALE	1 : 250
VERTICAL	1 : 50
RELEASED FOR CONSTRUCTION	ORIGINAL SIGNED BY RANDY FINGAS
DATE	03/24/10
CONSULTANT PROJECT NO.	088813
NO. REVISIONS	DATE BY
2	ISSUED FOR TENDER 03/26/10 CLP
1	ISSUED FOR 75% REVIEW 03/09/10 CLP

DESIGNED BY	CLP
DRAWN BY	CLP
CHECKED BY	ORIGINAL SIGNED BY TARAN J. PETERS
APPROVED BY	ORIGINAL SIGNED BY DAVE P. KRAHN
HOR. SCALE	1 : 250
VERTICAL	1 : 50
RELEASED FOR CONSTRUCTION	ORIGINAL SIGNED BY RANDY FINGAS
DATE	03/24/10
CONSULTANT PROJECT NO.	088813
NO. REVISIONS	DATE BY
2	ISSUED FOR TENDER 03/26/10 CLP
1	ISSUED FOR 75% REVIEW 03/09/10 CLP

**DILLON CONSULTING**

ENGINEER'S SEAL  
PROVINCE OF MANITOBA  
REGISTERED PROFESSIONAL ENGINEER  
T.J. PETERS  
03/26/10  
Member 22309

**THE CITY OF WINNIPEG TRANSIT DEPARTMENT**

SOUTHWEST RAPID TRANSIT CORRIDOR - STAGE 1  
TRANSITWAY CONSTRUCTION, LANDSCAPING & ASSOCIATED WORKS

LDS - FORT ROUGE STATION

CITY DRAWING NUMBER P-3317-44  
SHEET 44 OF 72  
CONSULTANT DRAWING NUMBER C6-C3034-T

G:\CAD\088813\Contract\Contract\_6-Busway\Current\Roadway\C6-320-LDS-Fort\_Rouge\_Station.dwg