

**PLANT LIST**

KEY	QTY.	COMMON NAME/BOTANICAL NAME	SIZE	REMARKS
<b>DECIDUOUS TREES</b>				
A	42	SILVER MAPLE / ACER SACCHARINUM	75-90mm cal.	SPECIMEN, W.B. MACHINE DUG WITH MIN. 10 BRANCHES IN WELL BRANCHED HEAD, STRAIGHT TRUNK, MIN. HT. 6.0m, BRANCHING HT. 1.8m.
B	8	SILVER MAPLE / ACER SACCHARINUM	40mm cal.	SPECIMEN, MACHINE DUG WITH MIN. 10 BRANCHES IN WELL BRANCHED HEAD, STRAIGHT TRUNK, MIN. HT. 3.5m, BRANCHING HT. 1.5m.
C	10	OHIO BUCKEYE / AESCULUS GLABRA	40mm cal.	SPECIMEN, MACHINE DUG WITH MIN. 10 BRANCHES IN WELL BRANCHED HEAD, STRAIGHT TRUNK, MIN. HT. 3.5m, BRANCHING HT. 1.5m.
D	15	PRAIRIE HORIZON ALDER / ALNUS HISUTA 'HARBIN'	40mm cal.	SPECIMEN, MACHINE DUG WITH MIN. 10 BRANCHES IN WELL BRANCHED HEAD, STRAIGHT TRUNK, MIN. HT. 3.5m, BRANCHING HT. 1.5m.
E	21	COMMON HACKBERRY / CELTIS OCCIDENTALIS	40mm cal.	SPECIMEN, MACHINE DUG WITH MIN. 10 BRANCHES IN WELL BRANCHED HEAD, STRAIGHT TRUNK, MIN. HT. 3.5m, BRANCHING HT. 1.5m.
F	27	MANCHURIAN ASH/FRAXINUS MANDSHURICA 'MANCANA'	75-90mm cal.	SPECIMEN, W.B. MACHINE DUG WITH MIN. 10 BRANCHES IN WELL BRANCHED HEAD, STRAIGHT TRUNK, MIN. HT. 6.0m, BRANCHING HT. 1.8m.
G	19	MANCHURIAN ASH/FRAXINUS MANDSHURICA 'MANCANA'	40mm cal.	SPECIMEN, MACHINE DUG WITH MIN. 10 BRANCHES IN WELL BRANCHED HEAD, STRAIGHT TRUNK, MIN. HT. 3.5m, BRANCHING HT. 1.5m.
H	7	BUTTERNUT / JUGLANS CINEREA	40mm cal.	SPECIMEN, W.B. MACHINE DUG WITH MIN. 10 BRANCHES IN WELL BRANCHED HEAD, STRAIGHT TRUNK, MIN. HT. 3.5m, BRANCHING HT. 1.8m.
J	55	BALSAM POPLAR / POPULUS BALSAMIFERA	75-90mm cal.	SPECIMEN, W.B. MACHINE DUG WITH MIN. 10 BRANCHES IN WELL BRANCHED HEAD, STRAIGHT TRUNK, MIN. HT. 6.0m, BRANCHING HT. 1.8m.
K	8	BALSAM POPLAR / POPULUS BALSAMIFERA	40mm cal.	SPECIMEN, MACHINE DUG WITH MIN. 10 BRANCHES IN WELL BRANCHED HEAD, STRAIGHT TRUNK, MIN. HT. 3.5m, BRANCHING HT. 1.5m.
L	12	TREMBLING ASPEN / POPULUS TREMULOIDES	75-90mm cal.	SPECIMEN, W.B. MACHINE DUG WITH MIN. 10 BRANCHES IN WELL BRANCHED HEAD, STRAIGHT TRUNK, MIN. HT. 6.0m, BRANCHING HT. 1.8m.
M	88	TREMBLING ASPEN / POPULUS TREMULOIDES	40mm cal.	SPECIMEN, MACHINE DUG WITH MIN. 10 BRANCHES IN WELL BRANCHED HEAD, STRAIGHT TRUNK, MIN. HT. 4.0m, BRANCHING HT. 1.5m.
N	30	AMERICAN BASSWOOD / TILIA AMERICANA	75-90mm cal.	SPECIMEN, W.B. MACHINE DUG WITH MIN. 10 BRANCHES IN WELL BRANCHED HEAD, STRAIGHT TRUNK, MIN. HT. 6.0m, BRANCHING HT. 1.8m.
P	11	AMERICAN BASSWOOD / TILIA AMERICANA	40mm cal.	SPECIMEN, MACHINE DUG WITH MIN. 10 BRANCHES IN WELL BRANCHED HEAD, STRAIGHT TRUNK, MIN. HT. 3.5m, BRANCHING HT. 1.5m.
Q	9	GLENLEVEN LINDEN / TILIA X FLAVESCENS 'GLENLEVEN'	75-90mm cal.	SPECIMEN, W.B. MACHINE DUG WITH MIN. 10 BRANCHES IN WELL BRANCHED HEAD, STRAIGHT TRUNK, MIN. HT. 6.0m, BRANCHING HT. 1.8m.
R	3	GLENLEVEN LINDEN / TILIA X FLAVESCENS 'GLENLEVEN'	40mm cal.	SPECIMEN, MACHINE DUG WITH MIN. 10 BRANCHES IN WELL BRANCHED HEAD, STRAIGHT TRUNK, MIN. HT. 3.5m, BRANCHING HT. 1.5m.
S	10	AMERICAN ELM / ULMUS AMERICANA	75-90mm cal.	SPECIMEN, W.B. MACHINE DUG WITH MIN. 10 BRANCHES IN WELL BRANCHED HEAD, STRAIGHT TRUNK, MIN. HT. 6.0m, BRANCHING HT. 1.8m.
T	74	AMERICAN ELM / ULMUS AMERICANA	40mm cal.	SPECIMEN, MACHINE DUG WITH MIN. 10 BRANCHES IN WELL BRANCHED HEAD, STRAIGHT TRUNK, MIN. HT. 3.5m, BRANCHING HT. 1.5m.
U	7	BRANDON ELM / ULMUS AMERICANA 'BRANDON'	75-90mm cal.	SPECIMEN, W.B. MACHINE DUG WITH MIN. 10 BRANCHES IN WELL BRANCHED HEAD, STRAIGHT TRUNK, MIN. HT. 6.0m, BRANCHING HT. 1.8m.
V	14	BRANDON ELM / ULMUS AMERICANA 'BRANDON'	40mm cal.	SPECIMEN, MACHINE DUG WITH MIN. 10 BRANCHES IN WELL BRANCHED HEAD, STRAIGHT TRUNK, MIN. HT. 3.5m, BRANCHING HT. 1.5m.
W	10	DISCOVERY ELM / ULMUS DAVIDIANA 'DISCOVERY'	75-90mm cal.	SPECIMEN, W.B. MACHINE DUG WITH MIN. 10 BRANCHES IN WELL BRANCHED HEAD, STRAIGHT TRUNK, MIN. HT. 6.0m, BRANCHING HT. 1.8m.
X	13	DISCOVERY ELM / ULMUS DAVIDIANA 'DISCOVERY'	40mm cal.	SPECIMEN, MACHINE DUG WITH MIN. 10 BRANCHES IN WELL BRANCHED HEAD, STRAIGHT TRUNK, MIN. HT. 3.5m, BRANCHING HT. 1.5m.

**PLANT LIST**

KEY	QTY.	COMMON NAME/BOTANICAL NAME	SIZE	REMARKS
<b>ORNAMENTAL DECIDUOUS TREES</b>				
Y	5	AMUR MAPLE / ACER GINNALA	60-75mm cal.	SPECIMEN, W.B. MACHINE DUG WITH MIN. 10 BRANCHES IN WELL BRANCHED HEAD, STRAIGHT TRUNK, MIN. HT. 4.0m, BRANCHING HT. 1.5m.
Z	12	AMUR MAPLE / ACER GINNALA	40mm cal.	SPECIMEN, MACHINE DUG WITH MIN. 10 BRANCHES IN WELL BRANCHED HEAD, STRAIGHT TRUNK, MIN. HT. 3.0m, BRANCHING HT. 1.2m.
AA	11	SNOWBIRD HAWTHORN / CRATAEGUS X MORDENENSIS 'SNOWBIRD'	60-75mm cal.	SPECIMEN, W.B. MACHINE DUG WITH MIN. 10 BRANCHES IN WELL BRANCHED HEAD, STRAIGHT TRUNK, MIN. HT. 4.0m, BRANCHING HT. 1.5m.
BB	12	SNOWBIRD HAWTHORN / CRATAEGUS X MORDENENSIS 'SNOWBIRD'	40mm cal.	SPECIMEN, MACHINE DUG WITH MIN. 10 BRANCHES IN WELL BRANCHED HEAD, STRAIGHT TRUNK, MIN. HT. 3.0m, BRANCHING HT. 1.2m.
CC	16	SPRING SNOW CRABAPPLE / MALUS X 'SPRING SNOW'	60-75mm cal.	SPECIMEN, W.B. MACHINE DUG WITH MIN. 10 BRANCHES IN WELL BRANCHED HEAD, STRAIGHT TRUNK, MIN. HT. 4.0m, BRANCHING HT. 1.5m.
DD	5	SPRING SNOW CRABAPPLE / MALUS X 'SPRING SNOW'	40mm cal.	SPECIMEN, MACHINE DUG WITH MIN. 10 BRANCHES IN WELL BRANCHED HEAD, STRAIGHT TRUNK, MIN. HT. 3.0m, BRANCHING HT. 1.2m.
EE	5	HOP HORNBEAM / OSTYRA VIRGINIANA	60-75mm cal.	SPECIMEN, W.B. MACHINE DUG WITH MIN. 10 BRANCHES IN WELL BRANCHED HEAD, STRAIGHT TRUNK, MIN. HT. 4.0m, BRANCHING HT. 1.5m.
FF	23	HOP HORNBEAM / OSTYRA VIRGINIANA	40mm cal.	SPECIMEN, MACHINE DUG WITH MIN. 10 BRANCHES IN WELL BRANCHED HEAD, STRAIGHT TRUNK, MIN. HT. 3.0m, BRANCHING HT. 1.2m.
GG	29	PINCHERRY / PRUNUS PENNSYLVANICA	40mm cal.	SPECIMEN, MACHINE DUG WITH MIN. 10 BRANCHES IN WELL BRANCHED HEAD, STRAIGHT TRUNK, MIN. HT. 3.0m, BRANCHING HT. 1.2m.
HH	34	CHOKECHERRY / PRUNUS VIRGINIANA	40mm cal.	SPECIMEN, MACHINE DUG WITH MIN. 10 BRANCHES IN WELL BRANCHED HEAD, STRAIGHT TRUNK, MIN. HT. 3.0m, BRANCHING HT. 1.2m.
JJ	12	URE PEAR / PYRUS USSURIENSIS 'URE'	60-75mm cal.	SPECIMEN, W.B. MACHINE DUG WITH MIN. 10 BRANCHES IN WELL BRANCHED HEAD, STRAIGHT TRUNK, MIN. HT. 4.0m, BRANCHING HT. 1.5m.
KK	5	URE PEAR / PYRUS USSURIENSIS 'URE'	40mm cal.	SPECIMEN, MACHINE DUG WITH MIN. 10 BRANCHES IN WELL BRANCHED HEAD, STRAIGHT TRUNK, MIN. HT. 3.0m, BRANCHING HT. 1.2m.
<b>CONIFEROUS TREES</b>				
LL	17	AMERICAN LARCH / LARIX LARICINA	1.8m ht.	SPECIMEN, W.B. MACHINE DUG WITH SINGLE UPRIGHT LEADER. STRAIGHT TRUNK, WELL BRANCHED, FULL FORM.
MM	43	AMERICAN LARCH / LARIX LARICINA	1.0m ht.	SPECIMEN, MACHINE DUG WITH SINGLE UPRIGHT LEADER. STRAIGHT TRUNK, WELL BRANCHED, FULL FORM. MIN 1.0m HT
NN	135	WHITE SPRUCE/PICEA GLAUCA	1.8m ht.	SPECIMEN, W.B. MACHINE DUG WITH SINGLE UPRIGHT LEADER. STRAIGHT TRUNK, WELL BRANCHED, FULL FORM.
PP	65	WHITE SPRUCE/PICEA GLAUCA	1.0m ht.	SPECIMEN, MACHINE DUG WITH SINGLE UPRIGHT LEADER. STRAIGHT TRUNK, WELL BRANCHED, FULL FORM. MIN 1.0m HT
QQ	75	COLORADO SPRUCE/PICEA PUNGENS	1.8m ht.	SPECIMEN, W.B. MACHINE DUG WITH SINGLE UPRIGHT LEADER. STRAIGHT TRUNK, WELL BRANCHED, FULL FORM.
RR	61	COLORADO SPRUCE/PICEA PUNGENS	1.0m ht.	SPECIMEN, MACHINE DUG WITH SINGLE UPRIGHT LEADER. STRAIGHT TRUNK, WELL BRANCHED, FULL FORM. MIN 1.0m HT

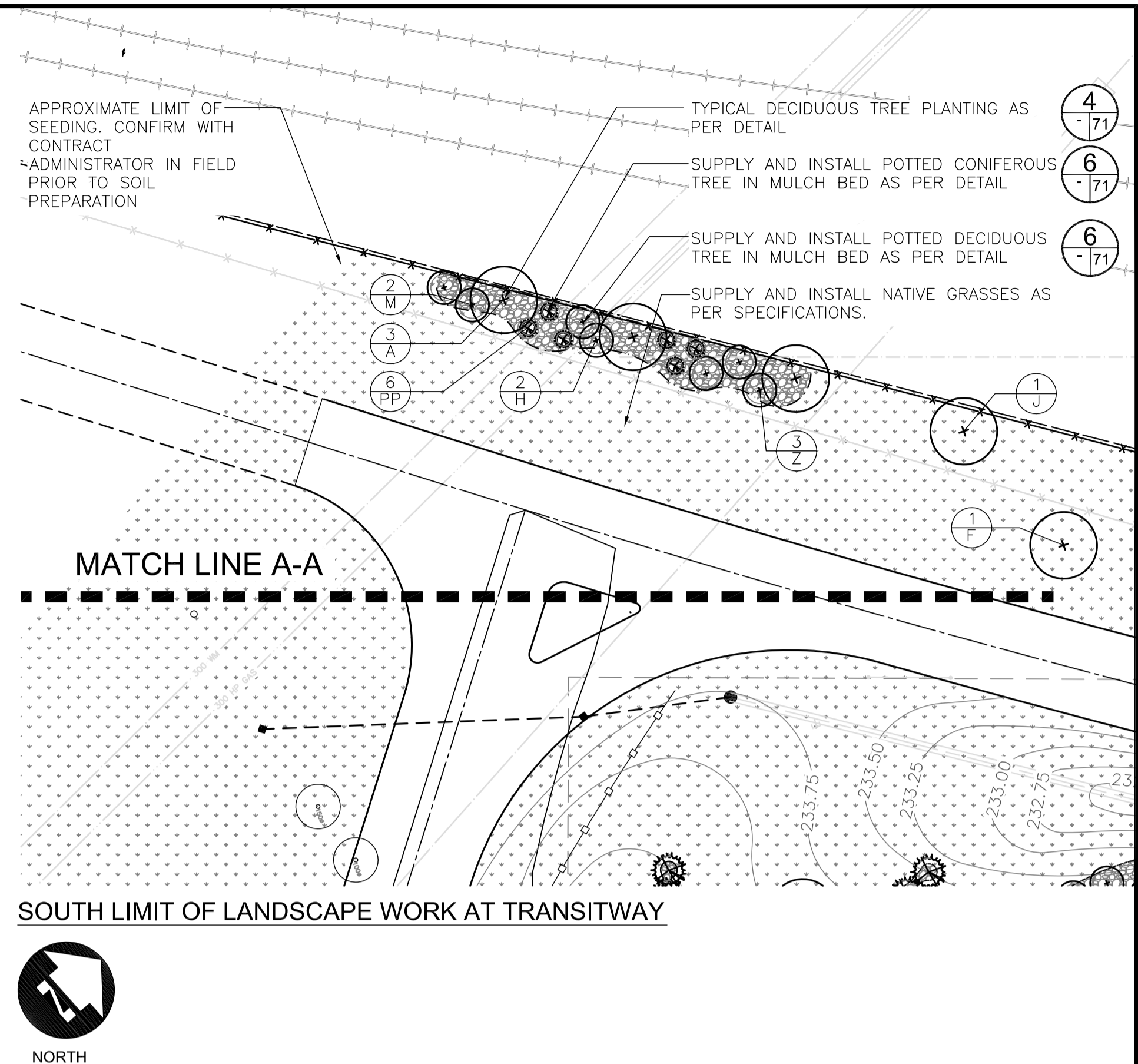

X:\08-028 Southwestern BRT Corridor.dwg\2010\fort\_rouge\_yards\Landscape Plans 2010-03-26.dwg

**LEGEND**

	SOD		EXISTING TREES TO REMAIN
	NATIVE GRASSES		PROPOSED DECIDUOUS TREE
	MULCH BED		PROPOSED ORNAMENTAL DECIDUOUS TREE
	CONCRETE SIDEWALK		PROPOSED CONIFEROUS TREE
	ASPHALT PATHWAY		PLANT KEY
	DETECTABLE PAVING IN SIDEWALK RAMP		QUANTITY PLANT KEY

LOCATION UNDERGROUND	APPROVED STRUCTURES	B.M. ELEV.	B.M. ELEV.
SUPY. U/G STRUCTURES COMMITTEE	DATE		

NOTE:  
LOCATION OF UNDERGROUND STRUCTURES AS SHOWN ARE BASED ON THE BEST INFORMATION AVAILABLE, BUT NO GUARANTEE IS GIVEN THAT ALL EXISTING UTILITIES ARE SHOWN OR THAT THE GIVEN LOCATIONS ARE EXACT. CONFIRMATION OF EXISTENCE AND EXACT LOCATION OF ALL SERVICES MUST BE OBTAINED FROM THE INDIVIDUAL UTILITIES BEFORE PROCEEDING WITH CONSTRUCTION.

NO.	REVISIONS	DATE	BY
2	ISSUED FOR TENDER	03/26/10	JW
1	ISSUED FOR 75% REVIEW	03/03/10	JW

DESIGNED BY	SR/JW
DRAWN BY	JW/OV
CHECKED BY	JW/SR
APPROVED BY	-
HOR. SCALE	1:400
VERTICAL	
DATE	2010-03-26

LANDSCAPE ARCHITECT'S SEAL  
ORIGINAL SIGNED BY JACKIE WILKIE  
JACQUELINE L. WILKIE member no. 75  
CONSULTANT PROJECT NO. 08-028

THE CITY OF WINNIPEG  
TRANSIT DEPARTMENT

Winnipeg

SOUTHWEST RAPID TRANSIT CORRIDOR - STAGE 1  
TRANSITWAY CONSTRUCTION, LANDSCAPING & ASSOCIATED WORK

CITY DRAWING NUMBER P-3317-62  
SHEET 62 OF 72  
CONSULTANT DRAWING NUMBER C6-L-5000-T

LANDSCAPE WORKS  
TRANSITWAY 1 OF 6