

B SIZE 11" x 17" (279mm x 432mm)

PLOT: 7/5/2010 5:12:51 PM

FILE NAME: 60154221-01-C-104-R0X.dwg Saved By: berardk



BLUERIDGE BAY (S LEG)

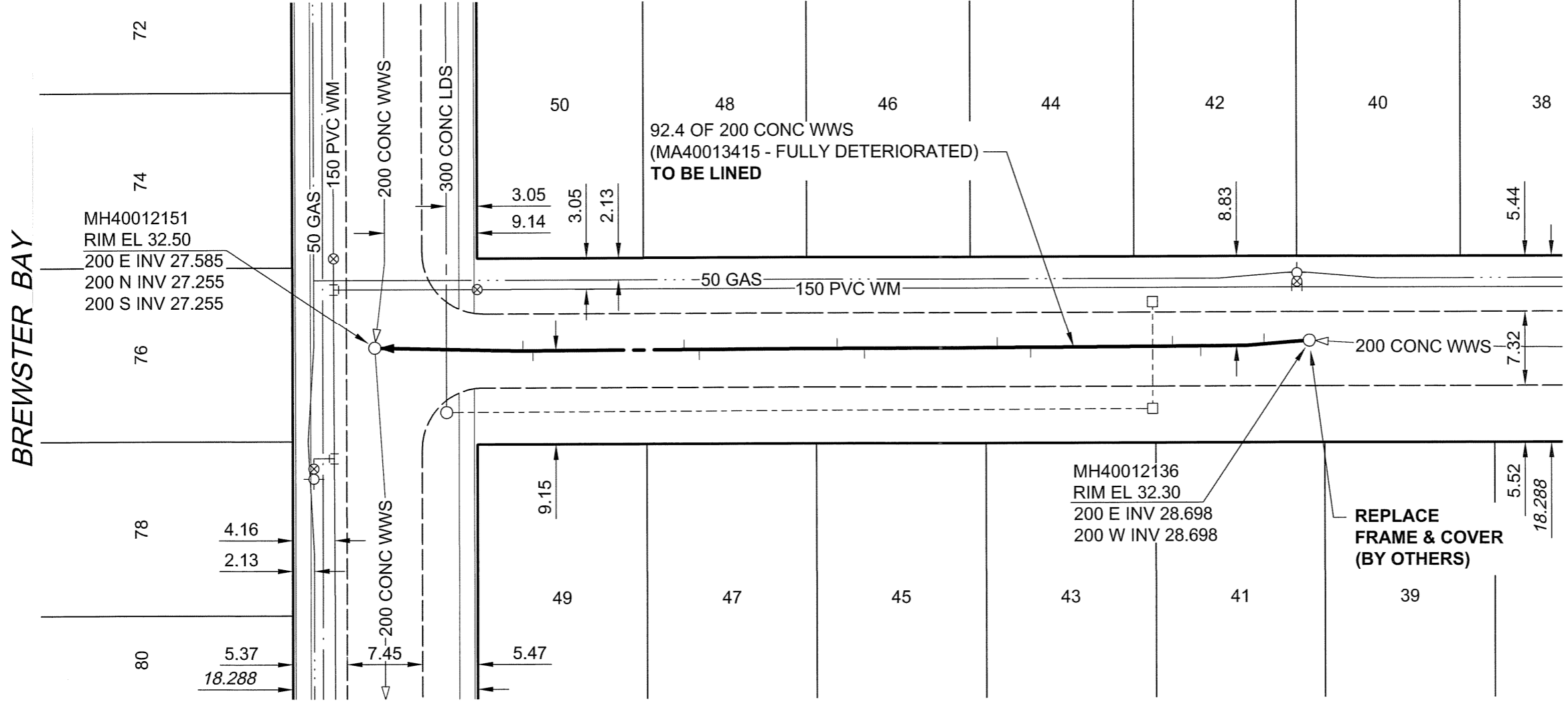

SEWER JUNCTION INFORMATION

REF MH*	DIST FROM* REF MH	SIZE*	CLOCK AT*
MH40012136	4.50	150Ø	01
MH40012136	10.80	150Ø	10
MH40012136	13.60	150Ø	01
MH40012136	27.60	150Ø	10
MH40012136	30.90	150Ø	02
MH40012136	44.00	150Ø	10
MH40012136	46.70	150Ø	03
MH40012136	60.40	150Ø	10
MH40012136	61.90	150Ø	02
MH40012136	76.80	150Ø	09
MH40012136	77.80	150Ø	02

*JUNCTION INFORMATION FROM VIDEO INSPECTION

APEGM
 Certificate of Authorization
 AECOM Canada Ltd.
 No. 4671 Date: 10/07/06

METRIC
 WHOLE NUMBERS INDICATE MILLIMETRES
 DECIMALIZED NUMBERS INDICATE METRES

BID OPPORTUNITY NO. 361-2010

AECOM REVIEW DRFT CHK

LOCATION APPROVED UNDERGROUND STRUCTURES

SUPR. U/G STRUCTURES DATE COMMITTEE

NOTE:
 LOCATION OF UNDERGROUND STRUCTURES AS SHOWN ARE BASED ON THE BEST INFORMATION AVAILABLE. BUT NO GUARANTEE IS GIVEN THAT ALL EXISTING UTILITIES ARE SHOWN OR THAT THE GIVEN LOCATIONS ARE EXACT. CONFIRMATION OF EXISTENCE AND EXACT LOCATION OF ALL SERVICES MUST BE OBTAINED FROM THE INDIVIDUAL UTILITIES BEFORE PROCEEDING WITH CONSTRUCTION.

BM 87R487 ELEV 232.250m	N.W. Cor. Brewster Bay (W. leg) & Kildare Ave. W., Tblt. on top of 0.05 m sq. x 2.4 m iron tube, 7.9 m S. of N.L. Kildare Ave. W. & on W.L. Brewster Bay (W. leg).
0	ISSUED FOR CONSTRUCTION 10/17/06 KMB
NO.	REVISIONS YY/MM/DD BY

AECOM		This drawing has been prepared for the use of AECOM's client and may not be used, reproduced or relied upon by third parties, except as agreed by AECOM and its client, as required by law or for use by governmental reviewing agencies. AECOM accepts no responsibility, and denies any liability whatsoever, to any party that modifies this drawing without AECOM's express written consent. Do not scale this document. All measurements must be obtained from stated dimensions.	
DESIGNED BY	ALD	CHECKED BY	PL
DRAWN BY	KMB	APPROVED BY	<i>[Signature]</i>
HOR. SCALE	1:500	RELEASED FOR CONSTRUCTION	<i>[Signature]</i>
VERT. SCALE	N/A	DATE	10/07/06

PROFESSIONAL'S SEAL

CONSULTANT DRAWING NO.
60154221-01-C-104-R0X.dwg

THE CITY OF WINNIPEG
WATER AND WASTE DEPARTMENT

2010 WASTE WATER SEWER RENEWALS
 BY CIPP LINING
 CONTRACT 13

BLUERIDGE BAY (S LEG)
 BREWSTER BAY
 TO 107m E OF BREWSTER BAY

SHEET 4 OF 73
 CITY DRAWING NUMBER
9230 REV 0