

B SIZE 11" x 17" (279mm x 432mm)

FILE NAME: 60154221-01-C-115-R0X.dwg Saved By: berardk

FILE NAME: 60154221-01-C-115-R0X.dwg Saved By: berardk

HORTON AVENUE EAST

WABASHA

STREET

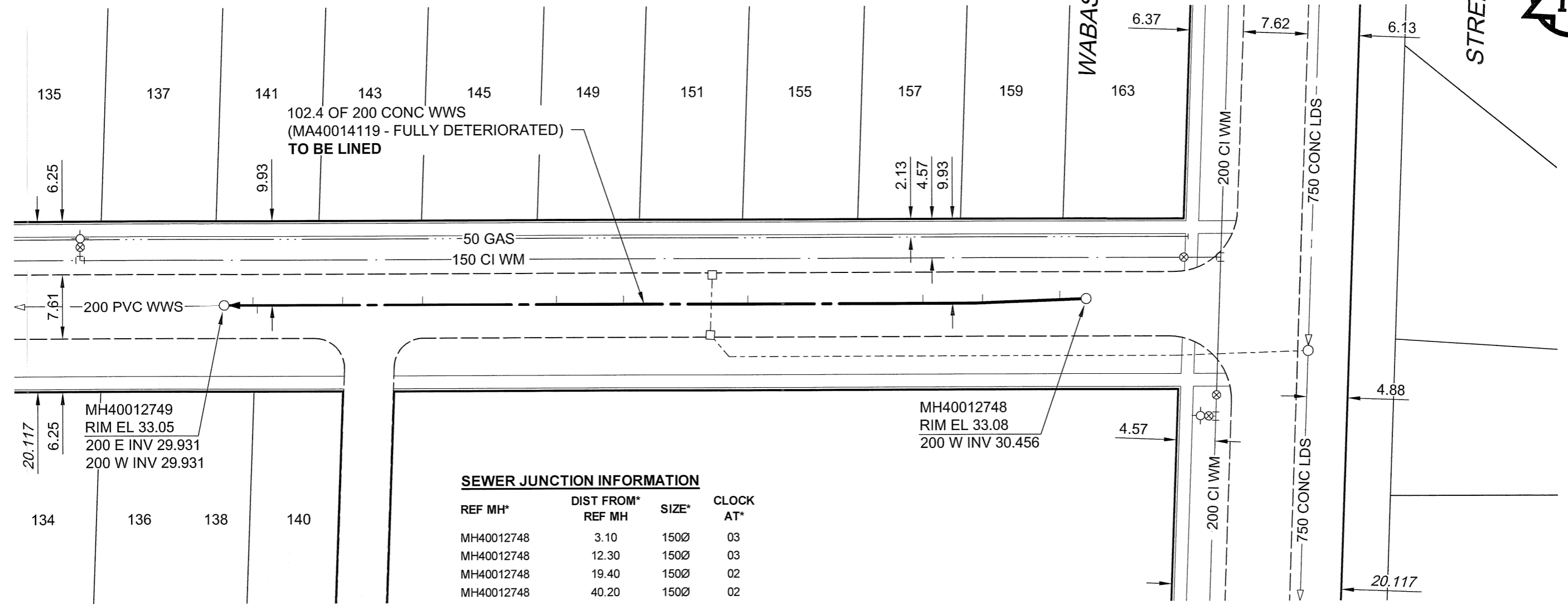

102.4 OF 200 CONC WWS
(MA40014119 - FULLY DETERIORATED)
TO BE LINED

SEWER JUNCTION INFORMATION

REF MH*	DIST FROM* REF MH	SIZE*	CLOCK AT*
MH40012748	3.10	150Ø	03
MH40012748	12.30	150Ø	03
MH40012748	19.40	150Ø	02
MH40012748	40.20	150Ø	02
MH40012748	54.90	150Ø	02
MH40012748	62.90	150Ø	02
MH40012748	78.80	150Ø	03
MH40012748	88.30	100Ø	02
MH40012748	98.40	150Ø	10
MH40012748	98.90	150Ø	02

*JUNCTION INFORMATION FROM VIDEO INSPECTION

METRIC

WHOLE NUMBERS INDICATE MILLIMETRES
DECIMALIZED NUMBERS INDICATE METRES

APEGM
Certificate of Authorization
AECOM Canada Ltd.
No. 4671 Date: 10/07/06

BID OPPORTUNITY NO. 361-2010

AECOM REVIEW DRAFT CHK

LOCATION APPROVED
UNDERGROUND STRUCTURES

BM 87R480
ELEV 233.427m

McMeans Ave. E. & Wabasha St., Tblt. on top of
0.05 m sq. x 2.4 m iron tube, 3.5 m S. of N.L. of
McMeans Ave. E. & 6.4 m W. of E.L. Wabasha St.

SUPR. U/G STRUCTURES DATE
COMMITTEE

NOTE:
LOCATION OF UNDERGROUND STRUCTURES
AS SHOWN ARE BASED ON THE BEST
INFORMATION AVAILABLE. BUT NO
GUARANTEE IS GIVEN THAT ALL EXISTING
UTILITIES ARE SHOWN OR THAT THE GIVEN
LOCATIONS ARE EXACT. CONFIRMATION OF
EXISTENCE AND EXACT LOCATION OF ALL
SERVICES MUST BE OBTAINED FROM THE
INDIVIDUAL UTILITIES BEFORE PROCEEDING
WITH CONSTRUCTION.

NO.	REVISIONS	YY/MM/DD	BY
0	ISSUED FOR CONSTRUCTION	10/7/06	KMB

AECOM

This drawing has been prepared for the use of AECOM's client and may not be used, reproduced or relied upon by third parties, except as agreed by AECOM and its client, as required by law or for use by governmental reviewing agencies. AECOM accepts no responsibility, and denies any liability whatsoever, to any party that modifies this drawing without AECOM's express written consent. Do not scale this document. All measurements must be obtained from stated dimensions.

DESIGNED BY	ALD	CHECKED BY	PL
DRAWN BY	KMB	APPROVED BY	<i>[Signature]</i>
HOR. SCALE	1:500	RELEASED FOR CONSTRUCTION	<i>[Signature]</i>
VERT. SCALE	N/A	DATE	10/07/06

PROFESSIONAL'S SEAL

PROVINCE OF MANITOBA
66 July 2019
C. C. MACEY
REGISTERED ENGINEER

CONSULTANT DRAWING NO.
60154221-01-C-115-R0X.dwg

THE CITY OF WINNIPEG
WATER AND WASTE DEPARTMENT

2010 WASTE WATER SEWER RENEWALS
BY CIPP LINING
CONTRACT 13
HORTON AVENUE EAST
166m E OF DAY STREET
TO WABASHA STREET

SHEET 15 OF 73
CITY DRAWING NUMBER
9241
REV 0