

LAURENTIA BAY (W LEG)

WIDLAKE STREET

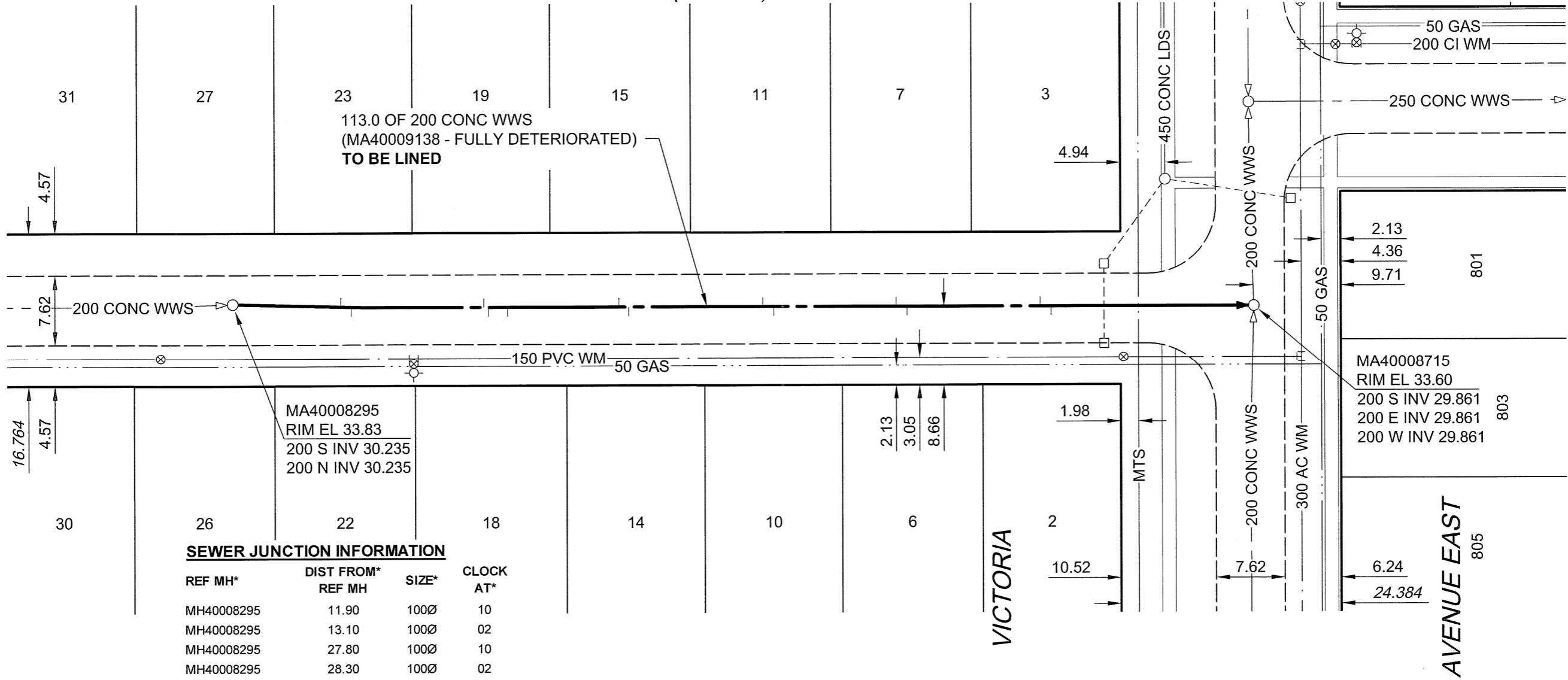

SEWER JUNCTION INFORMATION

REF MH*	DIST FROM* REF MH	SIZE*	CLOCK AT*
MH40008295	11.90	100Ø	10
MH40008295	13.10	100Ø	02
MH40008295	27.80	100Ø	10
MH40008295	28.30	100Ø	02
MH40008295	30.40	100Ø	02
MH40008295	42.70	100Ø	09
MH40008295	43.80	100Ø	02
MH40008295	58.60	100Ø	10
MH40008295	59.80	100Ø	02
MH40008295	73.40	100Ø	10
MH40008295	74.60	100Ø	02
MH40008295	89.30	100Ø	10
MH40008295	90.50	100Ø	02

*JUNCTION INFORMATION FROM VIDEO INSPECTION

METRIC
WHOLE NUMBERS INDICATE MILLIMETRES
DECIMALIZED NUMBERS INDICATE METRES

APEGM
Certificate of Authorization
AECOM Canada Ltd.
No. 4671 Date: 10/07/06

BID OPPORTUNITY NO. 361-2010

AECOM REVIEW DRFT CHK

LOCATION APPROVED
UNDERGROUND STRUCTURES

SUPR. U/G STRUCTURES COMMITTEE DATE

NOTE:
LOCATION OF UNDERGROUND STRUCTURES AS SHOWN ARE BASED ON THE BEST INFORMATION AVAILABLE. BUT NO GUARANTEE IS GIVEN THAT ALL EXISTING UTILITIES ARE SHOWN OR THAT THE GIVEN LOCATIONS ARE EXACT. CONFIRMATION OF EXISTENCE AND EXACT LOCATION OF ALL SERVICES MUST BE OBTAINED FROM THE INDIVIDUAL UTILITIES BEFORE PROCEEDING WITH CONSTRUCTION.

0	ISSUED FOR CONSTRUCTION	10/17/06	KMB
NO.	REVISIONS	YY/MM/DD	BY

AECOM

This drawing has been prepared for the use of AECOM's client and may not be used, reproduced or relied upon by third parties, except as agreed by AECOM and its client, as required by law or for use by governmental reviewing agencies. AECOM accepts no responsibility, and denies any liability whatsoever, to any party that modifies this drawing without AECOM's express written consent. Do not scale this document. All measurements must be obtained from stated dimensions.

DESIGNED BY	ALD	CHECKED BY	PL
DRAWN BY	KMB	APPROVED BY	Bygnalelaba
HOR. SCALE	1:500	RELEASED FOR CONSTRUCTION	X
VERT. SCALE	N/A	DATE	July 6/10
DATE	10/07/06		

PROFESSIONAL'S SEAL

PROVINCE OF MANITOBA
06 July 2010
C.C. MACEY
REGISTERED ENGINEER

CONSULTANT DRAWING NO.
60154221-01-C-120-R0X.dwg

THE CITY OF WINNIPEG
WATER AND WASTE DEPARTMENT

2010 WASTE WATER SEWER RENEWALS
BY CIPP LINING
CONTRACT 13
LAURENTIA BAY (W LEG)
80m N OF LAURENTIA BAY (S LEG)
TO VICTORIA AVENUE EAST

SHEET 20 OF 73
CITY DRAWING NUMBER
9246
REV 0