

B SIZE 11" x 17" (279mm x 432mm)

PLOT: 7/5/2010 5:19:11 PM

FILE NAME: 60154221-01-C-139-R0X.dwg Saved By: berardk



REGENT AVENUE WEST

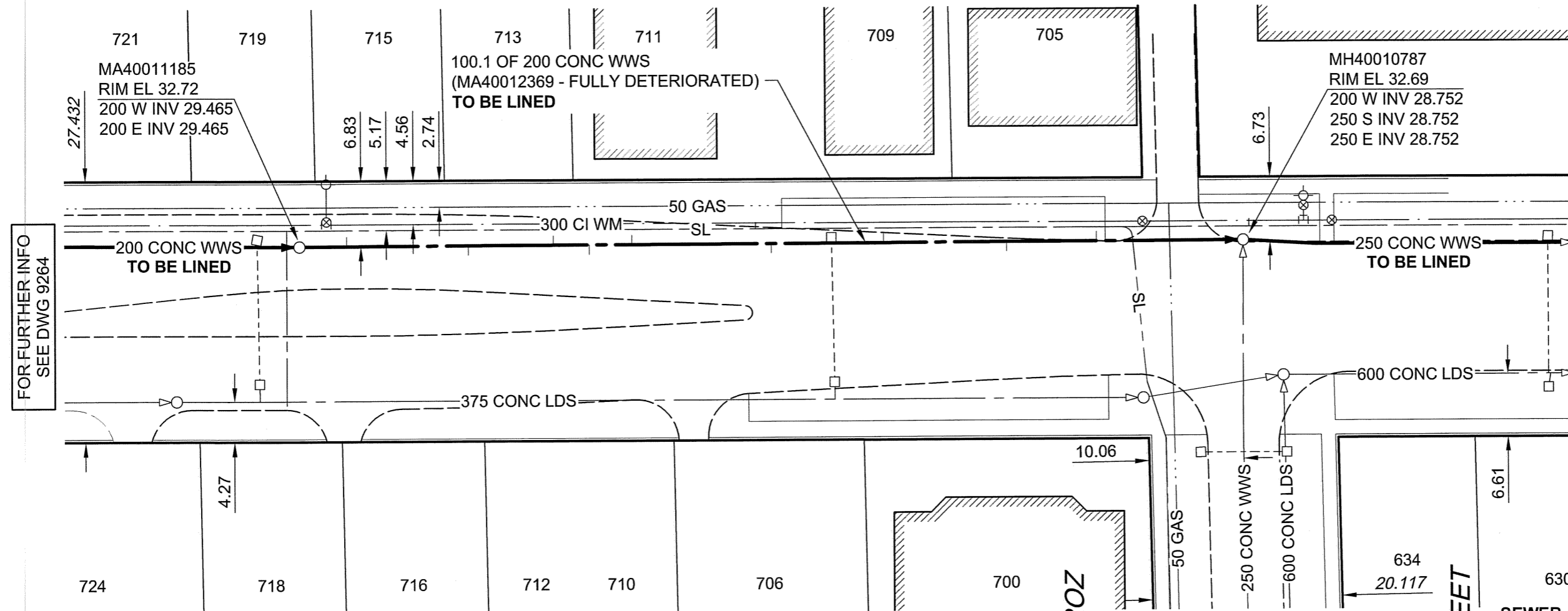

FOR FURTHER INFO
SEE DWG 9264

FOR FURTHER INFO
SEE DWG 9266

SEWER JUNCTION INFORMATION

REF MH*	DIST FROM* REF MH	SIZE*	CLOCK AT*
MH40011185	5.00	100Ø	10
MH40011185	17.90	100Ø	03
MH40011185	27.00	100Ø	11
MH40011185	30.80	100Ø	01
MH40011185	35.30	100Ø	10
MH40011185	50.10	100Ø	02
MH40011185	62.00	100Ø	10
MH40011185	75.10	100Ø	02
MH40011185	84.60	100Ø	10

*JUNCTION INFORMATION FROM VIDEO INSPECTION

BID OPPORTUNITY NO. 361-2010

METRIC
WHOLE NUMBERS INDICATE MILLIMETRES
DECIMALIZED NUMBERS INDICATE METRES

APEGM
Certificate of Authorization
AECOM Canada Ltd.
No. 4671 Date: 10/07/06

LOCATION APPROVED
UNDERGROUND STRUCTURES

SUPR. U/G STRUCTURES COMMITTEE DATE

NOTE:
LOCATION OF UNDERGROUND STRUCTURES AS SHOWN ARE BASED ON THE BEST INFORMATION AVAILABLE. BUT NO GUARANTEE IS GIVEN THAT ALL EXISTING UTILITIES ARE SHOWN OR THAT THE GIVEN LOCATIONS ARE EXACT. CONFIRMATION OF EXISTENCE AND EXACT LOCATION OF ALL SERVICES MUST BE OBTAINED FROM THE INDIVIDUAL UTILITIES BEFORE PROCEEDING WITH CONSTRUCTION.

BM 87R498 ELEV 232.489m	N.W. Cor. Ravelston Ave. W. & Brewster St. Tbit. on top of 0.05 m sq. x 2.4 m iron tube, 16.3 m S. of most Sly. wall & 2.7 m E. of E. wall No. 701 Ravelston Ave. W. or 17.1 m N. of S.L. Ravelston Ave. W. & on W.L. of Brewster St.		
NO.	REVISIONS	YY/MM/DD	BY
0	ISSUED FOR CONSTRUCTION	10/1/06	KMB

AECOM

This drawing has been prepared for the use of AECOM's client and may not be used, reproduced or relied upon by third parties, except as agreed by AECOM and its client, as required by law or for use by governmental reviewing agencies. AECOM accepts no responsibility, and denies any liability whatsoever, to any party that modifies this drawing without AECOM's express written consent. Do not scale this document. All measurements must be obtained from stated dimensions.

DESIGNED BY	ALD	CHECKED BY	PL
DRAWN BY	KMB	APPROVED BY	<i>[Signature]</i>
HOR. SCALE	1:500	RELEASED FOR CONSTRUCTION	<i>[Signature]</i>
VERT. SCALE	N/A	DATE	10/07/06

PROFESSIONAL'S SEAL
PROVINCE OF MANITOBA
07 July 2010
C. C. MACEY
REGISTERED ENGINEER
CONSULTANT DRAWING NO.
60154221-01-C-139-R0X.dwg

THE CITY OF WINNIPEG
WATER AND WASTE DEPARTMENT

2010 WASTE WATER SEWER RENEWALS
BY CIPP LINING
CONTRACT 13

REGENT AVENUE WEST (N OF CL)
80m E OF PLESSIS ROAD
TO MOROZ STREET

SHEET 39 OF 73
CITY DRAWING NUMBER
9265
REV 0