

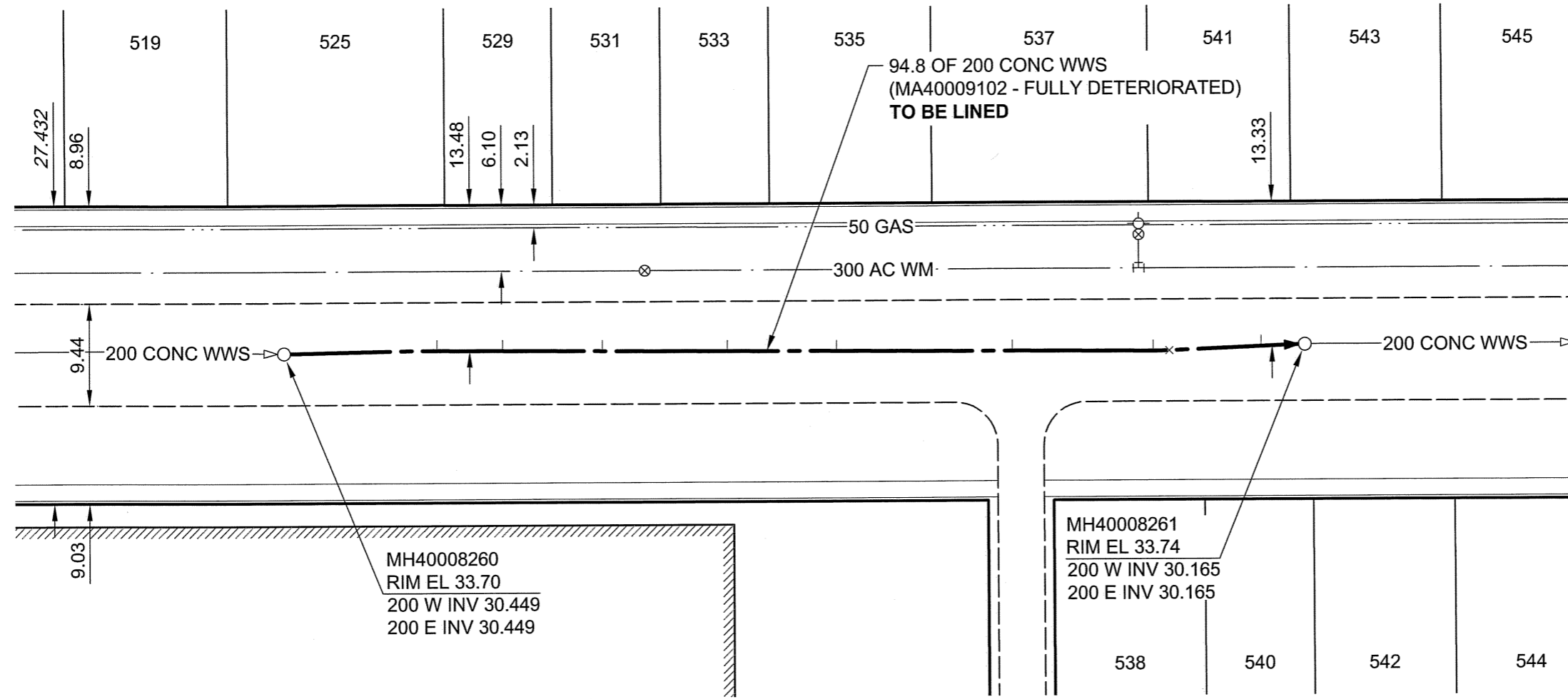

### REGENT AVENUE EAST



#### SEWER JUNCTION INFORMATION

REF MH*	DIST FROM* REF MH	SIZE*	CLOCK AT*
MH40008260	14.20	150Ø	10
MH40008260	20.30	150Ø	10
MH40008260	29.60	150Ø	09
MH40008260	41.20	150Ø	09
MH40008260	51.30	150Ø	09
MH40008260	67.60	150Ø	09
MH40008260	80.70	150Ø	09
MH40008260	82.20	150Ø	12
MH40008260	90.70	150Ø	09

\*JUNCTION INFORMATION FROM VIDEO INSPECTION

BID OPPORTUNITY NO. 361-2010

**AECOM**  
 Certificate of Authorization  
 AECOM Canada Ltd.  
 No. 4671 Date: 10/07/06

**METRIC**  
 WHOLE NUMBERS INDICATE MILLIMETRES  
 DECIMALIZED NUMBERS INDICATE METRES



This drawing has been prepared for the use of AECOM's client and may not be used, reproduced or relied upon by third parties, except as agreed by AECOM and its client, as required by law or for use by governmental reviewing agencies. AECOM accepts no responsibility, and denies any liability whatsoever, to any party that modifies this drawing without AECOM's express written consent. Do not scale this document. All measurements must be obtained from stated dimensions.

DESIGNED BY	ALD	CHECKED BY	PL
DRAWN BY	KMB	APPROVED BY	<i>[Signature]</i>
HOR. SCALE	1:500	RELEASED FOR CONSTRUCTION	<i>[Signature]</i>
VERT. SCALE	N/A	DATE	10/07/06

PROFESSIONAL'S SEAL  
 PROVINCE OF MANITOBA  
 06 July 2010  
 C. C. MACEY  
 REGISTERED ENGINEER  
 CONSULTANT DRAWING NO.  
 60154221-01-C-141-R0X.dwg

**THE CITY OF WINNIPEG**  
 WATER AND WASTE DEPARTMENT  
 2010 WASTE WATER SEWER RENEWALS  
 BY CIPP LINING  
 CONTRACT 13  
 REGENT AVENUE EAST  
 92m E OF LEOLA STREET  
 TO 66m W OF WAYOTA STREET

SHEET 41 OF 73  
 CITY DRAWING NUMBER  
**9267**  
 REV 0

**LOCATION APPROVED**  
 UNDERGROUND STRUCTURES

BM 87R491  
 ELEV 233.681m  
 Wayota St. @ Ravelston Ave. E., Tblt. on top of 0.05 m sq. x 2.4 m iron tube, 16.4 m E. of W. L. Wayota St. & 8 m N. of S.L. Ravelston Ave. E.

SUPR. U/G STRUCTURES COMMITTEE DATE

NOTE:  
 LOCATION OF UNDERGROUND STRUCTURES AS SHOWN ARE BASED ON THE BEST INFORMATION AVAILABLE. BUT NO GUARANTEE IS GIVEN THAT ALL EXISTING UTILITIES ARE SHOWN OR THAT THE GIVEN LOCATIONS ARE EXACT. CONFIRMATION OF EXISTENCE AND EXACT LOCATION OF ALL SERVICES MUST BE OBTAINED FROM THE INDIVIDUAL UTILITIES BEFORE PROCEEDING WITH CONSTRUCTION.

NO.	REVISIONS	YY/MM/DD	BY
0	ISSUED FOR CONSTRUCTION	10/7/06	KMB