

WHITEHALL BOULEVARD

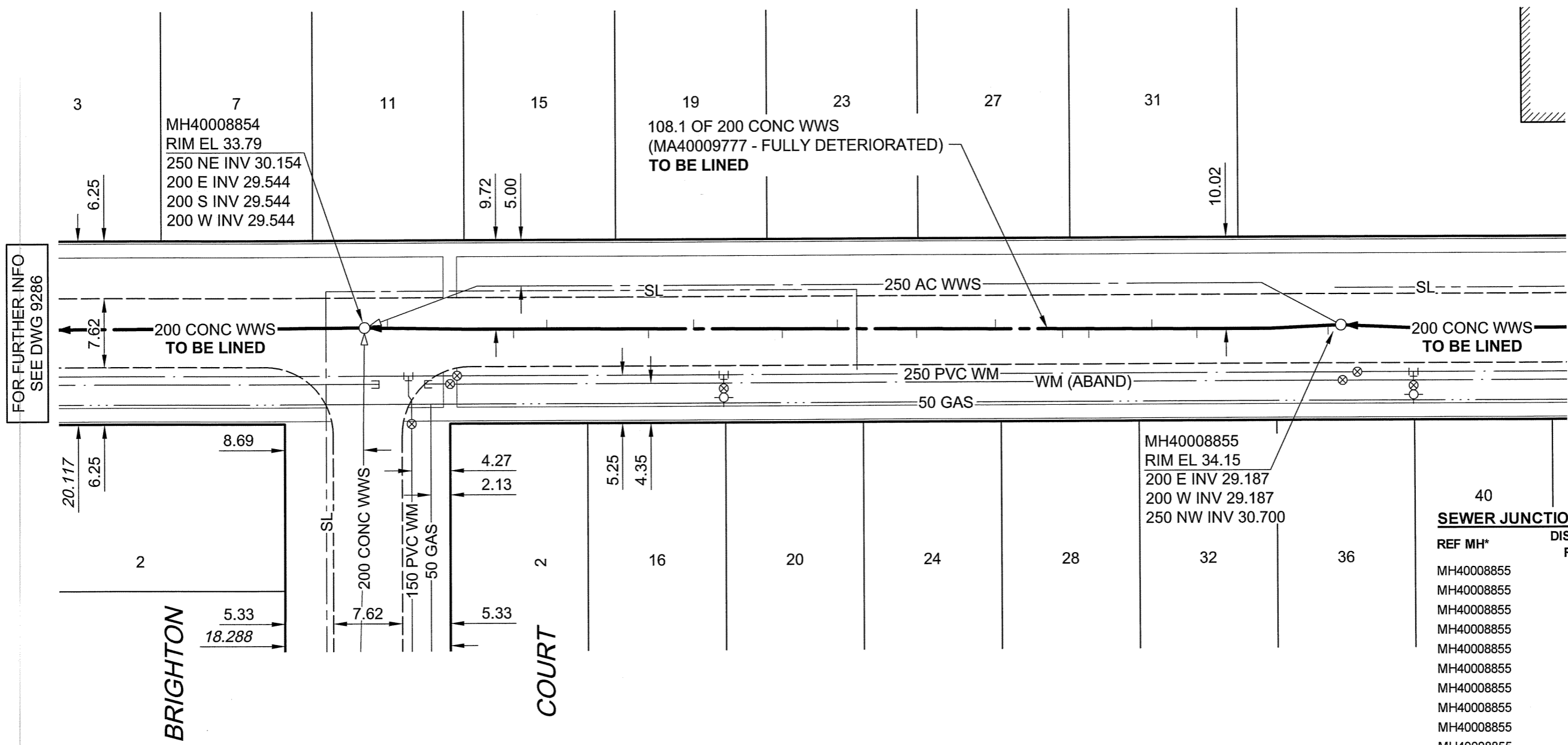

FOR FURTHER INFO
SEE DWG 9286

FOR FURTHER INFO
SEE DWG 9288

SEWER JUNCTION INFORMATION			
REF MH*	DIST FROM* REF MH	SIZE*	CLOCK AT*
MH40008855	1.40	150Ø	09
MH40008855	15.90	150Ø	11
MH40008855	20.90	150Ø	01
MH40008855	27.90	150Ø	11
MH40008855	30.80	150Ø	11
MH40008855	38.20	150Ø	01
MH40008855	46.90	150Ø	11
MH40008855	55.70	150Ø	01
MH40008855	61.80	150Ø	11
MH40008855	71.60	150Ø	01
MH40008855	76.60	150Ø	11
MH40008855	87.80	150Ø	01
MH40008855	91.50	150Ø	11
MH40008855	105.50	150Ø	01

*JUNCTION INFORMATION FROM VIDEO INSPECTION

BID OPPORTUNITY NO. 361-2010

METRIC
WHOLE NUMBERS INDICATE MILLIMETRES
DECIMALIZED NUMBERS INDICATE METRES

APEGM
Certificate of Authorization
AECOM Canada Ltd.
No. 4671 Date: 10/07/06

PROFESSIONAL'S SEAL
PROVINCE OF MANITOBA
06 July 2010
C. C. MACEY
REGISTERED ENGINEER
CONSULTANT DRAWING NO.
60154221-01-C-161-R0X.dwg

THE CITY OF WINNIPEG
WATER AND WASTE DEPARTMENT
2010 WASTE WATER SEWER RENEWALS
BY CIPP LINING
CONTRACT 13
WHITEHALL BOULEVARD
BRIGHTON COURT
TO 75m W OF SOUTHAMPTON PLACE

SHEET 61 OF 73
CITY DRAWING NUMBER
9287
REV 0

LOCATION APPROVED UNDERGROUND STRUCTURES

SUPR. U/G STRUCTURES	DATE

NOTE:
LOCATION OF UNDERGROUND STRUCTURES AS SHOWN ARE BASED ON THE BEST INFORMATION AVAILABLE. BUT NO GUARANTEE IS GIVEN THAT ALL EXISTING UTILITIES ARE SHOWN OR THAT THE GIVEN LOCATIONS ARE EXACT. CONFIRMATION OF EXISTENCE AND EXACT LOCATION OF ALL SERVICES MUST BE OBTAINED FROM THE INDIVIDUAL UTILITIES BEFORE PROCEEDING WITH CONSTRUCTION.

NO.	REVISIONS	YY/MM/DD	BY
0	ISSUED FOR CONSTRUCTION	10/17/06	KMB

N.E. Cor. Kildare Ave. E. & Wayoata St.
Tbtl. on top of 0.05 m dia. x 2.4 m iron pipe, 5.94 m S. of N.L. of Kildare Ave. E. and 16.92 m E. of W. L. of Wayoata St.

BM 81R943
ELEV 233.269m

AECOM

DESIGNED BY	ALD	CHECKED BY	PL
DRAWN BY	KMB	APPROVED BY	<i>[Signature]</i>
HOR. SCALE	1:500	RELEASED FOR CONSTRUCTION	<i>[Signature]</i>
VERT. SCALE	N/A	DATE	10/07/06

AECOM REVIEW DRFT CHK