

- General Notes**
- All elevations are Geodetic and in Meters
 - All dimensions are in meters unless otherwise noted
 - Contractor is to verify dimensions and grade information prior to beginning construction. Contractor is to report any discrepancies to the contract administrator immediately.
 - Contractor is to obtain all necessary permits and approvals prior to beginning construction. Contractor is further to ensure that all work is inspected and/or reviewed by municipal authorities as required by those authorities as part of the permitting / inspecting process.
 - Contractor is to obtain location of all utilities prior to construction. If using power equipment to excavate contractor must notify Hydro and Gas and telephone utilities and take steps to avoid damaging their installations. Contractor is advised that the site contains an existing oil pipeline. Contractor is to have pipeline located and to obtain clearance to dig prior to starting work. Contractor is to take all reasonable and prudent steps to ensure that work does not impact the existing oil pipeline.
 - All existing trees, sidewalks, curbs, catch basins, culverts, survey markers, to remain are to be protected during construction. Any damage to them is to be made good by the Contractor. Maintain positive drainage into all catch basins and curb inlets.
 - Contractor is to limit operations to the area within the area of work shown on the drawing. Should areas outside this limit be damaged during the course of construction, Contractor is to make good the damage at his own expense proceeding with grading operations. Any deviation from the stated slopes is to be approved by the Contract Administrator prior to construction.
 - Proposed Catch Basin elevations taken from drawing C-1 by MEC Engineering Inc. Spot elevations are to govern over contour information.
 - Contractor is advised that existing grades are given as information only and should be verified on site. Any discrepancies are to be reported to the Contract Administrator.
 - All grades shown are FINISH GRADES. Rough grading operations should establish a "mud" grade sufficiently below finish grade to allow for surface materials. Grading contractor is to establish rough grade within +/- 2.5 cm.
 - Rough grade in areas to be sodded are to be 10 cm. below finish grade. Slopes are to be maximum 25% and minimum 1%
 - All construction traffic shall be restricted to the limits of construction shown on the drawings and using access routes agreed to in advance by the contract administrator prior to starting work.
 - Excavation equipment shall be track based.
 - Excavate in a manner to minimize damage to the tree root systems. Keep exposed roots in excavations and trenches moist or shaded. If stockpiling of excavated soil material is required, stockpile in areas away from the tree roots if possible.
 - For deciduous trees greater than 100 mm in diameter, located within 3 meters of the limits of construction, attach wood strapping material having a minimum thickness of 25 millimetres and minimum length of 2440 millimetres around the tree trunks in a manner that will not harm the trees. Do not use nails or other fasteners that penetrate the tree trunk. The width of the strapping may be reduced to suit tree being protected. Length of strapping may be reduced to suit tree being protected as approved by the Contract Administrator.
 - For deciduous trees less than 100 mm in diameter, install PVC safety fencing around the tree to a 2.0 metre radius complete with installation hardware, to adequately support the safety fence. The 2.0 metre radius safety fence may be reduced to suit the tree being protected as approved by the Contract Administrator.
 - Obtain approval from the Contract Administrator to excavate within 2.0 metres of a tree.
 - Operation of equipment within the dripline of the trees shall be kept to the minimum required to perform the Work and shall be approved by the Contract Administrator prior to the commencement of Work. Equipment shall not be parked, repaired, refuelled; construction materials shall not be stored, and earth materials shall not be stockpiled within the driplines of the trees. The dripline of a tree shall be considered to be the ground surface directly beneath tree from the tree trunk to the tips of its outermost branches. The Contractor shall ensure that the operations do not cause flooding or sediment deposition on areas where trees are located.

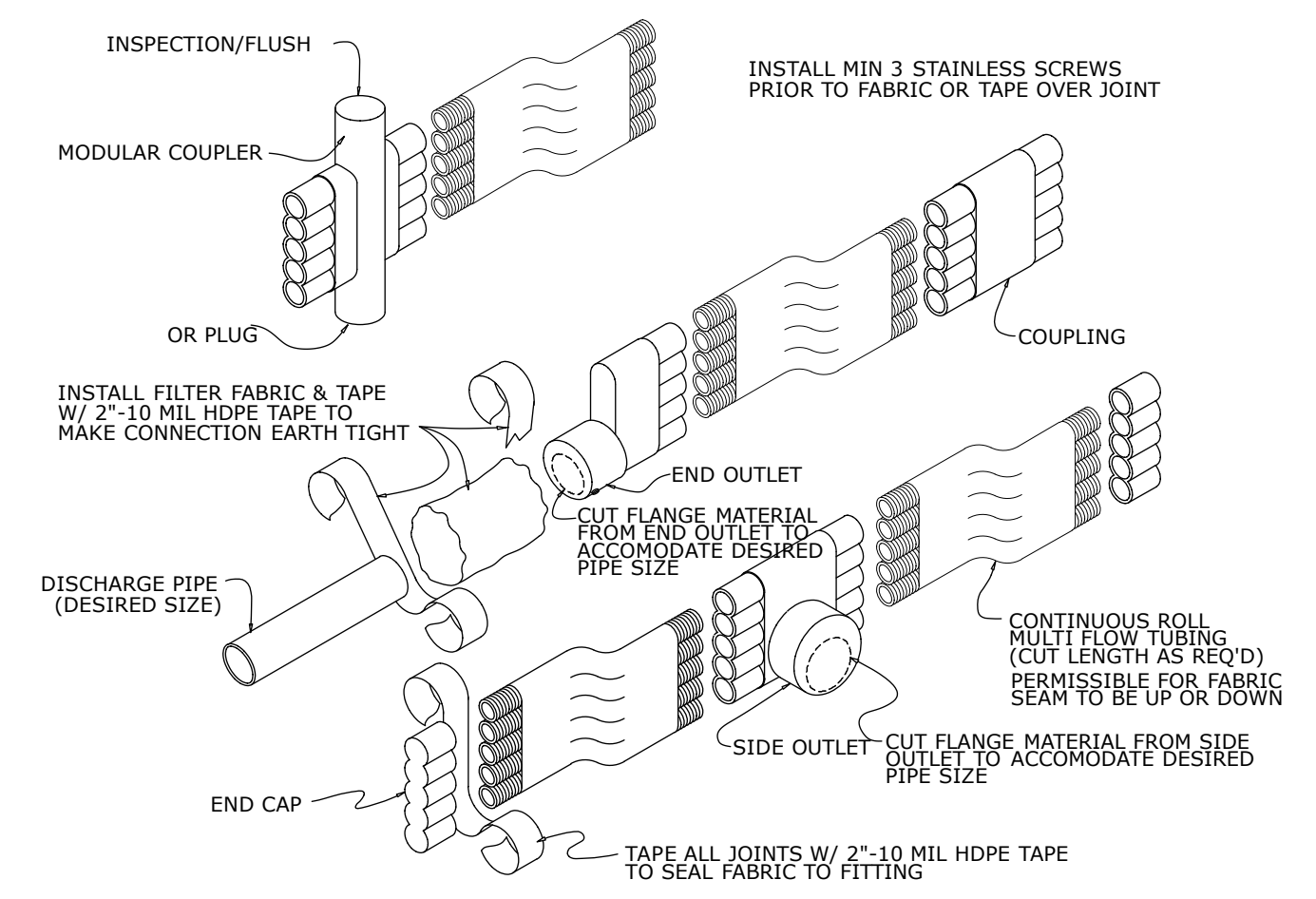

3 Multi-Flo Connection Details
L-1 Scale: 1:5

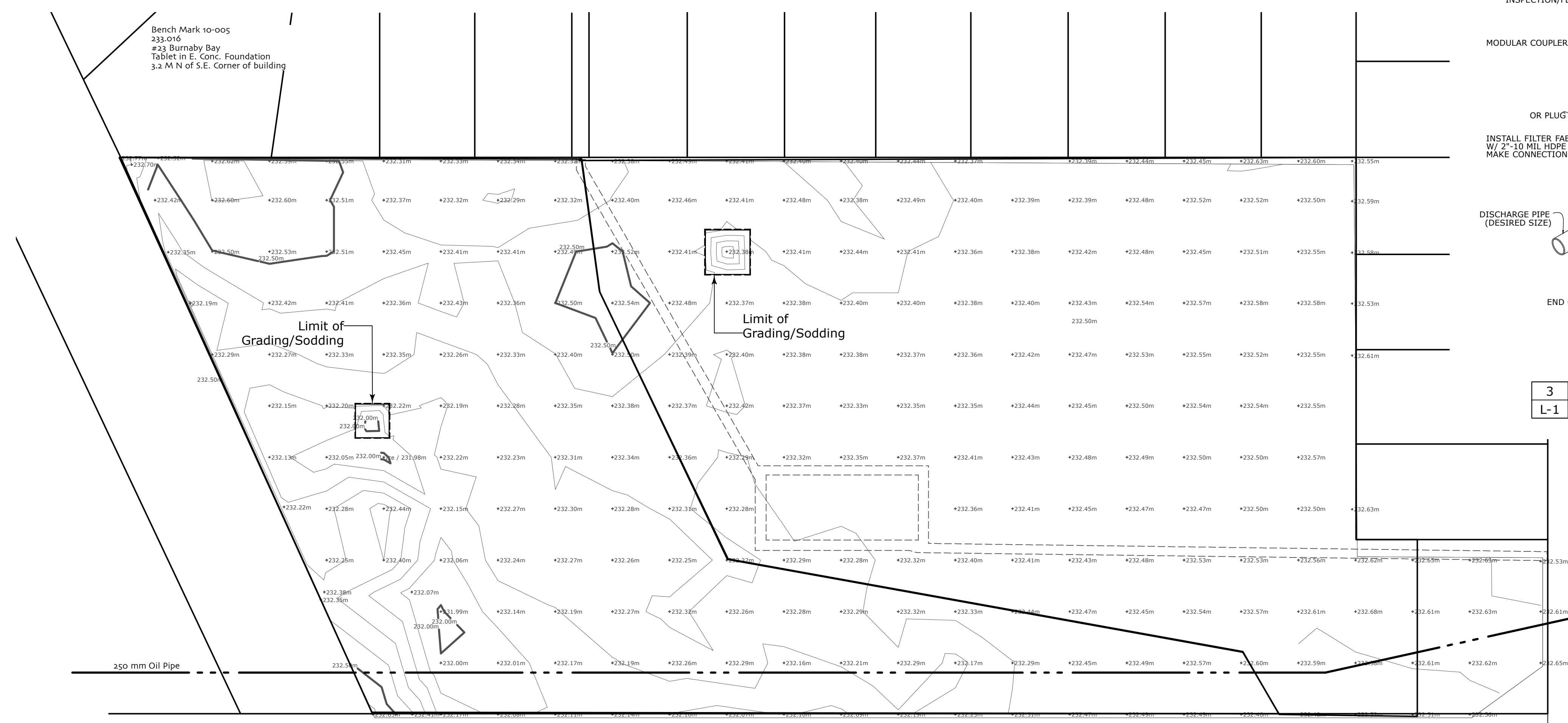

1 Site Grading / Drainage Plan
L-1 Scale: 1:500

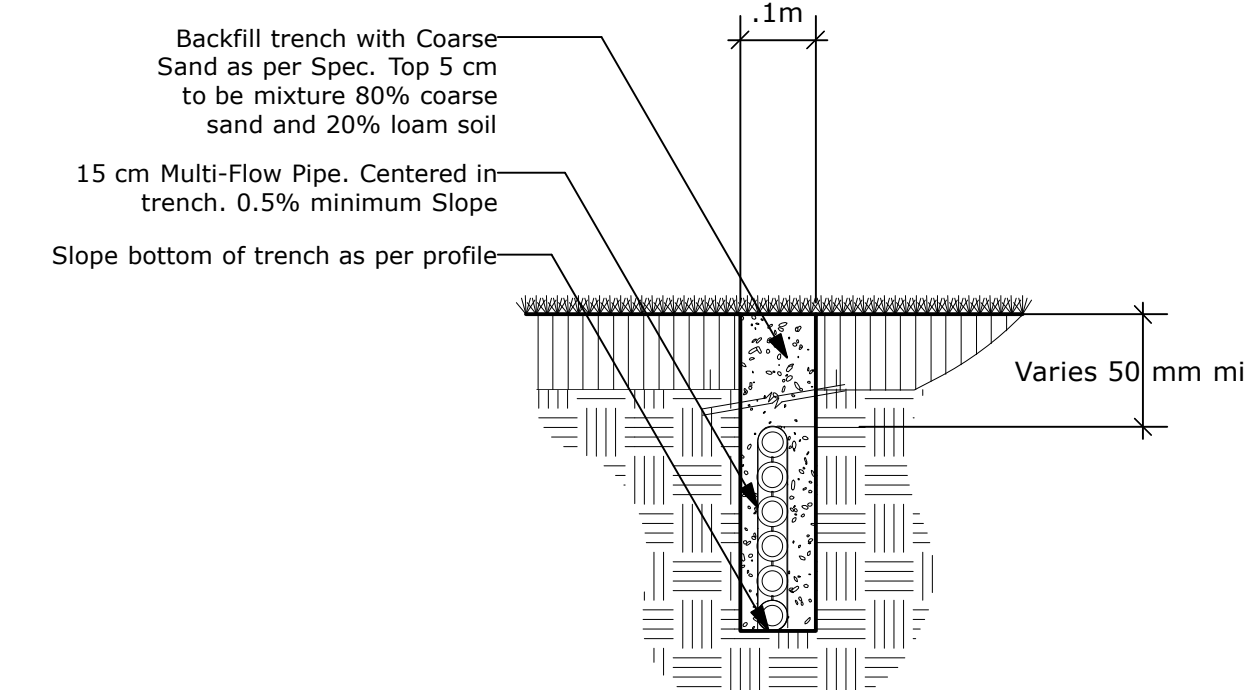
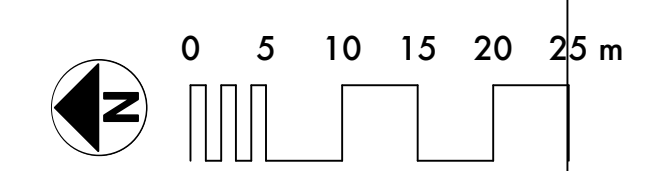

4 Multi-Flow Trench Through Sod
L-1 Scale: 1:10

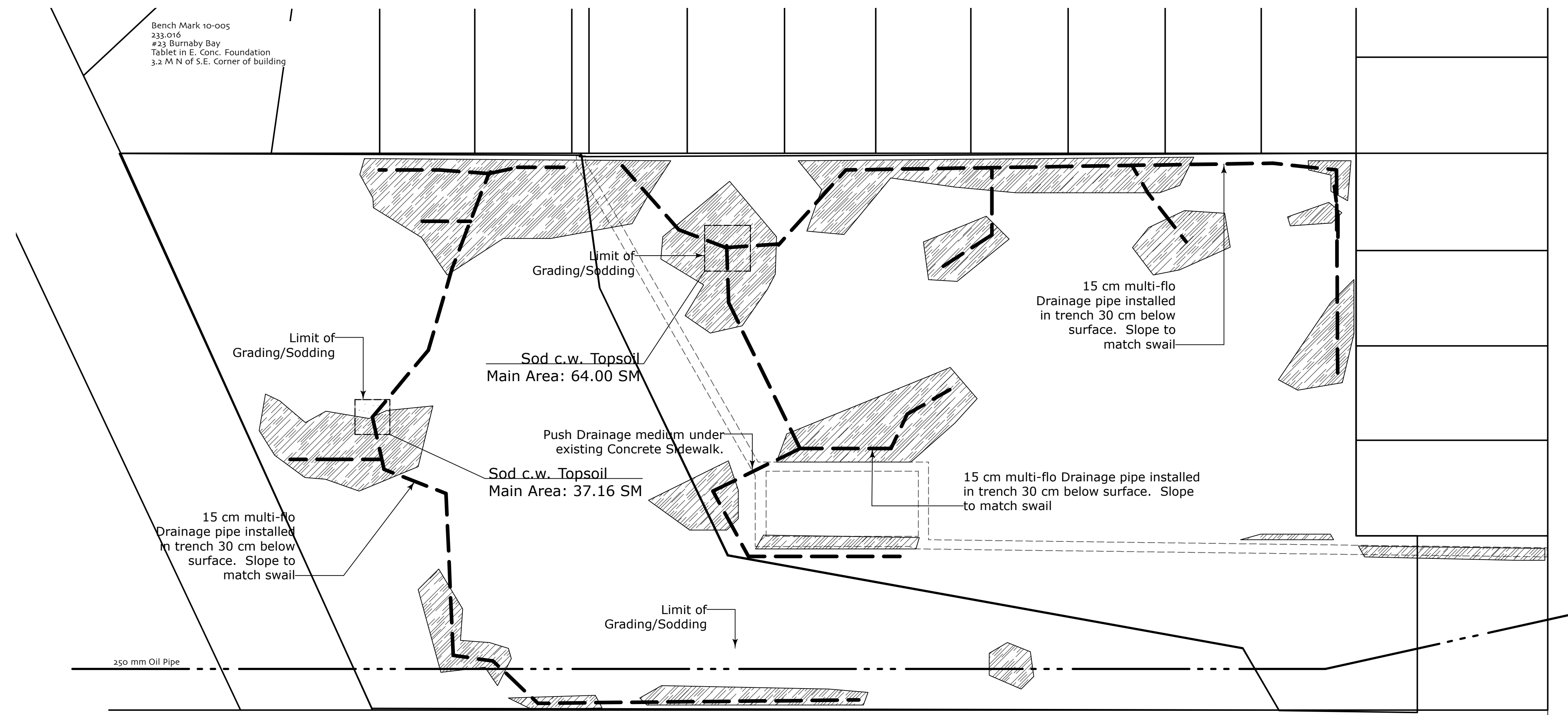

2 Landscape Plan
L-1 Scale: 1:500

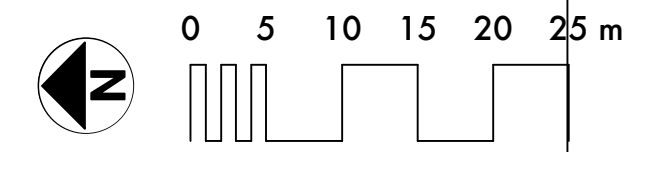

No.	Date	Issue Notes
1	3/04/09	

Consultant:	
Project Title:	Transcona - Kiwanis Park Site Drainage Improvements
Drawing Title:	Site Plan
Drawing No.:	L-1