

DUNKIRK DRIVE

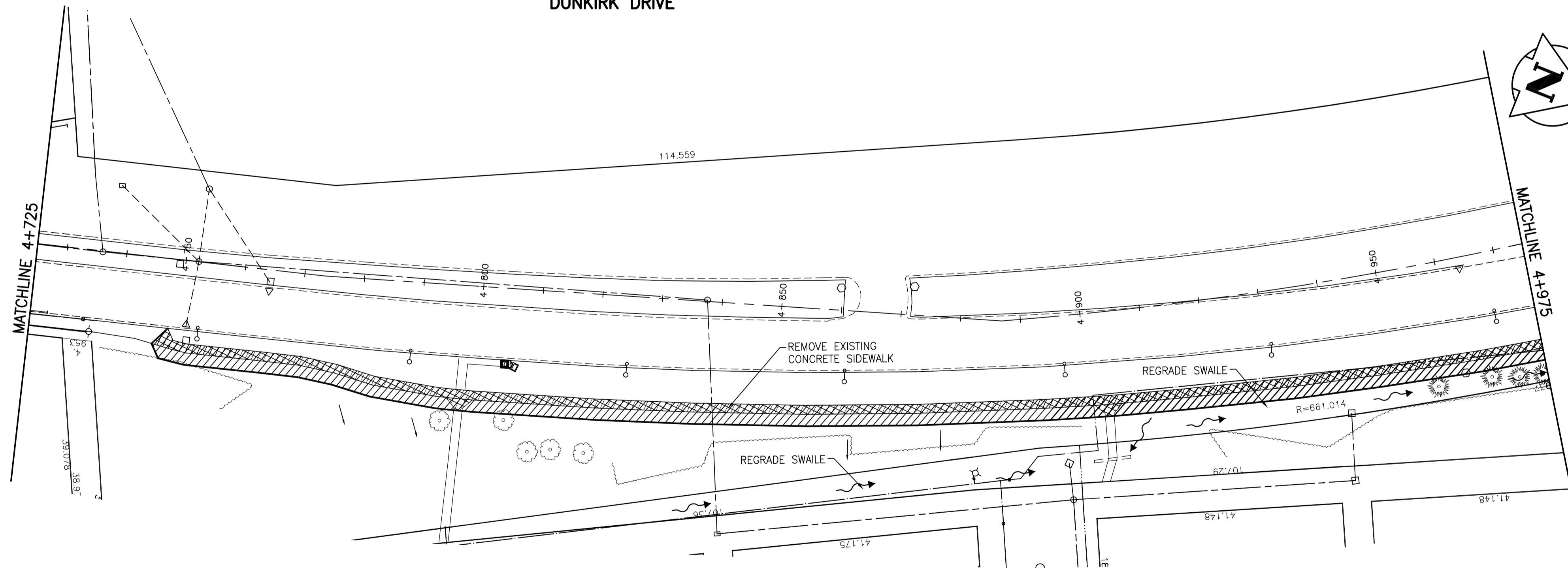

**WARNING**

IF POWER EQUIPMENT OR EXPLOSIVES ARE TO BE USED FOR EXCAVATION ON THIS PROJECT THE CONTRACTOR MUST:  
 1) NOTIFY THE GAS COMPANY OF THE PROPOSED LOCATION OF EXCAVATION.  
 2) TAKE PRECAUTION TO AVOID DAMAGE TO GAS COMPANY INSTALLATIONS.  
 SEE PROVINCIAL REGULATION 140/92 FOR DETAILS

**METRIC**

WHOLE NUMBERS INDICATE MILLIMETRES  
 DECIMALIZED NUMBERS INDICATE METRES

EXISTING	LEGEND-PLAN	PROPOSED	EXISTING	LEGEND-PLAN	PROPOSED	EXISTING	LEGEND-PROFILE	PROPOSED
150 WM	WATERMAIN	150 WM	HYDRO	HYDRO	150 WM	WATERMAIN	WATERMAIN	150 WM
300 LDS	LAND DRAINAGE SEWER	300 LDS	M.T.S.	M.T.S.	300 LDS	HYDRANT, VALVE	HYDRANT, VALVE	300 LDS
250 WWS	WASTE WATER SEWER	250 WWS	CONCRETE	CONCRETE	250 WWS	LAND DRAINAGE SEWER	LAND DRAINAGE SEWER	250 WWS
○	MANHOLE	●	ASPHALT	ASPHALT	○	WASTE WATER SEWER	WASTE WATER SEWER	○
□	CATCH BASIN	■	SIDEWALK REMOVAL	SIDEWALK REMOVAL	×	250 WWS	250 WWS	×
▽	CURB INLET	▲	SIDEWALK	SIDEWALK	□	○ PROFILE	○ PROFILE	□
+	JUNCTIONS	+	PROPERTY LINE	PROPERTY LINE	○	○	○	○
▬▬▬	CULVERT	▬▬▬	SURVEY BAR	SURVEY BAR	◇	○	○	○
▬▬▬	GAS	▬▬▬	DITCH	DITCH	◇	○	○	○
▬▬▬	LEGEND-PLAN	▬▬▬	ELEVATION	ELEVATION	△	○	○	○
▬▬▬	PROPOSED	▬▬▬	SIDEWALK RAMP	SIDEWALK RAMP	▽	○	○	○
▬▬▬	EXISTING	▬▬▬	LEGEND-PLAN	LEGEND-PROFILE	▽	○	○	○
▬▬▬	PROPOSED	▬▬▬	LEGEND-PLAN	LEGEND-PROFILE	▽	○	○	○

**LOCATION APPROVED UNDERGROUND STRUCTURES**

NOTE:  
 LOCATION OF UNDERGROUND STRUCTURES AS SHOWN ARE BASED ON THE BEST INFORMATION AVAILABLE BUT NO GUARANTEE IS GIVEN THAT ALL EXISTING UTILITIES ARE SHOWN OR THAT THE GIVEN LOCATIONS ARE EXACT. CONFIRMATION OF EXISTENCE AND EXACT LOCATION OF ALL SERVICES MUST BE OBTAINED FROM THE INDIVIDUAL UTILITIES BEFORE PROCEEDING WITH CONSTRUCTION.

NO.	REVISIONS	DATE	BY
1	ISSUED FOR TENDER	00.07.05	S.R.S.
0	ISSUED FOR REVIEW	00.06.28	S.R.S.

**Stantec Consulting Ltd.**  
 905 Waverley Street, Winnipeg, Manitoba  
 Tel 204-489-5900 Fax 204-453-9012

DESIGNED BY: S.R.S. CHECKED BY: V.M.M.  
 DRAWN BY: T.G. APPROVED BY: S.R.S.

HOR. SCALE: 1:500  
 VERTICAL: 1:20

DATE: 10.04.22

ENGINEER'S SEAL  
 CONSULTANT DRAWING NO. C-227

**THE CITY OF WINNIPEG**  
 PUBLIC WORKS DEPARTMENT  
 ENGINEERING DIVISION

**DAKOTA/DUNKIRK PATHWAY PH I**  
 BISHOP GRANDIN BOULEVARD TO FERMOR AVENUE  
 STA. 4+725 TO STA. 4+975

2010 ACTIVE TRANSPORTATION  
 INFRASTRUCTURE STIMULUS PROGRAM

SHEET 10 OF 15  
 CAD FILE DRAWING NUMBER 05260c-210-xxx.dwg  
 CITY DRAWING NUMBER W-379-10

**PRELIMINARY**  
 NOT FOR CONSTRUCTION

**APEGM**  
 Certificate of Authorization  
 Stantec Consulting Ltd.  
 No. 1301 Date: \_\_\_\_\_