

DUNKIRK DRIVE

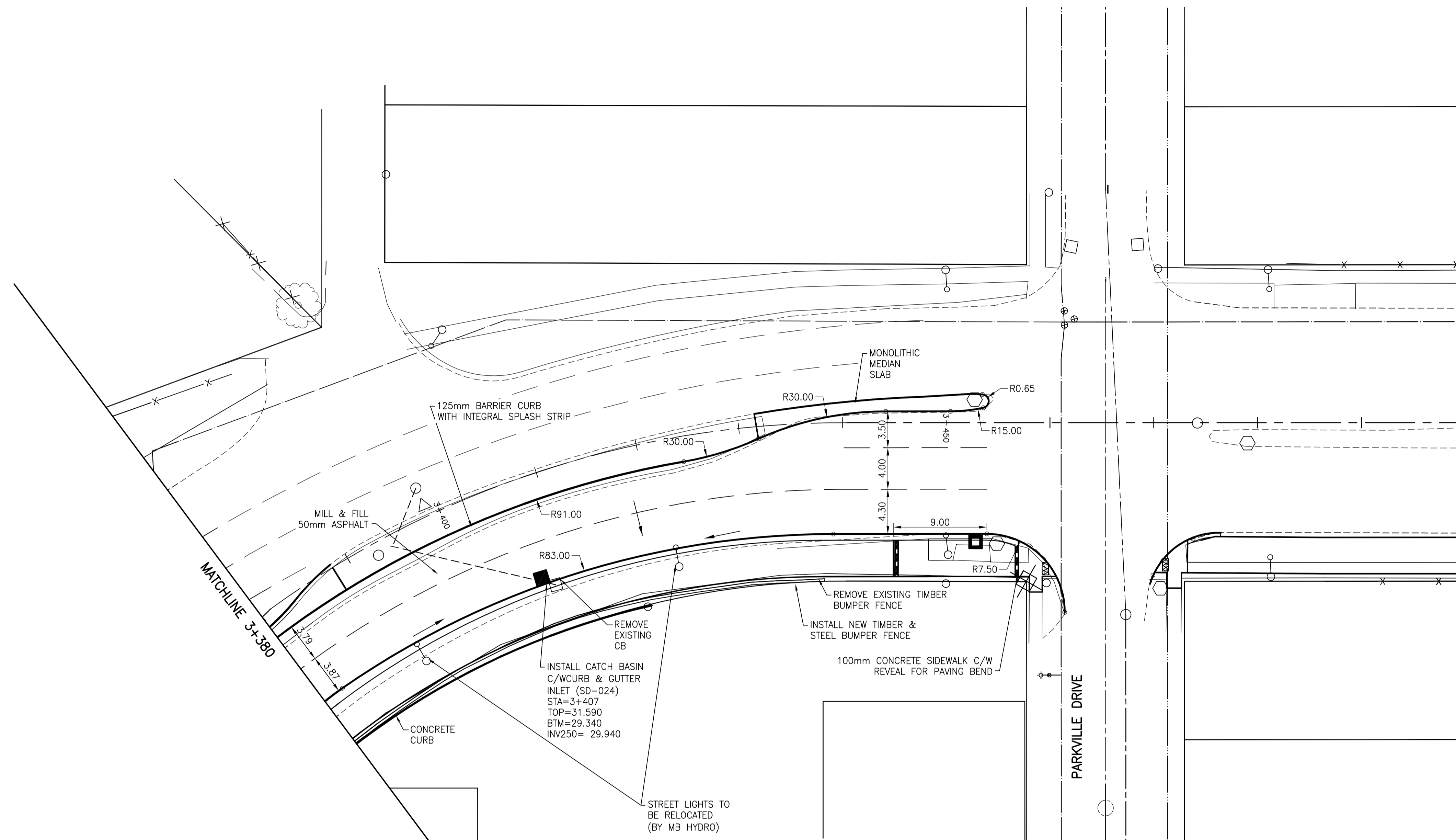

WARNING

IF POWER EQUIPMENT OR EXPLOSIVES ARE TO BE USED FOR EXCAVATION ON THIS PROJECT THE CONTRACTOR MUST:
 1) NOTIFY THE GAS COMPANY OF THE PROPOSED LOCATION OF EXCAVATION.
 2) TAKE PRECAUTION TO AVOID DAMAGE TO GAS COMPANY INSTALLATIONS.
 SEE PROVINCIAL REGULATION 140/92 FOR DETAILS

METRIC

WHOLE NUMBERS INDICATE MILLIMETRES
 DECIMALIZED NUMBERS INDICATE METRES

PRELIMINARY
 NOT FOR CONSTRUCTION



150 WM	WATERMAIN	150 WM	HYDRO	150 WM	WATERMAIN	150 WM	WATERMAIN
⊕	HYDRANT	⊕	M.T.S.	±, X	HYDRANT, VALVE	⊕, X	HYDRANT, VALVE
⊙	VALVE	⊙	CONCRETE	±, X	LAND DRAINAGE SEWER	±, X	LAND DRAINAGE SEWER
— 300 LDS —	LAND DRAINAGE SEWER	— 300 LDS —	ASPHALT	— 300 LDS —	WASTE WATER SEWER	— 300 LDS —	WASTE WATER SEWER
— 250 WWS —	WASTE WATER SEWER	— 250 WWS —	SIDEWALK	— 250 WWS —	Q PROFILE	— 250 WWS —	Q PROFILE
○	MANHOLE	●	SIDEWALK REMOVAL	○	NORTH OR WEST GUTTER	○	NORTH OR WEST GUTTER
□	CATCH BASIN	■	PROPERTY LINE	○	SOUTH OR EAST GUTTER	○	SOUTH OR EAST GUTTER
▽	CURB INLET	▽	SURVEY BAR	◇	NORTH OR WEST DITCH	◇	NORTH OR WEST DITCH
+	JUNCTIONS	+	DITCH	○	SOUTH OR EAST DITCH	○	SOUTH OR EAST DITCH
— — — — —	CULVERT	— — — — —	ELEVATION	△	NORTH OR WEST DITCH	△	NORTH OR WEST DITCH
— — — — —	GAS	— — — — —	SIDEWALK RAMP	▽	SOUTH OR EAST DITCH	▽	SOUTH OR EAST DITCH
EXISTING	LEGEND-PLAN	PROPOSED	EXISTING	LEGEND-PLAN	PROPOSED	EXISTING	LEGEND-PROFILE

LOCATION APPROVED UNDERGROUND STRUCTURES

SUPV. U/G STRUCTURES DATE COMMITTEE
 NOTE:
 LOCATION OF UNDERGROUND STRUCTURES AS SHOWN ARE BASED ON THE BEST INFORMATION AVAILABLE BUT NO GUARANTEE IS GIVEN THAT ALL EXISTING UTILITIES ARE SHOWN OR THAT THE GIVEN LOCATIONS ARE EXACT. CONFIRMATION OF EXISTENCE AND EXACT LOCATION OF ALL SERVICES MUST BE OBTAINED FROM THE INDIVIDUAL UTILITIES BEFORE PROCEEDING WITH CONSTRUCTION.

B.M. ELEV.	NO.	REVISIONS	DATE	BY
	1	ISSUED FOR TENDER	0.07.05	S.R.S.
	0	ISSUED FOR REVIEW	0.06.28	S.R.S.

Stantec Consulting Ltd.
 905 Waverley Street, Winnipeg, Manitoba
 Tel 204-489-5900 Fax 204-453-9012

DESIGNED BY	S.R.S.	CHECKED BY	V.M.M.
DRAWN BY	T.G.	APPROVED BY	S.R.S.
HOR. SCALE:	1:250	RELEASED FOR CONSTRUCTION:	
VERTICAL:		DATE	

DATE 10.05.10

ENGINEER'S SEAL
 CONSULTANT DRAWING NO. C-117

THE CITY OF WINNIPEG
 PUBLIC WORKS DEPARTMENT
 ENGINEERING DIVISION

DAKOTA/DUNKIRK PATHWAY PH I
 BISHOP GRANDIN BOULEVARD TO FERMOR AVENUE
 ST. MARRY'S ROAD STA. 3+380 TO STA. 3+500

2010 ACTIVE TRANSPORTATION INFRASTRUCTURE STIMULUS PROGRAM

SHEET 14 OF 15
 CAD FILE DRAWING NUMBER 05260c-115-xxx.dwg
 CITY DRAWING NUMBER W-379-14