

WATER SERVICE INFORMATION

ADDRESS	SIZE(mm) & TYPE (STREET)	SIZE(mm) & TYPE (PROP)	SHORT & LONG MEASUREMENT	CORP. LOCATION	SERVICE
679 LAXDAL RD RESIDENTIAL	-	-	2.81 NSL HSE	-	RECONNECT SERVICE
701 LAXDAL RD RESIDENTIAL	-	-	6.93 NSL ELDRIDGE	-	RECONNECT SERVICE
705 LAXDAL RD RESIDENTIAL	-	-	4.69 SNL HSE	-	RECONNECT SERVICE
706 LAXDAL RD RESIDENTIAL	-	-	8.72 SSL ELDRIDGE	-	RECONNECT SERVICE
707 LAXDAL RD RESIDENTIAL	-	-	5.97 SNL HSE	-	RECONNECT SERVICE
708 LAXDAL RD RESIDENTIAL	-	-	27.24 SSL ELDRIDGE	-	RECONNECT SERVICE
709 LAXDAL RD RESIDENTIAL	-	-	3.28 SNL HSE	5.5 N OF S/C	RECONNECT SERVICE
710 LAXDAL RD RESIDENTIAL	-	-	40.96 SSL ELDRIDGE	-	RECONNECT SERVICE
711 LAXDAL RD RESIDENTIAL	-	-	5.45 SNL HSE	-	RECONNECT SERVICE
712 LAXDAL RD RESIDENTIAL	-	-	45.30 SSL ELDRIDGE	-	RECONNECT SERVICE
713 LAXDAL RD RESIDENTIAL	-	-	4.92 SNL HSE	-	RECONNECT SERVICE
714 LAXDAL RD RESIDENTIAL	-	-	88.69 SSL ELDRIDGE	-	RECONNECT SERVICE
715 LAXDAL RD RESIDENTIAL	-	-	2.76 NSL HSE	-	RECONNECT SERVICE
716 LAXDAL RD RESIDENTIAL	-	-	6.781 SSL ELDRIDGE	-	RECONNECT SERVICE
717 LAXDAL RD RESIDENTIAL	-	-	4.12 NSL HSE	-	RECONNECT SERVICE
3596 ELDRIDGE AVE RESIDENTIAL	-	-	83.74 SSL ELDRIDGE	-	RECONNECT SERVICE
3597 ELDRIDGE AVE RESIDENTIAL	-	-	3.13 WEL HSE	-	RECONNECT SERVICE
9.11 WW LAXDAL	-	-	-	-	-

* SERVICES TO BE RENEWED TO R ALL OTHERS TO BE RECONNECTED

NOTE: CHAINAGES SHOWN ARE ALONG E P OF LAXDAL ST

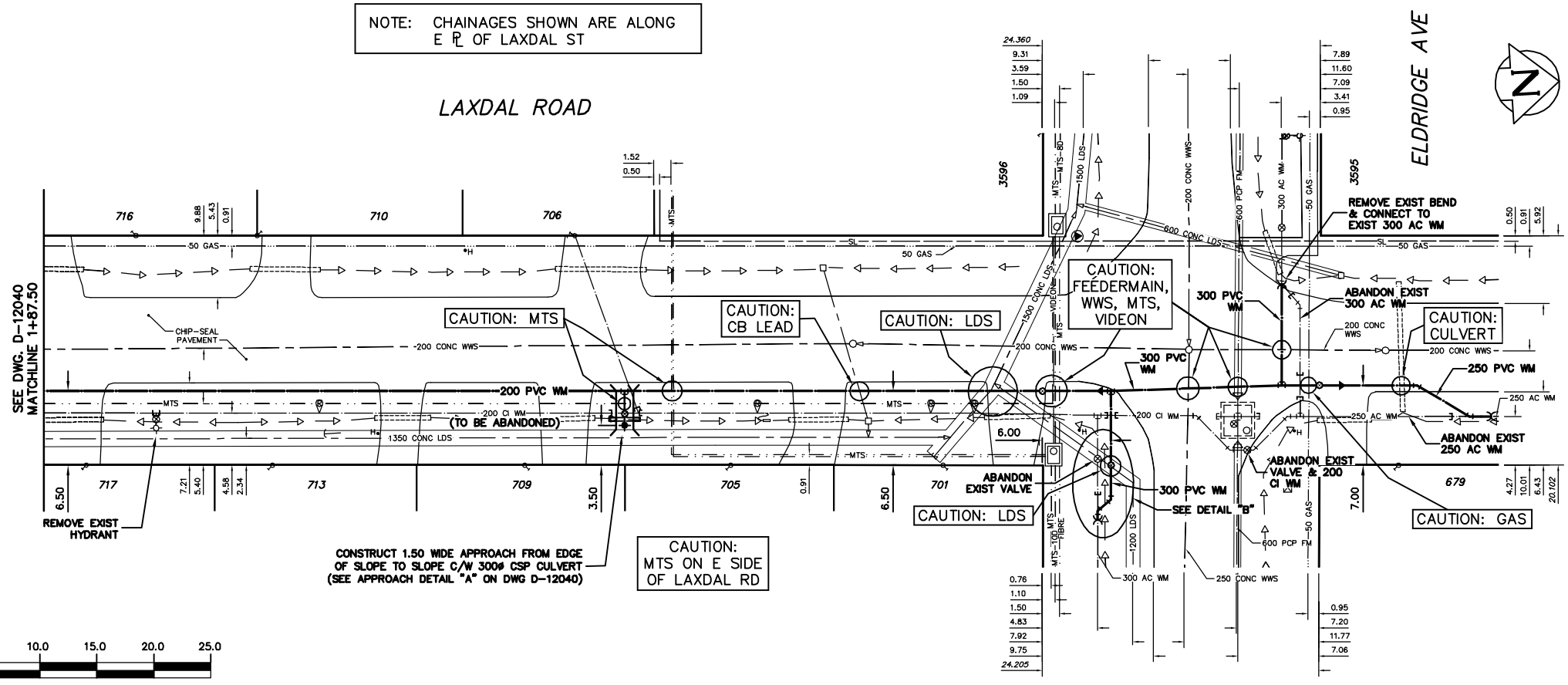

- CONSTRUCTION NOTES**
1. EXPOSE EXISTING WATERMAIN & CONFIRM INVERTS PRIOR TO CONSTRUCTION.
 2. LOCATION OF ALL SERVICES TO BE CONFIRMED IN THE FIELD.
 3. INSTALL WATERMAIN BY TRENCHLESS METHODS.
 4. TRENCHES AND EXCAVATIONS WITHIN 1 METRE OF A PAVED AREA INCLUDING SIDEWALKS SHALL BE CLASS 3 BACKFILL.
 5. ALL MATERIALS SHALL CONFORM TO THE CITY OF WINNIPEG STANDARD CONSTRUCTION SPECIFICATIONS.
 6. MINIMUM COVER TO TOP OF WATERMAIN SHALL BE 2.4 m.
 7. REPLACE ALL EXISTING LEAD SERVICES FROM PROPOSED WATERMAIN TO R.
 8. NOTIFY ALL AFFECTED RESIDENTS AND BUSINESSES 24 HOURS IN ADVANCE OF ANY WATER SHUTDOWNS OR DISRUPTION OF SERVICE.
 9. CONFIRM DEPTH OF FEEDERMAIN BY HYDRO-VAC PRIOR TO CONSTRUCTION AND INSTALL INSULATION WHERE COVER IS LESS THAN 2.4 m.

METRIC
WHOLE NUMBERS INDICATE MILLIMETRES
DECIMALIZED NUMBERS INDICATE METRES
NOTE: ALL VALVES TO BE INSTALLED CLOCKWISE TO CLOSE

WARNING
IF POWER EQUIPMENT OR EXPLOSIVES ARE TO BE USED FOR EXCAVATION ON THIS PROJECT THE CONTRACTOR MUST:
1) NOTIFY THE GAS COMPANY OF THE PROPOSED LOCATION OF EXCAVATION.
2) TAKE PRECAUTION TO AVOID DAMAGE TO GAS COMPANY INSTALLATIONS.
SEE PROVINCIAL REGULATION 210/72 FOR DETAILS

200 WM	WATERMAIN	200 WM	SL, HYDRO	150 WM	WATERMAIN	150 WM
+	HYDRANT	+	MTS	+	HYDRANT	+
o	VALVE	o	TRAFFIC SIGNALS	+	VALVE	+
525 LDS	LAND DRAINAGE SEWER	525 LDS	GAS	50 GAS	300 LDS	LAND DRAINAGE SEWER
375 WWS	WASTEWATER SEWER	375 WWS	SURVEY BAR	250 WWS	250 WWS	WASTEWATER SEWER
o	MANHOLE	o	FENCE	x	o	PROFILE
□	CATCH BASIN	■	POLE - HYDRO, MTS	=====	□	GROUND ABOVE PIPE
▽	CURB INLET	▽	CURB STOP	▲	⊖	DITCH (NORTH & WEST)
▽	REDUCER	▽	GUY ANCHOR	▽	⊖	DITCH (SOUTH & EAST)
X	COUPLER	X	LIGHT STANDARD	□	□	GUTTER (NORTH & EAST)
⊖	ANODE	⊖	TREE	○	○	GUTTER (SOUTH & EAST)
EXISTING	LEGEND-PLAN	PROPOSED	EXISTING	LEGEND-PLAN	PROPOSED	EXISTING
EXISTING	LEGEND-PROFILE	PROPOSED	EXISTING	LEGEND-PROFILE	PROPOSED	EXISTING

LOCATION APPROVED UNDERGROUND STRUCTURES

SUPV. U/G STRUCTURES COMMITTEE DATE

NOTE: LOCATION OF UNDERGROUND STRUCTURES AS SHOWN ARE BASED ON THE BEST INFORMATION AVAILABLE BUT NO GUARANTEE IS GIVEN THAT ALL EXISTING UTILITIES ARE SHOWN OR THAT THE GIVEN LOCATIONS ARE EXACT. CONFIRMATION OF EXISTENCE AND EXACT LOCATION OF ALL SERVICES MUST BE OBTAINED FROM THE INDIVIDUAL UTILITIES BEFORE PROCEEDING WITH CONSTRUCTION.

B.M. ELEV. FIELD BOOK #

POSTED TO LIS

CITY OF WINNIPEG WATER AND WASTE ENGINEERING DIVISION

DESIGNED BY MKG CHECKED BY SC

DRAWN BY CJH APPROVED BY SC

HOR. SCALE 1:250 VERTICAL 1:50

RELEASED FOR CONSTRUCTION

NO. REVISIONS DATE BY

DATE 2010 06 02 DATE

ENGINEER'S SEAL

ORIGINAL MYLAR SIGNED BY S.R.J. COURNOYER 02/06/10

BID OPPORTUNITY 397-2010 FILENAME: D-12041.dwg PLOT DATE: 2010 06 02

THE CITY OF WINNIPEG WATER AND WASTE DEPARTMENT

2010 WATERMAIN RENEWALS CONTRACT 6

LAXDAL ROAD 87.50 S OF ELDRIDGE AVENUE TO ELDRIDGE AVENUE

SHEET 8 OF 10 CITY DRAWING NUMBER D-12041