

A3 & B3 Existing Roof

steel deck  
felt vapor barrier  
1 1/2" fiberboard  
4 ply felt and asphalt  
gravel

A3 & B3 Construction (2010)

steel deck  
1/2" drywall  
2.2 torch grade VB  
3" polyisocyanurate  
type 2 EPS saddles  
(3"-0"x8' either side of valley)  
1" polyisocyanurate  
1/8" recovery board  
180 gr torch grade base sheet  
250 gr torch grade cap sheet

Note: insulation system is mechanically fastened

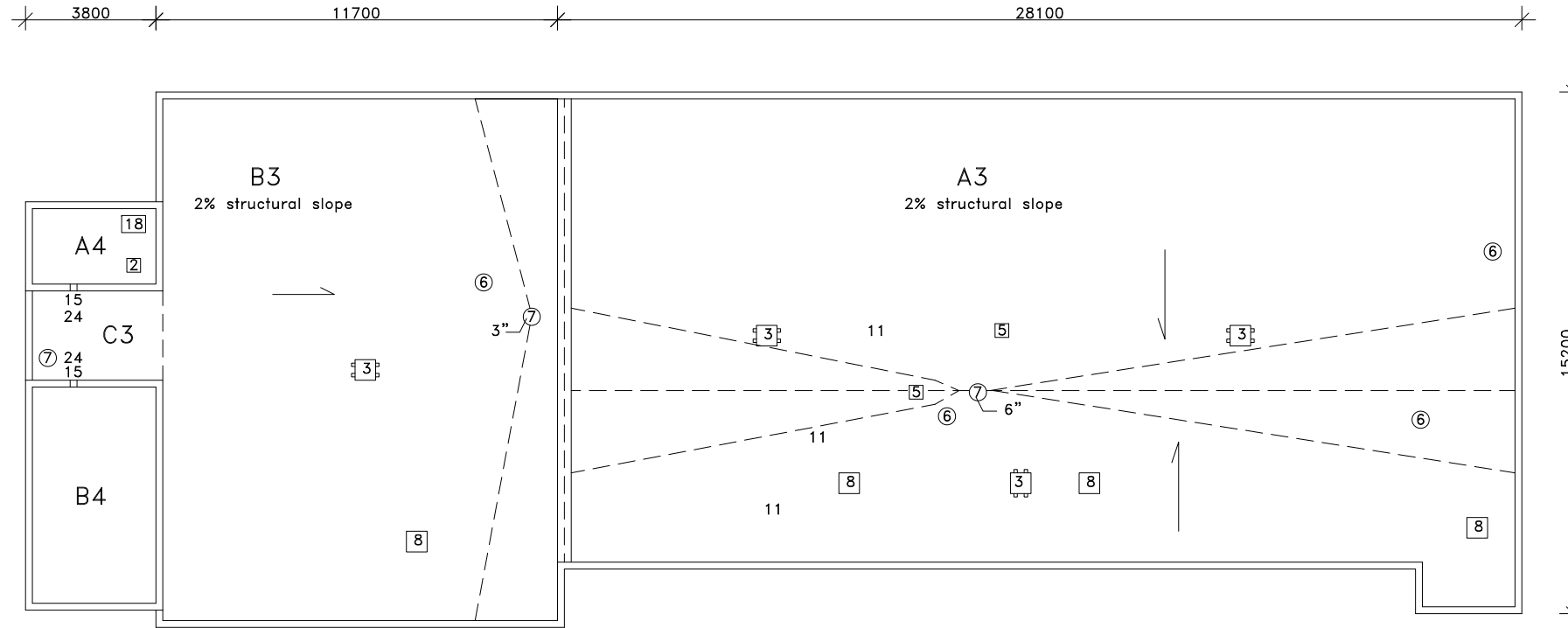

**GRAPHIC LEGEND**

- Parapet
- Gravel stop
- Gas line
- Control joint
- Expansion joint
- New insulated drain pipe
- Photo vantage point
- Area Label

☒ = attic vent    X = leak

**KEYNOTE LEGEND**

- 1 core sample
- 2 chimney
- 3 AC unit
- 4 vent hood
- 5 ventilator
- 6 vent pipe
- 7 roof drain
- 8 skylight
- 9 eavestrough
- 10 firewall
- 11 antenna
- 12 ladder
- 13 stub column
- 14 roof hatch
- 15 scupper
- 16 pitch box
- 17 HVAC unit
- 18 capped curb
- 19 flag pole
- 20 electrical mast
- 21 cooling tower
- 22 splash pad
- 23 splash pan
- 24 downspout/rainwater leader
- 25 back slope
- 26 cant
- 27 increase slope to drain
- 28 cricket
- 29 parapet/wide flashing
- 30 life line anchor



Approx. Area  
sq.m.  
A1 = 26  
A2 = 10  
A3 = 392  
B3 = 188  
Total = 616

KEY PLAN

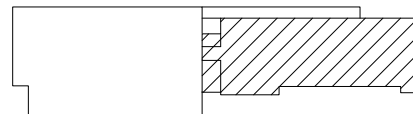

**Notes:**

- .01 Contractor is responsible for site verifications of all dimensions
- .02 Drawings are not to be scaled for estimating purposes
- .03 All areas given are approximate
- .04 Contractor is responsible for site verification of existing roof constructions

Stated scale is when in 11x17 format

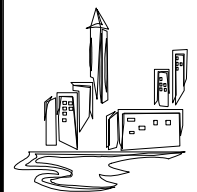

**AGASSIZ  
CONSULTING  
GROUP  
LTD.**

809 Pipeline Road, Winnipeg, Manitoba  
Phone: 697-8091 Fax: 697-8039

Project: Commercial Building  
700 Assiniboine Park Drive  
Winnipeg, MB

Date: March 3, 2010

Drawing No. R-1

File no: 3772-10 Scale: 1:200