

TYPE 12 - EXTERIOR GIRDER END METALLIZING

SECTION

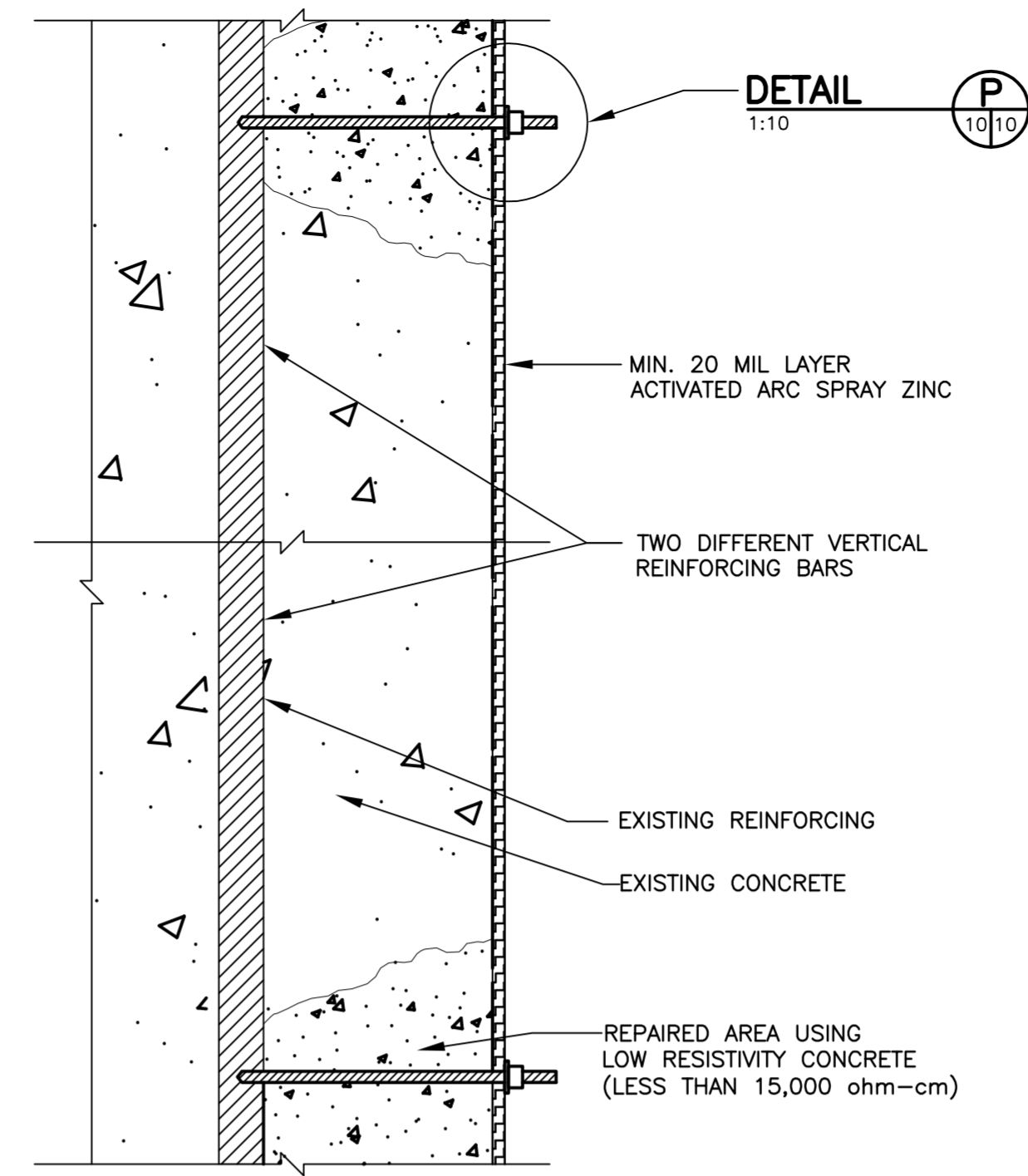

METALLIZING INSTALLATION DETAIL - AT REPAIRED CONCRETE
 1:10

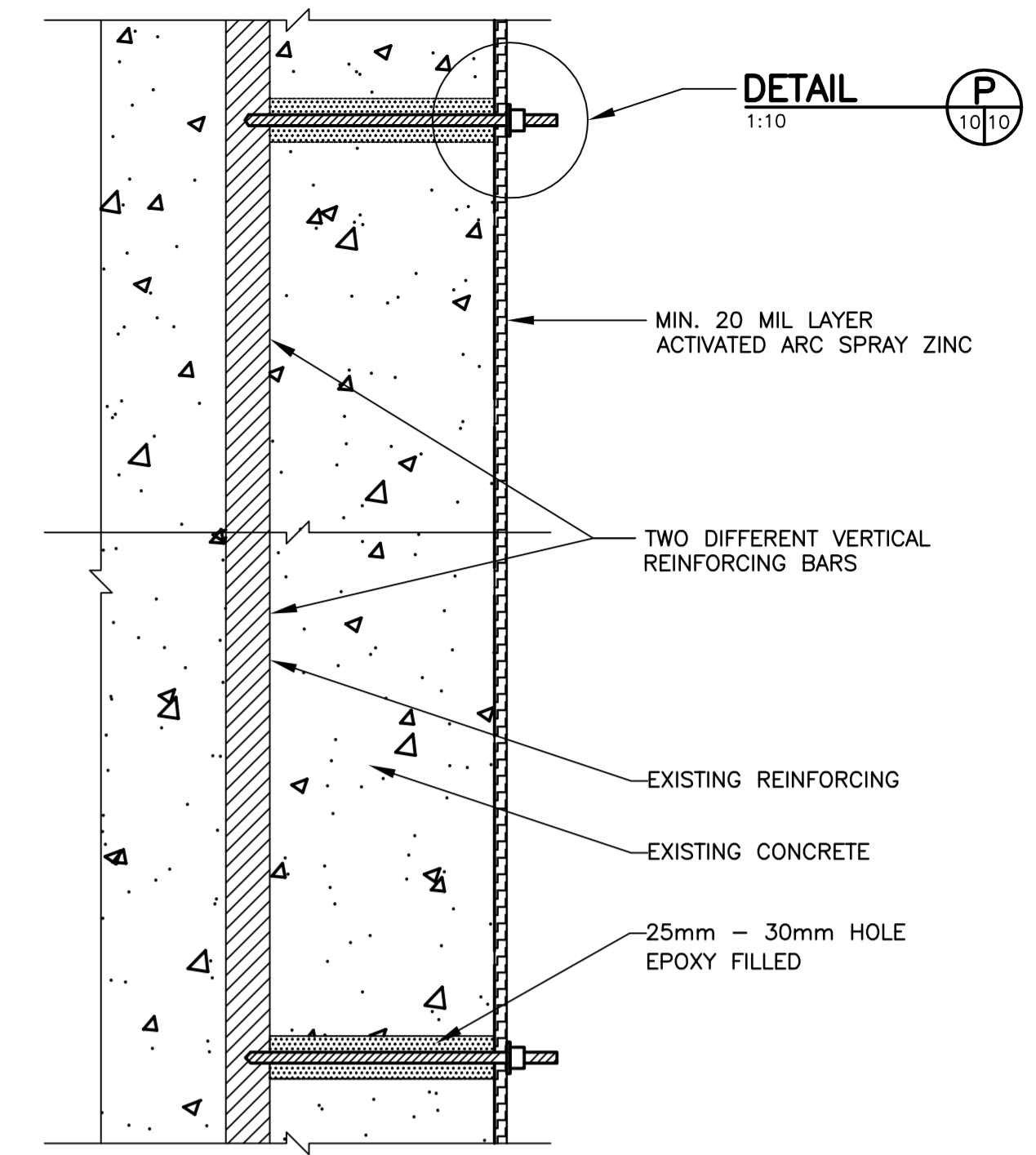

METALLIZING INSTALLATION DETAIL - AT SOUND CONCRETE
 1:10

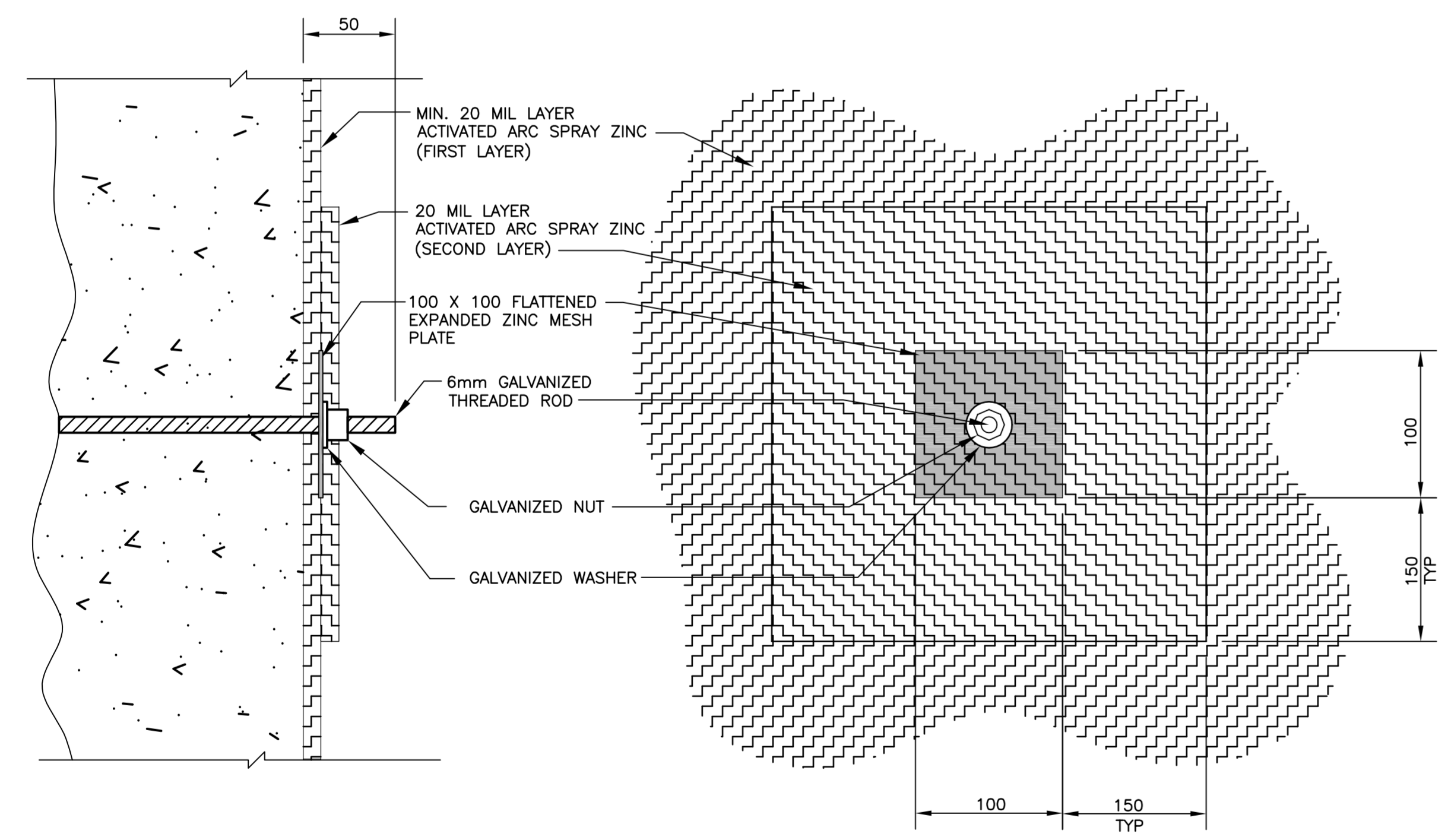

DETAIL
 N.T.S.

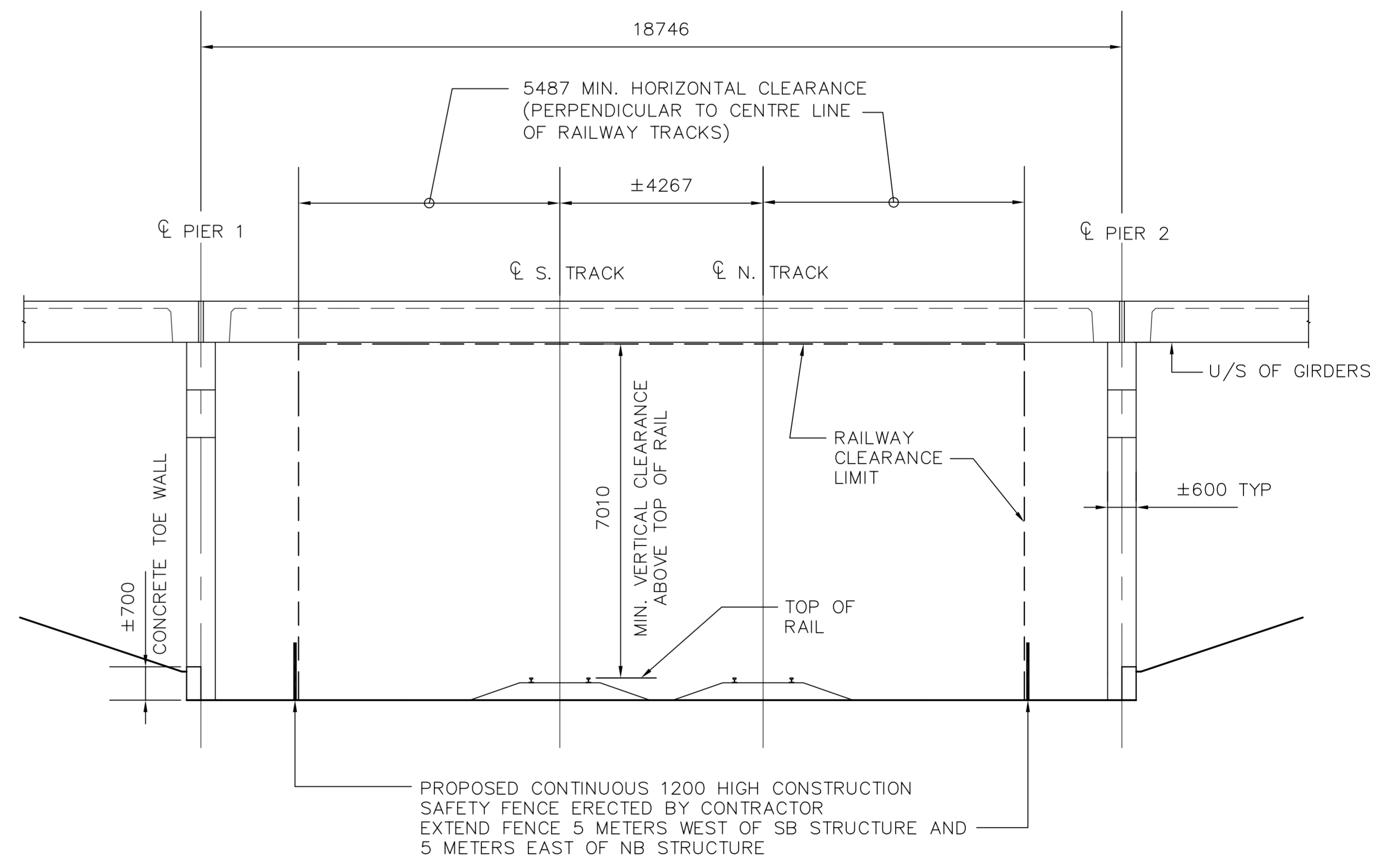

RAILWAY TRACK CLEARANCE DIAGRAM - CNR REDDITT
 1:10
 TYPICAL FOR NB AND SB STRUCTURES

METALLIZING NOTES:

1. COMPLETE ALL NECESSARY REPAIRS. CONNECTIONS TO EXPOSED REBAR MAY BE MADE AT THIS TIME. ALLOW CONCRETE TO FULLY CURE.
2. CONNECT THREADED GALVANIZED ROD TO STEEL VIA DRILL AND TAP, BRAZE, OR WELD CONNECTION. TWO CONNECTIONS ARE REQUIRED PER VERTICAL FACE. CONNECTIONS SHALL BE ESTABLISHED WITH TWO DIFFERENT VERTICAL REINFORCING BARS.
3. CONTINUITY BETWEEN THE TWO CONNECTION LOCATIONS SHALL BE ESTABLISHED PRIOR TO METALLIZING.
4. CONCRETE SURFACES TO BE METALLIZED ARE TO BE FREE OF ANY BARRIER COATINGS, OIL, DUST, GREASE ETC.
5. PROVIDE PROTECTION TO BEARINGS.
6. METALLIZE ALL SURFACES INDICATED.
7. PLACE 100 X 100 FLATTENED EXPANDED ZINC MESH PLATE, WASHER AND NUT OVER THREADED ROD AND TIGHTEN NUT. THREADED ROD SHOULD EXTEND 50 mm BEYOND THE SURFACE OF THE CONCRETE.
8. PROVIDE AN ADDITIONAL LAYER OF METALLIZING OVER THE ZINC MESH PLATE. THE ADDITIONAL LAYER SHALL EXTEND 150 mm BEYOND THE PLATE IN ALL DIRECTIONS.
9. APPLY HUMECTANT TO ALL METALLIZED SURFACES.
10. SPECIFICATIONS SHALL SUPERCEDE DRAWING NOTES.



B.M. ELEV.	DESIGNED BY GCL	 RELEASED FOR CONSTRUCTION ORIGINAL SIGNED BY B.A. NEIRNCK DATE MAY 20, 2010
	DRAWN BY CDW	
	CHECKED BY	
	APPROVED BY	
	HOR. SCALE AS NOTED	CONSULTANT PROJECT NO. 103192
	VERTICAL SCALE AS NOTED	
0 ISSUED FOR TENDER 05/20/10 MRD	DATE BY DATE MAY 2010	
NO. REVISIONS	DATE BY DATE	

 THE CITY OF WINNIPEG PUBLIC WORKS DEPARTMENT	2010 CAPITAL PROGRAM GIRDER REPAIRS AT ROUTE 20 REDDITT OVERPASS	CITY DRAWING NUMBER B122-10-03
	REDDITT OVERPASS - REPAIR DETAILS 2 AND TRACK CLEARANCE DIAGRAM	SHEET 10 OF 10 BID OPPORTUNITY 421-2010

4:00 DILLON_ACAD_FILE(C:\CAD\103192\Contract\Current\Bid-Op\5.6.7.9.10.REPAIR_DETAILS.dwg 4/27/2010