

DEMOLITION NOTES:

- 1 REMOVE & DISCARD EXISTING DOOR, FRAME & GLAZING UNITS, HARDWARE. REMOVE DOOR OPERATOR FOR REUSE & MORTISE LOCKSET, SEE ELEC. DWG. PREPARE OPENING FOR NEW DOORS & GLAZING UNITS. GYPSUM BOARD WALL ABOVE DOORS & GLAZING UNIT TO REMAIN.
- 2 EXISTING HANDICAP WALL MOUNTED ACTUATORS TO BE REMOVED & RETURNED TO CITY OF WINNIPEG. SEE RENOVATION DWG & DOOR & FRAME TYPES FOR LOCATIONS OF NEW ACTUATORS.
- 3 DEMOLISH & DISCARD OF EXISTING CIRCULATION DESK. SEE ELECTRICAL DWG. FOR RELOCATION OF EXISTING ELECTRICAL IN DESK.
- 4 EXISTING GYPSUM BOARD CLAD STRUCTURAL PILLAR TO REMAIN. PATCH & PAINT WALL AS REQUIRED.
- 5 DEMOLISH & DISCARD EXISTING WALL, DOOR & FRAME. SEE ELEC. DWG. FOR RELOCATION OF ELEC, SECURITY PANEL, FIRE BELL & PULLS.
- 6 REMOVE & DISCARD EXISTING DOOR & FRAME. PREPARE OPENING FOR NEW WALL. SEE WALL TYPES.
- 7 DISCONNECT, REMOVE & DISCARD EXISTING LAVATORY, MIRROR, WALL MOUNTED WASHROOM ACCESSORIES. EXISTING TOILET TO REMAIN. PREPARE WALLS FOR NEW ACCESSORIES & PROVIDE BRACING IN WALLS AS REQUIRED. SEE RENOVATION DRAWING.
- 8 REMOVE & DISCARD EXISTING TOILET PARTITIONS. DISCONNECT, REMOVE & DISCARD EXISTING LAVATORY, MIRROR, WALL MOUNTED WASHROOM ACCESSORIES EXCEPT GRAB BARS ABOVE WIC TANK IN MEN'S & WOMEN'S WASHROOM. EXISTING TOILET TO REMAIN. PREPARE WALLS FOR NEW ACCESSORIES & PROVIDE BRACING AS REQUIRED. SEE RENOVATION DRAWING.
- 9 REMOVE, SALVAGE & SET ASIDE EXISTING BABY CHANGE TABLES FOR REUSE IN RENOVATION.
- 10 EXISTING WALL HUNG URINAL TO REMAIN. SEE RENOVATION DRAWING.
- 11 REMOVE & DISCARD EXISTING DOORS & FRAMES. DEMOLISH WALL OPENINGS AS DIMENSIONED. SEE RENOVATION DRAWING.
- 12 REMOVE & DISCARD EXISTING DOOR & FRAME. DEMOLISH WALL OPENING WALL TO WALL & TO U/S OF REMOVED FRAME. SUPPORT UPPER WALL BULKHEAD AS REQUIRED. PATCH & PREPARE WALL FOR PAINT.
- 13 REMOVE & DISCARD EXISTING BOOK CHUTE IN EXTERIOR WALL. PREPARE OPENING FOR NEW BOOK CHUTE. SEE RENOVATION DWG. FOR DETAILS.

LEGEND	
	EXISTING WALLS TO BE DEMOLISHED
	EXISTING GLAZING UNIT & FRAMES TO BE DEMOLISHED
	EXISTING DOORS TO BE DEMOLISHED

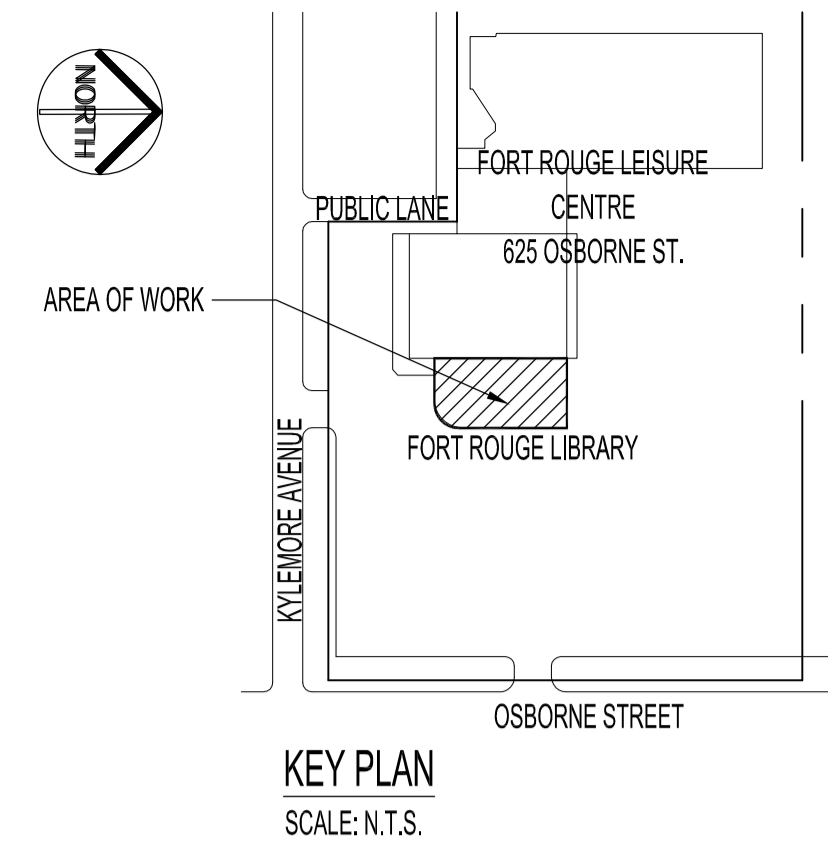

NOTES :

THESE DRAWINGS SHALL NOT BE SCALED.
REFER TO BID OPPORTUNITY FOR ADDITIONAL INFORMATION.

THE CONTRACTOR SHALL VISIT THE SITE AND SATISFY ONESELF ALL DIMENSIONS, DATUM, AND DETAILED INFORMATION SHOWN ARE CORRECT.

THE CONTRACTOR IS TO REVIEW AND COORDINATE ALL ARCHITECTURAL, MECHANICAL AND ELECTRICAL DRAWINGS FOR ADDITIONAL OPENINGS THROUGH FLOORS, WALLS, AND CEILINGS FOR DUCT, PIPE & ELECTRICAL RISERS AND ALL OPENINGS NOT SHOWN ON DRAWINGS.

ALL OPENINGS THROUGH FIRE ASSEMBLIES ARE TO BE FIRE STOPPED AND SEALED WITH UL/C APPROVED FIRE STOPPING TO MAINTAIN THE INTEGRITY OF THE FIRE SEPARATION, AND PROVIDE A SMOKE-TIGHT BARRIER.

ALL PRODUCTS AND MATERIALS TO BE USED AND INSTALLED SHALL CONFORM WITH MANUFACTURER'S SPECIFICATIONS & APPLICABLE CODES.

THE CONTRACTOR SHALL BE RESPONSIBLE TO PATCH AND MAKE GOOD ALL EXISTING CONSTRUCTION AFFECTED BY THE REMOVAL OF ALL ITEMS FORMING THE PART OF THE RENOVATION WORK.

WHERE NEW FLOORING AND BASE IS TO BE INSTALLED IN EXISTING AREAS (REFER TO FLOOR PLAN AND ROOM SCHEDULE) THE EXISTING FLOORING SURFACE AND BASE MUST BE REMOVED, UNLESS OTHERWISE NOTED. ALL FLOOR SURFACES SHALL BE PREPARED IN ACCORDANCE TO MANUFACTURER'S RECOMMENDATIONS FOR INSTALLATION OF NEW FLOOR.

WHERE PAINTING OF EXISTING WALLS IS INDICATED ON THE ROOM SCHEDULE, THESE WALLS MUST BE CLEANED OF ANY EXISTING WALL COVERING, PATCHED & PREPARED TO ACCEPT NEW MATERIAL, UNLESS OTHERWISE NOTED.

DRAWING LIST	
SHEET No:	SHEET TITLE
A1	PARTIAL MAIN FLOOR PLAN - DEMOLITION
A2	PARTIAL MAIN FLOOR PLAN - RENOVATION
A3	PARTIAL MAIN FLOOR PLAN - REFLECTED CEILING DEMOLITION & RENOVATION
A4	PARTIAL MAIN FLOOR PLAN - WALL & FLOOR FINISH PLANS DEMOLITION & RENOVATION
A5	WASHROOM & CIRCULATION DESK ELEVATIONS, DOOR & ROOM SCHEDULES
A6	CIRCULATION DESK SECTIONS

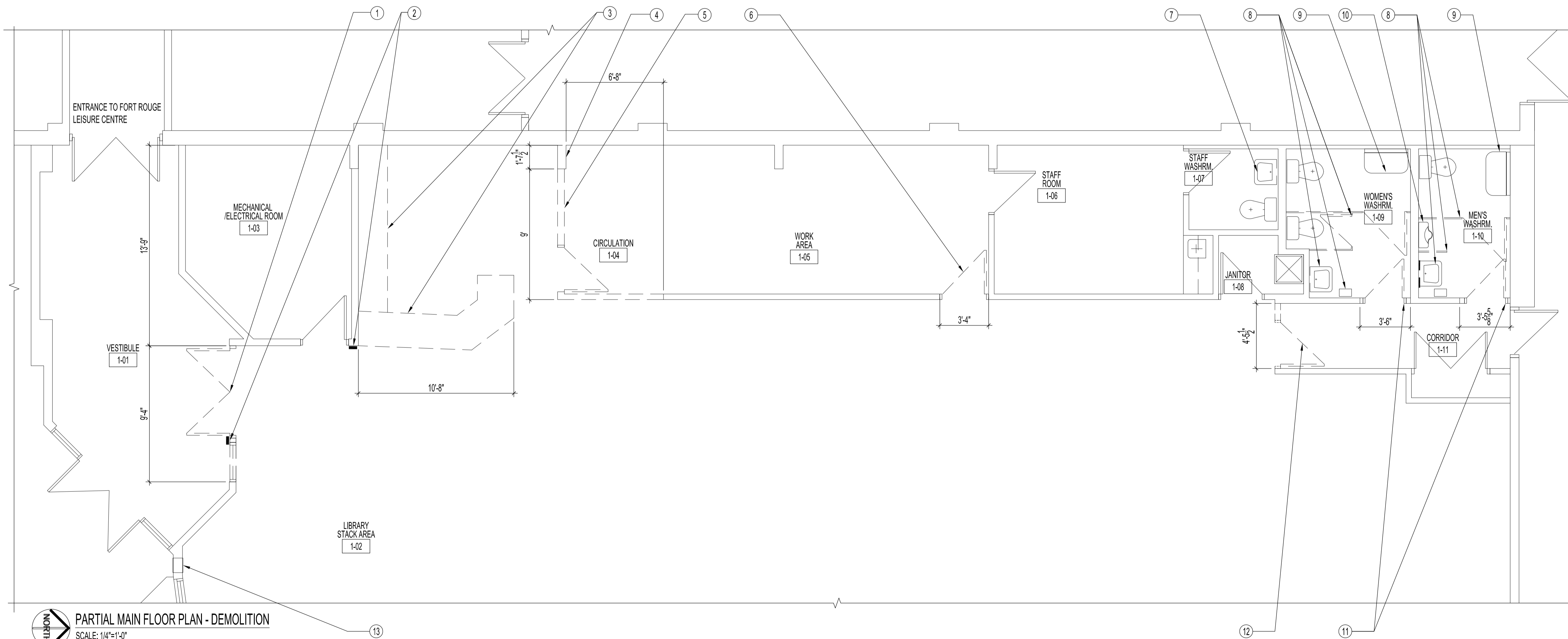

	DESIGN LEAD HAS CHANGED	MMK 2009.06.01	
NO.	REVISION/DESCRIPTION	BY	DATE
SEALS			

DRAWN BY	MMK	CHECKED BY	APPROVED
DATE	2010.02.24	USER APPROVAL	

CITY OF WINNIPEG
PLANNING, PROPERTY AND
DEVELOPMENT DEPARTMENT
MUNICIPAL ACCOMMODATIONS DIVISION
3 - 65 GARRY ST. R3C 4K4

PROJECT
FORT ROUGE LIBRARY
INTERIOR UPGRADING
NEW CIRCULATION DESK
625 OSBORNE STREET

SHEET TITLE
PARTIAL MAIN FLOOR PLAN
DEMOLITION

SCALE	PROJECT NO.	SHEET NO.
AS SHOWN	2008-019-01	A1R1