

ADDRESS	SIZE (mm) & TYPE (STREET)	SHORT & LONG MEASUREMENT	CORP LOCATION	REMARKS
#24 FERNWOOD AVE. RESIDENTIAL	19 COPPER	ON WEST HOUSE LINE	N/A	DR/WY 17.4
#28 FERNWOOD AVE. RESIDENTIAL	13 COPPER	2.1 EWHL 0.5 IN LAWN	N/A	
#32 FERNWOOD AVE. RESIDENTIAL	19 COPPER	1.5 EWHL 0.6 IN LAWN	N/A	DR/WY A5576
#36 FERNWOOD AVE. RESIDENTIAL	13 COPPER	0.9 EWHL 0.8 IN LOT	N/A	
#39 FERNWOOD AVE. RESIDENTIAL	19 COPPER	3.1 WEHL	N/A	
#40 FERNWOOD AVE. RESIDENTIAL	13 COPPER	2.1 EWHL	N/A	
#43 FERNWOOD AVE. RESIDENTIAL	19 COPPER	1.8 LR CR OF HOUSE 2.0 E/S/C	1.8 LR CR OF HOUSE 2.0 E/S/C	SERVICE RUNS STRAIGHT (1.8 E. OF SIC)
#44 FERNWOOD AVE. RESIDENTIAL	13 COPPER	1.2 EWHL	N/A	
#47 FERNWOOD AVE. RESIDENTIAL	13 COPPER	3.1 EWHL 0.9 IN LAWN	N/A	
#48 FERNWOOD AVE. RESIDENTIAL	13 COPPER	1.7 EWHL 0.6 IN LAWN	N/A	
#51 FERNWOOD AVE. RESIDENTIAL	13 COPPER	1.5 EWHL	N/A	
#52 FERNWOOD AVE. RESIDENTIAL	19 COPPER	1.8 EWHL	N/A	DR/WY 17.4
#54 FERNWOOD AVE. RESIDENTIAL	13 COPPER	2.9 EWHL	N/A	
#55 FERNWOOD AVE. RESIDENTIAL	13 COPPER	1.5 EWHL	N/A	DR/WY A5821

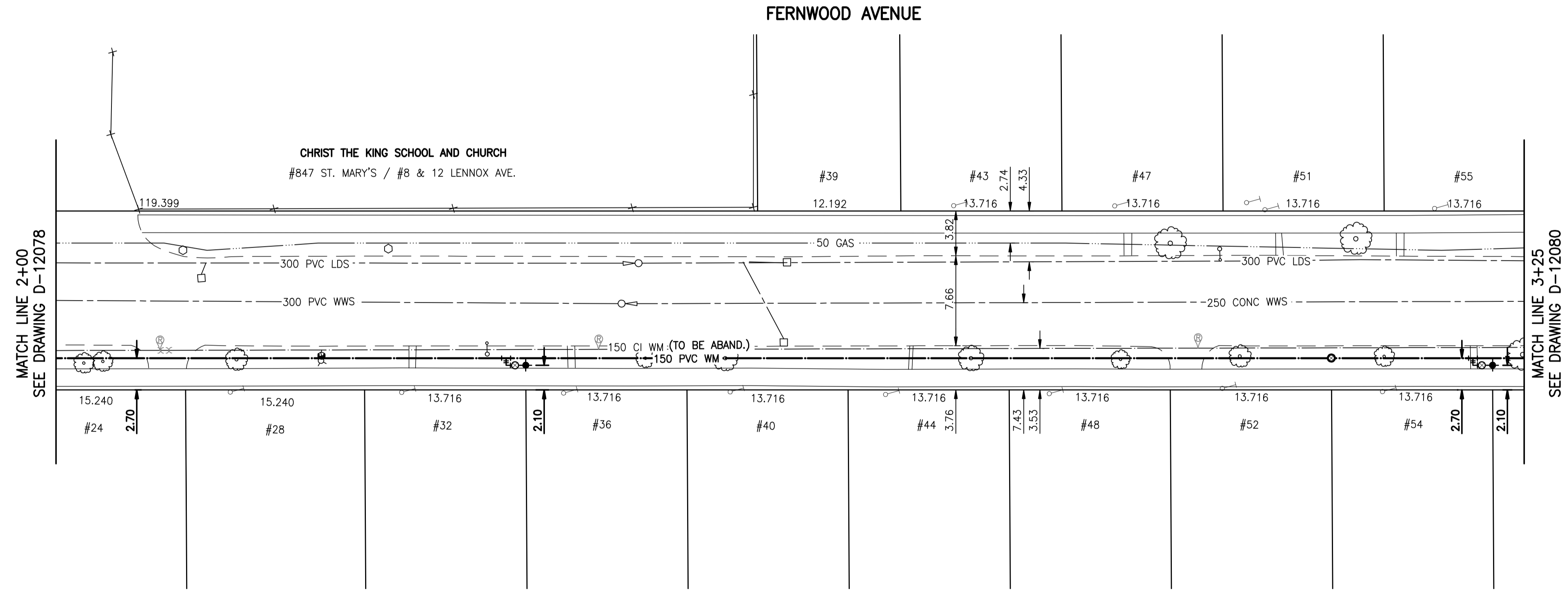

METRIC

WHOLE NUMBERS INDICATE MILLIMETRES
DECIMALIZED NUMBERS INDICATE METRES

WARNING

IF POWER EQUIPMENT OR EXPLOSIVES ARE TO BE USED FOR EXCAVATION ON THIS PROJECT THE CONTRACTOR MUST:
1) NOTIFY THE GAS COMPANY OF THE PROPOSED LOCATION OF EXCAVATION.
2) TAKE PRECAUTION TO AVOID DAMAGE TO GAS COMPANY INSTALLATIONS.
SEE PROVINCIAL REGULATION 140/92 FOR DETAILS

NOTES:

- CONTRACTOR TO EXPOSE EXISTING WATERMANS AT THE IN'S AND CONFIRM INVERTS OF PIPE.
- CONTRACTOR TO FOLLOW LATEST VERSION OF THE CITY OF WINNIPEG STANDARD CONSTRUCTION SPECIFICATION. WATERMANS TO BE INSTALLED BY TRENCHLESS METHODS.
- CLASS 3 BACKFILL TO BE USED WITHIN 1 METER OF PAVED SURFACES.
- CONTRACTOR TO NOTIFY RESIDENTS AT LEAST 24 HOURS PRIOR TO ANY DISRUPTION OF WATER SERVICE.

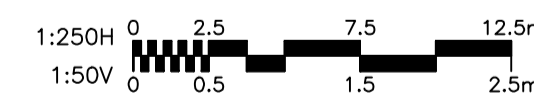

BENCH MARK: N.E. Cor. of St. Mary's Rd. & Thorndale Ave., Tblt. on top of 0.05 m dia. x 2.4 m iron pipe, 2.7 m S. of N.L. of Thorndale Ave. & on E.L. of St. Mary's Rd.

NOTE: STATIONS ALONG S R OF FERNWOOD AVE.

BID OPPORTUNITY 457-2010



EXISTING	LEGEND-PLAN	PROPOSED	EXISTING	LEGEND-PLAN	PROPOSED	EXISTING	LEGEND-PROFILE	PROPOSED
150 WM	WATERMAIN HYDRANT	150 WM	HYDRO M.T.S.	150 WM	WATERMAIN HYDRANT, VALVE	150 WM	LOCATION APPROVED UNDERGROUND STRUCTURES	
300 LDS	LAND DRAINAGE SEWER	300 LDS	CONCRETE	300 LDS	LAND DRAINAGE SEWER	300 LDS	SUPV. U/G STRUCTURES COMMITTEE	
250 WWS	WASTE WATER SEWER	250 WWS	ASPHALT	250 WWS	WASTE WATER SEWER	250 WWS	NOTE:	
	MANHOLE		SIDEWALK		Q PROFILE		LOCATION OF UNDERGROUND STRUCTURES AS SHOWN ARE BASED ON THE BEST INFORMATION AVAILABLE BUT NO GUARANTEE IS GIVEN THAT ALL EXISTING UTILITIES ARE SHOWN OR THAT THE GIVEN LOCATIONS ARE EXACT. CONFIRMATION OF EXISTENCE AND EXACT LOCATION OF ALL SERVICES MUST BE OBTAINED FROM THE INDIVIDUAL UTILITIES BEFORE PROCEEDING WITH CONSTRUCTION.	
	CATCH BASIN		PROPERTY LINE		NORTH OR WEST GUTTER			
	CURB INLET		SURVEY BAR		SOUTH OR EAST GUTTER			
	JUNCTIONS		DITCH		NORTH OR WEST R			
	STREET REHABILITATION LIMIT		CURB STOP		SOUTH OR EAST R			
	GAS		TREE		NORTH OR WEST DITCH			
			FENCE		SOUTH OR EAST DITCH			

B.M.	35-054	
ELEV.	231.677m	
NO.	REVISIONS	DATE BY

Stantec Consulting Ltd.	
905 Waverley Street, Winnipeg, Manitoba Tel 204-489-5900 Fax 204-453-9012	
DESIGNED BY	J.K.H.
CHECKED BY	W.W.B.
DRAWN BY	J.K.H.
APPROVED BY	H.A.K.
HOR. SCALE:	1:250
VERTICAL:	1:50
RELEASED FOR CONSTRUCTION:	
DATE	10.04.15

ENGINEER'S SEAL
ORIGINAL SEALED BY
H.A. KATZ
P. ENG.
10.06.09
CONSULTANT DRAWING NO.
C-202

THE CITY OF WINNIPEG
WATER AND WASTE DEPARTMENT
ENGINEERING DIVISION

2010 WATERMAIN RENEWALS - CONTRACT 8
FERNWOOD AVENUE
100.0 EEL OF ST. MARY'S ROAD TO
99.4 WWL OF ST. DAVID ROAD

SHEET 2 OF 13
CAD FILE DRAWING NUMBER
I2170c-201-735.dwg
CITY DRAWING NUMBER
D-12079