

ADDRESS	SIZE (mm) & TYPE (STREET)	SHORT & LONG MEASUREMENT	CORP LOCATION	REMARKS
#385 SOFTLEY RD. COMMERCIAL	N/A	N/A	N/A	

- NOTES:**
- CONTRACTOR TO EXPOSE EXISTING WATERMANS AT TIE IN'S AND CONFIRM INVERTS OF PIPE.
 - CONTRACTOR TO FOLLOW LATEST VERSION OF THE CITY OF WINNIPEG STANDARD CONSTRUCTION SPECIFICATION.
 - WATERMANS TO BE INSTALLED BY TRENCHLESS METHODS.
 - CLASS 3 BACKFILL TO BE USED WITHIN 1.0 METER OF PAVED SURFACES.
 - CONTRACTOR TO NOTIFY RESIDENTS AT LEAST 24 HOURS PRIOR TO ANY DISRUPTION OF WATER SERVICE.
 - OIL AND GAS RESISTANT GASKETS TO BE USED ON DUGALD ROAD RENEWAL.



METRIC
WHOLE NUMBERS INDICATE MILLIMETRES
DECIMALIZED NUMBERS INDICATE METRES

WARNING
IF POWER EQUIPMENT OR EXPLOSIVES ARE TO BE USED FOR EXCAVATION ON THIS PROJECT THE CONTRACTOR MUST:
1) NOTIFY THE GAS COMPANY OF THE PROPOSED LOCATION OF EXCAVATION.
2) TAKE PRECAUTION TO AVOID DAMAGE TO GAS COMPANY INSTALLATIONS.
SEE PROVINCIAL REGULATION 140/92 FOR DETAILS

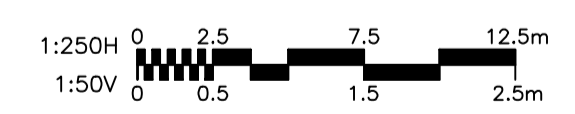
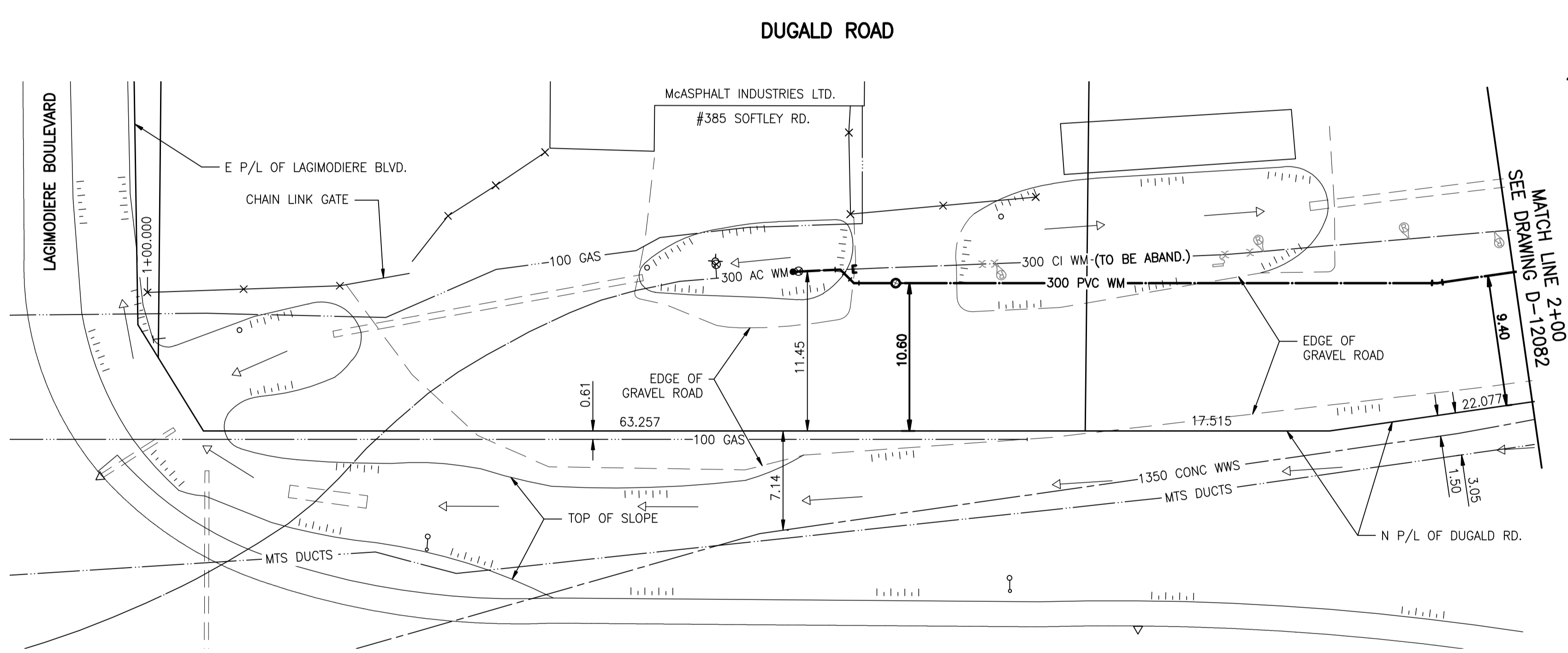

BENCH MARK: N. side Dugald Rd. Btwn. Mozenod Rd. & Plessis Rd., 19 mm dia. x 4.6 m I.B. in Valve Box in front of W. doorway to No. 1755 Dugald Rd.

NOTE: STATIONS ALONG N P OF DUGALD RD.

BID OPPORTUNITY 457-2010

<table border="1"> <tr> <td>150 WM</td> <td>WATERMAIN</td> <td>150 WM</td> <td>HYDRO</td> <td>150 WM</td> <td>WATERMAIN</td> <td>150 WM</td> </tr> <tr> <td>Hydrant</td> <td>HYDRANT</td> <td>Hydrant</td> <td>M.T.S.</td> <td>Hydrant</td> <td>HYDRANT, VALVE</td> <td>Hydrant</td> </tr> <tr> <td>Valve</td> <td>VALVE</td> <td>Valve</td> <td>CONCRETE</td> <td>Valve</td> <td>LAND DRAINAGE SEWER</td> <td>Valve</td> </tr> <tr> <td>300 LDS</td> <td>LAND DRAINAGE SEWER</td> <td>300 LDS</td> <td>ASPHALT</td> <td>300 LDS</td> <td>WASTE WATER SEWER</td> <td>300 LDS</td> </tr> <tr> <td>250 WWS</td> <td>WASTE WATER SEWER</td> <td>250 WWS</td> <td>SIWALK</td> <td>250 WWS</td> <td>Q PROFILE</td> <td>250 WWS</td> </tr> <tr> <td>Manhole</td> <td>MANHOLE</td> <td>Manhole</td> <td>PROPERTY LINE</td> <td>Manhole</td> <td>NORTH OR WEST GUTTER</td> <td>Manhole</td> </tr> <tr> <td>Catch Basin</td> <td>CATCH BASIN</td> <td>Catch Basin</td> <td>SURVEY BAR</td> <td>Manhole</td> <td>SOUTH OR EAST GUTTER</td> <td>Manhole</td> </tr> <tr> <td>Curb Inlet</td> <td>CURB INLET</td> <td>Curb Inlet</td> <td>DITCH</td> <td>Manhole</td> <td>NORTH OR WEST DITCH</td> <td>Manhole</td> </tr> <tr> <td>Junctions</td> <td>JUNCTIONS</td> <td>Junctions</td> <td>CURB STOP</td> <td>Manhole</td> <td>SOUTH OR EAST DITCH</td> <td>Manhole</td> </tr> <tr> <td>Street Rehabilitation Limit</td> <td>STREET REHABILITATION LIMIT</td> <td>Street Rehabilitation Limit</td> <td>TREE</td> <td>Manhole</td> <td>NORTH OR WEST DITCH</td> <td>Manhole</td> </tr> <tr> <td>Gas</td> <td>GAS</td> <td>Gas</td> <td>FENCE</td> <td>Manhole</td> <td>SOUTH OR EAST DITCH</td> <td>Manhole</td> </tr> <tr> <td>EXISTING</td> <td>LEGEND-PLAN</td> <td>PROPOSED</td> <td>EXISTING</td> <td>EXISTING</td> <td>LEGEND-PROFILE</td> <td>PROPOSED</td> </tr> </table>		150 WM	WATERMAIN	150 WM	HYDRO	150 WM	WATERMAIN	150 WM	Hydrant	HYDRANT	Hydrant	M.T.S.	Hydrant	HYDRANT, VALVE	Hydrant	Valve	VALVE	Valve	CONCRETE	Valve	LAND DRAINAGE SEWER	Valve	300 LDS	LAND DRAINAGE SEWER	300 LDS	ASPHALT	300 LDS	WASTE WATER SEWER	300 LDS	250 WWS	WASTE WATER SEWER	250 WWS	SIWALK	250 WWS	Q PROFILE	250 WWS	Manhole	MANHOLE	Manhole	PROPERTY LINE	Manhole	NORTH OR WEST GUTTER	Manhole	Catch Basin	CATCH BASIN	Catch Basin	SURVEY BAR	Manhole	SOUTH OR EAST GUTTER	Manhole	Curb Inlet	CURB INLET	Curb Inlet	DITCH	Manhole	NORTH OR WEST DITCH	Manhole	Junctions	JUNCTIONS	Junctions	CURB STOP	Manhole	SOUTH OR EAST DITCH	Manhole	Street Rehabilitation Limit	STREET REHABILITATION LIMIT	Street Rehabilitation Limit	TREE	Manhole	NORTH OR WEST DITCH	Manhole	Gas	GAS	Gas	FENCE	Manhole	SOUTH OR EAST DITCH	Manhole	EXISTING	LEGEND-PLAN	PROPOSED	EXISTING	EXISTING	LEGEND-PROFILE	PROPOSED	<p>LOCATION APPROVED UNDERGROUND STRUCTURES</p> <p>SUPV. U/G STRUCTURES COMMITTEE DATE</p> <p>NOTE: LOCATION OF UNDERGROUND STRUCTURES AS SHOWN ARE BASED ON THE BEST INFORMATION AVAILABLE BUT NO GUARANTEE IS GIVEN THAT ALL EXISTING UTILITIES ARE SHOWN OR THAT THE GIVEN LOCATIONS ARE EXACT. CONFIRMATION OF EXISTENCE AND EXACT LOCATION OF ALL SERVICES MUST BE OBTAINED FROM THE INDIVIDUAL UTILITIES BEFORE PROCEEDING WITH CONSTRUCTION.</p>	<p>B.M. 32-001 ELEV. 231.777m</p>	<p>Stantec Consulting Ltd. 905 Waverley Street, Winnipeg, Manitoba Tel 204-489-5900 Fax 204-453-9012</p> <table border="1"> <tr> <td>DESIGNED BY</td> <td>J.K.H.</td> <td>CHECKED BY</td> <td>W.W.B.</td> </tr> <tr> <td>DRAWN BY</td> <td>J.K.H.</td> <td>APPROVED BY</td> <td>H.A.K.</td> </tr> <tr> <td>HOR. SCALE:</td> <td>1:250</td> <td>RELEASED FOR CONSTRUCTION:</td> <td></td> </tr> <tr> <td>VERTICAL:</td> <td>1:50</td> <td>DATE</td> <td>10.04.15</td> </tr> </table>	DESIGNED BY	J.K.H.	CHECKED BY	W.W.B.	DRAWN BY	J.K.H.	APPROVED BY	H.A.K.	HOR. SCALE:	1:250	RELEASED FOR CONSTRUCTION:		VERTICAL:	1:50	DATE	10.04.15	<p>ENGINEER'S SEAL</p> <p>ORIGINAL SEALED BY H.A. KATZ P. ENG. 10.08.09</p> <p>CONSULTANT DRAWING NO. C-204</p>	<p>THE CITY OF WINNIPEG WATER AND WASTE DEPARTMENT ENGINEERING DIVISION</p> <p>2010 WATERMAIN RENEWALS - CONTRACT 8 DUGALD ROAD 47.50 EEL OF LAGIMODIERE BOULEVARD TO 38.3 WWL OF SOFTLEY ROAD</p> <p>SHEET 4 OF 13 CAD FILE DRAWING NUMBER I2170c-204-735.dwg CITY DRAWING NUMBER D-12081</p>
150 WM	WATERMAIN	150 WM	HYDRO	150 WM	WATERMAIN	150 WM																																																																																																				
Hydrant	HYDRANT	Hydrant	M.T.S.	Hydrant	HYDRANT, VALVE	Hydrant																																																																																																				
Valve	VALVE	Valve	CONCRETE	Valve	LAND DRAINAGE SEWER	Valve																																																																																																				
300 LDS	LAND DRAINAGE SEWER	300 LDS	ASPHALT	300 LDS	WASTE WATER SEWER	300 LDS																																																																																																				
250 WWS	WASTE WATER SEWER	250 WWS	SIWALK	250 WWS	Q PROFILE	250 WWS																																																																																																				
Manhole	MANHOLE	Manhole	PROPERTY LINE	Manhole	NORTH OR WEST GUTTER	Manhole																																																																																																				
Catch Basin	CATCH BASIN	Catch Basin	SURVEY BAR	Manhole	SOUTH OR EAST GUTTER	Manhole																																																																																																				
Curb Inlet	CURB INLET	Curb Inlet	DITCH	Manhole	NORTH OR WEST DITCH	Manhole																																																																																																				
Junctions	JUNCTIONS	Junctions	CURB STOP	Manhole	SOUTH OR EAST DITCH	Manhole																																																																																																				
Street Rehabilitation Limit	STREET REHABILITATION LIMIT	Street Rehabilitation Limit	TREE	Manhole	NORTH OR WEST DITCH	Manhole																																																																																																				
Gas	GAS	Gas	FENCE	Manhole	SOUTH OR EAST DITCH	Manhole																																																																																																				
EXISTING	LEGEND-PLAN	PROPOSED	EXISTING	EXISTING	LEGEND-PROFILE	PROPOSED																																																																																																				
DESIGNED BY	J.K.H.	CHECKED BY	W.W.B.																																																																																																							
DRAWN BY	J.K.H.	APPROVED BY	H.A.K.																																																																																																							
HOR. SCALE:	1:250	RELEASED FOR CONSTRUCTION:																																																																																																								
VERTICAL:	1:50	DATE	10.04.15																																																																																																							

V:\1112\csw\1112170\winipeg\402_design\sheet_files\12170c-204-735.dwg
 2010-08-10 10:54AM By: jkatz