

ADDRESS	SIZE (mm) & TYPE (STREET)	SHORT & LONG MEASUREMENT	CORP LOCATION	REMARKS
#79 PARKVILLE AVE. RESIDENTIAL	18 COPPER	0.9 WEHL	N/A	SERVICED OFF PARKVILLE
#81 PARKVILLE AVE. RESIDENTIAL	19 COPPER	2.3 EWL 341.7 EEL OF PARKVILLE BY	7.1 W CS 334.6 EEL OF PARKVILLE BY	RECONNECTED IN 2009
#2 WEAVER BAY RESIDENTIAL	19 COPPER	3.4 EWL	N/A	SERVICED OFF WEAVER BAY
#1 WEAVER BAY RESIDENTIAL	19 COPPER	0.45 EWL	N/A	SERVICED OFF WEAVER BAY
#95 PULBERRY ST. COMMERCIAL	100 UNKNOWN	3.4 SSL CROFTON SEE REMARKS	2.0 E SC 4.4 WW LEOVA ST	VALVE LOCATION - 3.4 SSL CROFTON - 24.1 S HYD NE PULBERRY & CROFTON 49.4 NSL BUILDING

NOTES:

- CONTRACTOR TO EXPOSE EXISTING WATERMANS AT THE IN'S AND CONFIRM INVERTS OF PIPE.
- CONTRACTOR TO FOLLOW LATEST VERSION OF THE CITY OF WINNIPEG STANDARD CONSTRUCTION SPECIFICATION. WATERMANS TO BE INSTALLED BY TRENCHLESS METHODS.
- CLASS 3 BACKFILL TO BE USED WITHIN 1 METER OF PAVED SURFACES.
- CONTRACTOR TO NOTIFY RESIDENTS AT LEAST 24 HOURS PRIOR TO ANY DISRUPTION OF WATER SERVICE.

METRIC
WHOLE NUMBERS INDICATE MILLIMETRES
DECIMALIZED NUMBERS INDICATE METRES

WARNING
IF POWER EQUIPMENT OR EXPLOSIVES ARE TO BE USED FOR EXCAVATION ON THIS PROJECT THE CONTRACTOR MUST:
1) NOTIFY THE GAS COMPANY OF THE PROPOSED LOCATION OF EXCAVATION.
2) TAKE PRECAUTION TO AVOID DAMAGE TO GAS COMPANY INSTALLATIONS.
SEE PROVINCIAL REGULATION 140/92 FOR DETAILS

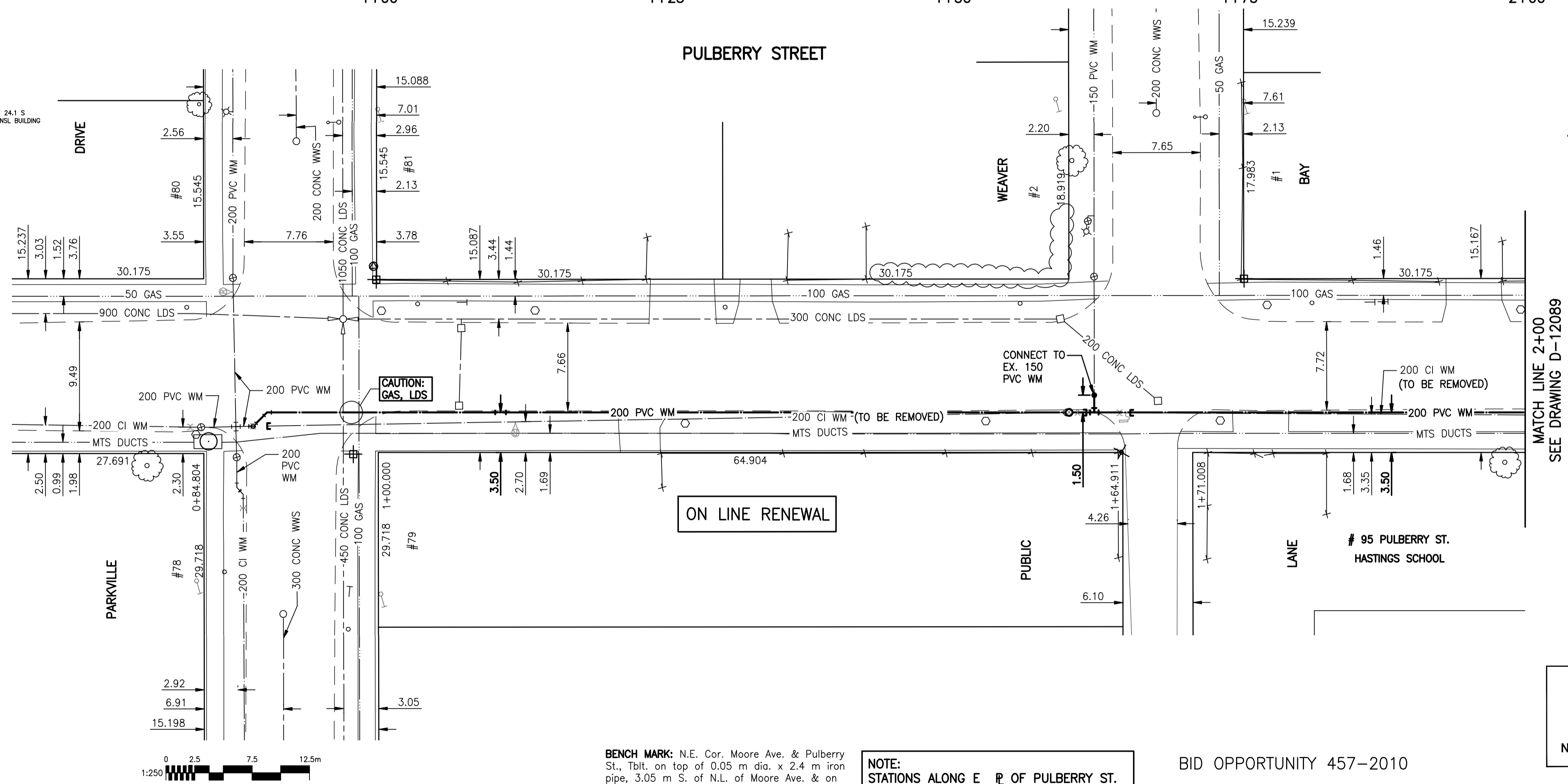

BENCH MARK: N.E. Cor. Moore Ave. & Pulberry St., Tbit, on top of 0.05 m dia. x 2.4 m iron pipe, 3.05 m S. of N.L. of Moore Ave. & on E.L. of Pulberry St.

NOTE:
STATIONS ALONG E P OF PULBERRY ST.

BID OPPORTUNITY 457-2010

150 WM			150 WM			HYDRO M.T.S.			150 WM			WATERMAIN HYDRANT, VALVE			150 WM		
	WATERMAIN	---		WATERMAIN	---		HYDRO		WATERMAIN	---		WATERMAIN	---		WATERMAIN	---	
	HYDRANT			CONCRETE			VALVE		LAND DRAINAGE SEWER			LAND DRAINAGE SEWER			LAND DRAINAGE SEWER		
	300 LDS			ASPHALT			WASTE WATER SEWER		WASTE WATER SEWER			WASTE WATER SEWER			WASTE WATER SEWER		
	250 WWS			SIDEWALK			PROPERTY LINE		SURVEY BAR			NORTH OR WEST GUTTER		NORTH OR WEST GUTTER		NORTH OR WEST GUTTER	
	MANHOLE		CATCH BASIN		CURB INLET		JUNCTIONS		STREET REHABILITATION LIMIT		GAS		FENCE		TREE		
	EXISTING		PROPOSED		EXISTING		PROPOSED		EXISTING		PROPOSED		EXISTING		PROPOSED		EXISTING

LOCATION APPROVED UNDERGROUND STRUCTURES
SHPV. U/G STRUCTURES COMMITTEE DATE
NOTE:
LOCATION OF UNDERGROUND STRUCTURES AS SHOWN ARE BASED ON THE BEST INFORMATION AVAILABLE BUT NO GUARANTEE IS GIVEN THAT ALL EXISTING UTILITIES ARE SHOWN OR THAT THE GIVEN LOCATIONS ARE EXACT. CONFIRMATION OF EXISTENCE AND EXACT LOCATION OF ALL SERVICES MUST BE OBTAINED FROM THE INDIVIDUAL UTILITIES BEFORE PROCEEDING WITH CONSTRUCTION.

B.M. 63-038 ELEV. 231.197m

NO. REVISIONS DATE BY

Stantec Consulting Ltd.
905 Waverley Street, Winnipeg, Manitoba
Tel 204-489-5900 Fax 204-453-9012

DESIGNED BY	J.K.H.	CHECKED BY	W.W.B.
DRAWN BY	J.K.H.	APPROVED BY	H.A.K.
HOR. SCALE:	1:250	RELEASED FOR CONSTRUCTION:	
VERTICAL:	1:50	DATE	10.04.15

ENGINEER'S SEAL
ORIGINAL SEALED BY
H.A. KATZ
P. ENG.
10.06.09
CONSULTANT DRAWING NO.
C-211

THE CITY OF WINNIPEG
WATER AND WASTE DEPARTMENT
ENGINEERING DIVISION

2010 WATERMAIN RENEWALS - CONTRACT 8
PULBERRY STREET
PARKVILLE DRIVE TO
100.0>NNL OF PARKVILLE DRIVE

SHEET **11** OF **13**
CAD FILE DRAWING NUMBER
12170c-211-735.dwg
CITY DRAWING NUMBER
D-12088

APEN
Certificate of Authorization
Stantec Consulting Ltd.
No. 1301 Date: