

ADDRESS	SIZE (mm) & TYPE (STREET)	SHORT & LONG MEASUREMENT	CORP LOCATION	REMARKS
#102 CROFTON BY RESIDENTIAL	19 COPPER	4.3 WEHL	N/A	DR/RY/01 SEWER 150 CONCRETE SERVICED OFF CROFTON BY
#101 CROFTON BY RESIDENTIAL	19 COPPER	3.2 WEHL	N/A	DR/RY 0280 TAN-STY-6-35015-08 SEWER 150 CONCRETE SERVICED OFF CROFTON BY
#120 MOORE AVE. RESIDENTIAL	19 COPPER	0.9 E OF W HOUSE LINE 0.8 W/HYD#120	0.1 W/HYD#120	DR/RY C9021 SERVICED OFF MOORE AVE.
#124 MOORE AVE. RESIDENTIAL	19 COPPER	2.7 W OF E HOUSE LINE 68.3 E/HYD#132	7.0 E/HYD#132	DR/RY #026 SEWER 150 CONC SERVICED OFF MOORE AVE.
#95 PULBERRY ST. COMMERCIAL	100 UNKNOWN	3.4 SSL CROFTON SEE REMARKS	2.0 E SC 4.4 WW LEOLA ST	VALVE LOCATION - 3.4 SSL CROFTON - 24.1 S HYD NE PULBERRY & CROFTON 49.4 NSL BUILDING

NOTES:

- CONTRACTOR TO EXPOSE EXISTING WATERMANS AT THE IN'S AND CONFIRM INVERTS OF PIPE.
- CONTRACTOR TO FOLLOW LATEST VERSION OF THE CITY OF WINNIPEG STANDARD CONSTRUCTION SPECIFICATION.
- WATERMANS TO BE INSTALLED BY TRENCHLESS METHODS.
- CLASS 3 BACKFILL TO BE USED WITHIN 1 METER OF PAVED SURFACES.
- CONTRACTOR TO NOTIFY RESIDENTS AT LEAST 24 HOURS PRIOR TO ANY DISRUPTION OF WATER SERVICE.
- CONTRACTOR TO CONFIRM MATERIAL TYPE OF EX 150 WM CROSSING PULBERRY ST. AT NORTH LEG OF CROFTON BAY. IF EXISTING MATERIAL TYPE IS PVC, CONTRACTOR SHALL NOT RENEW 150 WM UNDER PULBERRY AS SHOWN. CONTRACTOR SHALL CONNECT TO 150 PVC WITH 200x150 TEE AND 1.0m OF 150 PVC.

METRIC

WHOLE NUMBERS INDICATE MILLIMETRES
DECIMALIZED NUMBERS INDICATE METRES

WARNING

IF POWER EQUIPMENT OR EXPLOSIVES ARE TO BE USED FOR EXCAVATION ON THIS PROJECT THE CONTRACTOR MUST:
1) NOTIFY THE GAS COMPANY OF THE PROPOSED LOCATION OF EXCAVATION.
2) TAKE PRECAUTION TO AVOID DAMAGE TO GAS COMPANY INSTALLATIONS.
SEE PROVINCIAL REGULATION 140/92 FOR DETAILS



MATCH LINE 3+00
SEE DRAWING D-12089

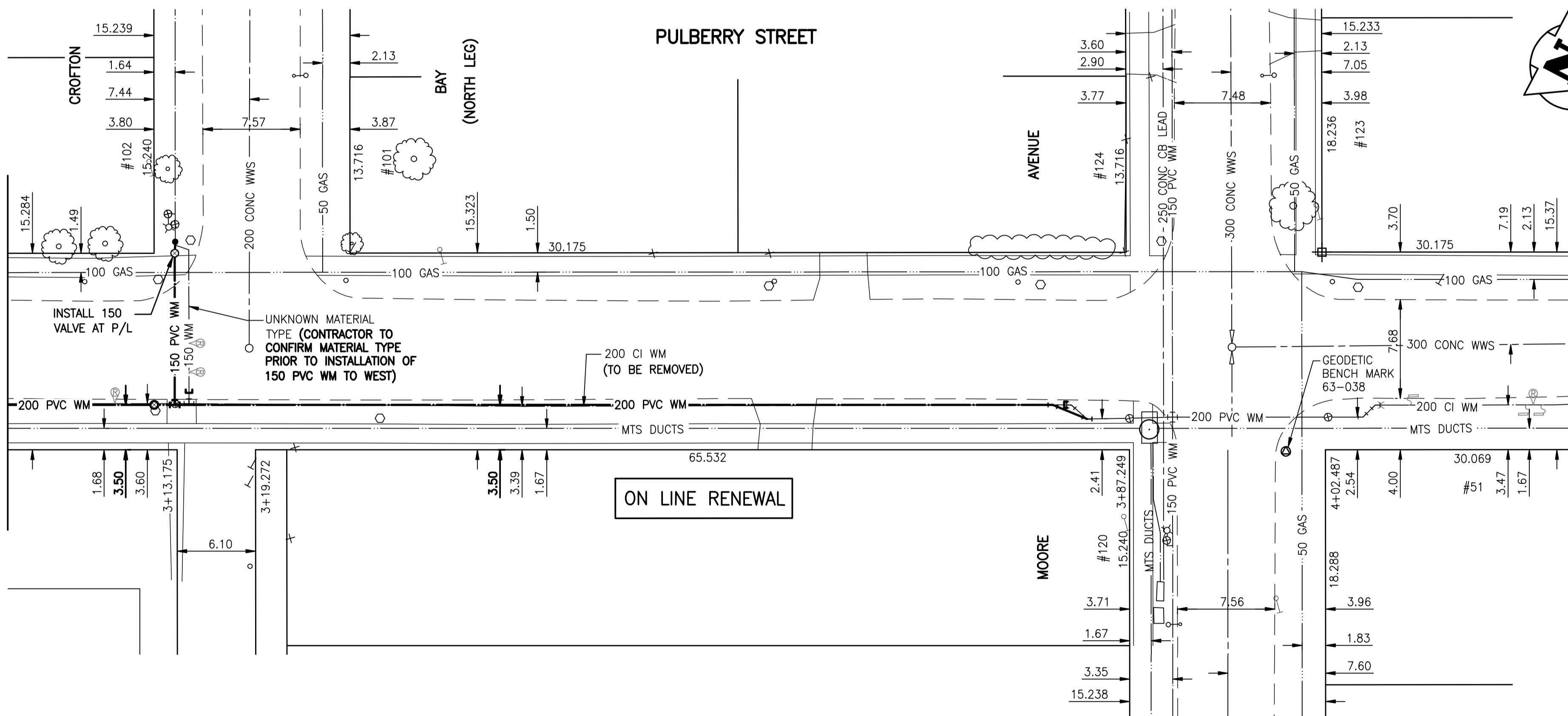

BENCH MARK: N.E. Cor. Moore Ave. & Pulberry St., Tblt. on top of 0.05 m dia. x 2.4 m iron pipe, 3.05 m S. of N.L. of Moore Ave. & on E.L. of Pulberry St.

NOTE: STATIONS ALONG E OF PULBERRY ST.

BID OPPORTUNITY 457-2010



150 WM	WATERMAIN HYDRANT	150 WM	HYDRO M.T.S.	150 WM	WATERMAIN HYDRANT, VALVE	150 WM
⊕	⊕	⊕	⊕	⊕	⊕	⊕
⊙	VALVE	⊙	CONCRETE	⊙	LAND DRAINAGE SEWER	⊙
300 LDS	LAND DRAINAGE SEWER	300 LDS	ASPHALT	250 WWS	WASTE WATER SEWER	250 WWS
250 WWS	WASTE WATER SEWER	250 WWS	SIDEWALK	⊗	PROFILE	
○	MANHOLE	○	PROPERTY LINE	⊖	NORTH OR WEST GUTTER	
□	CATCH BASIN	□	SURVEY BAR	⊕	SOUTH OR EAST GUTTER	
▽	CURB INLET	▽	DITCH	⊖	NORTH OR WEST DITCH	
+	JUNCTIONS	+	CURB STOP	⊕	SOUTH OR EAST DITCH	
---	STREET REHABILITATION LIMIT	---	TREE	△	NORTH OR WEST DITCH	
---	GAS	---	FENCE	▽	SOUTH OR EAST DITCH	
---	EXISTING	---	LEGEND-PLAN	---	LEGEND-PROFILE	---
---	PROPOSED	---	PROPOSED	---	EXISTING	---

LOCATION APPROVED UNDERGROUND STRUCTURES
SUPV. U/G STRUCTURES COMMITTEE DATE
NOTE: LOCATION OF UNDERGROUND STRUCTURES AS SHOWN ARE BASED ON THE BEST INFORMATION AVAILABLE BUT NO GUARANTEE IS GIVEN THAT ALL EXISTING UTILITIES ARE SHOWN OR THAT THE GIVEN LOCATIONS ARE EXACT. CONFIRMATION OF EXISTENCE AND EXACT LOCATION OF ALL SERVICES MUST BE OBTAINED FROM THE INDIVIDUAL UTILITIES BEFORE PROCEEDING WITH CONSTRUCTION.

NO.	REVISIONS	DATE	BY

Stantec Consulting Ltd.
905 Waverley Street, Winnipeg, Manitoba
Tel 204-489-5900 Fax 204-453-9012

DESIGNED BY: J.K.H.	CHECKED BY: W.W.B.
DRAWN BY: J.K.H.	APPROVED BY: H.A.K.
HOR. SCALE: 1:250	RELEASED FOR CONSTRUCTION:
VERTICAL: 1:50	DATE: 10.04.15

ENGINEER'S SEAL
ORIGINAL SEALED BY H.A. KATZ P. ENG. 10.06.09
CONSULTANT DRAWING NO. C-213

THE CITY OF WINNIPEG
WATER AND WASTE DEPARTMENT
ENGINEERING DIVISION

2010 WATERMAIN RENEWALS - CONTRACT 8
PULBERRY STREET
87.2 SSL OF MOORE AVENUE TO MOORE AVENUE

SHEET 13 OF 13
CAD FILE DRAWING NUMBER 12170c-211-735.dwg
CITY DRAWING NUMBER D-12090