

sheet size: Super A1 247 x 367 photo scale: 1:1 (metric) CAD File Name: 0013_base_working_sw_090.dwg

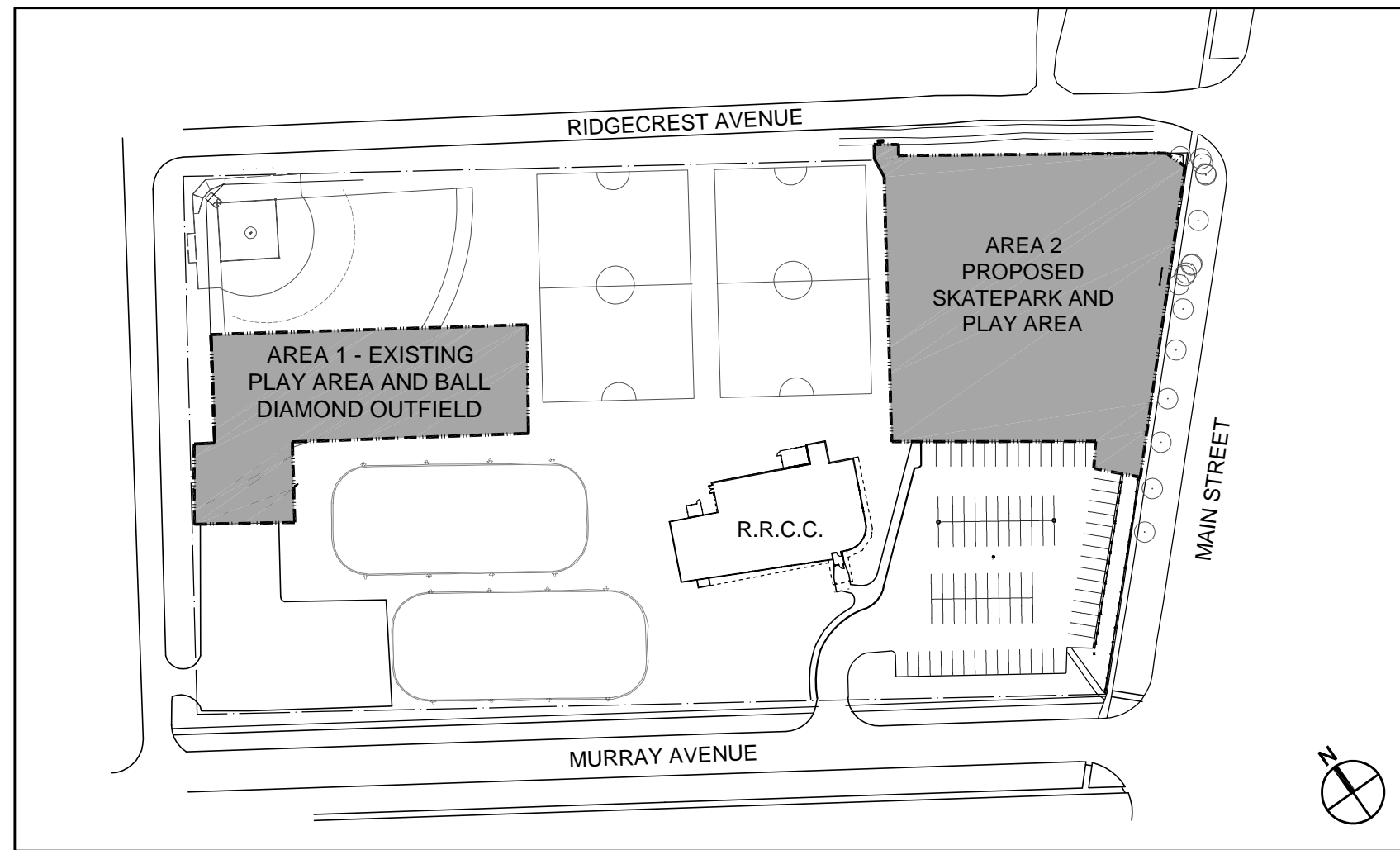

1
L2 KEY PLAN - PROPOSED SITEWORKS
NTS

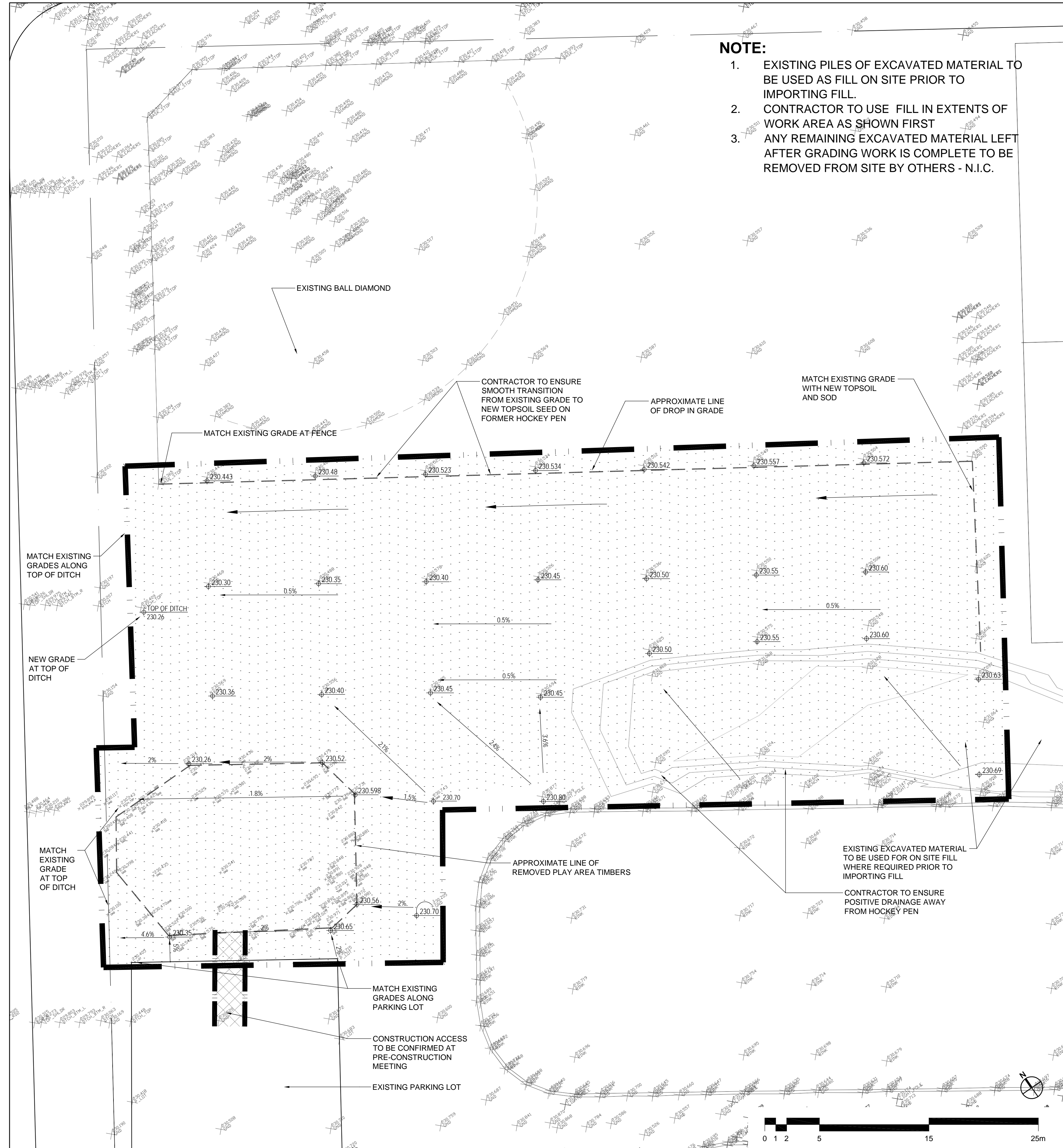

- NOTE:**
- EXISTING PILES OF EXCAVATED MATERIAL TO BE USED AS FILL ON SITE PRIOR TO IMPORTING FILL.
 - CONTRACTOR TO USE FILL IN EXTENTS OF WORK AREA AS SHOWN FIRST
 - ANY REMAINING EXCAVATED MATERIAL LEFT AFTER GRADING WORK IS COMPLETE TO BE REMOVED FROM SITE BY OTHERS - N.I.C.

NOTES:

- GENERAL NOTES**
- ALL EXISTING TREES, SHRUBS, SIDEWALKS, CURBS, SOD, UTILITIES AND PAVING TO BE PROTECTED (UNLESS OTHERWISE NOTED) DURING CONSTRUCTION TO CITY OF WINNIPEG STANDARDS. CONTRACTOR TO MAKE GOOD ALL DAMAGED AREAS DURING CONSTRUCTION BOTH ON AND OFF SITE TO CITY OF WINNIPEG STANDARDS AT THE CONTRACTORS COST.
 - MAINTAIN EXISTING GRADE AND DRAINAGE PATTERNS. ENSURE POSITIVE DRAINAGE.
 - ELEVATIONS SHOWN REPRESENT FINISHED GRADE. CONTRACTOR TO ENSURE SUB-GRADE FORMED TO ALLOW FOR TOPSOIL AND SEED AS PER CW 3520-R7.
 - ALL GRADES TO BE APPROVED BY CONTRACT ADMINISTRATOR PRIOR TO INSTALLATION.
 - CONTRACTOR TO ENSURE FILL AREAS BLEND SMOOTHLY WITH EXISTING GRADE.
 - REFER ALSO TO WRITTEN SPECIFICATIONS

LEGEND

	PROPERTY LINE
	LIMITS OF WORK
	CONSTRUCTION ACCESS LOCATION
	EXISTING CHAIN LINK FENCE
	PROPOSED SEED
	EXISTING SPOT ELEVATION
	PROPOSED SPOT ELEVATION
	SLOPE GRADIENT AND DIRECTION

REV	YY / MM / DD	DESCRIPTION	BY
R0	2010/08/06	RELEASED FOR TENDER	JW

A. SECTION LETTER OR DETAIL NUMBER,
B. DRAWING WHERE SECTION OR DETAIL IS DRAWN,
OR
DRAWING WHERE SECTION OR DETAIL IS INDICATED,
--- SECTION OR DETAIL SHOWN ON SAME DRAWING.

SEAL

 J. Wapner
 MEMBER NO. 82

SCATLIFF + MILLER + MURRAY Inc.
 TEL 204 927-3444 8-136 MARKET AVENUE
 FAX 204 927-3443 WINNIPEG, MB, CANADA

CLIENT
CITY OF WINNIPEG

PROJECT
RED RIVER COMMUNITY CENTRE
SITE WORKS AND FURNISHINGS

TITLE
RED RIVER COMMUNITY CENTRE
PROPOSED SITEWORKS
AREA 1

DESIGN	DRAWN	DATE - Y / M / D	SCALE
JW	JW/MBP	2010/08/06	AS SHOWN
CHECKED	APPROVED	JOB NO.	DRAWING NO.
JW	JW	9019	L2

2
L2 AREA 1- PROPOSED GRADING FOR EXISTING PLAY AREA AND FIELD
1 : 200

FOR TENDER PURPOSES ONLY