

sheet size: Super A1 247 x 367
 CAD File Name: 0013_base_working_sw_090.dwg

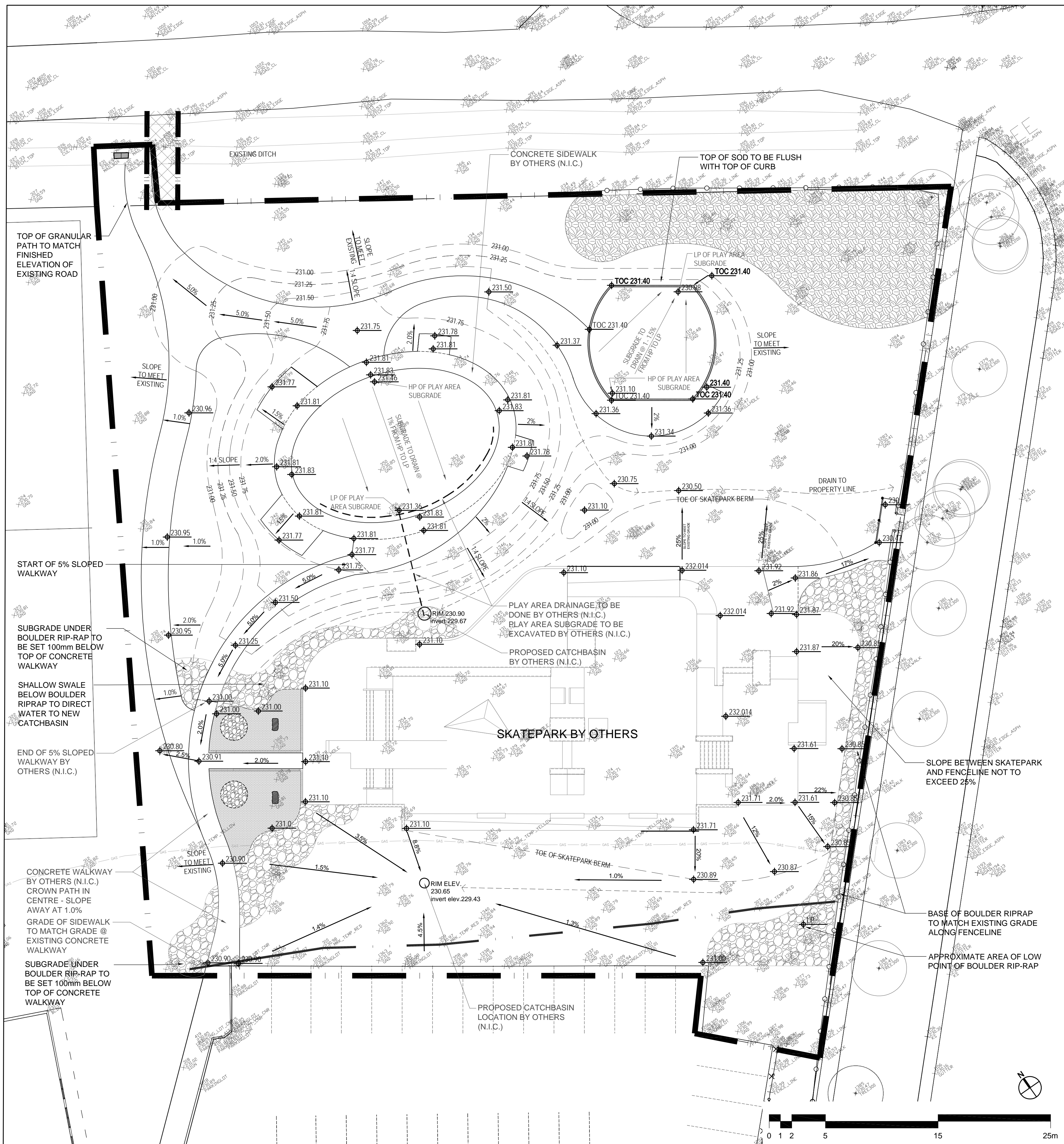

1 AREA 2 - GRADING PLAN
L5 1:200

FOR TENDER PURPOSES ONLY

NOTE:

- ROUGH GRADING OF BERMS TO BE DONE BY SKATEPARK CONTRACTOR
- CONCRETE WALKWAYS AND CURBING TO BE DONE BY SKATEPARK CONTRACTOR
- BASE COURSE FOR CONCRETE PAVERS TO BE DONE BY SKATEPARK CONTRACTOR
- SITWORKS CONTRACTOR TO COMPLETE FINISH GRADING, TOPSOIL, SOD AND SEED AS INDICATED ON DRAWING
- SITWORKS CONTRACTOR TO ESTABLISH FINISH GRADES FOR DRAINAGE SWALES, CONCRETE PAVERS, GRANULAR PATHWAY AND BOULDER RIP-RAP SUBGRADE AS INDICATED ON DRAWINGS

NOTE:

SKATEPARK CONTRACTOR TO CONFIRM WITH PLAY EQUIPMENT CONTRACTOR THE DEPTH REQUIRED FOR SAFETY SURFACING IN PLAY AREAS A AND B PRIOR TO EXCAVATING AND GRADING OF PLAY AREAS.

REFER TO 2/L5 FOR LOCATION OF MULTI-FLOW LINES IN PLAY AREA A

SOD EDGE. GRADE TO MATCH TOP OF CONCRETE EDGING. ENSURE POSITIVE DRAINAGE AWAY FROM PLAY AREA (GRANULAR - 1% SOD - MIN 1%, MAX 5%)

150 x 200mm CONCRETE CURB EDGING WITH 1 CONTINUOUS 10M REBAR

SAFETY SURFACING (BY OTHERS) TOP OF SAND SURFACE TO BE NO MORE THAN 12.5mm BELOW TOP OF CURB

150mm DEPTH x 450mm CRUSHED GRANULAR BASE

GEOTEXTILE FABRIC TO BE PLACED BETWEEN LIMESTONE BASE AND COMPACTED SUBGRADE. EXTEND FABRIC AROUND LIMESTONE BASE AND UNDER CONCRETE CURB

COMPACTED SUBGRADE

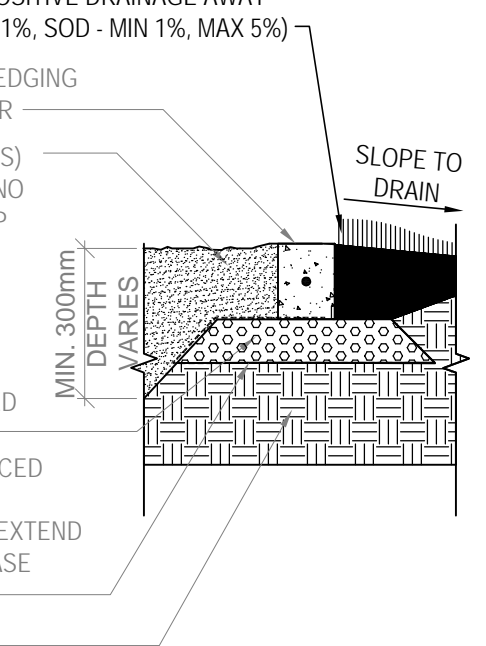

2 SECTION THROUGH CONCRETE CURB AND PLAY AREA B
L5 1:20

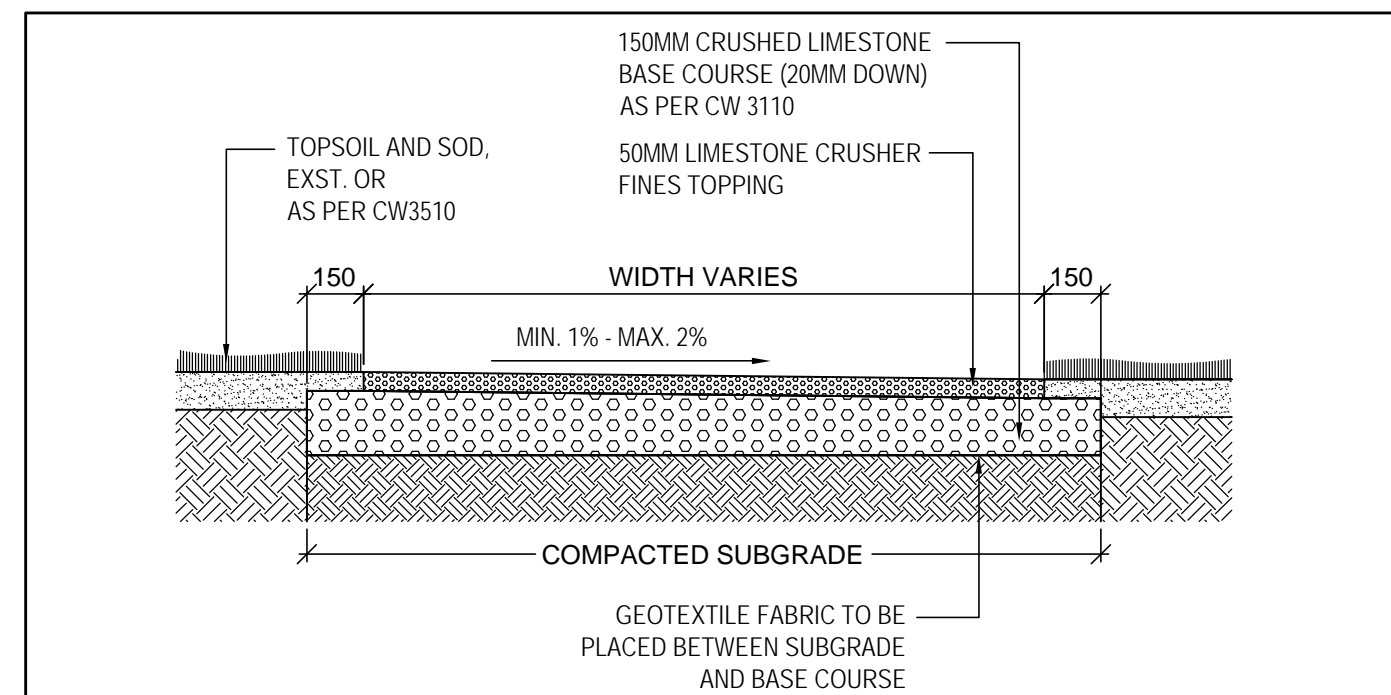

3 TYPICAL SECTION THROUGH CRUSHED GRANULAR PATH
L5 1:20

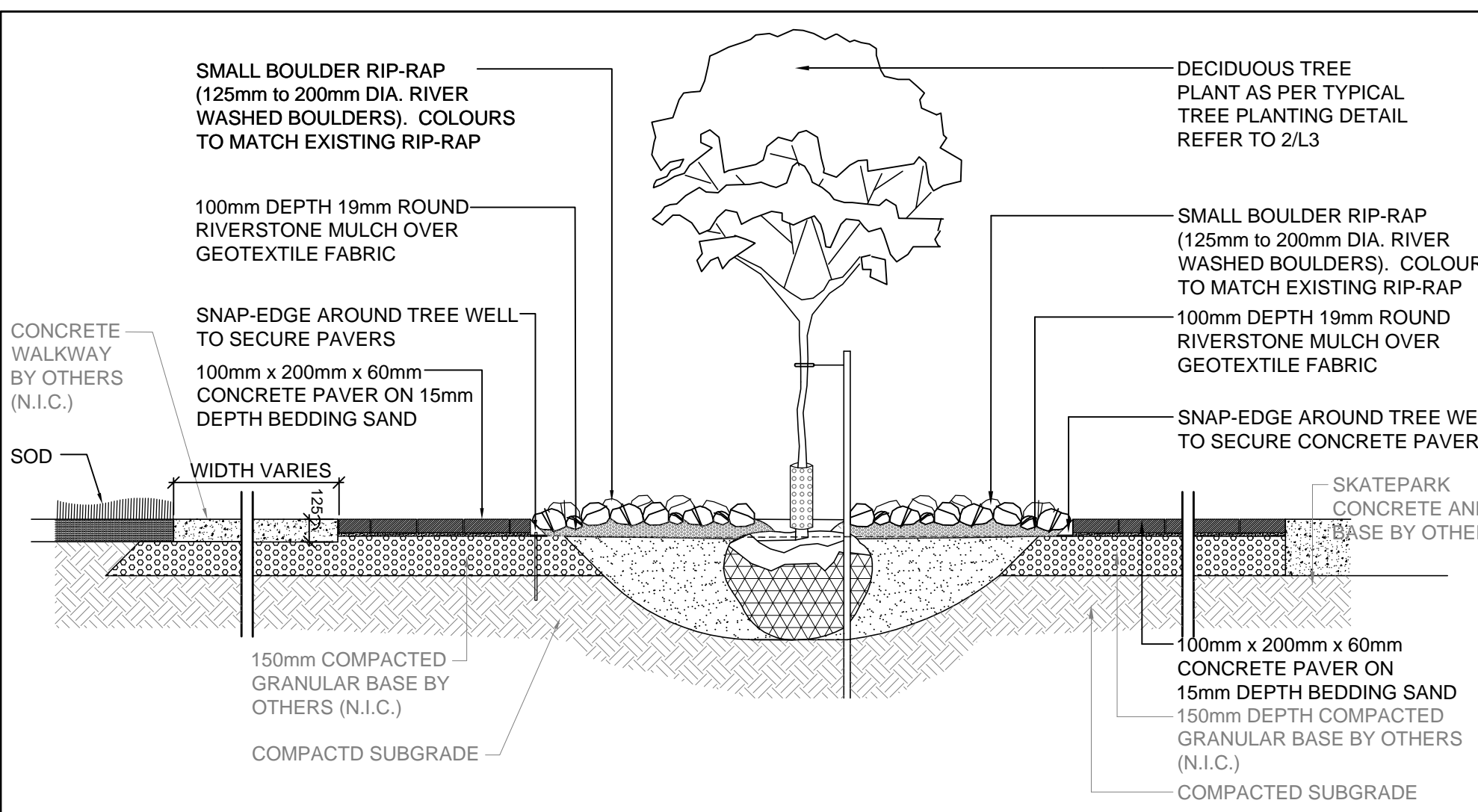

4 SECTION DETAIL - CONCRETE PAVER PLAZA
L5 1:25

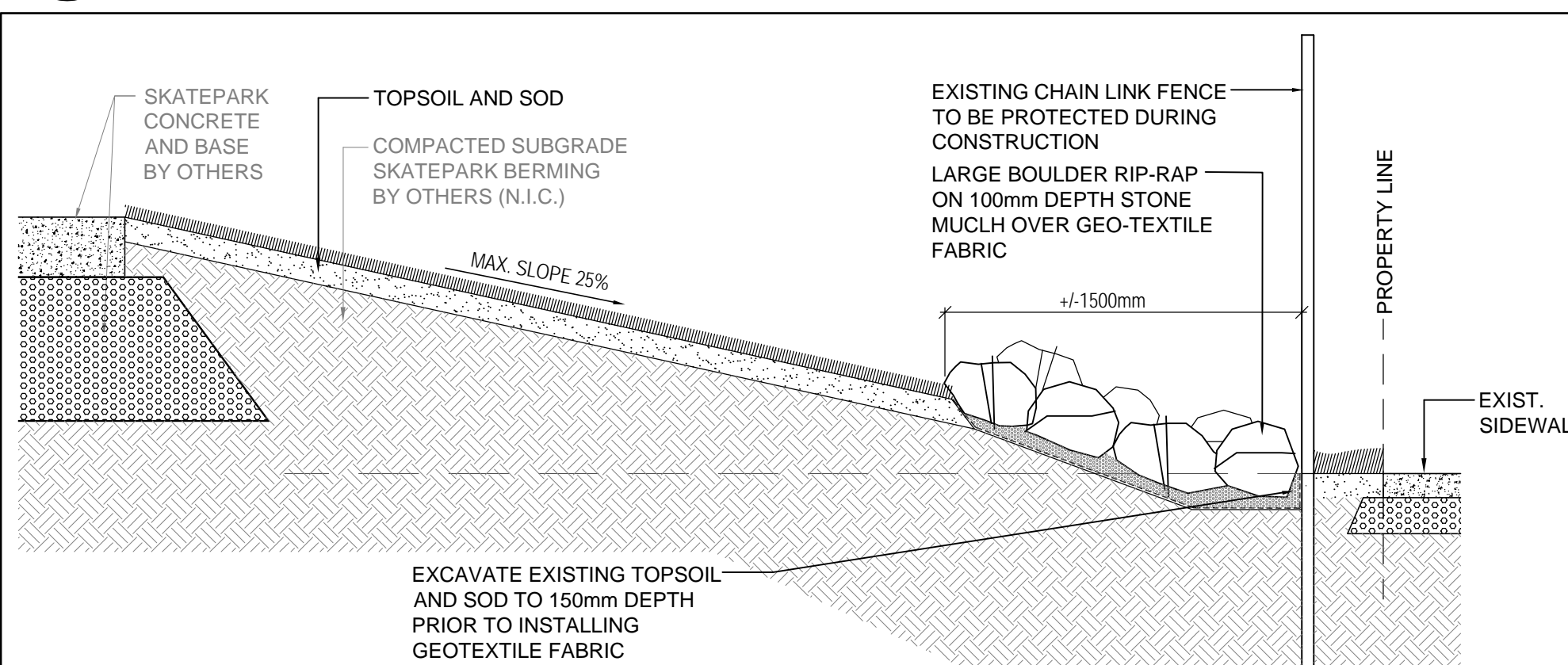

5 SECTION THROUGH SKATEPARK TO PROPERTY LINE
L5 1:10

NOTES:

GRADING NOTES

- ALL EXISTING TREES, SHRUBS, SIDEWALKS, CURBS, SOD, UTILITIES AND PAVING TO BE PROTECTED (UNLESS OTHERWISE NOTED) DURING CONSTRUCTION TO CITY OF WINNIPEG STANDARDS. CONTRACTOR TO MAKE GOOD ALL DAMAGED AREA DURING CONSTRUCTION BOTH ON AND OFF SITE TO CITY OF WINNIPEG STANDARDS AT THE CONTRACTOR'S COSTS.
- EXISTING GRADE TO BE MAINTAINED AT ALL PROPERTY LINES AND CITY SIDEWALKS AND WITHIN 3m OF TREES.
- ALL GRADING TO BE APPROVED BY CONTRACT ADMINISTRATOR PRIOR TO ANY CONSTRUCTION.
- EXACT LOCATION OF UNDERGROUND SERVICES SHOULD BE CHECKED WITH THE UTILITIES PRIOR TO CONSTRUCTION OR EXCAVATION.
- EXISTING GRADES, BUILDINGS LOCATIONS AND LAYOUTS ARE GIVEN AS INFORMATION ONLY AND SHOULD BE VERIFIED ON SITE. REPORT ANY DISCREPANCIES.
- REPORT ANY DISCREPANCIES TO C.A. PRIOR TO CONSTRUCTION.
- ALL PROPOSED ELEVATIONS TO BE FINISHED ELEVATIONS.
- ENSURE POSITIVE DRAINAGE IN ALL AREAS TO CATCH BASINS AND CURB INLETS.
- ELEVATIONS OF ALL EXISTING TREES AND UTILITIES TO REMAIN, UNLESS NOTED OTHERWISE.
- SLOPE TOLERANCE:
 - GRANULAR PAVING SLOPES: MAX. 5%, MIN. 2%; MAX. CROSS SLOPE 1.5%
 - SODDED AREA SLOPES: MAX. 25%, MIN. 1%
 - ANY DEVIATION FROM THE ABOVE SLOPES TO BE APPROVED BY CONTRACT ADMINISTRATOR PRIOR TO CONSTRUCTION
- IF POWER EQUIPMENT IS TO BE USED FOR EXCAVATION ON THIS PROJECT THE CONTRACTOR MUST:
 - A) NOTIFY THE GAS COMPANY AND HYDRO COMPANY OF THE PROPOSED LOCATION OF EXCAVATION.
 - B) TAKE PRECAUTION TO AVOID DAMAGE TO GAS COMPANY AND HYDRO COMPANY INSTALLATIONS.
- REFER ALSO TO WRITTEN SPECIFICATIONS

LEGEND

- PROPERTY LINE
- LIMITS OF WORK
- CONSTRUCTION ACCESS LOCATION
- EXISTING CHAIN LINK FENCE
- EXISTING TREE
- EXISTING BURIED HYDRO LINE
- EXISTING SPOT ELEVATION
- PROPOSED SPOT ELEVATION
- SLOPE GRADIENT/DIRECTION
- SWALE

R0	2010/08/06	RELEASED FOR TENDER	JW
REV	YY/MM/DD	DESCRIPTION	BY

A	SECTION LETTER OR DETAIL NUMBER, B. DRAWING WHERE SECTION OR DETAIL IS DRAWN.	SEAL
OR	DRAWING WHERE SECTION OR DETAIL IS INDICATED, -- SECTION OR DETAIL SHOWN ON SAME DRAWING.	
A		
B		

SCATLIFF + MILLER + MURRAY Inc.
 TEL 204 927-3444 FAX 204 927-3443
 8 - 136 MARKET AVENUE WINNIPEG, MB, CANADA

CLIENT: CITY OF WINNIPEG

PROJECT: RED RIVER COMMUNITY CENTRE SITE WORKS AND FURNISHINGS

TITLE: RED RIVER COMMUNITY CENTRE PROPOSED SITWORKS GRADING PLAN AND DETAILS

DESIGN	DRAWN	DATE - Y/M/D	SCALE
JW	JW/MBP	2010/07/26	AS SHOWN
CHECKED	APPROVED	JOB NO.	DRAWING NO.
JW	JW	9019	L5