

TYPICAL PATH SECTION AT STA 1+060.0 TO 1+345.0
HOR 1:50, VER 1:20

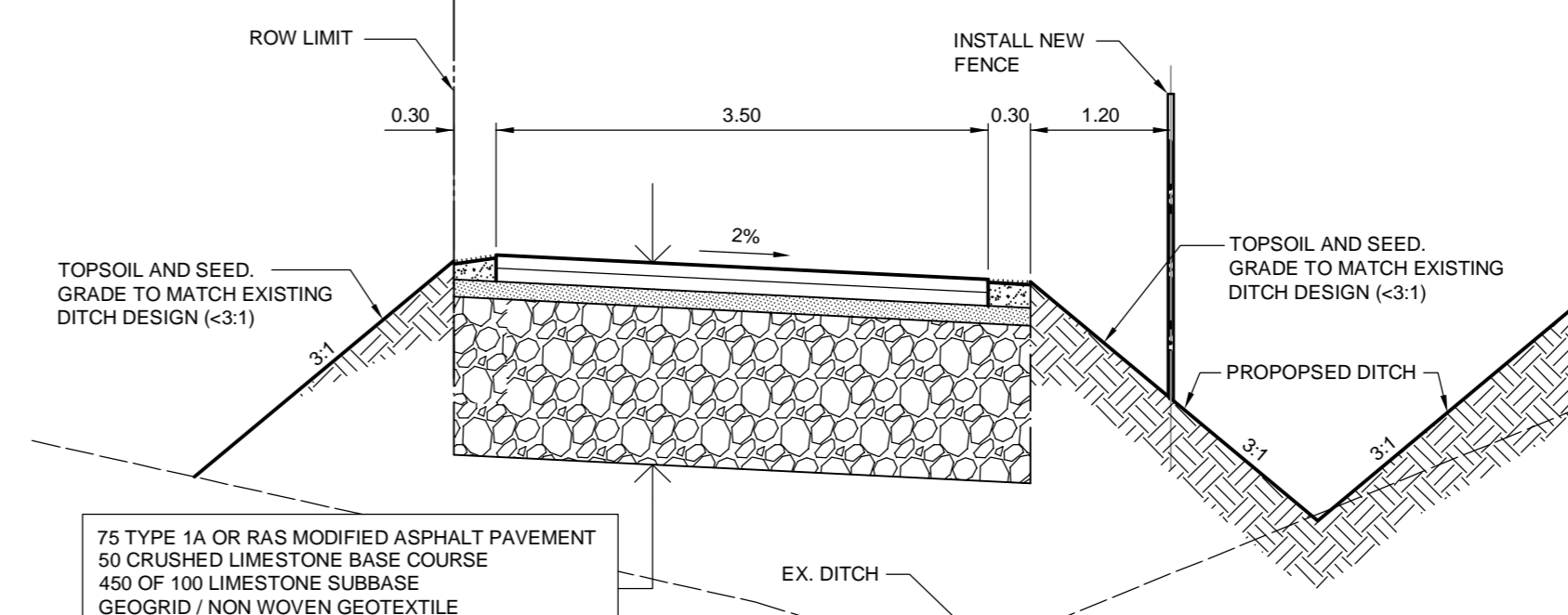

TYPICAL PATH SECTION AT STA 1+345.0 TO 1+480.0
HOR 1:50, VER 1:20

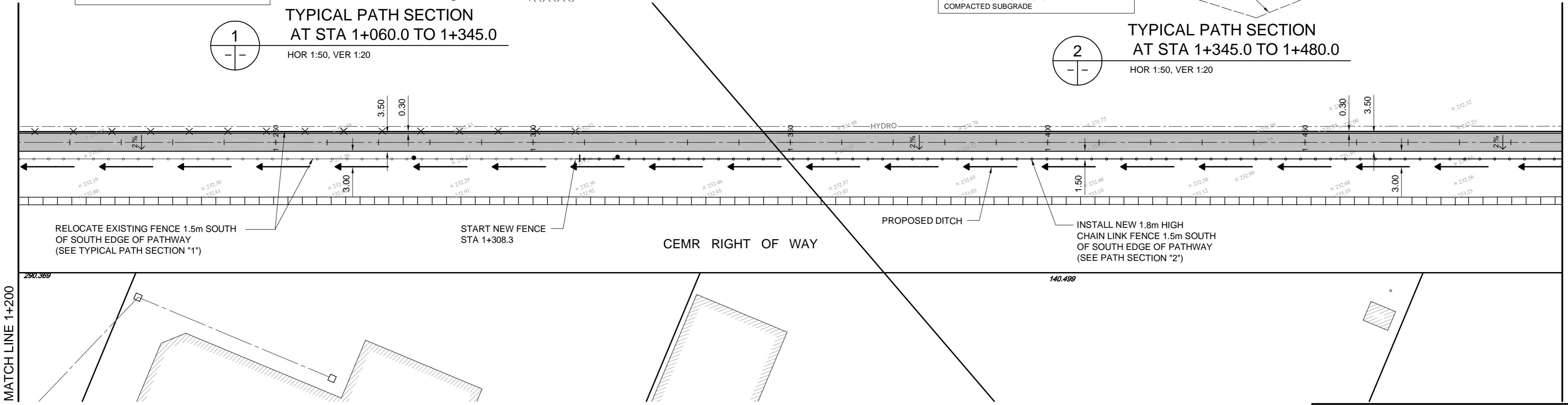

Coordinate Control Survey Monuments			
No.	NAD 83 Grid Coordinate	Description	
	Northing	Easting	
CP1	5528842.152	639868.658	IRON BAR
CP2	5529368.017	641068.147	IRON BAR
CP3	5530344.824	643436.566	IRON BAR
CP4	5530372.228	643436.161	IRON BAR
CP5	5530394.867	646173.994	IRON BAR

APEGM
Certificate of Authorization
Wardrop Engineering Inc.
No. 195 Expiry: April 30, 2011

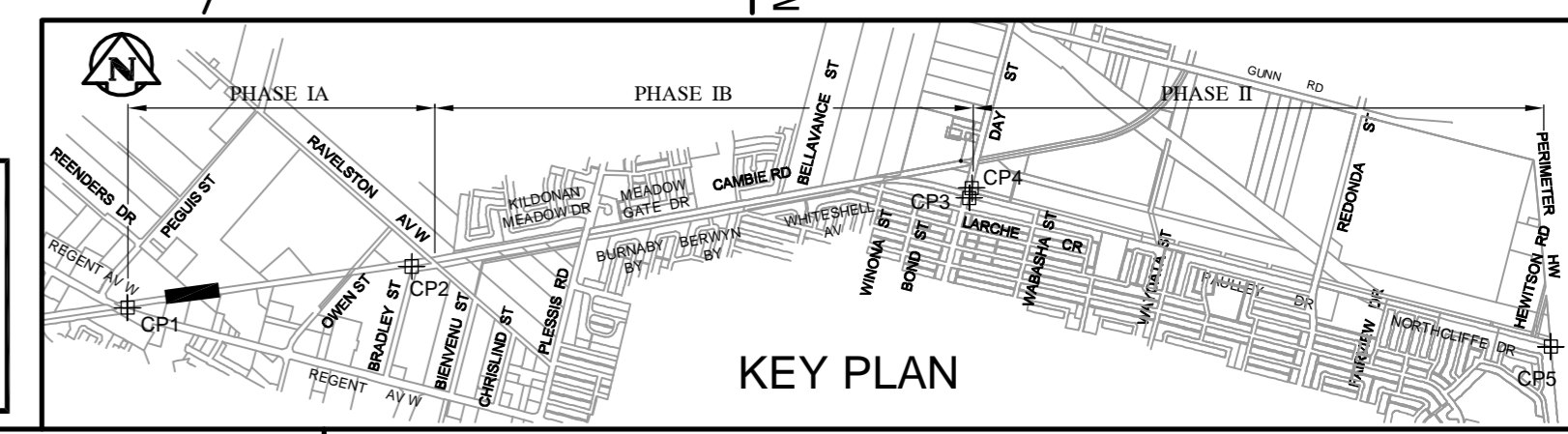

150 WM	WATERMAIN	150 WM	SWALE	TRAFFIC SIGNAL
400 FM	FEEDERMAIN	400 FM	MANHOLE	GAS
300 LDS	LAND DRAINAGE SEWER	300 LDS	CATCHBASIN	HYDRO
250 WWS	WASTEWATER SEWER	250 WWS	HYDRO BOX	MTS
300 CS	COMBINED SEWER	300 CS	HYDRO POLE	SPRINKLER
200 FCM	FORCEMAIN	200 FCM	LIGHT STANDARD	ELEVATION
	JUNCTIONS		ANCHOR	SIDEWALK
	HYDRANT		TREE	CURB
	VALVE		SURVEY BAR	ASPHALT
	CURB STOP		SIGNAL CONTROLLER	CONCRETE
EXISTING	LEGEND-PLAN	PROPOSED	LEGEND-PLAN	PROPOSED

LOCATION APPROVED UNDERGROUND STRUCTURES

SUPV. U/G STRUCTURES COMMITTEE DATE

NOTE: LOCATION OF UNDERGROUND STRUCTURES AS SHOWN ARE BASED ON THE BEST INFORMATION AVAILABLE. BUT NO GUARANTEE IS GIVEN THAT ALL EXISTING UTILITIES ARE SHOWN OR THAT THE GIVEN LOCATIONS ARE EXACT. CONFIRMATION OF EXISTENCE AND EXACT LOCATION OF ALL SERVICES MUST BE OBTAINED FROM THE INDIVIDUAL UTILITIES BEFORE PROCEEDING WITH CONSTRUCTION.

NO.	ISSUED FOR TENDER	DATE	BY
00	ISSUED FOR TENDER	10.07.13	DAL
NO. REVISIONS			

WARDROP PEOPLE. PASSION. PERFORMANCE. TRUSTED GLOBALLY.

DESIGNED BY: TF
DRAWN BY: NL

CHECKED BY:
APPROVED BY:

HOR. SCALE: 1 : 500
VERTICAL: 1 : 20

RELEASED FOR CONSTRUCTION

PRELIMINARY DRAWING

NOT TO BE USED FOR CONSTRUCTION

CONSULTANT DRAWING NO. 100070100-DWG-C1002-00

THE CITY OF WINNIPEG
PUBLIC WORKS DEPARTMENT
ENGINEERING DIVISION

2010 ACTIVE TRANSPORTATION / INFRASTRUCTURE STIMULUS PROGRAM

TRANSCONA TRAIL MULTI USE PATHWAY
200m EAST OF REGENT AVENUE
TO STA 1+500

CITY DRAWING NUMBER
SHEET 2 OF 31
C1002