

**1 ASPHALT RESURFACING/EXTENSION CROSS SECTION**  
HOR 1:50, VER 1:20

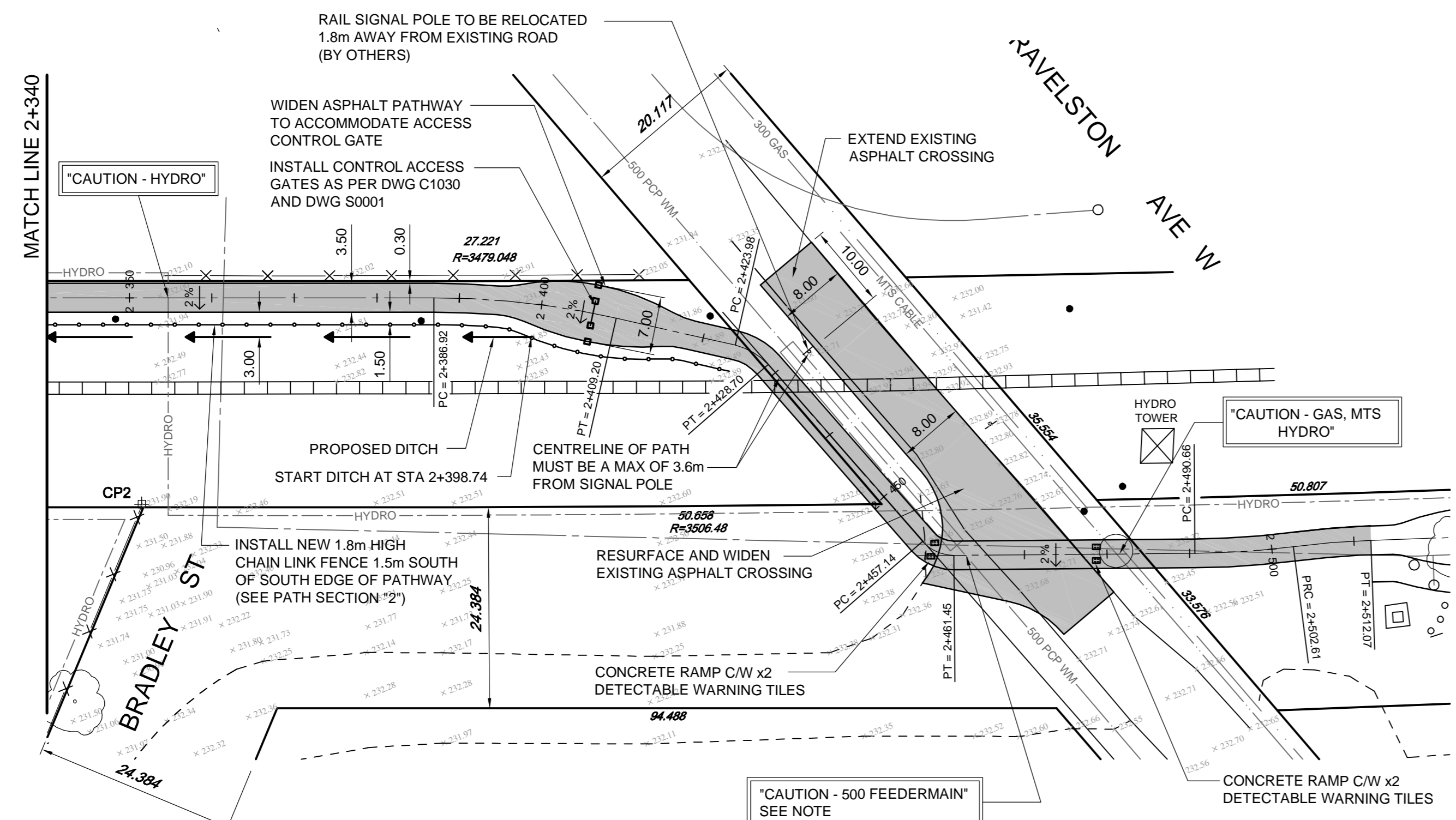

FOR CONSTRUCTION DETAILS EAST OF STA 2+512.07 SEE DRAWING C1007

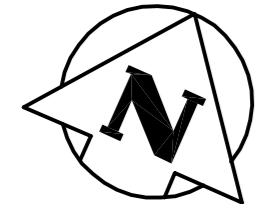
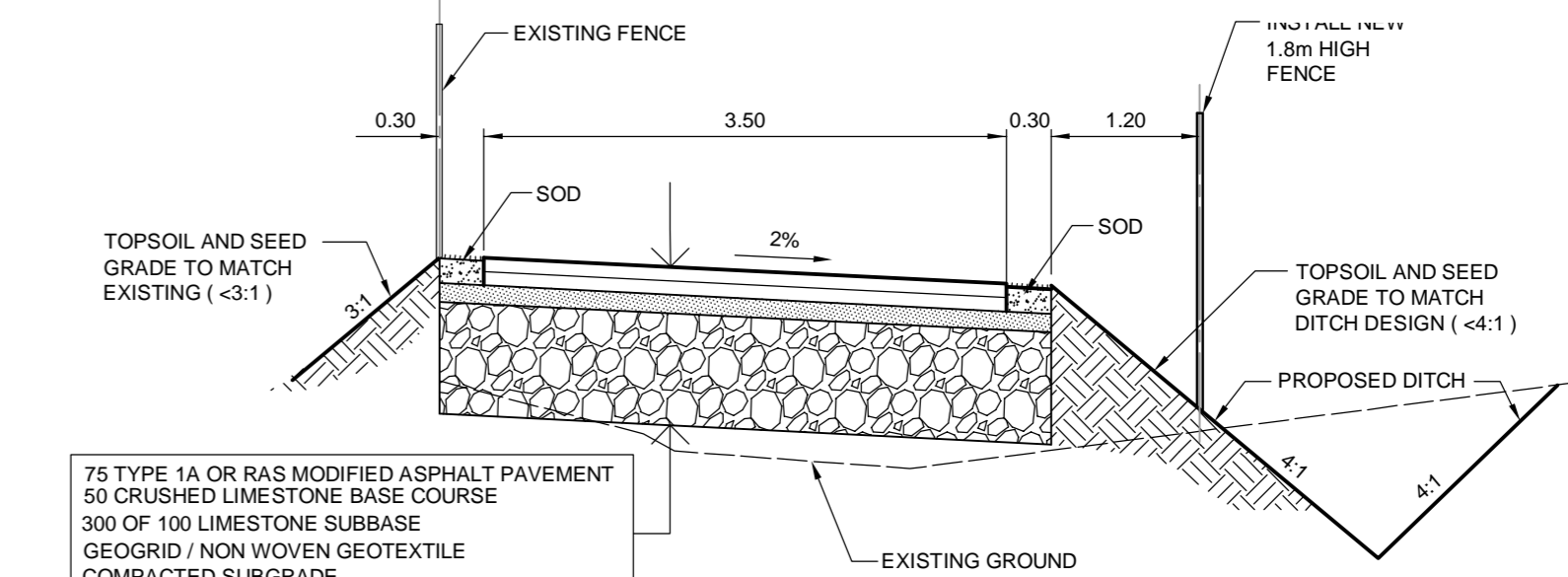

**2 TYPICAL PATH SECTION AT STA 2+087.0 TO 2+460.0**  
HOR 1:50, VER 1:20

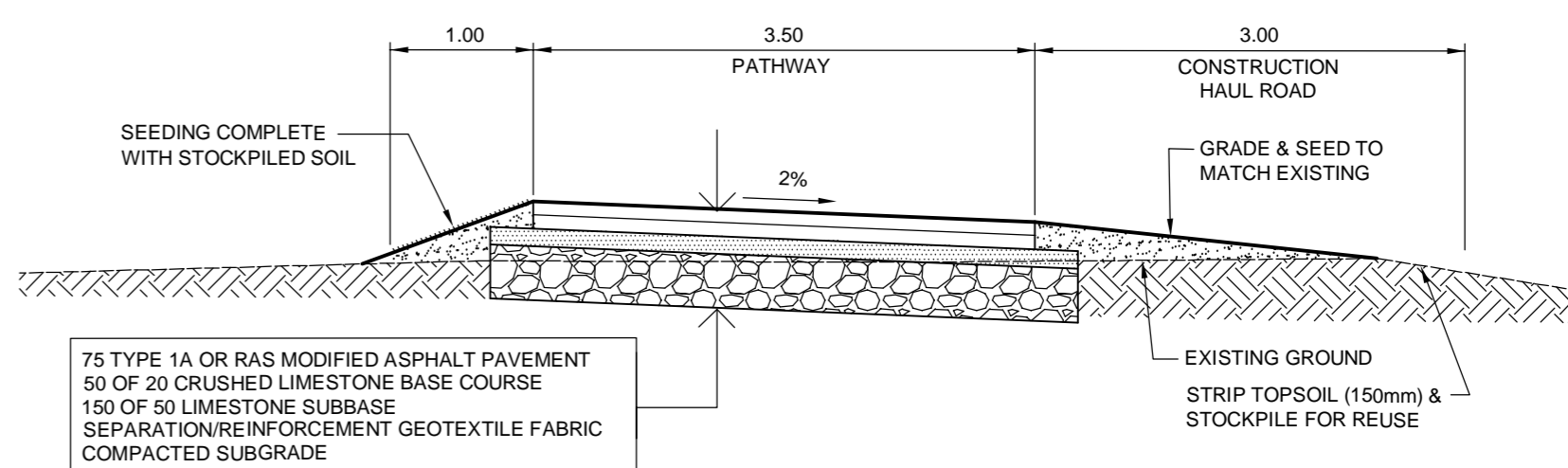

**3 PATH SECTION STA 2+477 TO EAST**  
HOR 1:50, VER 1:20

**CAUTION: FEEDERMAIN CROSSING**  
SEE SPECIFICATIONS FOR CONSTRUCTION PROCEDURES AND RESTRICTIONS  
CONTACT THE WATER AND WASTE DEPARTMENT CONSTRUCTION SERVICES COORDINATOR AT 986-3823  
A MINIMUM OF SEVEN DAYS PRIOR TO CROSSING OR WORKING ADJACENT TO FEEDERMAIN TO ARRANGE FOR INSPECTION.

Coordinate Control Survey Monuments			
No.	NAD 83 Grid Coordinate	Description	
	Northing	Easting	
CP1	5528842.152	639868.658	IRON BAR
CP2	5529368.017	641068.147	IRON BAR
CP3	5530344.824	643436.566	IRON BAR
CP4	5530372.228	643436.161	IRON BAR
CP5	5530394.867	646173.994	IRON BAR

**APEGM**  
Certificate of Authorization  
Wardrop Engineering Inc.  
No. 195 Expiry: April 30, 2011

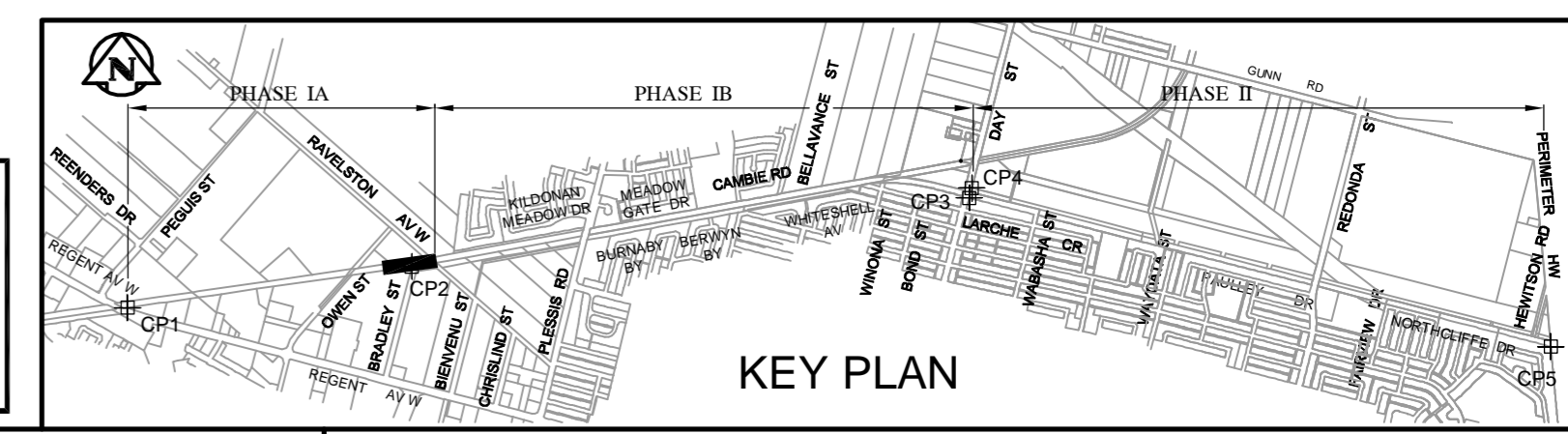

150 WM	WATERMAIN	150 WM	SWALE	TRAFFIC SIGNAL
400 FM	FEEDERMAIN	400 FM	MANHOLE	GAS
300 LDS	LAND DRAINAGE SEWER	300 LDS	CATCHBASIN	HYDRO
250 WWS	WASTEWATER SEWER	250 WWS	HYDRO BOX	MTS
300 CS	COMBINED SEWER	300 CS	HYDRO POLE	SPRINKLER
200 FCM	FORCEMAIN	200 FCM	LIGHT STANDARD	ELEVATION
	JUNCTIONS		ANCHOR	SIDEWALK
	HYDRANT		TREE	CURB
	VALVE		SURVEY BAR	ASPHALT
	CURB STOP		SIGNAL CONTROLLER	CONCRETE
EXISTING	LEGEND-PLAN	PROPOSED	EXISTING	LEGEND-PLAN

**LOCATION APPROVED UNDERGROUND STRUCTURES**  
SUPV. U/G STRUCTURES COMMITTEE DATE  
NOTE: LOCATION OF UNDERGROUND STRUCTURES AS SHOWN ARE BASED ON THE BEST INFORMATION AVAILABLE. BUT NO GUARANTEE IS GIVEN THAT ALL EXISTING UTILITIES ARE SHOWN OR THAT THE GIVEN LOCATIONS ARE EXACT. CONFIRMATION OF EXISTENCE AND EXACT LOCATION OF ALL SERVICES MUST BE OBTAINED FROM THE INDIVIDUAL UTILITIES BEFORE PROCEEDING WITH CONSTRUCTION.

NO.	REVISIONS	DATE	BY
00	ISSUED FOR TENDER	10.07.13	DAL

**WARDROP** PEOPLE. PASSION. PERFORMANCE. TRUSTED GLOBALLY.  
DESIGNED BY TF CHECKED BY  
DRAWN BY NL APPROVED BY  
HOR. SCALE: 1 : 500  
VERTICAL: 1 : 20  
RELEASED FOR CONSTRUCTION  
DATE

**PRELIMINARY DRAWING**  
NOT TO BE USED FOR CONSTRUCTION  
CONSULTANT DRAWING NO. 100070100-DWG-C1006-00

**THE CITY OF WINNIPEG**  
PUBLIC WORKS DEPARTMENT  
ENGINEERING DIVISION  
2010 ACTIVE TRANSPORTATION / INFRASTRUCTURE STIMULUS PROGRAM  
TRANCONA TRAIL MULTI USE PATHWAY  
80m WEST OF RAVELSTON AVENUE TO RAVELSTON AVENUE  
CITY DRAWING NUMBER  
SHEET 6 OF 31  
C1006