

1 TYPICAL PATH SECTION
HOR 1:50, VER 1:20

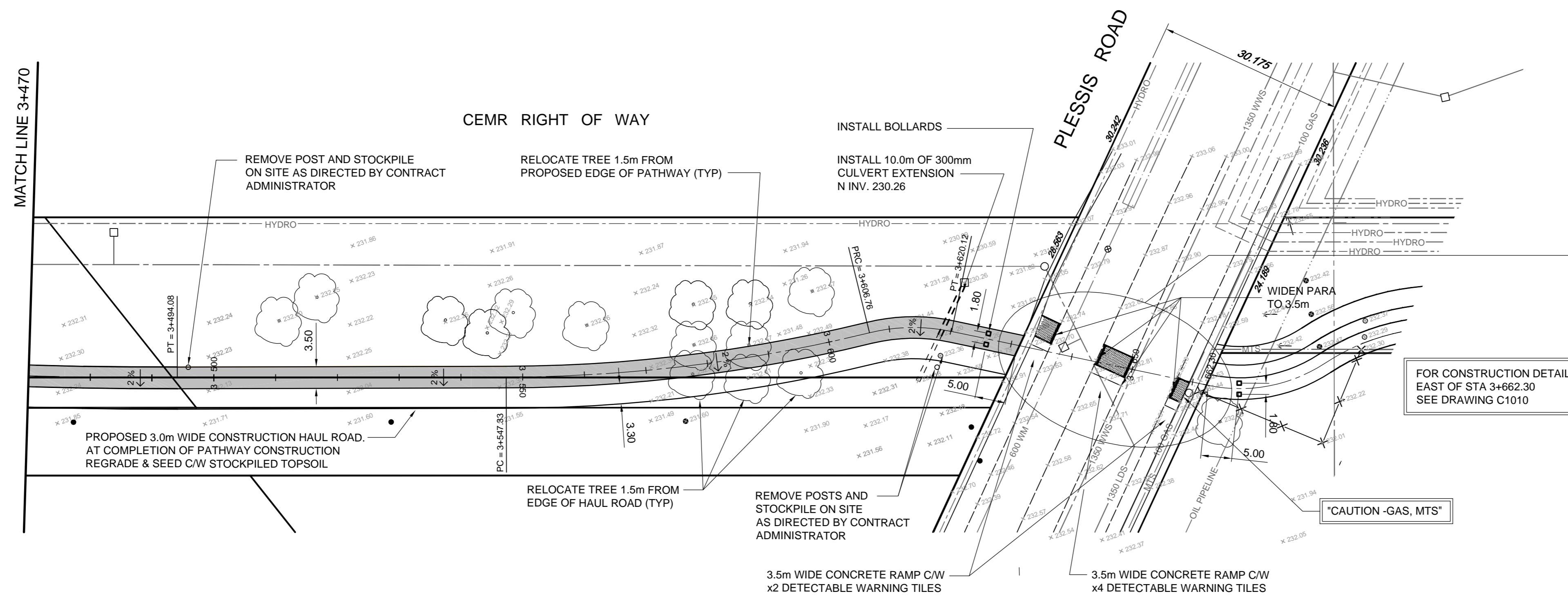

FOR CONSTRUCTION DETAILS EAST OF STA 3+662.30 SEE DRAWING C1010

Coordinate Control Survey Monuments			
No.	NAD 83 Grid Coordinate	Description	
	Northing	Easting	
CP1	5528842.152	639868.658	IRON BAR
CP2	5529368.017	641068.147	IRON BAR
CP3	5530344.824	643436.566	IRON BAR
CP4	5530372.228	643436.161	IRON BAR
CP5	5530384.867	646173.994	IRON BAR

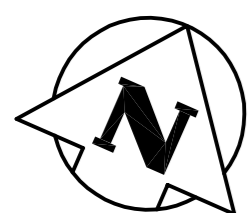
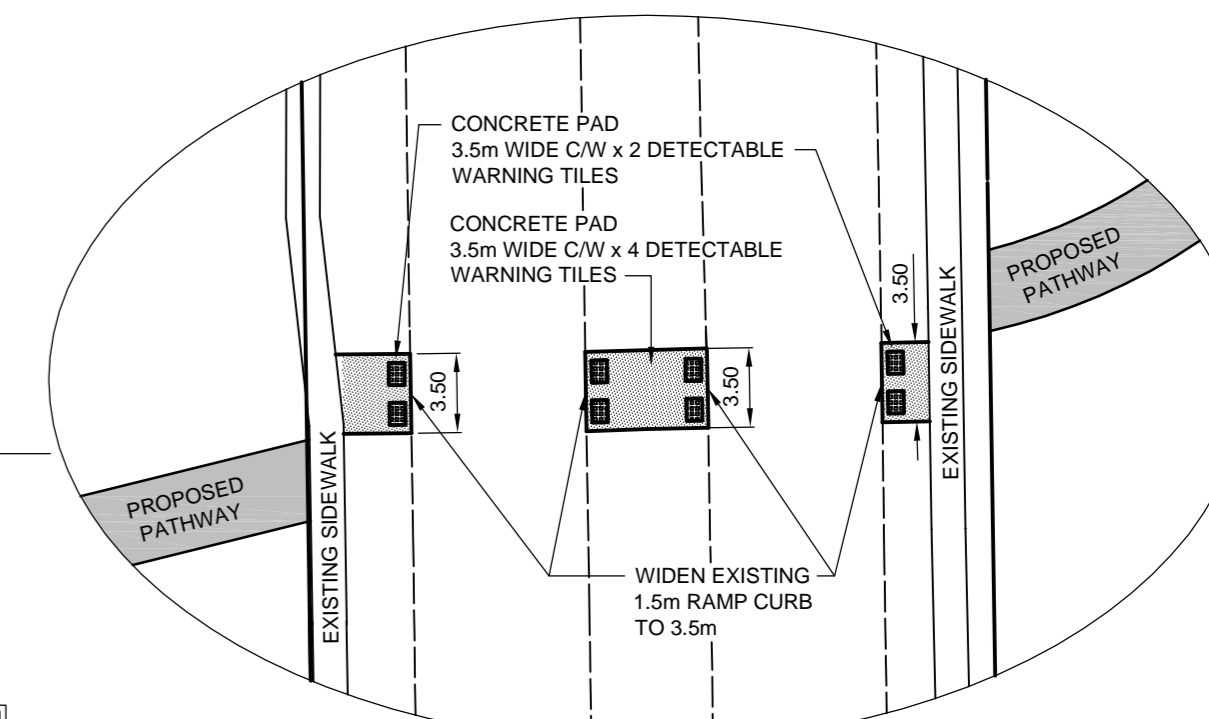
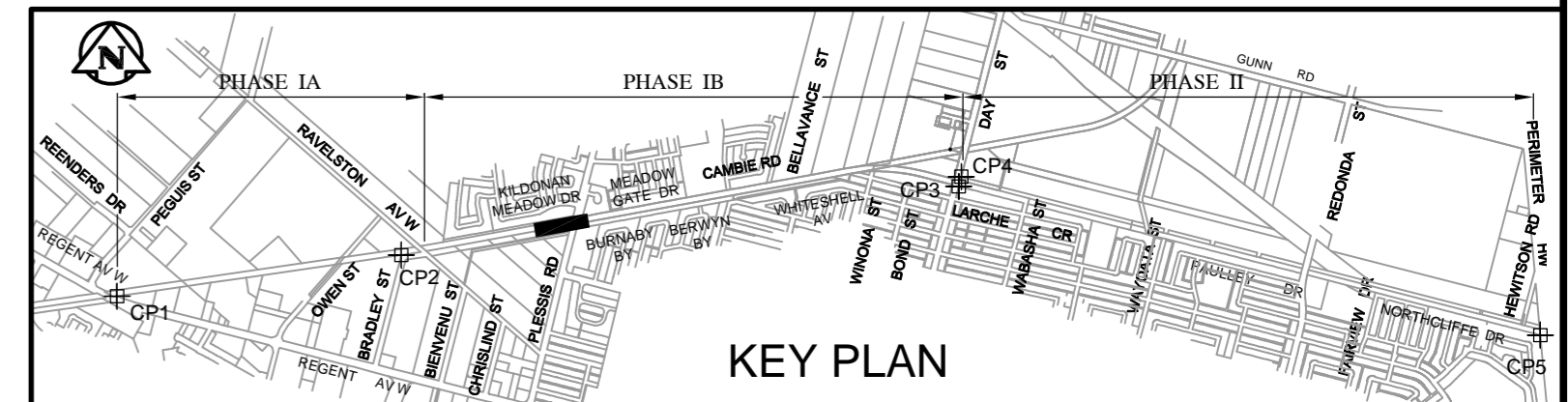
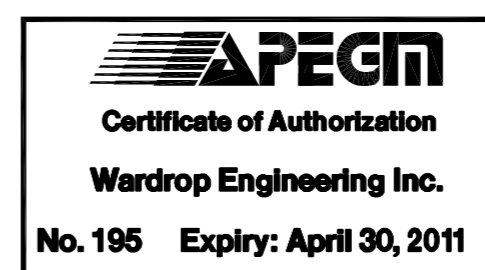

EXISTING	LEGEND-PLAN	PROPOSED	EXISTING	LEGEND-PLAN	PROPOSED	EXISTING	LEGEND-PLAN	PROPOSED
150 WM	WATERMAIN	150 WM	SWALE	TRAFFIC SIGNAL				
400 FM	FEEDERMAIN	400 FM	MANHOLE	GAS				
300 LDS	LAND DRAINAGE SEWER	300 LDS	CATCHBASIN	HYDRO				
250 WWS	WASTEWATER SEWER	250 WWS	HYDRO BOX	MTS				
300 CS	COMBINED SEWER	300 CS	HYDRO POLE	SPRINKLER				
200 FCM	FORCEMAIN	200 FCM	LIGHT STANDARD	ELEVATION				
	JUNCTIONS		ANCHOR	SIDEWALK				
	HYDRANT		TREE	CURB				
	VALVE		SURVEY BAR	ASPHALT				
	CURB STOP		SIGNAL CONTROLLER	CONCRETE				

LOCATION APPROVED UNDERGROUND STRUCTURES

SUPV. U/G STRUCTURES COMMITTEE DATE

NOTE: LOCATION OF UNDERGROUND STRUCTURES AS SHOWN ARE BASED ON THE BEST INFORMATION AVAILABLE. BUT NO GUARANTEE IS GIVEN THAT ALL EXISTING UTILITIES ARE SHOWN OR THAT THE GIVEN LOCATIONS ARE EXACT. CONFIRMATION OF EXISTENCE AND EXACT LOCATION OF ALL SERVICES MUST BE OBTAINED FROM THE INDIVIDUAL UTILITIES BEFORE PROCEEDING WITH CONSTRUCTION.

B.M. ELEV.	NO.	ISSUED FOR TENDER	DATE	BY
	00	ISSUED FOR TENDER	10.07.13	DAL
		NO. REVISIONS		

WARDROP		PEOPLE, PASSION, PERFORMANCE. TRUSTED GLOBALLY	
DESIGNED BY	TF	CHECKED BY	
DRAWN BY	NL	APPROVED BY	
HOR. SCALE:	1 : 500	RELEASED FOR CONSTRUCTION	
VERTICAL:	1 : 20		

PRELIMINARY DRAWING

NOT TO BE USED FOR CONSTRUCTION

CONSULTANT DRAWING NO. 1000070100-DWG-C1009-00

THE CITY OF WINNIPEG
PUBLIC WORKS DEPARTMENT
ENGINEERING DIVISION

2010 ACTIVE TRANSPORTATION / INFRASTRUCTURE STIMULUS PROGRAM

TRANSCONA TRAIL MULTI USE PATHWAY
160m WEST OF PLESSIS ROAD
TO PLESSIS ROAD

CITY DRAWING NUMBER: 9 OF 31
SHEET: 9 OF 31
C1009