

NOTES:

- CLEAN AND REGRADE EXISTING DITCH AS DIRECTED BY CONTRACT ADMINISTRATOR
- RENEW EXISTING APPROACHES AS DIRECTED BY CONTRACT ADMINISTRATOR
- MAINTAIN ACCESS TO EX. APPROACHES

CHAINAGE ALONG CENTER OF ROAD

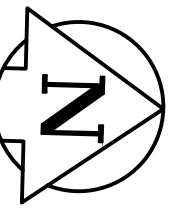

MURDOCK ROAD

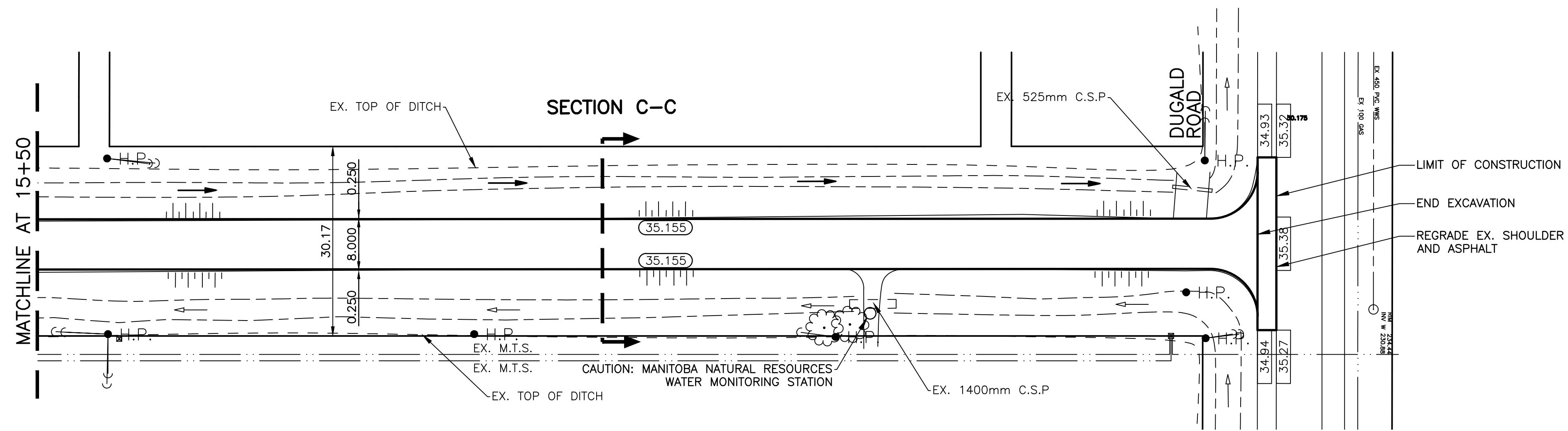

TYPICAL ROAD CROSS SECTION
N.T.S.

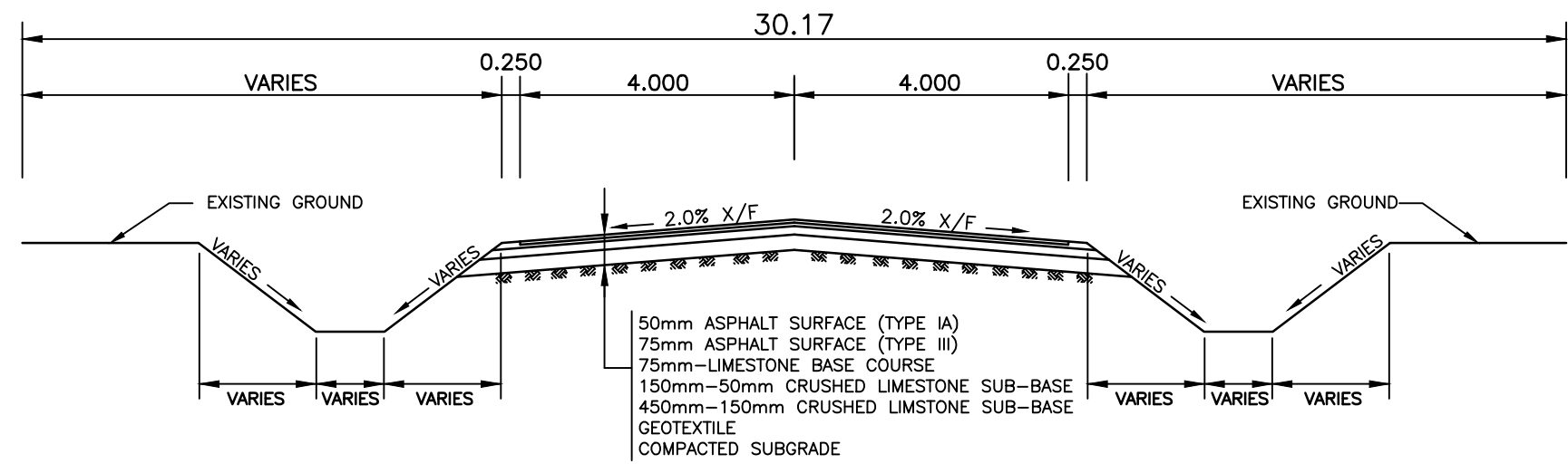

SECTION C-C
N.T.S.

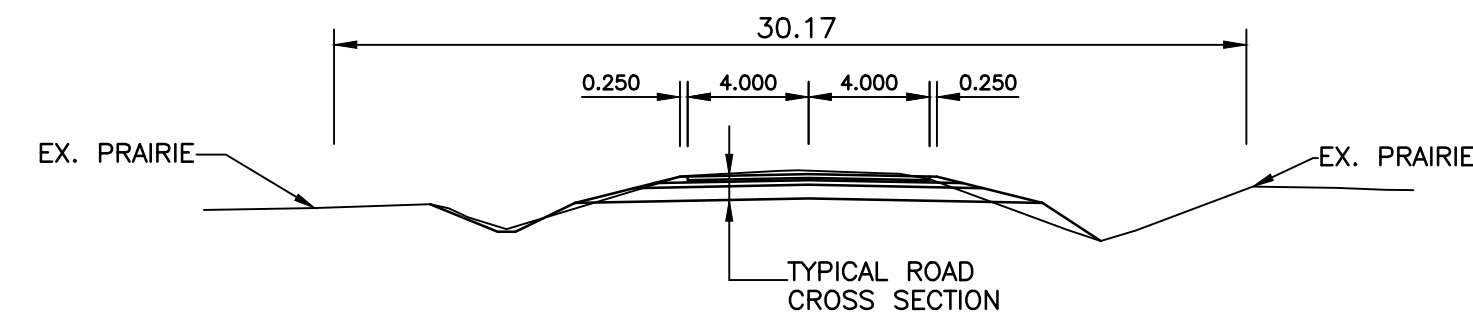

BENCHMARK:
N. SIDE COPELAND ST., E. OF MCFADDEN AVE., TBLT. IN E. CONC.
FOUNDATION 0.5m N. & 0.4m BELOW CEDAR SIDING OF S.E.
COR. NO. 1113 COPELAND ST., (TBLT. FACING DRIVEWAY).

METRIC
WHOLE NUMBERS INDICATE MILLIMETRES
DECIMALIZED NUMBERS INDICATE METRES



EXISTING	LEGEND - PLAN	PROPOSED	EXISTING	LEGEND - PLAN	PROPOSED	EXISTING	LEGEND - PROFILE	PROPOSED
	WATERMAIN			HYDRO			CENTER LINE	
	HYDRANT			M.T.S.			NORTH GUTTER LINE	
	VALVE			GRAVEL/CHIP SEAL			SOUTH GUTTER LINE	
	BOTTOM OF DITCH			ASPHALT			WEST DITCH	
	TOP OF DITCH			PROPERTY LINE			EAST DITCH	
	WASTE WATER SEWER			TESTHOLE				
	MANHOLE			ELEVATIONS				
	CATCH BASIN			CULVERT				
	CURB INLET			FLOW DIRECTION				
	TRAFFIC SIGNAL							
	GAS							

LOCATION APPROVED

SUPV. U/G STRUCTURES COMMITTEE DATE
NOTE:
LOCATION OF UNDERGROUND STRUCTURES AS SHOWN ARE BASED ON THE BEST INFORMATION AVAILABLE BUT NO GUARANTEE IS GIVEN THAT ALL EXISTING UTILITIES ARE SHOWN OR THAT THE GIVEN LOCATIONS ARE EXACT. CONFIRMATION OF EXISTENCE AND EXACT LOCATION OF ALL SERVICES MUST BE OBTAINED FROM THE INDIVIDUAL UTILITIES BEFORE PROCEEDING WITH CONSTRUCTION.

NO.	REVISIONS	DATE	BY
1	SUBMISSION DRAWING	06/10	R.H.

GENIVAR
10 PRAIRIE WAY WINNIPEG, MANITOBA R2J 3J8
PH: (204)-477-8650 FAX: (204)-474-2864

DESIGNED BY: R.H. CHECKED BY: S.M.
DRAWN BY: R.H. APPROVED BY: I.MCK.
HOR. SCALE: 1:500
VERT. SCALE: 1:50
RELEASED FOR CONSTRUCTION
DATE: JUNE 2010

ENGINEERS SEAL
I. G. MCKINNON
REGISTERED PROFESSIONAL ENGINEER
CONSULTANT DRAWING NO. 09-170-06

Winnipeg **THE CITY OF WINNIPEG**
PUBLIC WORKS DEPARTMENT

2010 GRANULAR ROAD RENEWALS
MURDOCK ROAD
FROM MATCHLINE AT STATION 15+50 TO DUGALD ROAD

CITY DRAWING NO. SHEET 6 OF 6
559-2010