

# PEMBINA HIGHWAY

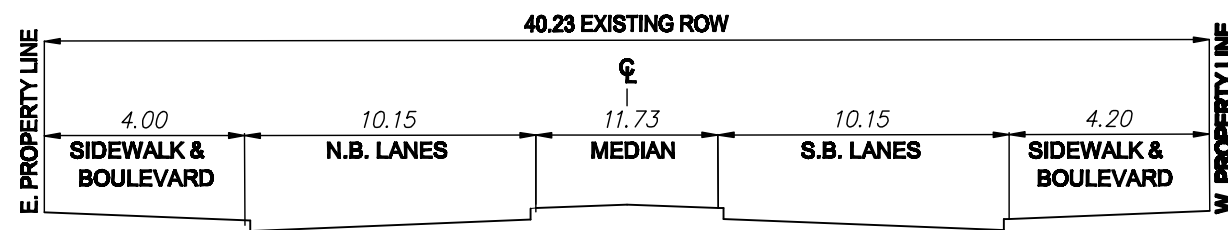
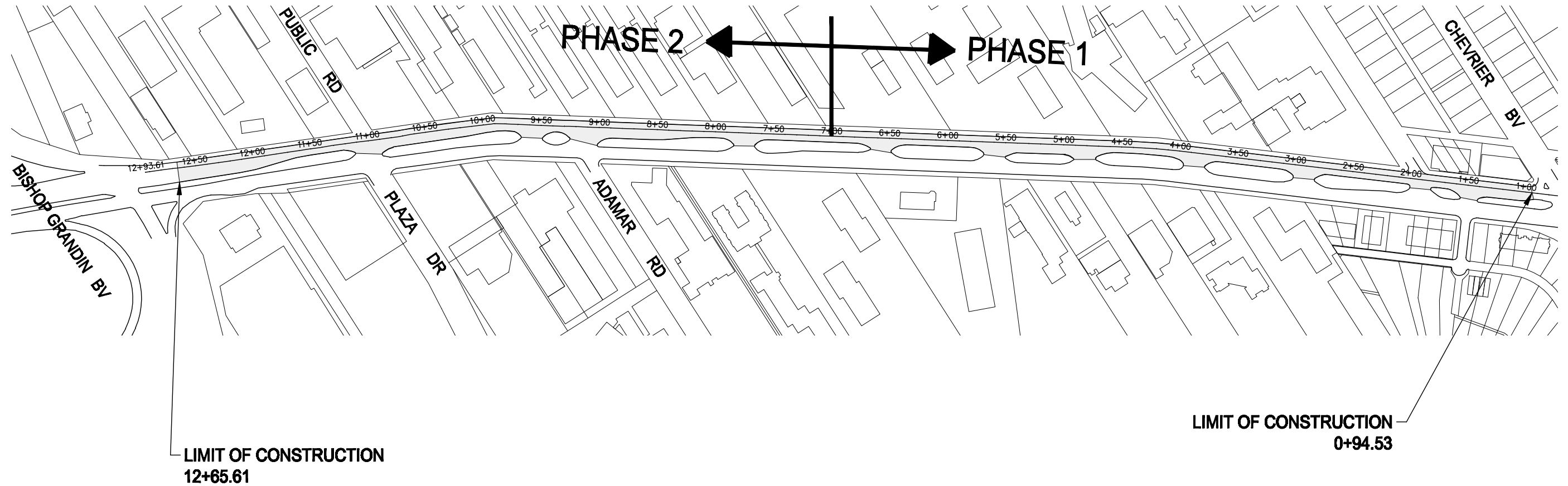

**TYPICAL CROSS-SECTION**  
SCALE: NTS

**SCOPE OF WORK:**

- MISCELLANEOUS CURB RENEWALS
- MISCELLANEOUS SLAB RENEWALS
- MILL EXISTING ASPHALT AT TIE-IN LOCATIONS
- PLACE ASPHALT OVERLAY ON EXISTING CONCRETE PAVEMENT

Feb 23, 2010 - 4:21pm  
P:\5509119-5509196\5509119-000 Mill and Fill-Pembina Hwy. and Main Street\MMM DWGS\5509119-SK002-PEMBINA\FEB23-2010.dwg -tab:SK-002

NOTE:  
These design documents are prepared solely for the use by the party with whom the design professional has entered into a contract and there are no representations of any kind made by the design professional to any party with whom the design professional has not entered into a contract.



MMM Group Limited  
Suite 111 - 93 Lombard Ave.  
Winnipeg, MB R3B 3B1  
t. 204.943.3178  
f. 204.943.4948  
www.mmm.ca

CITY OF WINNIPEG  
2010 REGIONAL STREETS MINOR ASPHALT REHABILITATION  
PEMBINA HIGHWAY - WEST BOUND  
CHEVRIER BLVD. TO BISHOP GRANDIN BLVD.

SCALE: NTS

DATE: JAN. 18/10

DWG. No. 5509119-SK002