

TYPICAL CULVERT X-SECTION D-D

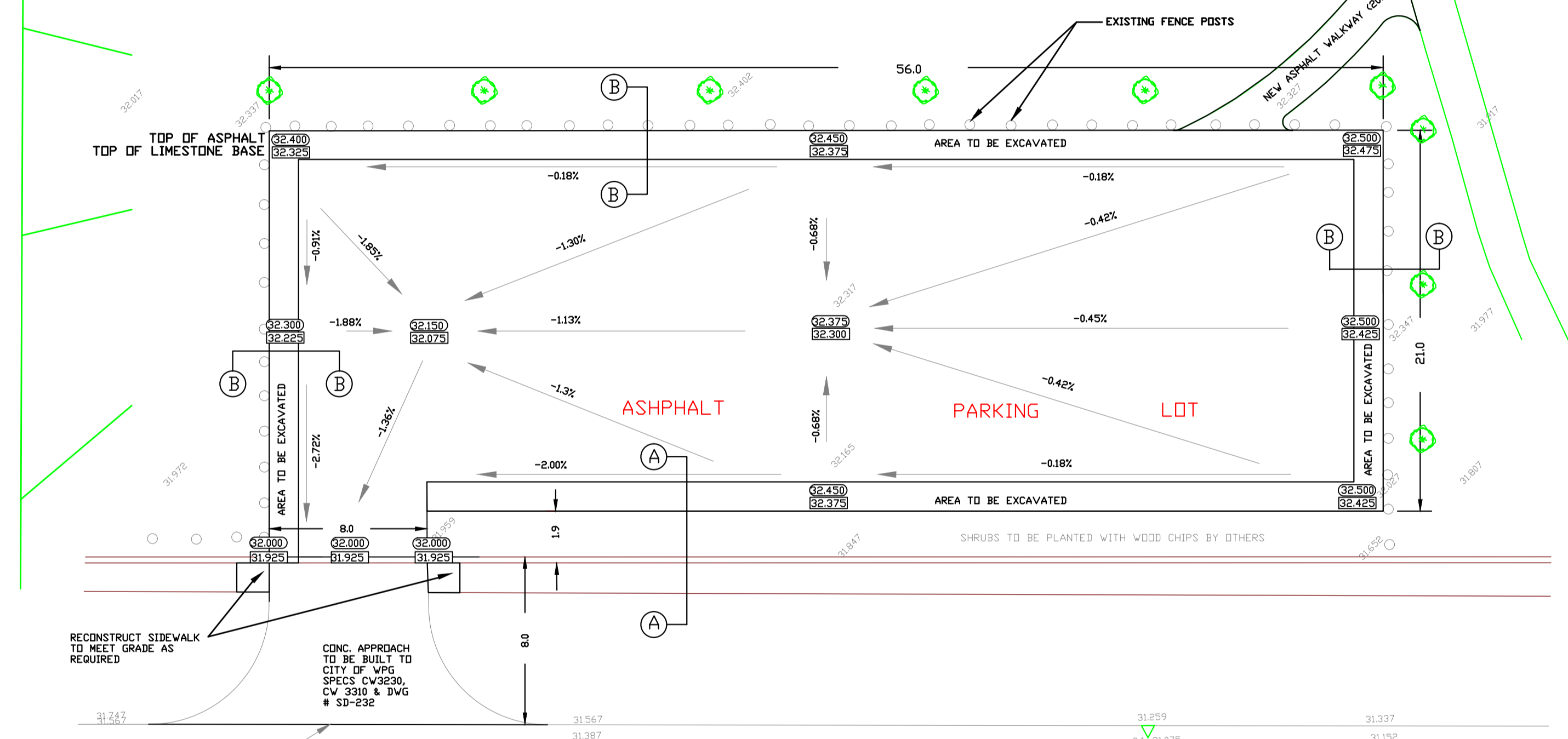

DETAIL 1 PARKING LOT AND CONCRETE APPROACH

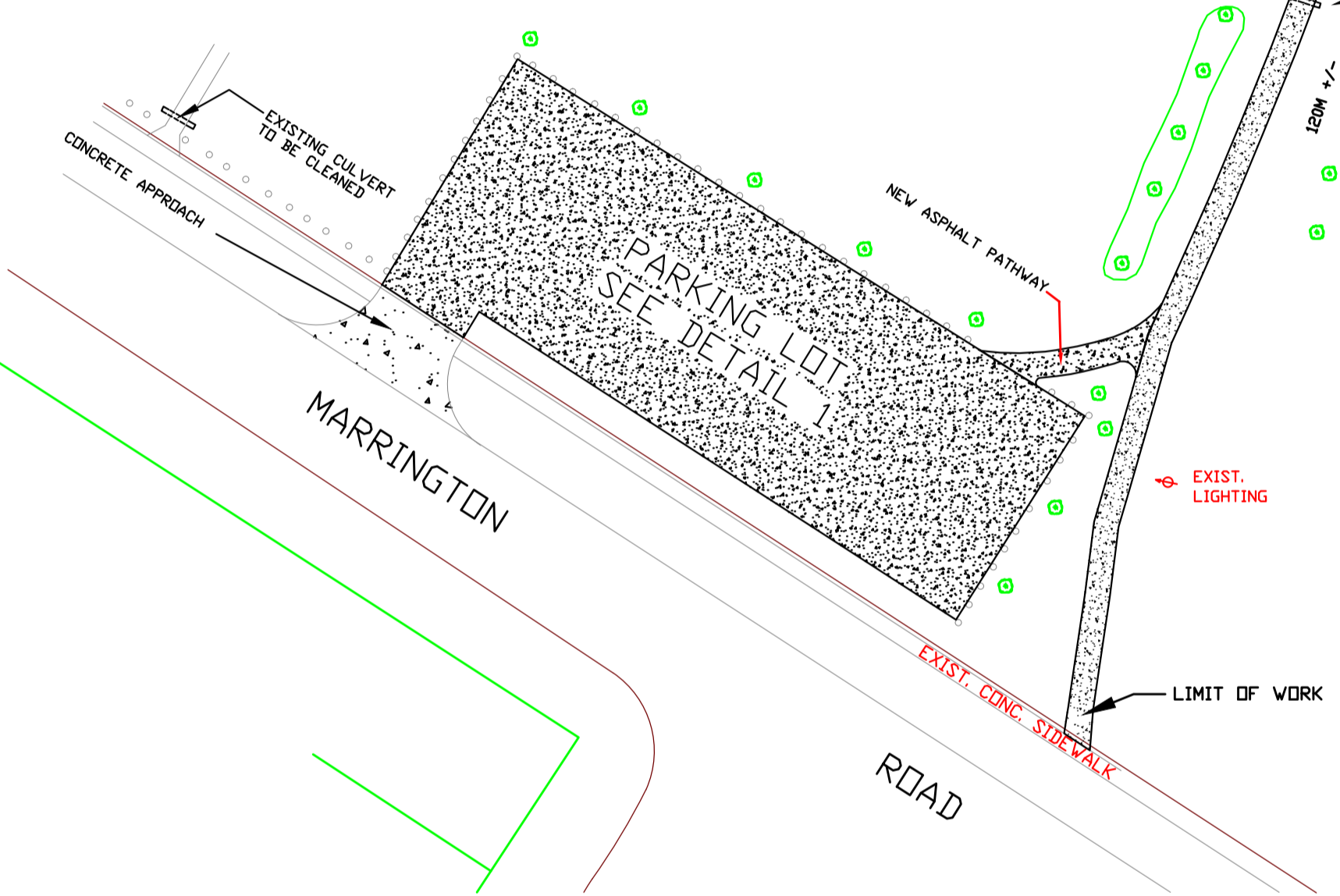
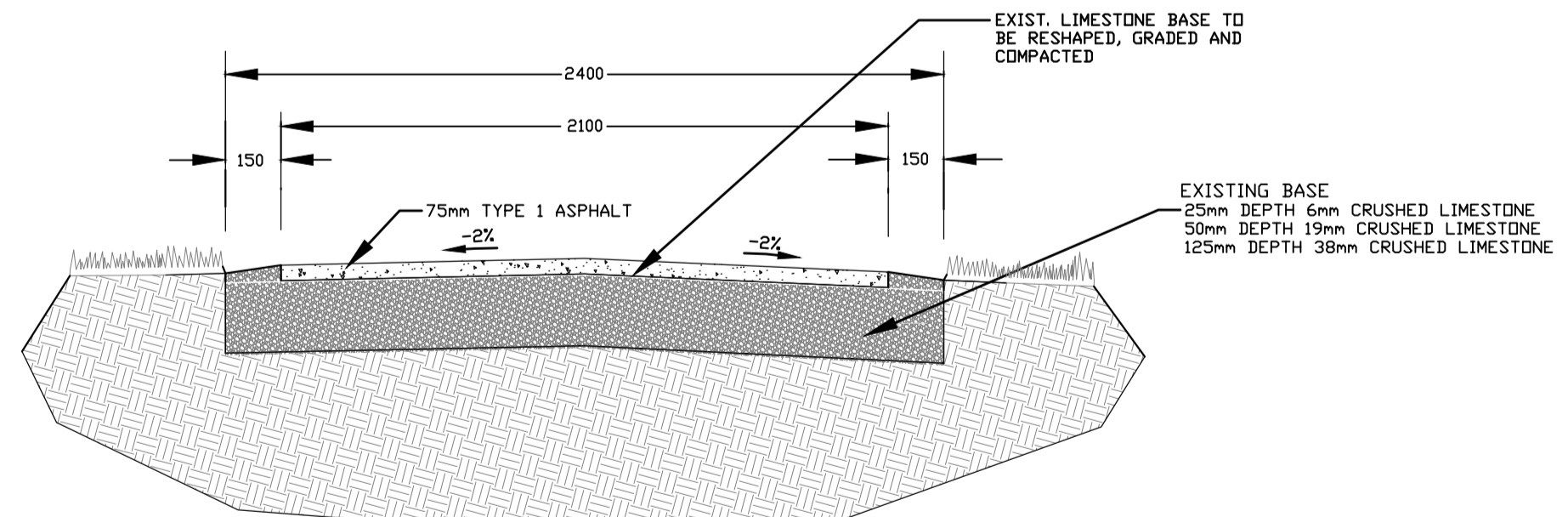

TYPICAL PATHWAY X-SECTION C-C

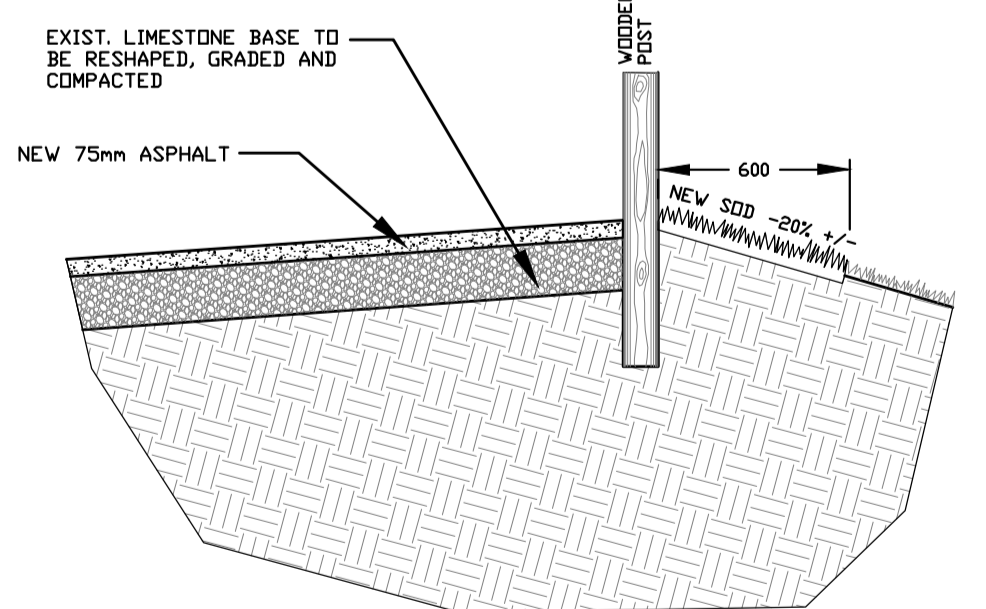

TYPICAL X-SECTION B-B

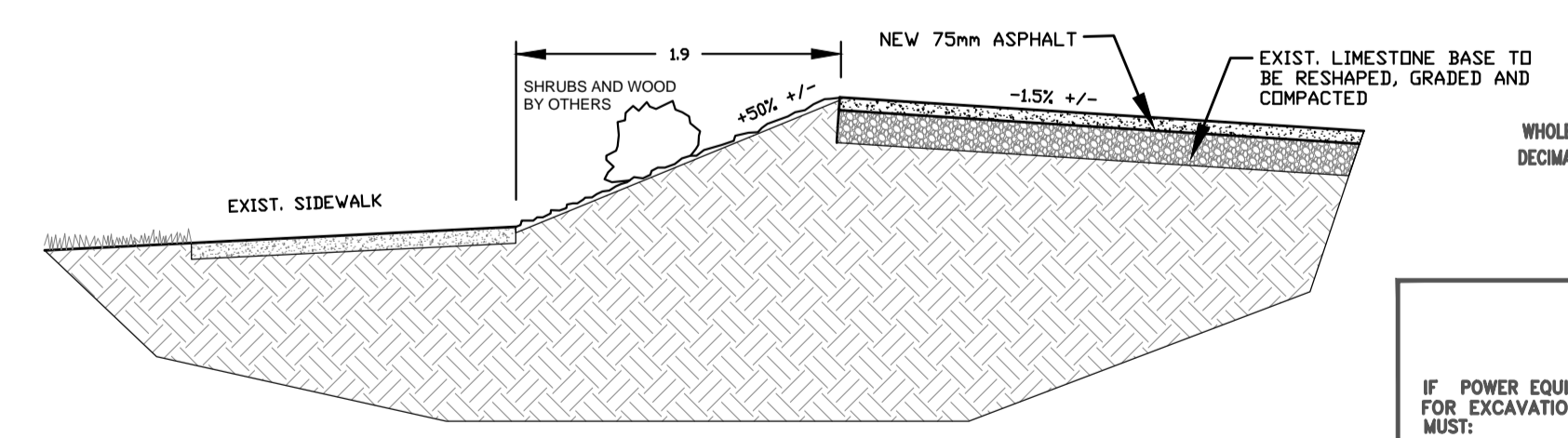

TYPICAL X-SECTION A-A

METRIC
WHOLE NUMBERS INDICATE MILLIMETRES
DECIMAL NUMBERS INDICATE METRES

WARNING
IF POWER EQUIPMENT OR EXPLOSIVES ARE TO BE USED FOR EXCAVATION ON THIS PROJECT THE CONTRACTOR MUST:
1) NOTIFY THE GAS COMPANY OF THE PROPOSED LOCATION OF EXCAVATION.
2) TAKE PRECAUTION TO AVOID DAMAGE TO GAS COMPANY INSTALLATIONS.
SEE PROVINCIAL REGULATION 210/72 FOR DETAILS

200 WM	WATERMAIN	200 WM	---	SL, HYDRO	---	150 WM	WATERMAIN	150 WM	---	LOCATION APPROVED	B.M. ELEV.	FIELD BOOK #	CITY OF WINNIPEG PARKS, RIVER BANKS & COMMUNITY INITIATIVES	LANDSCAPE ARCHITECT'S/ ENGINEER'S SEAL	THE CITY OF WINNIPEG Planning, Property and Development Dept. Parks, Riverbanks and Community Initiatives Unit 15-30 Fort Street	SHEET 1 OF 1 CITY DRAWING NUMBER K.5-M
○	HYDRANT	⬆	---	MTS	---	---	HYDRANT	+	---	UNDERGROUND STRUCTURES						
⊗	VALVE	⬆	---	TRAFFIC SIGNALS	---	---	VALVE	+	---			DRAWN BY: TB	APPROVED BY: RZ	RELEASED FOR CONSTRUCTION		
525 LBS	LAND DRAINAGE SEWER	525 LBS	---	GAS	---	---	GAS	---	---			HDR. SCALE: 1:500				
375 WWS	WASTEWATER SEWER	375 WWS	---	SURVEY BAR	---	---	WASTEWATER SEWER	---	---			VERTICAL				
○	MANHOLE	○	---	FENCE	---	---	TOP OF ASPHALT	---	---							
□	CATCH BASIN	□	---	POLE - HYDRO, MTS	---	---	TOP OF LIMESTONE BASE	---	---							
▽	CURB INLET	▽	---	CURB STOP	---	---	? DITCH (NORTH & WEST)	---	---							
◁	REDUCER	◁	---	GUY ANCHOR	---	---	? DITCH (SOUTH & EAST)	---	---							
×	COUPLER	×	---	LIGHT STANDARD	---	---	GUTTER (NORTH & WEST)	---	---							
⊕	ANODE	⊕	---	TREE	---	---	GUTTER (SOUTH & EAST)	---	---							
EXISTING	LEGEND-PLAN	PROPOSED	---	LEGEND-PLAN	---	PROPOSED	LEGEND-PROFILE	---	PROPOSED							

NOTE: LOCATION OF UNDERGROUND STRUCTURES AS SHOWN ARE BASED ON THE BEST INFORMATION AVAILABLE BUT NO GUARANTEE IS GIVEN THAT ALL EXISTING UTILITIES ARE SHOWN OR THAT THE GIVEN LOCATIONS ARE EXACT. CONFIRMATION OF EXISTENCE AND EXACT LOCATION OF ALL SERVICES MUST BE OBTAINED FROM THE INDIVIDUAL UTILITIES BEFORE PROCEEDING WITH CONSTRUCTION.

NO.	REVISIONS	DATE	BY	DATE	JULY 20, 2010
-----	-----------	------	----	------	---------------