

**NOTES**

PILE FLIGHTS TO HAVE A TOTAL AREA OF 0.125 m<sup>2</sup>

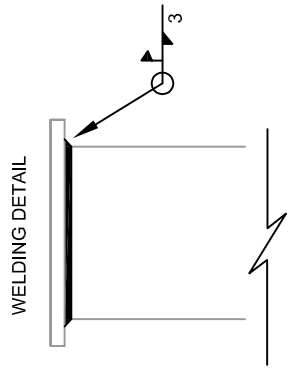
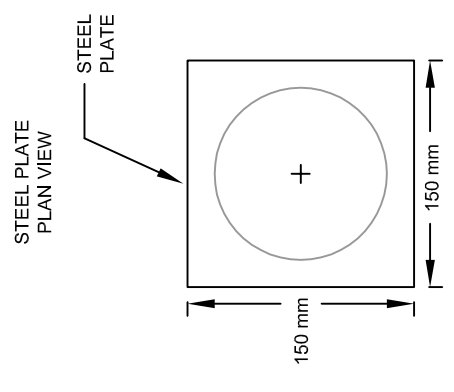
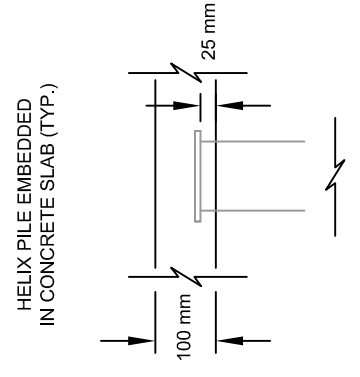
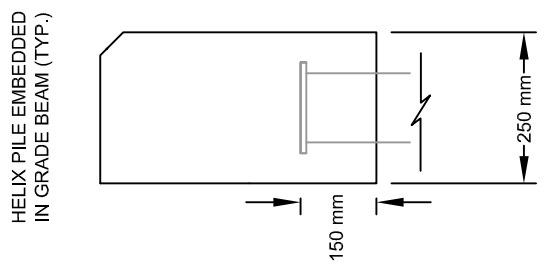
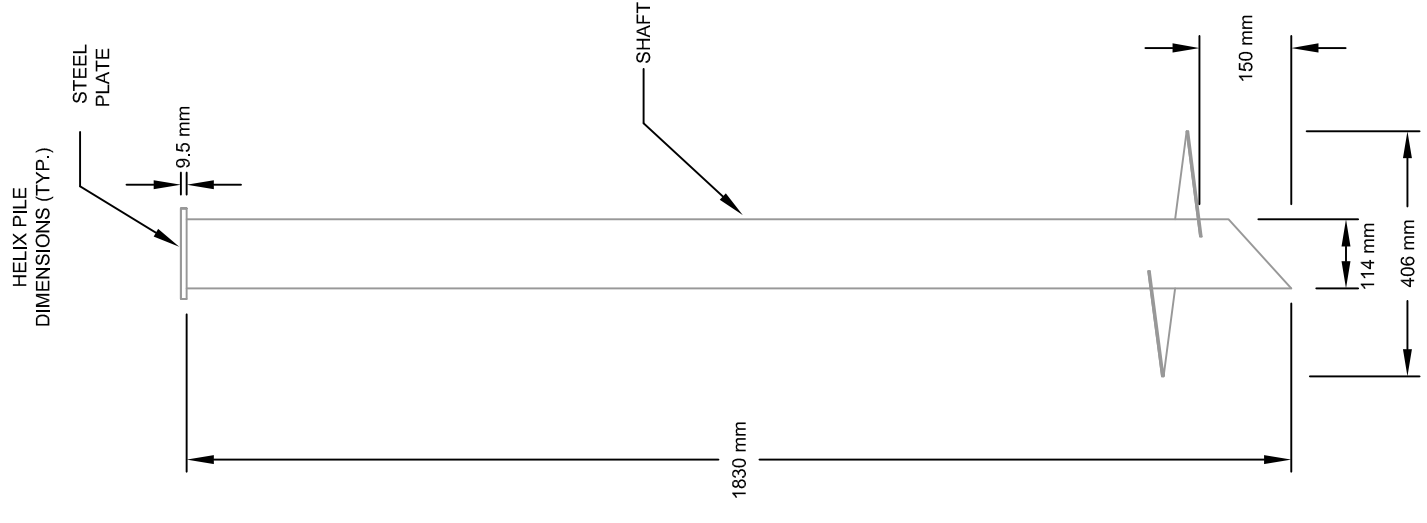

CLIENT: KEN RECH LANDSCAPE ARCHITECTS INC.  
PROJECT: RIVERBANK ASSESSMENT, BOURKEVALE C.C. RIVER ACCESS/ CANOE LAUNCH, WINNIPEG, MB

DWG DESCRIPTION: HELIX PILE DETAILS

SCALE: NOT TO SCALE

DRAWN BY: ERM DATE: AUGUST 2010

FILE No.: 10-432-01 CLIENT DWG/FIG. No.:

ENG-TECH DWG/FIG. No.: G-6 REV.: R-0

#6 - 854 Marion Street  
Winnipeg, MB R2J 0K4  
Phone: (204) 233-1694  
Fax: (204) 235-1579

