

- ** Contractor to Supply and Install 21 Bollards to Replace Existing Bollards (Contract Administrator to Identify on Site)
- Excavate and legally dispose of old safety surfacing (7 CM)
- Supply and Install Soil & Sod (160 SM)
- Grass Field
- Supply and Install Granular Path (127 SM)
- Supply and Install Benches (x2)
- Supply and Install Shade Trees (By Others)
- Prepare Shrub Bed (5 SM)
- Supply and Install Granular Pad (28 SM)
- Supply and Install Accessible Picnic Table w/ DuckBill Anchors

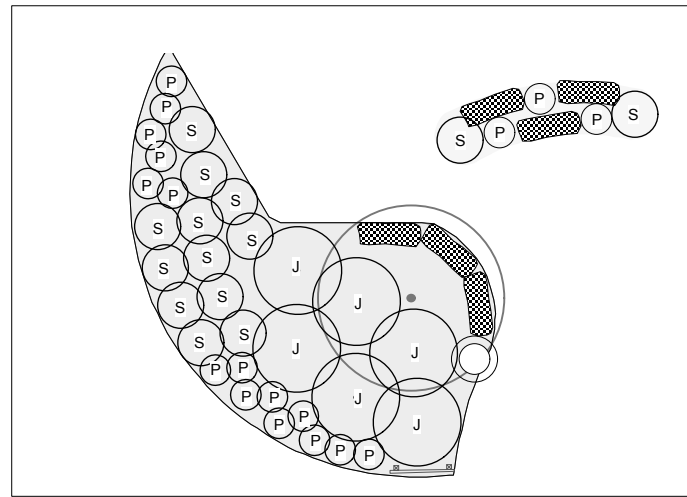

ID	Quant	Botanical Name	Project Plant Name	Type	Ht	Spr	Size	Spacing
J	6	Juniperus sabina 'Arcadia'	Arcadia Juniper	shrub	0.6	1.8	2 gal	1.5m o.c.
P	18	Potentilla fruticosa 'Mango Tango'	Mango Tango Potentilla	shrub	0.6	0.6	2 gal	0.5m o.c.
S	14	Salix brachycarpa 'Blue Fox'	Blue Fox Willow	shrub	0.9	0.9	2 gal	0.8m o.c.

PLANTING PLAN
1:150

CONTRACTOR TO CONFIRM ALL DIMENSIONS AND REPORT ANY DISCREPANCIES TO CONTRACT ADMINISTRATOR PRIOR TO CONSTRUCTION. LOCATION OF UNDERGROUND STRUCTURES AS SHOWN ARE BASED ON THE BEST INFORMATION AVAILABLE BUT NO GUARANTEE IS GIVEN THAT ALL EXISTING UTILITIES ARE SHOWN OR THAT THE GIVEN LOCATIONS ARE EXACT. CONFIRMATION OF EXISTENCE AND EXACT LOCATION OF ALL SERVICES MUST BE OBTAINED FROM THE INDIVIDUAL UTILITIES BEFORE PROCEEDING WITH CONSTRUCTION.



THE CITY OF WINNIPEG
Planning, Property and Development Department
Planning and Land Use Division
Unit 15 - 30 Fort Street, Winnipeg, MB, (R3C 4X5)

DESIGNED BY	IL	CHECKED BY	
DRAWN BY	IL	APPROVED BY	
HORIZ. SCALE			
VERT. SCALE	1:200		
DATE	June 10		

MANAGER, PARK AND OPEN SPACES	DATE
MANAGER, PLANNING AND LAND USE DIVISION	DATE

DRAWING TITLE
HELEN PROMISLOW PLAYGROUND
Playground Redevelopment
Proposed Site Works

SITE ADDRESS 295 Kingsbury Ave

DRAWING NO.
H.57-A
BID OPPORTUNITY NO.
693-2010