

SUMMERSIDE AVENUE

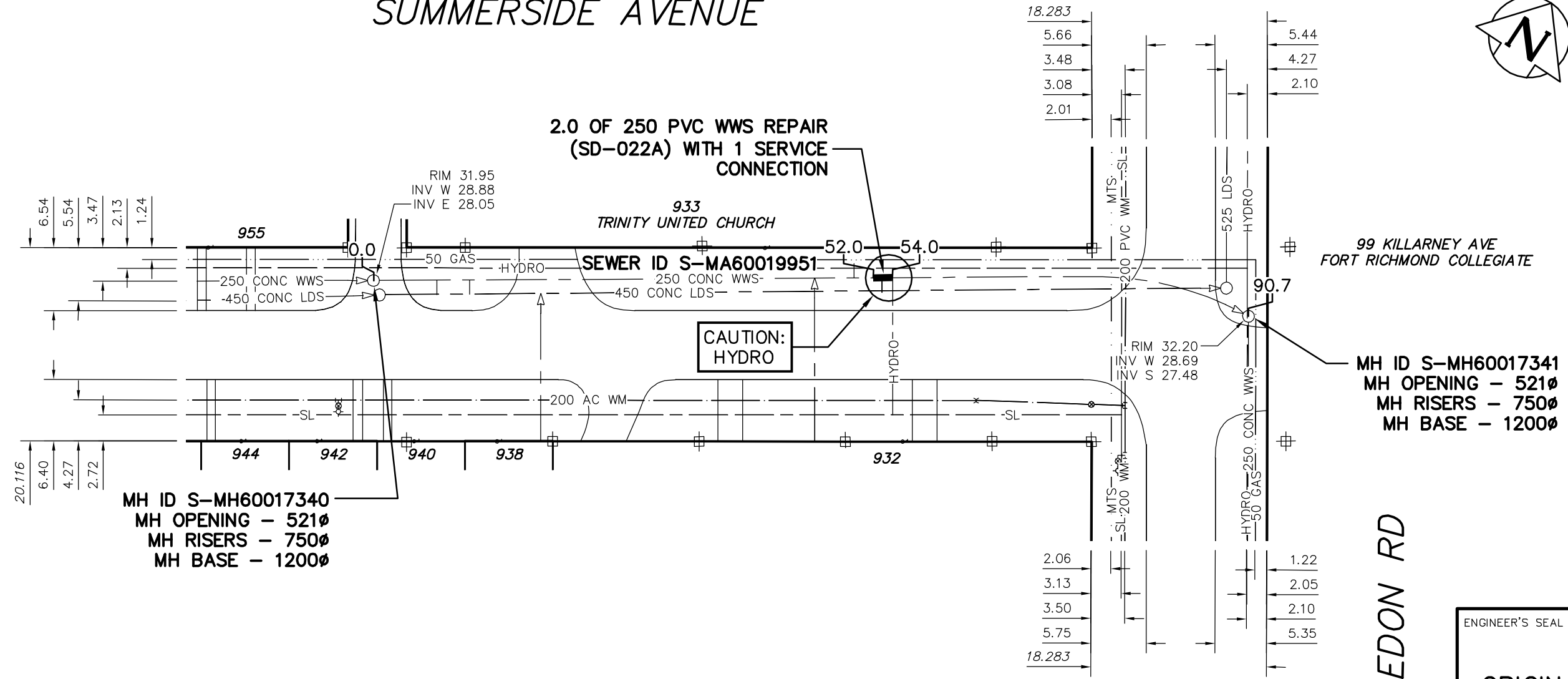

MH ID S-MH60017340
 MH OPENING - 521Ø
 MH RISERS - 750Ø
 MH BASE - 1200Ø

MH ID S-MH60017341
 MH OPENING - 521Ø
 MH RISERS - 750Ø
 MH BASE - 1200Ø

SEWER JUNCTION INFORMATION FROM SEWER VIDEO INSPECTION SEWER ID S-MA60019951				
DISTANCE FROM MH ID S-MH60017272				
52.9	E	150Ø	SOUTH	CN

ENGINEER'S SEAL

ORIGINAL SIGNED BY
 S.R.J. COURNOYER
 10/10/21

BID OPPORTUNITY: 790-2010
 FILENAME : 9427.dwg
 PLOT DATE : 2010 10 21

LEGEND:
 52.0 | MEASUREMENT TO REPAIR FROM REFERENCE MH SHOWN THUS... 0.0

METRIC
 WHOLE NUMBERS INDICATE MILLIMETRES
 DECIMALIZED NUMBERS INDICATE METRES

B.M. ELEV.	FIELD BOOK #:	CITY OF WINNIPEG WATER AND WASTE ENGINEERING DIVISION		THE CITY OF WINNIPEG WATER AND WASTE DEPARTMENT		
POSTED TO LBIS		DESIGNED BY: SC	CHECKED BY: SC	2010 WASTEWATER SEWER RENEWALS AND REPAIRS, CONTRACT 15 SUMMERSIDE AVENUE 1ST MH W OF CALEDON ROAD TO MH AT CALEDON ROAD		
		DRAWN BY: CJH	APPROVED BY: KZ			SHEET 12 OF 16
		HOR. SCALE: 1:500	RELEASED FOR CONSTRUCTION			CITY DRAWING NUMBER: 9427
NO.	REVISIONS	DATE	BY	DATE: 2010 10 20		