

FERMOR AVENUE

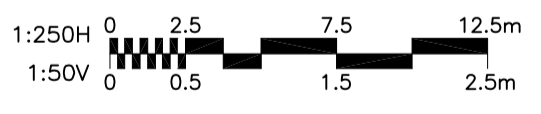
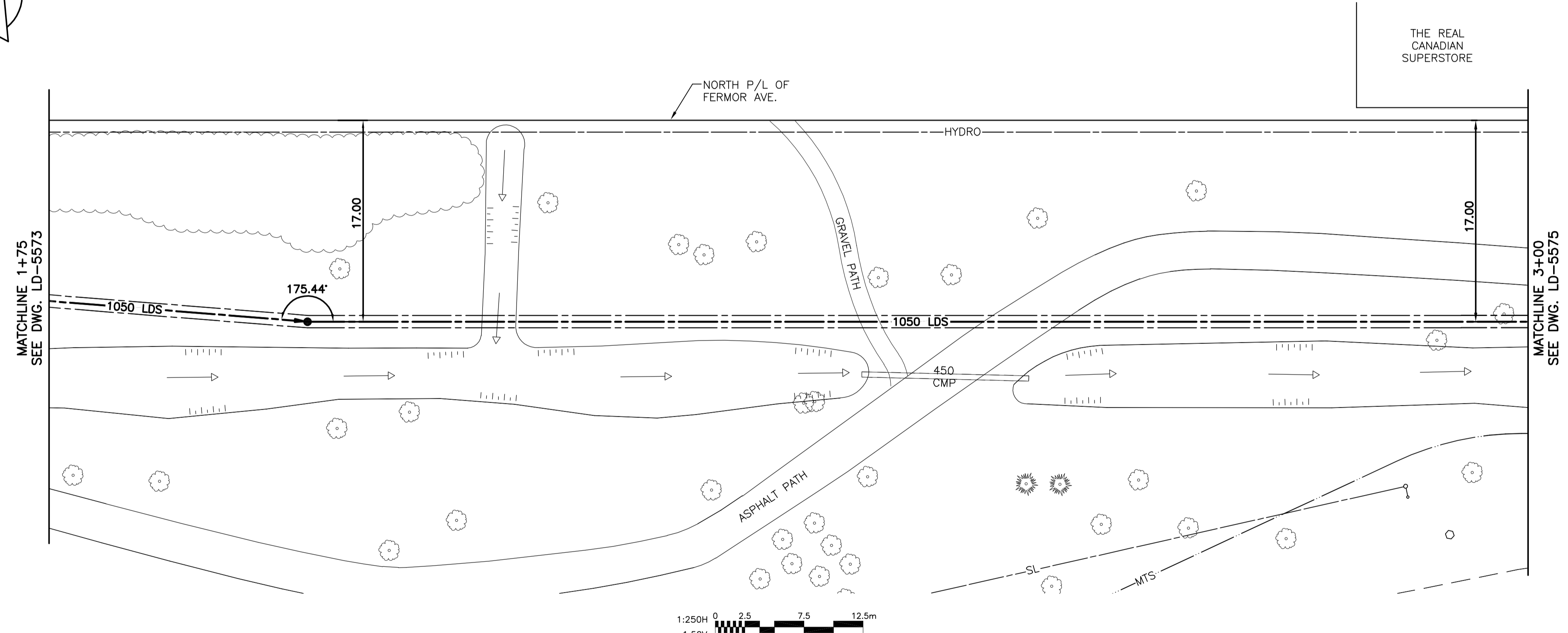

- CONSTRUCTION NOTES:**
1. ALL NEW SEWERS AND SEWER SERVICES TO BE INSTALLED BY TRENCHLESS METHODS UNLESS OTHERWISE NOTED.
 2. EXCAVATIONS WITHIN 1.0m OF PAVEMENT OR GRAVEL PATHWAYS TO BE BACKFILLED WITH CLASS 3 MATERIAL.
 3. CONTRACTOR TO COORDINATE WITH CONTRACT ADMINISTRATOR PRIOR TO THE REMOVAL OF ANY EXISTING TREES. ONLY MARKED TREES MAY BE REMOVED. CONTRACTOR TO PROTECT ANY EX. TREES AS REQUIRED.
 4. CONTRACTOR TO MAINTAIN DRAINAGE IN EX. DITCH DURING THE DURATION OF THE CONSTRUCTION.
 5. EX. DITCHES AND RIVERBANK TO BE RESTORED USING SPECIFIED SEEDMIX.
 6. PREVENT EXCAVATED MATERIAL FROM ENTERING OUTFALL PIPE AND ENTERING RIVER.

WARNING

IF POWER EQUIPMENT OR EXPLOSIVES ARE TO BE USED FOR EXCAVATION ON THIS PROJECT THE CONTRACTOR MUST:
 1) NOTIFY THE GAS COMPANY OF THE PROPOSED LOCATION OF EXCAVATION.
 2) TAKE PRECAUTION TO AVOID DAMAGE TO GAS COMPANY INSTALLATIONS.
 SEE PROVINCIAL REGULATION 140/92 FOR DETAILS

METRIC

WHOLE NUMBERS INDICATE MILLIMETRES
 DECIMALIZED NUMBERS INDICATE METRES

NOTE:
 STATIONING IS ALONG N P

BENCH MARK: S.W. Cor. St. Mary's Rd. & Glenview Ave., Tblt. in 7.6 m Conc. pile, 6 m N. of S.L. of Glenview Ave. & 0.6 m W. of W.L. of St. Mary's Rd.

BID OPPORTUNITY NO. 886-2010

APEGM
 Certificate of Authorization
 Stantec Consulting Ltd.
 No. 1301 Date: _____

150 WM		150 WM		HYDRO		150 WM		150 WM		LOCATION APPROVED UNDERGROUND STRUCTURES	
+	HYDRANT	+	HYDRANT	---	M.T.S.	+	HYDRANT, VALVE	+	HYDRANT, VALVE		
+	VALVE	+	VALVE	---	CONCRETE	---	CONCRETE	---	CONCRETE		
---	LAND DRAINAGE SEWER	---	LAND DRAINAGE SEWER	---	ASPHALT	---	LAND DRAINAGE SEWER	---	LAND DRAINAGE SEWER		
---	WASTE WATER SEWER	---	WASTE WATER SEWER	---	SIDEWALK	---	WASTE WATER SEWER	---	WASTE WATER SEWER		
○	MANHOLE	○	MANHOLE	---	PROPERTY LINE	○	WASTE WATER SEWER	○	WASTE WATER SEWER		
□	CATCH BASIN	□	CATCH BASIN	---	SURVEY BAR	○	WASTE WATER SEWER	○	WASTE WATER SEWER		
▽	CURB INLET	▽	CURB INLET	---	DITCH	○	WASTE WATER SEWER	○	WASTE WATER SEWER		
---	JUNCTIONS	---	JUNCTIONS	---	ELEVATION	○	WASTE WATER SEWER	○	WASTE WATER SEWER		
---	CULVERT	---	CULVERT	---		○	WASTE WATER SEWER	○	WASTE WATER SEWER		
---	GAS	---	GAS	---		○	WASTE WATER SEWER	○	WASTE WATER SEWER		
---	LEGEND-PLAN	---	LEGEND-PLAN	---	LEGEND-PLAN	○	WASTE WATER SEWER	○	WASTE WATER SEWER		
---	PROPOSED	---	PROPOSED	---	PROPOSED	○	WASTE WATER SEWER	○	WASTE WATER SEWER		
---	EXISTING	---	EXISTING	---	EXISTING	○	WASTE WATER SEWER	○	WASTE WATER SEWER		
---	LEGEND-PROFILE	---	LEGEND-PROFILE	---	LEGEND-PROFILE	○	WASTE WATER SEWER	○	WASTE WATER SEWER		
---	PROPOSED	---	PROPOSED	---	PROPOSED	○	WASTE WATER SEWER	○	WASTE WATER SEWER		
---	EXISTING	---	EXISTING	---	EXISTING	○	WASTE WATER SEWER	○	WASTE WATER SEWER		

NO.	REVISIONS	DATE	BY

Stantec Consulting Ltd.
 905 Waverley Street, Winnipeg, Manitoba
 Tel 204-489-5900 Fax 204-453-9012

DESIGNED BY: J.C. CHECKED BY: H.K.
 DRAWN BY: D.M.L. APPROVED BY: L.C.
 HOR. SCALE: 1:250
 VERTICAL: 1:50
 RELEASED FOR CONSTRUCTION: _____
 DATE: 2010.07.26

ENGINEER'S SEAL
 CONSULTANT DRAWING NO. C-238

THE CITY OF WINNIPEG
 WATER AND WASTE DEPARTMENT
 ENGINEERING DIVISION

FERMOR AVENUE
 21.8 W OF 1ST MH E OF ST. ANNE'S RD TO
 103.2 E OF 1ST MH E OF ST. ANNE'S RD

MAGER COMBINED SEWER DISTRICT SEWER SEPARATION
 CONTRACT NO. 3

SHEET 6 OF 12
 CAD FILE DRAWING NUMBER 11890c-237-712.dwg
 CITY DRAWING NUMBER LD-5574

W:\1121\p000\11211890\Drawings\W2_design\p000_31\p000_31.dwg 11890c-237-712.dwg
 2010-10-08 01:25:04 By: dclark