

B SIZE 11" x 17" (279mm x 432mm)

PLOT: 2/8/2011 7:30:47 PM

FILE NAME: 60164626-01-C-118-R0X.dwg Saved By: betardk

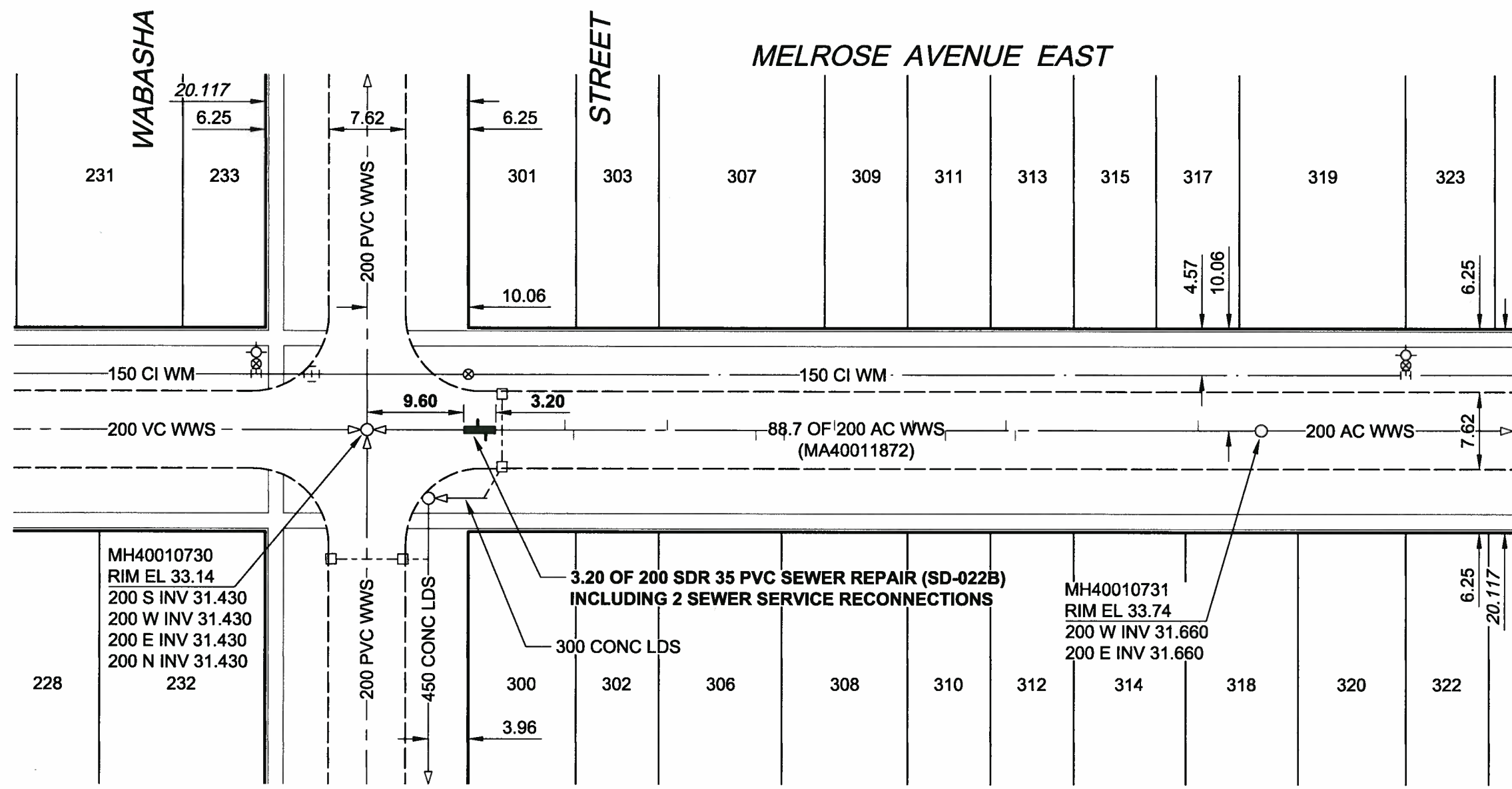

SEWER JUNCTION INFORMATION

REF. MH*	DIST FROM* REF. MH	SIZE*	CLOCK AT*
MH40010731	6.20	100Ø	03
MH40010731	24.40	100Ø	09
MH40010731	25.30	100Ø	03
MH40010731	31.30	100Ø	10
MH40010731	34.50	100Ø	03
MH40010731	42.30	100Ø	03
MH40010731	47.30	100Ø	10
MH40010731	50.10	100Ø	09
MH40010731	58.90	100Ø	03
MH40010731	68.20	100Ø	09
MH40010731	69.10	100Ø	02
MH40010730	11.00	100Ø	09
MH40010730	11.80	100Ø	03
MH40010730	19.60	100Ø	10

*JUNCTION INFORMATION FROM VIDEO INSPECTION

CONSTRUCTION NOTES:

1. CONTRACTOR TO VERIFY LIMITS OF SEWER REPAIRS PRIOR TO EXCAVATION BY MEANS OF VIDEO INSPECTION.
2. CONTRACTOR TO PROVIDE VIDEO INSPECTION OF SEWER SERVICES WITHIN LIMITS OF REPAIR IN PRESENCE OF CONTRACT ADMINISTRATOR TO DETERMINE IF SERVICE RENEWAL IS REQUIRED.
3. ALL BACKFILL TO BE CLASS 5 BACKFILL UNDER BOULEVARDS AND CLASS 3 UNDER OR WITHIN 1.0m OF PAVEMENT AND SIDEWALKS.

BENCH MARK:
 87R463 - S. side Pandora Ave. E. @ Wabasha St.,
 Tilt on top of 0.05 m sq. x 2.4 m iron tube, 10.2 m
 W. of W. wall No. 301 Pandora Ave. E. & 8.3 m S. of
 C.L. Conc. Pav't on Pandora Ave. E. or 23.2 m S. of
 N.L. Pandora Ave. E. & 10 m W. of E.L. Wabasha St.

METRIC
 WHOLE NUMBERS INDICATE MILLIMETRES
 DECIMALIZED NUMBERS INDICATE METRES

AECOM
 Certificate of Authorization
 AECOM Canada Ltd.
 No. 4671 Date: 11/02/10

BID OPPORTUNITY NO. 901-2010

LOCATION APPROVED UNDERGROUND STRUCTURES		BM 30-035 ELEV 233.496m	
SUPR. U/G STRUCTURES	DATE		
NOTE: LOCATION OF UNDERGROUND STRUCTURES AS SHOWN ARE BASED ON THE BEST INFORMATION AVAILABLE. BUT NO GUARANTEE IS GIVEN THAT ALL EXISTING UTILITIES ARE SHOWN OR THAT THE GIVEN LOCATIONS ARE EXACT. CONFIRMATION OF EXISTENCE AND EXACT LOCATION OF ALL SERVICES MUST BE OBTAINED FROM THE INDIVIDUAL UTILITIES BEFORE PROCEEDING WITH CONSTRUCTION.			
0	ISSUED FOR CONSTRUCTION	11/02/09	KMB
NO.	REVISIONS	YYMM/DD	BY

This drawing has been prepared for the use of AECOM's client and may not be used, reproduced or relied upon by third parties, except as agreed by AECOM and its client, as required by law or for use by governmental reviewing agencies. AECOM accepts no responsibility, and denies any liability whatsoever, to any party that modifies this drawing without AECOM's express written consent. Do not scale this document. All measurements must be obtained from stated dimensions.

DESIGNED BY	ALD	CHECKED BY	PL
DRAWN BY	KMB	APPROVED BY	<i>[Signature]</i>
HOR. SCALE	1:500	RELEASED FOR CONSTRUCTION	<i>[Signature]</i>
VERT. SCALE	N/A	DATE	11/02/10

PROFESSIONAL'S SEAL
 PROVINCE OF MANITOBA
 K.W.
FITCHETT
 REGISTERED PROFESSIONAL ENGINEER
 CONSULTANT DRAWING NO.
 60164626-01-C-118-R0X.dwg

THE CITY OF WINNIPEG
WATER AND WASTE DEPARTMENT
 2010 WASTEWATER SEWER RENEWALS AND REPAIRS CONTRACT 16
 MELROSE AVENUE EAST
 WABASHA STREET
 TO 39m W OF ROANOKE STREET

SHEET 18 OF 45
 CITY DRAWING NUMBER
9450 REV 0