

B SIZE 11" x 17" (279mm x 432mm)

PLOT: 2/8/2011 7:32:23 PM

FILE NAME: 60164626-01-C-120-R0X.dwg Saved By: betardik

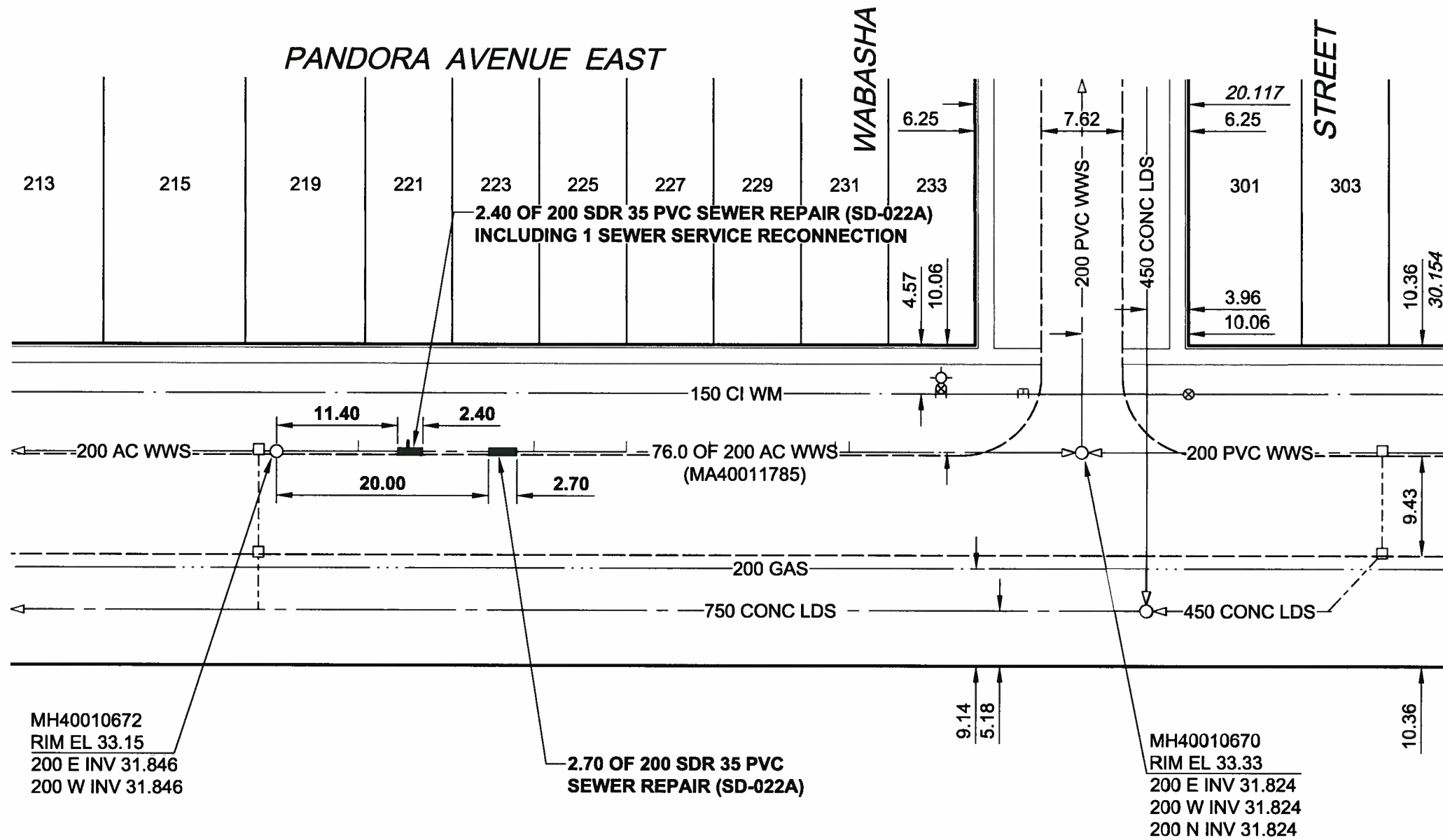

SEWER JUNCTION INFORMATION

REF. MH*	DIST FROM* REF. MH	SIZE*	CLOCK AT*
MH40010672	7.70	1000	09
MH40010672	12.40	1000	09
MH40010670	22.00	1000	03
MH40010670	23.30	1000	03
MH40010670	35.10	1000	03
MH40010670	43.00	1000	03
MH40010670	51.70	1000	03

*JUNCTION INFORMATION FROM VIDEO INSPECTION

- CONSTRUCTION NOTES:**
1. CONTRACTOR TO VERIFY LIMITS OF SEWER REPAIRS PRIOR TO EXCAVATION BY MEANS OF VIDEO INSPECTION.
 2. CONTRACTOR TO PROVIDE VIDEO INSPECTION OF SEWER SERVICES WITHIN LIMITS OF REPAIR IN PRESENCE OF CONTRACT ADMINISTRATOR TO DETERMINE IF SERVICE RENEWAL IS REQUIRED.
 3. ALL BACKFILL TO BE CLASS 5 BACKFILL UNDER BOULEVARDS AND CLASS 3 UNDER OR WITHIN 1.0m OF PAVEMENT AND SIDEWALKS.

MH40010672
RIM EL 33.15
200 E INV 31.846
200 W INV 31.846

2.70 OF 200 SDR 35 PVC
SEWER REPAIR (SD-022A)

MH40010670
RIM EL 33.33
200 E INV 31.824
200 W INV 31.824
200 N INV 31.824

BENCH MARK:
87R463 - S. side Pandora Ave. E. @ Wabasha St.,
Tilt: on top of 0.05 m sq. x 2.4 m iron tube, 10.2 m
W. of W. wall No. 301 Pandora Ave. E. & 8.3 m S. of
C.L. Conc. Pav't. on Pandora Ave. E. or 23.2 m S. of
N.L. Pandora Ave. E. & 10 m W. of E.L. Wabasha St.

METRIC
WHOLE NUMBERS INDICATE MILLIMETRES
DECIMALIZED NUMBERS INDICATE METRES

AECOM
Certificate of Authorization
AECOM Canada Ltd.
No. 4671 Date: 11/02/10

BID OPPORTUNITY NO. 901-2010

LOCATION APPROVED
UNDERGROUND STRUCTURES

SUPR. U/G STRUCTURES DATE COMMITTEE

NOTE:
LOCATION OF UNDERGROUND STRUCTURES AS SHOWN ARE BASED ON THE BEST INFORMATION AVAILABLE. BUT NO GUARANTEE IS GIVEN THAT ALL EXISTING UTILITIES ARE SHOWN OR THAT THE GIVEN LOCATIONS ARE EXACT. CONFIRMATION OF EXISTENCE AND EXACT LOCATION OF ALL SERVICES MUST BE OBTAINED FROM THE INDIVIDUAL UTILITIES BEFORE PROCEEDING WITH CONSTRUCTION.

BM 30-035 ELEV 233.496m			
0	ISSUED FOR CONSTRUCTION	11/02/09	KMB
NO.	REVISIONS	YYMM/DD	BY

AECOM

This drawing has been prepared for the use of AECOM's client and may not be used, reproduced or relied upon by third parties, except as agreed by AECOM and its client, as required by law or for use by governmental reviewing agencies. AECOM accepts no responsibility, and denies any liability whatsoever, to any party that modifies this drawing without AECOM's express written consent. Do not scale this document. All measurements must be obtained from stated dimensions.

DESIGNED BY	ALD	CHECKED BY	PL
DRAWN BY	KMB	APPROVED BY	<i>[Signature]</i>
HOR. SCALE	1:500	RELEASED FOR CONSTRUCTION	<i>[Signature]</i>
VERT. SCALE	N/A	DATE	11/02/10

PROFESSIONAL'S SEAL

PROVINCE OF MANITOBA
[Signature]
K.W.
FITCHETT
Feb 10/11
REGISTERED PROFESSIONAL ENGINEER

CONSULTANT DRAWING NO.
60164626-01-C-120-R0X.dwg

THE CITY OF WINNIPEG
WATER AND WASTE DEPARTMENT

2010 WASTEWATER SEWER RENEWALS AND REPAIRS CONTRACT 16

PANDORA AVENUE EAST
51m E OF KANATA STREET
TO WABASHA STREET

SHEET 20 OF 45
CITY DRAWING NUMBER
9452 REV 0