

B SIZE 11" x 17" (279mm x 432mm)

PLOT: 2/9/2011 2:15:21 PM

FILE NAME: 60164626-01-C-121-R0X.dwg Saved By: berardk

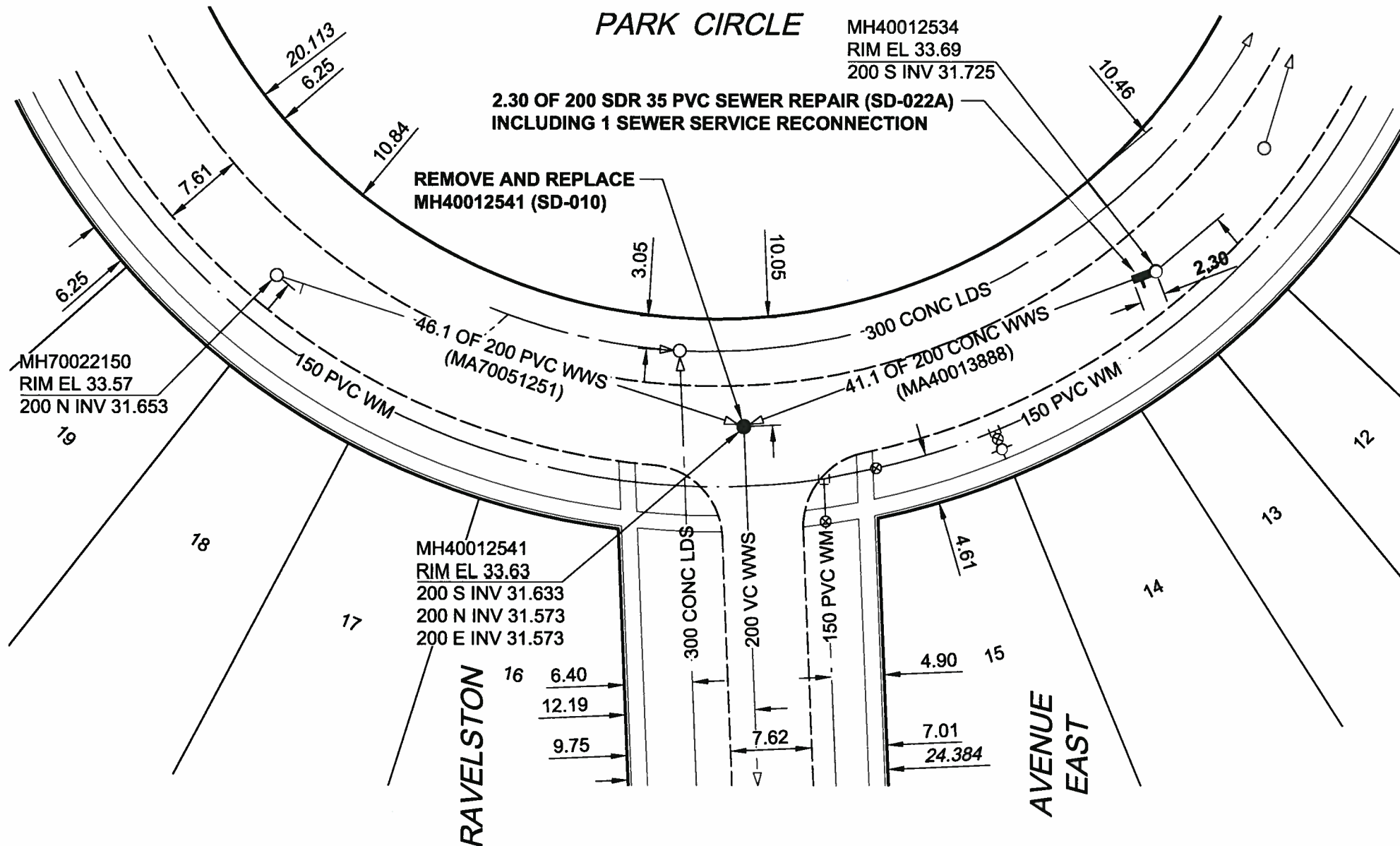

**MA40013888**

**SEWER JUNCTION INFORMATION**

REF. MH*	DIST FROM* REF. MH	SIZE*	CLOCK AT*
MH40012534	1.50	150Ø	09
MH40012534	17.40	150Ø	09

\*JUNCTION INFORMATION FROM VIDEO INSPECTION

**MA70051251**

**SEWER JUNCTION INFORMATION**

REF. MH*	DIST FROM* REF. MH	SIZE*	CLOCK AT*
MH70022150	2.60	150Ø	03
MH70022150	15.20	150Ø	03
MH70022150	24.00	150Ø	02

\*JUNCTION INFORMATION FROM VIDEO INSPECTION

**CONSTRUCTION NOTES:**

- CONTRACTOR TO VERIFY LIMITS OF SEWER REPAIRS PRIOR TO EXCAVATION BY MEANS OF VIDEO INSPECTION.
- CONTRACTOR TO PROVIDE VIDEO INSPECTION OF SEWER SERVICES WITHIN LIMITS OF REPAIR IN PRESENCE OF CONTRACT ADMINISTRATOR TO DETERMINE IF SERVICE RENEWAL IS REQUIRED.
- ALL BACKFILL TO BE CLASS 5 BACKFILL UNDER BOULEVARDS AND CLASS 3 UNDER OR WITHIN 1.0m OF PAVEMENT AND SIDEWALKS.

BID OPPORTUNITY NO. 901-2010

**METRIC**  
WHOLE NUMBERS INDICATE MILLIMETRES  
DECIMALIZED NUMBERS INDICATE METRES

**AECOM**  
Certificate of Authorization  
AECOM Canada Ltd.  
No. 4671 Date: 11/02/10

AECOM REVIEW DRAFT CHK

**LOCATION APPROVED**  
UNDERGROUND STRUCTURES

SUPR. U/G STRUCTURES	DATE

NOTE:  
LOCATION OF UNDERGROUND STRUCTURES AS SHOWN ARE BASED ON THE BEST INFORMATION AVAILABLE. BUT NO GUARANTEE IS GIVEN THAT ALL EXISTING UTILITIES ARE SHOWN OR THAT THE GIVEN LOCATIONS ARE EXACT. CONFIRMATION OF EXISTENCE AND EXACT LOCATION OF ALL SERVICES MUST BE OBTAINED FROM THE INDIVIDUAL UTILITIES BEFORE PROCEEDING WITH CONSTRUCTION.

NO.	REVISIONS	YY/MM/DD	BY
0	ISSUED FOR CONSTRUCTION	11/02/09	KMB



DESIGNED BY	ALD	CHECKED BY	PL
DRAWN BY	KMB	APPROVED BY	<i>[Signature]</i>
HOR. SCALE	1:500	RELEASED FOR CONSTRUCTION	<i>[Signature]</i>
VERT. SCALE	N/A	DATE	11/02/10

PROFESSIONAL'S SEAL



CONSULTANT DRAWING NO.  
60164626-01-C-121-R0X.dwg



**THE CITY OF WINNIPEG**  
**WATER AND WASTE DEPARTMENT**

**2010 WASTEWATER SEWER RENEWALS AND REPAIRS CONTRACT 16**

**PARK CIRCLE (E LEG)**  
INTERSECTION AT  
RAVELSTON AVENUE EAST

SHEET 21 OF 40

CITY DRAWING NUMBER

**9453**

REV 0