

B SIZE 11" x 17" (279mm x 432mm)

PLOT: 2/9/2011 8:18:15 AM

FILE NAME: 60164626-01-C-134-RDX.dwg Saved By: berardk

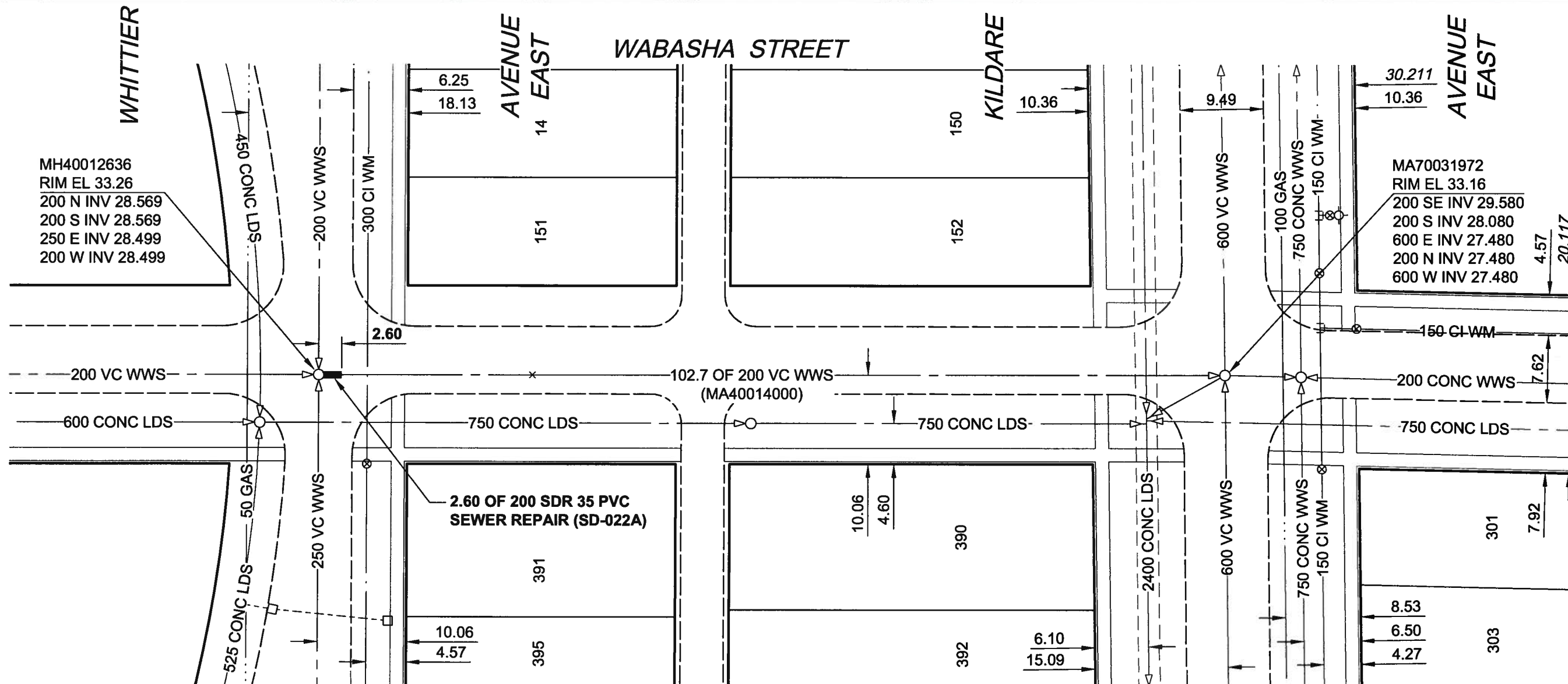
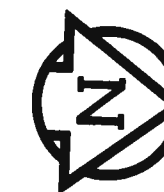

- CONSTRUCTION NOTES:**
- CONTRACTOR TO VERIFY LIMITS OF SEWER REPAIRS PRIOR TO EXCAVATION BY MEANS OF VIDEO INSPECTION.
  - CONTRACTOR TO PROVIDE VIDEO INSPECTION OF SEWER SERVICES WITHIN LIMITS OF REPAIR IN PRESENCE OF CONTRACT ADMINISTRATOR TO DETERMINE IF SERVICE RENEWAL IS REQUIRED.
  - ALL BACKFILL TO BE CLASS 5 BACKFILL UNDER BOULEVARDS AND CLASS 3 UNDER OR WITHIN 1.0m OF PAVEMENT AND SIDEWALKS.

**SEWER JUNCTION INFORMATION**

| REF. MH*   | DIST FROM* REF. MH | SIZE* | CLOCK AT* |
|------------|--------------------|-------|-----------|
| MH40012636 | 24.20              | 1000  | 12        |

\*JUNCTION INFORMATION FROM VIDEO INSPECTION

**METRIC**  
WHOLE NUMBERS INDICATE MILLIMETRES  
DECIMALIZED NUMBERS INDICATE METRES

Certificate of Authorization  
AECOM Canada Ltd.  
No. 4671 Date: 11/02/10

BID OPPORTUNITY NO. 901-2010

**LOCATION APPROVED UNDERGROUND STRUCTURES**

| SUPR. U/G STRUCTURES | DATE |
|----------------------|------|
|                      |      |

**NOTE:**  
LOCATION OF UNDERGROUND STRUCTURES AS SHOWN ARE BASED ON THE BEST INFORMATION AVAILABLE. BUT NO GUARANTEE IS GIVEN THAT ALL EXISTING UTILITIES ARE SHOWN OR THAT THE GIVEN LOCATIONS ARE EXACT. CONFIRMATION OF EXISTENCE AND EXACT LOCATION OF ALL SERVICES MUST BE OBTAINED FROM THE INDIVIDUAL UTILITIES BEFORE PROCEEDING WITH CONSTRUCTION.

| NO. | REVISIONS               | YY/MM/DD | BY  |
|-----|-------------------------|----------|-----|
| 0   | ISSUED FOR CONSTRUCTION | 11/02/09 | KMB |

This drawing has been prepared for the use of AECOM's client and may not be used, reproduced or relied upon by third parties, except as agreed by AECOM and its client, as required by law or for use by governmental reviewing agencies. AECOM accepts no responsibility, and denies any liability whatsoever, to any party that modifies this drawing without AECOM's express written consent. Do not scale this document. All measurements must be obtained from stated dimensions.

|             |       |                           |                    |
|-------------|-------|---------------------------|--------------------|
| DESIGNED BY | ALD   | CHECKED BY                | <i>RZ</i>          |
| DRAWN BY    | KMB   | APPROVED BY               | <i>[Signature]</i> |
| HOR. SCALE  | 1:500 | RELEASED FOR CONSTRUCTION | <i>[Signature]</i> |
| VERT. SCALE | N/A   | DATE                      | 11/02/10           |

PROFESSIONAL'S SEAL

CONSULTANT DRAWING NO.  
60164626-01-C-134-RDX.dwg

**THE CITY OF WINNIPEG**  
**WATER AND WASTE DEPARTMENT**

**2010 WASTEWATER SEWER RENEWALS AND REPAIRS CONTRACT 16**

**WABASHA STREET WHITTIER AVENUE EAST TO KILDARE AVENUE EAST**

|                     |             |     |    |
|---------------------|-------------|-----|----|
| SHEET               | 34          | OF  | 45 |
| CITY DRAWING NUMBER |             |     |    |
|                     | <b>9466</b> | REV | 0  |