

YALE AVENUE WEST

FOR FURTHER INFO
SEE DWG 9439

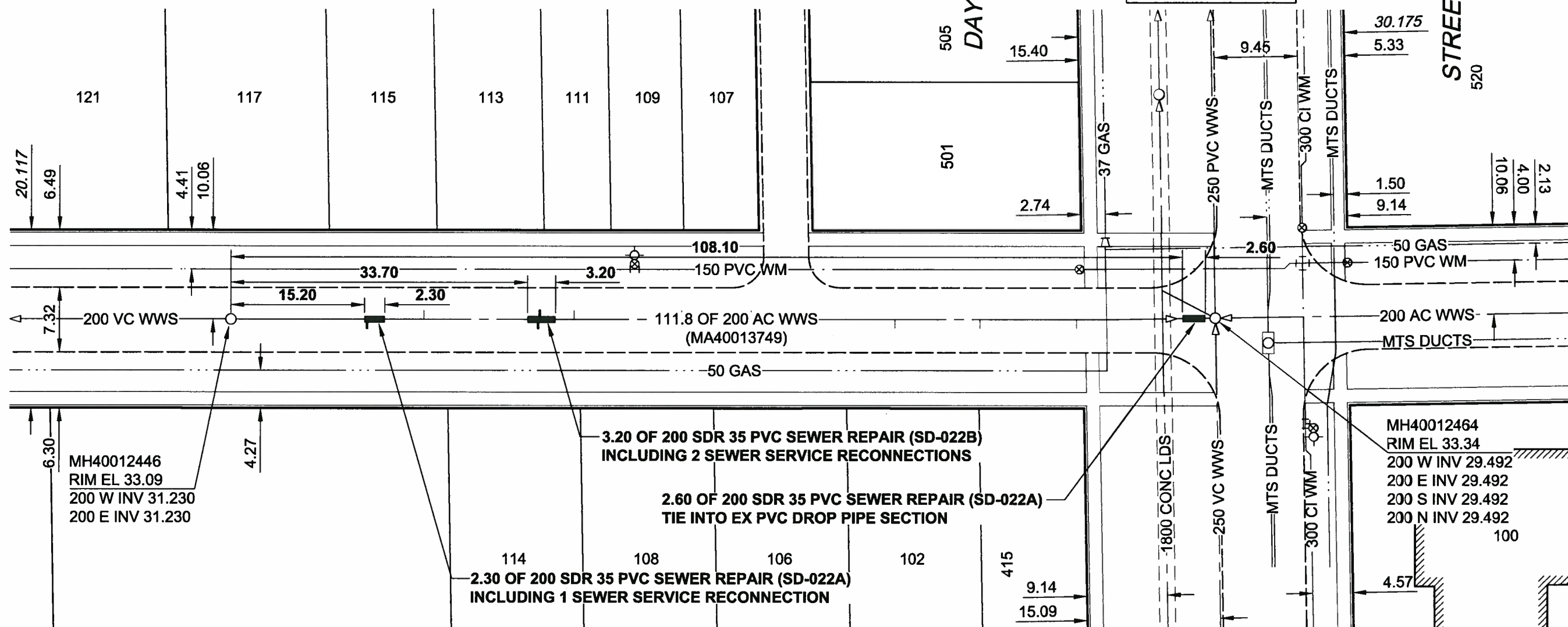

SEWER JUNCTION INFORMATION

REF. MH*	DIST FROM* REF. MH	SIZE*	CLOCK AT*
MH40012446	15.50	1500	02
MH40012446	21.90	1500	10
MH40012446	34.90	1500	03
MH40012446	35.10	1500	10
MH40012446	39.00	1500	10
MH40012446	51.20	1500	09
MH40012446	54.80	1500	03
MH40012446	59.10	1500	10
MH40012446	75.40	1500	02
MH40012446	85.10	1500	03
MH40012446	96.00	1500	01

- CONSTRUCTION NOTES:
- CONTRACTOR TO VERIFY LIMITS OF SEWER REPAIRS PRIOR TO EXCAVATION BY MEANS OF VIDEO INSPECTION.
 - CONTRACTOR TO PROVIDE VIDEO INSPECTION OF SEWER SERVICES WITHIN LIMITS OF REPAIR IN PRESENCE OF CONTRACT ADMINISTRATOR TO DETERMINE IF SERVICE RENEWAL IS REQUIRED.
 - ALL BACKFILL TO BE CLASS 5 BACKFILL UNDER BOULEVARDS AND CLASS 3 UNDER OR WITHIN 1.0m OF PAVEMENT AND SIDEWALKS.

BID OPPORTUNITY NO. 901-2010

METRIC
WHOLE NUMBERS INDICATE MILLIMETRES
DECIMALIZED NUMBERS INDICATE METRES

AECOM
Certificate of Authorization
AECOM Canada Ltd.
No. 4671 Date: 11/02/10

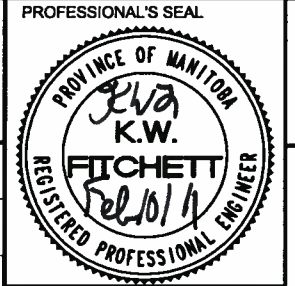

**THE CITY OF WINNIPEG
WATER AND WASTE DEPARTMENT**

**2010 WASTEWATER SEWER
RENEWALS AND REPAIRS
CONTRACT 16**

YALE AVENUE WEST
61m E OF BOND STREET
TO DAY STREET

SHEET	39	OF	45
CITY DRAWING NUMBER			
9471			REV
			0

LOCATION APPROVED UNDERGROUND STRUCTURES			
SUPR. U/G STRUCTURES	DATE	COMMITTEE	
NOTE: LOCATION OF UNDERGROUND STRUCTURES AS SHOWN ARE BASED ON THE BEST INFORMATION AVAILABLE. BUT NO GUARANTEE IS GIVEN THAT ALL EXISTING UTILITIES ARE SHOWN OR THAT THE GIVEN LOCATIONS ARE EXACT. CONFIRMATION OF EXISTENCE AND EXACT LOCATION OF ALL SERVICES MUST BE OBTAINED FROM THE INDIVIDUAL UTILITIES BEFORE PROCEEDING WITH CONSTRUCTION.			
0	ISSUED FOR CONSTRUCTION	11/02/09	KMB
NO.	REVISIONS	YY/MM/DD	BY

<p>This drawing has been prepared for the use of AECOM's client and may not be used, reproduced or relied upon by third parties, except as agreed by AECOM and its client, as required by law or for use by governmental reviewing agencies. AECOM accepts no responsibility, and denies any liability whatsoever, to any party that modifies this drawing without AECOM's express written consent. Do not scale this document. All measurements must be obtained from stated dimensions.</p>			
DESIGNED BY	ALD	CHECKED BY	PL
DRAWN BY	KMB	APPROVED BY	[Signature]
HOR. SCALE	1:500	RELEASED FOR CONSTRUCTION	[Signature]
VERT. SCALE	N/A	DATE	11/02/10
DATE	11/02/10	DATE	Feb 10/11

PROFESSIONAL'S SEAL
CONSULTANT DRAWING NO.
60164626-01-C-139-R0X.dwg

B SIZE 11" x 17" (279mm x 432mm)
 PLOT: 2/9/2011 8:22:36 AM
 FILE NAME: 60164626-01-C-139-R0X.dwg Saved By: berardk
 AECOM REVIEW DRAFT CHK