

GENERAL NOTES

- ALL SERVICES ARE TO BE INSTALLED IN ACCORDANCE WITH THE LATEST REVISION OF THE CITY OF WINNIPEG STANDARD CONSTRUCTION SPECIFICATIONS.
- THE DEVELOPER SHALL CONSTRUCT TEMPORARY MEASURES TO CONTROL SILT ENTERING THE STORM DRAINAGE SYSTEM TO THE SPECIFICATIONS OUTLINED IN THE GUIDELINES ON EROSION AND SEDIMENT CONTROL FOR URBAN CONSTRUCTION SITES PREPARED BY THE MINISTRY OF NATURAL RESOURCES. THESE MEASURES ARE TO BE INSTALLED PRIOR TO COMMENCING ANY CONSTRUCTION FOR THIS PROJECT AND ARE TO REMAIN IN PLACE UNTIL CONSTRUCTION HAS BEEN COMPLETED TO THE SPECIFICATIONS OF THE CITY ENGINEER.
- NO FOUNDATION DRAIN CONNECTIONS WILL BE PERMITTED INTO THE SANITARY SEWERS AND NO DIRECT GRAVITY CONNECTIONS FROM THE FOUNDATION DRAINS WILL BE PERMITTED TO THE STORM SYSTEM UNLESS THE STORM SYSTEM HAS THE CAPACITY TO PROVIDE FOR SUCH CONNECTIONS TO THE SATISFACTION OF THE CITY ENGINEER.
- THE STRUCTURAL DESIGN OF SEWERS IS BASED ON THE TRANSITION WIDTH UNLESS OTHERWISE NOTED.
- THE DEVELOPER IS TO NOTIFY THE WATER AND WASTE DEPARTMENT IN WRITING AT LEAST 48 HOURS PRIOR TO COMMENCING CONSTRUCTION.
- THE DEVELOPER SHALL HAVE ITS PROFESSIONAL ENGINEER PROVIDE FULL-TIME INSPECTION DURING CONSTRUCTION AND A CERTIFICATE OF COMPLETION OF WORKS UPON COMPLETION OF ALL WORKS TO BE CONSTRUCTED ON AN EXISTING CITY STREET OR EASEMENT.
- THE DEVELOPER SHALL HAVE ITS PROFESSIONAL ENGINEER PROVIDE ADEQUATE INSPECTION DURING CONSTRUCTION AND A CERTIFICATE OF COMPLETION OF WORKS UPON COMPLETION OF ALL WORKS WHICH ARE TO BE ASSUMED BY THE CITY.
- A "USE OF STREETS" PERMIT WILL BE REQUIRED WHERE ANY PORTION OF A STREET (PUBLIC RIGHT OF WAY) IS ENCUMBERED, OBSTRUCTED OR OCCUPIED.
- THE DEVELOPER IS TO MEET ALL THE REQUIREMENTS OF THE OWNERS OF THE UTILITIES ON THIS PLAN AND MUST MAKE SATISFACTORY ARRANGEMENTS WITH THE UTILITY COMPANIES FOR CROSSING THEIR INSTALLATIONS AND FOR PROVIDING ADEQUATE PROTECTION DURING CONSTRUCTION.
- ALL ORGANIC, UNSTABLE OR UNSUITABLE MATERIALS BENEATH THE ROAD ALLOWANCE OR FOUNDATIONS MUST BE REMOVED AND THESE AREAS BACK FILLED WITH AN APPROVED FILL MATERIAL, ALL TO THE SATISFACTION OF A GEOTECHNICAL ENGINEER.
- ALL SUBSTITUTIONS MUST BE APPROVED BY THE CITY ENGINEER.

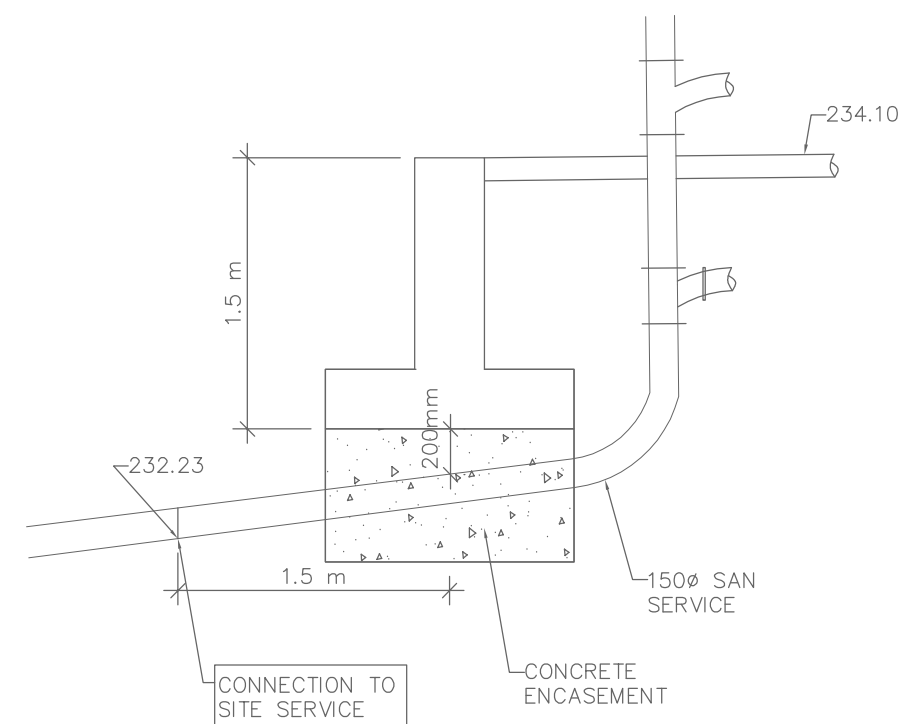

TYPICAL DETAIL

NOT TO SCALE

CONSTRUCTION NOTES

- THE CONTRACTOR SHALL TAKE ALL PRECAUTIONARY MEASURES UNDER THE OCCUPATIONAL HEALTH AND SAFETY ACT AS REQUIRED BY THE MINISTRY OF LABOUR.
- ALL SERVICE TRENCHES SHALL BE BACK FILLED WITH SUITABLE (ON THE OPINION OF THE GEOTECHNICAL ENGINEER) NATIVE MATERIAL AND COMPACTED TO AT LEAST 98% OF THE STANDARD PROCTOR MAXIMUM DRY DENSITY.
- RECOMMENDED MINIMUM PAVEMENT STRUCTURE:
 -40mm HL-3 TOP COURSE ASPHALT COMPACTED TO 98% STANDARD MARSHALL
 -60mm HL-8 BASE COURSE ASPHALT COMPACTED TO 98% STANDARD MARSHALL
 -300mm GRANULAR 'A' BASE COMPACTED TO 98% STANDARD PROCTOR
- THE OWNER SHALL BE RESPONSIBLE FOR ALL SURFACE AND SUBSURFACE WATERS.
- THE OWNER SHALL BE RESPONSIBLE FOR THE COMPLETE RESTORATION OF DISTURBED AREAS ON CITY PROPERTY AND THE ADJACENT AREAS DISTURBED BY THE CONTRACTOR'S OPERATIONS.

ORIFICE DETAIL (CBMH1)

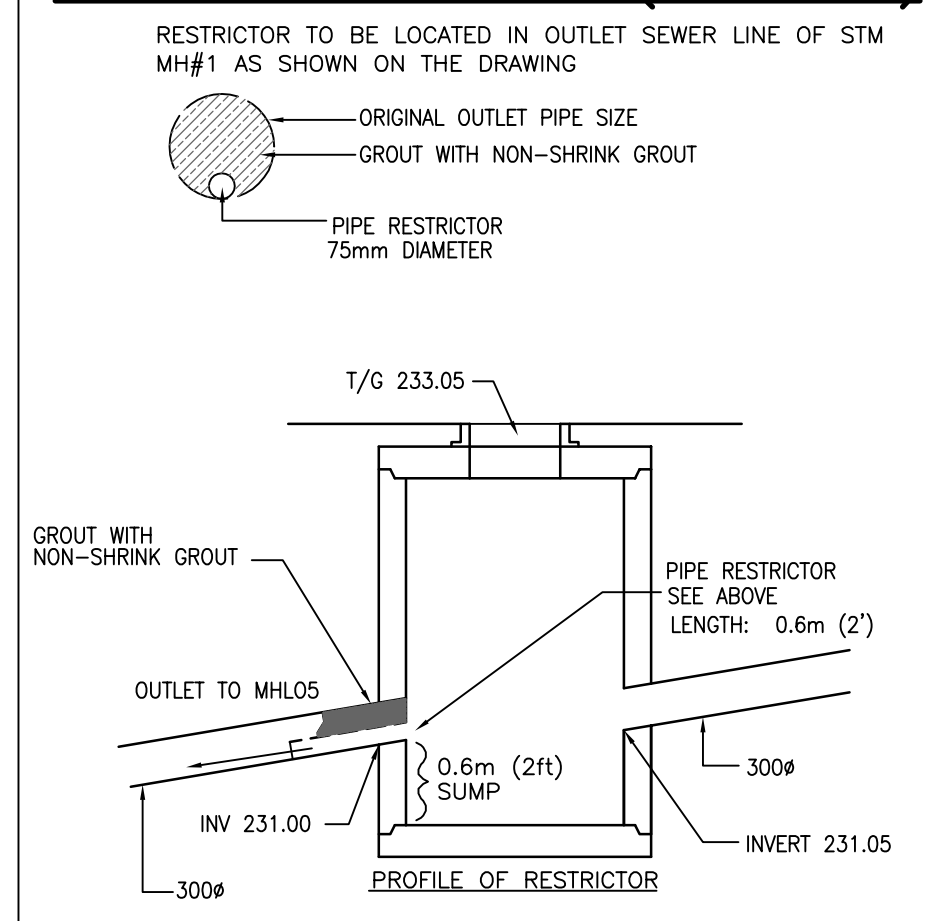

EXISTING PLAN REFERENCE

EXISTING LEGAL INFORMATION OBTAINED FROM PLAN PROVIDED BY SHEPHERD AND STEVENS, PROFESSIONAL SURVEYORS, DATED AUGUST 10th, 2010, AND FILE No. 10-279. EXISTING SITE LAYOUT OBTAINED FROM PLANS PROVIDED BY MURPHY & MURPHY ARCHITECT INC., DATED MARCH 2010, PROJECT No. 2261.

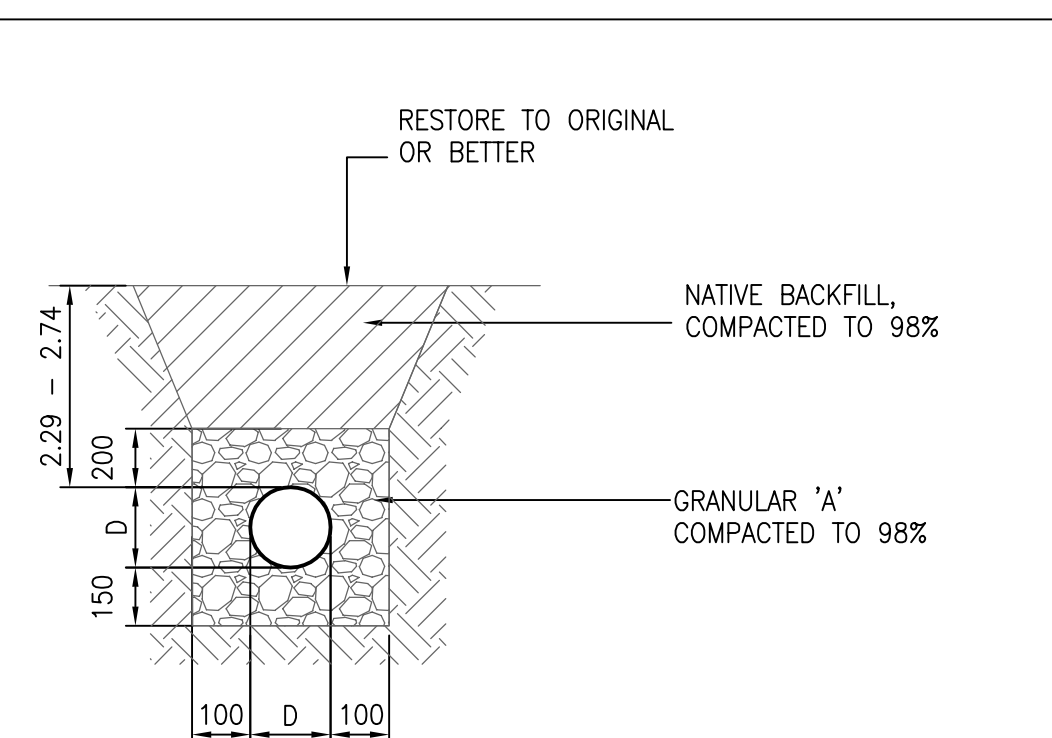

TYPICAL TRENCH DETAIL

NOT TO SCALE

MANHOLE/CATCHBASIN SCHEDULE					
	TYPE OF MATERIAL	TOP EL. (RIM)	INLET	OUTLET	SIZE
CB1	SD-025	233.45	-	231.70	250
CB2	SD-025	233.45	231.51	231.46	250 / 250
CB3	SD-025	233.45	231.16	231.11	250 / 300
CB4	SD-025	233.45	-	232.23	250
CBMH1	SD-010/AP-004/AP-006	233.05	231.05/231.05	231.00	300/250/250
CONNECTION	SD-014		230.28	230.13	300 / 450
SAN INV @ BLDG				232.23	150
SAMH1	SD-010	233.75	231.34	230.27	150
CONNECTION	SD-014		228.93	228.83	150 / 250

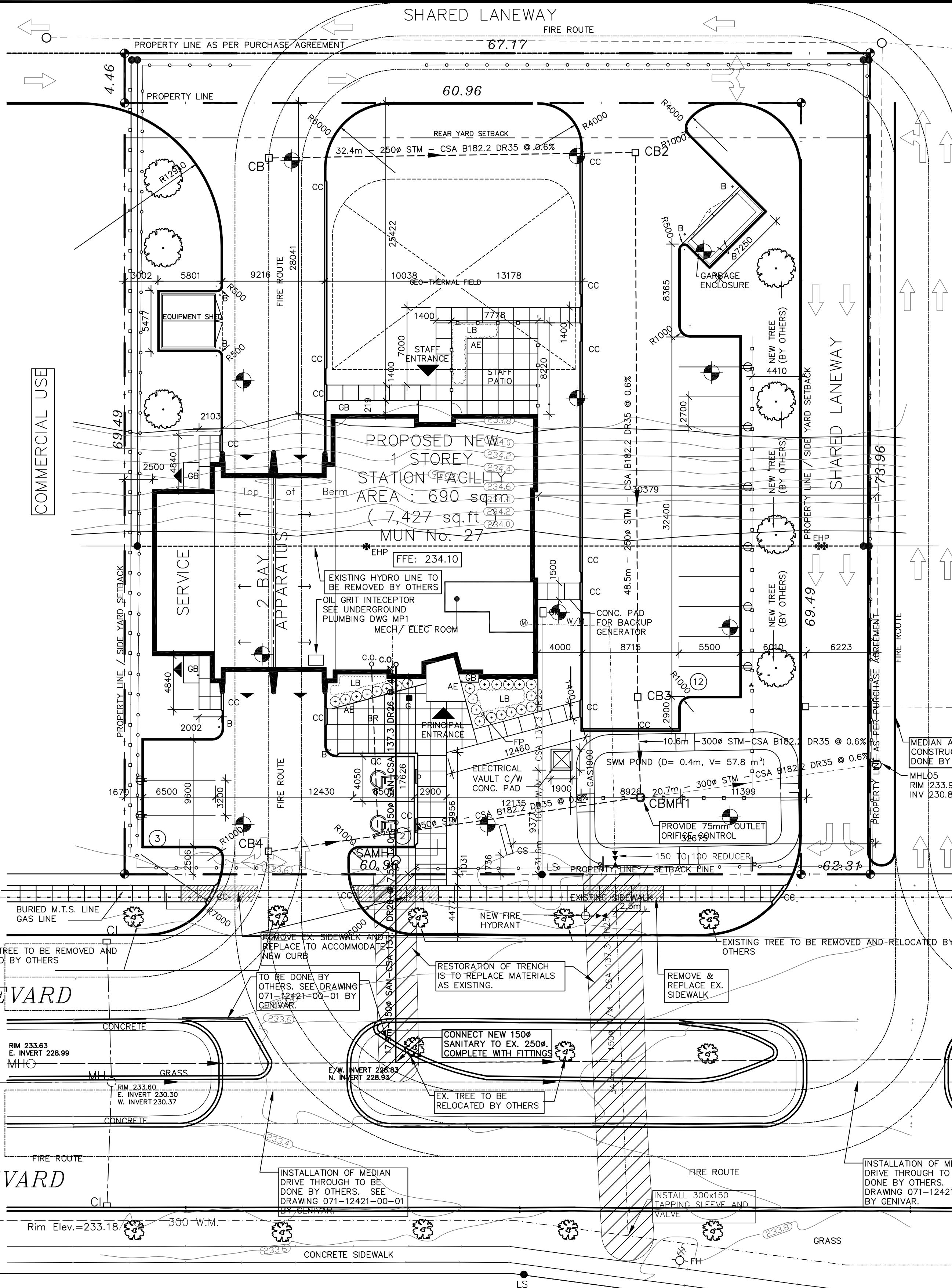

11 SITE PLAN SCALE 1:250

LEGEND

- | | | | |
|--|--|--|---|
| <ul style="list-style-type: none"> EXISTING CATCHBASIN PROPOSED CATCHBASIN EXISTING MANHOLE PROPOSED MANHOLE | <ul style="list-style-type: none"> ALUMINIUM EDGING STEEL BOLLARD BIKE RACK CATCH BASIN CURB CUT EXISTING HYDRO POLE EXTERIOR LIGHT FIXTURE FIRE ROUTE SIGN FLAG POLE GARBAGE CAN GAS METER GRAVEL BED GROUND SIGN BARRIER-FREE PARKING SIGN NEW HYDRO POLE | <ul style="list-style-type: none"> LANDSCAPE BED NOT IN CONTRACT REVERSE NEW CONCRETE SIDEWALK C/W CONTROL JOINTS @ 1220 / 1524 mm O.C. SIAMSE CONNECTION (NOT CONNECTED) SIMILAR TYPICAL | <ul style="list-style-type: none"> DIRECTION OF SLOPE NEW TREE EXISTING TREE TO REMAIN 6" HIGH CEDAR WOOD POST FENCE 5" HIGH STAKED ORANGE CONSTRUCTION FENCE @ 6" O.C. C/W TIE WIRE ON TOP SILT FENCE PROPERTY LINE VEHICLE PLUG-IN RECEPTACLE (REFER TO ELECTRICAL) |
|--|--|--|---|

ISSUES:

1	23 SEPT 10	BUILDING PERMIT APPLICATION
2	28 NOV 10	COMPATIBILITY WITH GENIVAR
3		

KEY PLAN

N.T.S.

STEVENSON ENGINEERING LIMITED
 1335 HYDE PARK ROAD LONDON, ONTARIO N6A 3L4
 TEL: (519) 474-5410 FAX: (519) 474-5420
 PROJECT No. 2010-08 AFEW LICENSE # 4851

© COPYRIGHT MURPHY & MURPHY ARCHITECT 2009
 NOT TO BE REPRODUCED WITHOUT CONSENT OF ARCHITECT.

ENGINEER'S STAMP: ARCHITECT'S STAMP:

Stevenson Engineering Limited
 No. 4851 Date: 23 Sept 2010

MURPHY & MURPHY ARCHITECT INC.
 775 WATERLOO STREET, LONDON, ONTARIO N6A 3W6
 PH: (519) 433-9161 FAX: (519) 433-5115

A Detail Number
 B Drawing Number - Where Detail Found

CONTRACTOR SHALL CHECK ALL DIMENSIONS ON THE DRAWINGS AND REPORT ANY DISCREPANCIES TO THE ARCHITECT BEFORE PROCEEDING. ALL DRAWINGS AND SPECIFICATIONS ARE PROPERTY OF THE ARCHITECT AND MUST BE RETURNED AT THE COMPLETION OF THE WORK. DRAWINGS ARE NOT TO BE SCALED. USE ONLY THE LATEST REVISED DRAWINGS OR THOSE THAT ARE MARKED "ISSUED FOR CONSTRUCTION". ANY UNAUTHORIZED USE IS PROHIBITED. AREA CALCULATIONS ARE APPROXIMATE.

PROJECT NAME:
NEW WINNIPEG STATION No. 27 PROJECT

SAGE CREEK, WINNIPEG, MANITOBA

DRAWING TITLE:
SITE SERVICING PLAN

PROJECT NORTH:

STAMP:

SCALE: AS NOTED
 DATE: MARCH 2010
 ISSUED: MAY 21, 2010
 DRAWN BY: MPM
 CHECKED BY: RCS

PROJECT NO.: 2261
 FILE NAME:
 DRAWING NO.: SS-1